

Wild Rose Cottage - Newt Barrier Plan:

- KEY**
- EXISTING TREES
 - PROPOSED TREES
 - WILDFLOWER MEADOWS
 - GROUND PROTECTION MATS/CRUSHED STONE/GRASS
 - EXISTING HARD STANDING
 - BICYCLE HIRE STATION WITH CANOPY OVER SHEFFIELD BICYCLE STAND

Key area of suitable reptile habitat. To be maintained as wildflower meadow, with occasional shrubs. Grass maintained short in sections along the watercourse for basking, grading back to areas of scrub along the hedge margins (as per fig. 15 of Reptile Mitigation Method Statement).

Hibernacula Set / Translocation Area (as per fig. 15 of Reptile Mitigation Method Statement).

Location of Newt Barrier

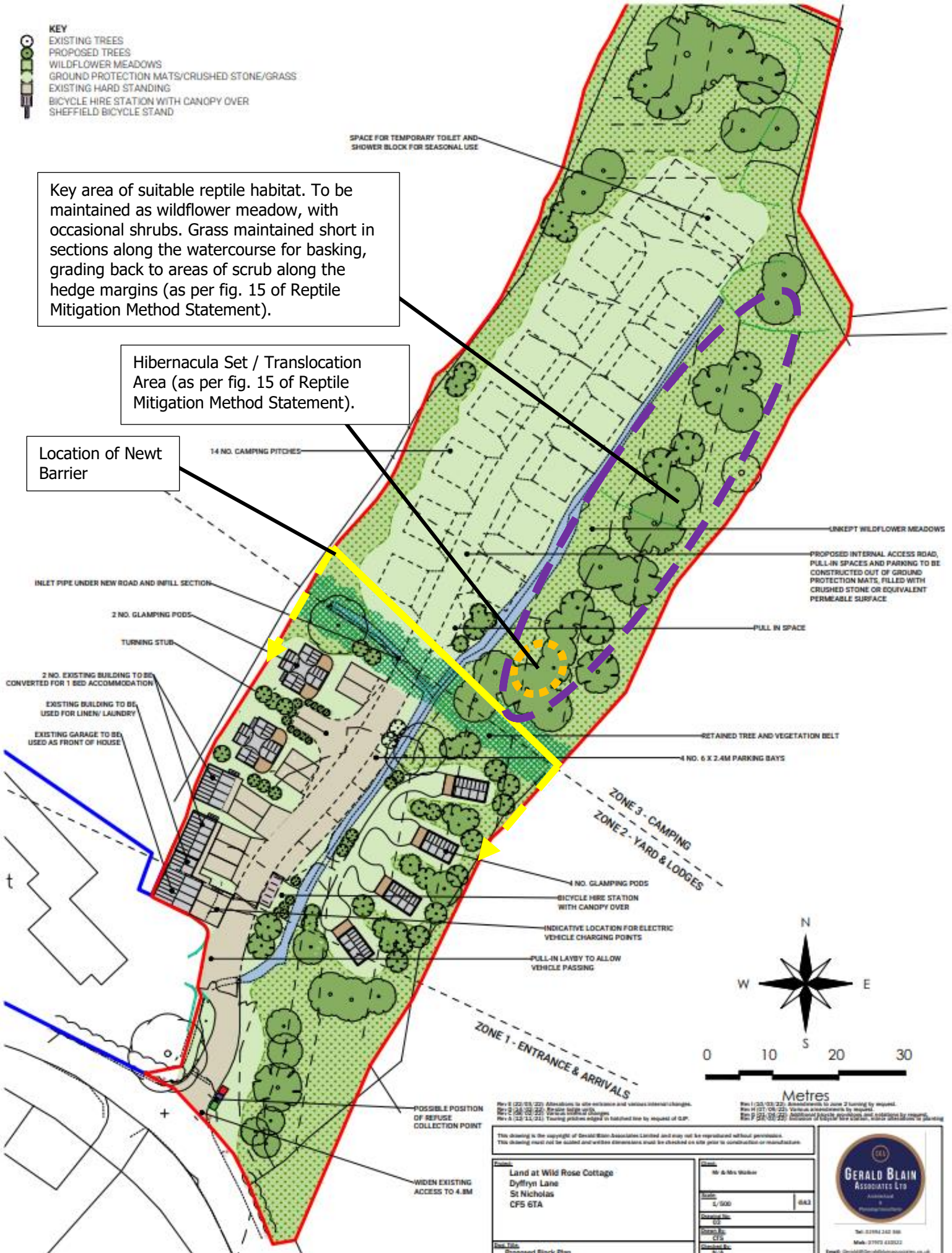

Rev 8 (20/08/22) Alterations to site entrance and various internal changes.
 Rev 7 (24/08/22) Various minor changes.
 Rev 6 (22/11/21) Tearing gridlines added in hatched line by request of C.P.
 Rev 1 (20/03/22) Amendments to June 21 drawing by request.
 Rev 0 (07/08/22) Various amendments by request.
 Rev P (21/08/22) Additional fence proposals and alterations by request.
 Location of fence line a red line, other alterations to drawing

This drawing is the copyright of Gerald Blain Associates Limited and may not be reproduced without permission.
 This drawing must not be scaled and written dimensions shall be checked on site prior to construction or manufacture.

Project:	Land at Wild Rose Cottage Dyffryn Lane St Nicholas CFS 6TA	Client:	M & Mrs Walker
Scale:	1/500	Drawn by:	043
Checked by:	03	Project No.:	
Drawn by:	03	Project No.:	
Checked by:	03	Project No.:	
Drawn by:	03	Project No.:	

Proposed Block Plan