

ISO A1 594mm x 841mm  
Approved: RM  
Checked: ATZ  
Designer: KP  
Project Management Initials: JG  
PAVEMENTS\_GENERAL30\_0700\_PAVEMENTS\_GENERAL30\_0700-CT-0701-0708-DWG  
CADD5.3 DRAWINGSERIES 0700 - PAVEMENTS\_GENERAL30\_0700\_PAVEMENTS\_GENERAL30\_0700-CT-0701-0708-DWG  
Last saved by: RHYS DAVIES(2021-05-02) Last Plotted: 2021-07-08  
Filename: \\UKCDF-FF002\UKCDF-FF002-V11\PROJECTS\HIGHWAYS - LLANMAES FLOOD ALLEVIATION SCHEME\5.0 CADD\5.3 DRAWINGSERIES 0700 - PAVEMENTS\_GENERAL30\_0700\_PAVEMENTS\_GENERAL30\_0700-CT-0701-0708-DWG

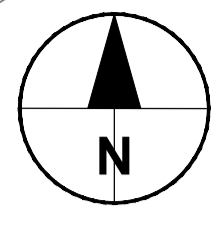
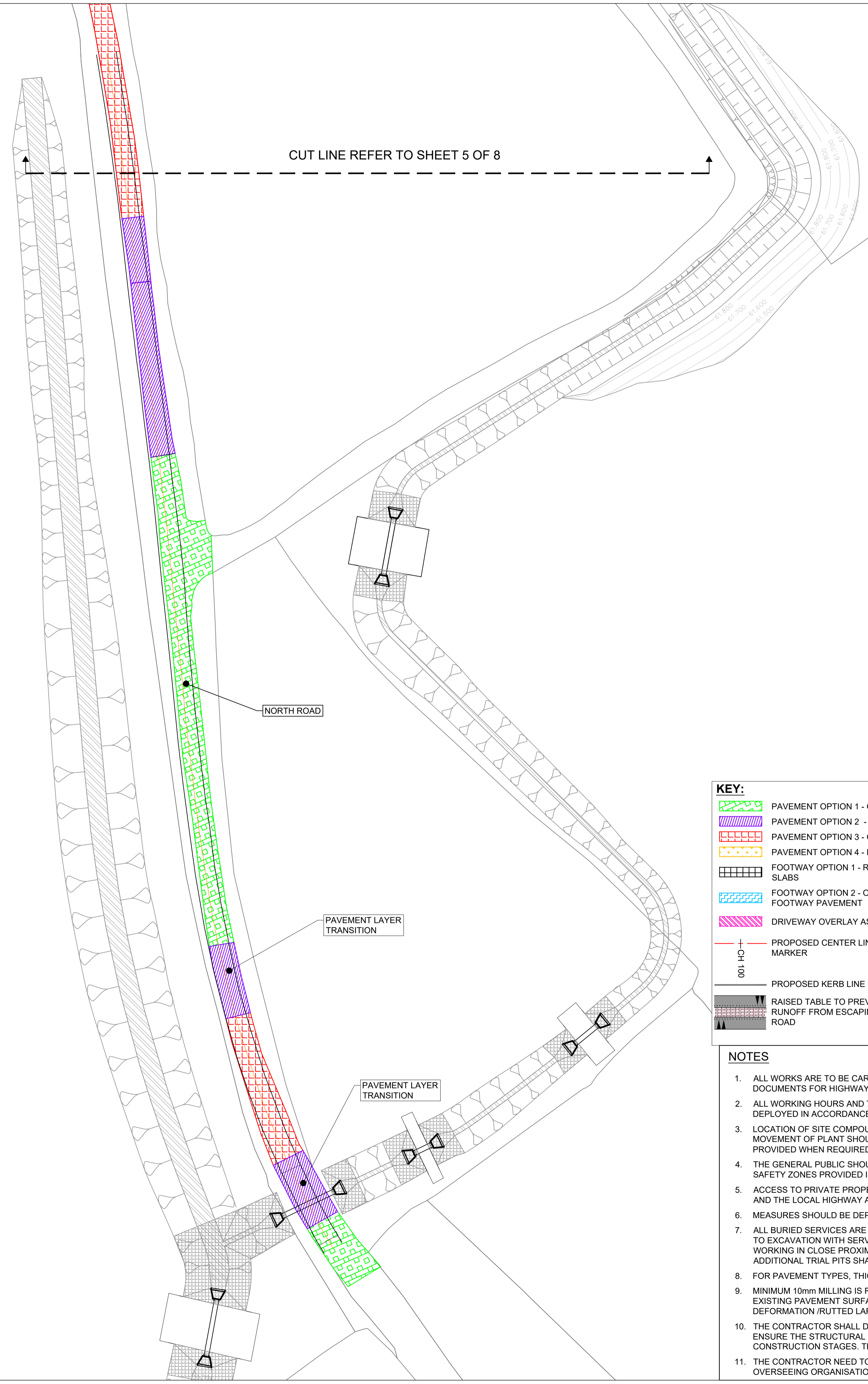

CUT LINE REFER TO SHEET 5 OF 8

NORTH ROAD

PAVEMENT LAYER TRANSITION

PAVEMENT LAYER TRANSITION

**KEY:**

- PAVEMENT OPTION 1 - OVERLAY 0-40mm
- PAVEMENT OPTION 2 - OVERLAY 40-130mm
- PAVEMENT OPTION 3 - OVERLAY 130-370mm
- PAVEMENT OPTION 4 - RECONSTRUCTION
- FOOTWAY OPTION 1 - RAISE EXISTING PAVING SLABS
- FOOTWAY OPTION 2 - OVERLAY TO EXISTING FOOTWAY PAVEMENT
- DRIVEWAY OVERLAY AS REQUIRED
- PROPOSED CENTER LINE AND CHAINAGE MARKER
- PROPOSED KERB LINE
- RAISED TABLE TO PREVENT RUNOFF FROM ESCAPING WEST ROAD

### SAFETY, HEALTH AND ENVIRONMENTAL INFORMATION

- IN ADDITION TO THE HAZARDS/RISKS NORMALLY ASSOCIATED WITH THE TYPES OF WORK DETAILED ON THIS DRAWING, NOTE THE FOLLOWING SPECIFIC RESIDUAL RISKS (REFERENCE SHALL ALSO BE MADE TO THE DESIGN HAZARD LOG).
- WORKING WITHIN LIVE TRAFFIC AND UNDER TRAFFIC MANAGEMENT
  - UNDERGROUND UTILITIES, ELECTRICITY
  - WORKING WITH HAZARDOUS MATERIAL (ASPHALT)
  - DITCH EXCAVATIONS

### NOTES

1. ALL WORKS ARE TO BE CARRIED OUT IN ACCORDANCE WITH THE CONTRACT SPECIFICATION AND THE MANUAL OF CONTRACT DOCUMENTS FOR HIGHWAY WORKS (MCHW).
2. ALL WORKING HOURS AND TRAFFIC MANAGEMENT MEASURES ARE TO BE AGREED WITH THE LOCAL HIGHWAY AUTHORITY AND DEPLOYED IN ACCORDANCE WITH CHAPTER 8 OF THE TRAFFIC SIGNS MANUAL.
3. LOCATION OF SITE COMPOUND TO BE AGREED WITH THE LOCAL HIGHWAY AUTHORITY PRIOR TO WORKS COMMENCING. ALL MOVEMENT OF PLANT SHOULD BE IN ACCORDANCE WITH RECOGNISED GOOD INDUSTRY PRACTICE. BANKSMEN SHOULD BE PROVIDED WHEN REQUIRED.
4. THE GENERAL PUBLIC SHOULD BE SEPARATED FROM THE WORKS WITH ADEQUATE LATERAL CLEARANCE AND APPROPRIATE SAFETY ZONES PROVIDED IN ACCORDANCE WITH CHAPTER 8 OF THE TRAFFIC SIGNS MANUAL.
5. ACCESS TO PRIVATE PROPERTIES MUST BE MAINTAINED AT ALL TIMES UNLESS OTHERWISE AGREED WITH THE AFFECTED PARTY AND THE LOCAL HIGHWAY AUTHORITY.
6. MEASURES SHOULD BE DEPLOYED TO ENSURE NOISE, VIBRATION AND DUST IS MINIMISED.
7. ALL BURIED SERVICES ARE TO BE POSITIVELY LOCATED ON SITE PRIOR TO EXCAVATION. CAT SCANS SHALL BE COMPLETED PRIOR TO EXCAVATION WITH SERVICE LOCATIONS MARKED UP ON SITE. OPERATIVES SHALL EMPLOY HAND DIGGING METHODS WHEN WORKING IN CLOSE PROXIMITY TO BURIED SERVICES. STATUTORY UNDERTAKER'S PLANT SHALL BE PROTECTED AS NECESSARY. ADDITIONAL TRIAL PITS SHALL BE EXCAVATED AS REQUIRED.
8. FOR PAVEMENT TYPES, THICKNESS AND STANDARD DETAILS REFER TO DRAWING "60160078-ACM-SHT-30-9000-CT-9001".
9. MINIMUM 10mm MILLING IS REQUIRED BETWEEN PROPOSED AND EXISTING SURFACE COURSE TO PROVIDE A KEY WITH THE EXISTING PAVEMENT SURFACE. IT IS ASSUMED THAT THE REMAINDER SURFACE COURSE IS SUITABLE TO BE RETAINED AND NOT DEFORMATION /RUTTED LARGER THAN 10mm. NO CRACKS OR MAJOR FRETTING ARE PRESENT.
10. THE CONTRACTOR SHALL DEVELOP CONSTRUCTION SEQUENCE AND PROVIDE ADEQUATE TEMPORARY WORKS IF NECESSARY TO ENSURE THE STRUCTURAL STABILITY OF THE EXISTING (STONE WALL) AND NEW STRUCTURE (KERB AND PAVEMENT) DURING ALL CONSTRUCTION STAGES. THIS WILL NEED TO BE APPROVED FROM THE OVERSEEING ORGANISATION PRIOR WORKS COMMENCE.
11. THE CONTRACTOR NEED TO SUBMIT CONSTRUCTION SEQUENCE AND TEMPORARY WORKS CALCULATIONS (IF NECESSARY) TO OVERSEEING ORGANISATION FOR APPROVAL.

### STATUS

DETAILED DESIGN

### ISSUE/REVISION

IR	DATE	DESCRIPTION
C	07/07/2021	FOR PRICING
B	26/02/2021	DETAILED DESIGN
A	16/12/2020	DRAFT DETAILED DESIGN

### KEY PLAN

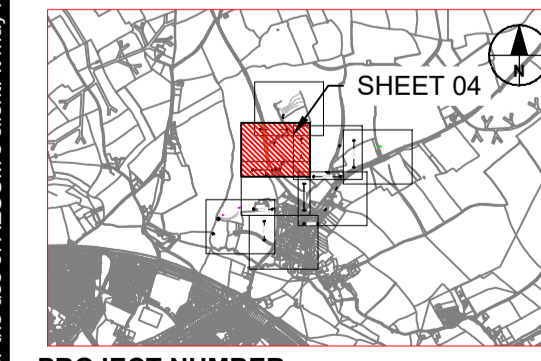

PROJECT NUMBER  
60160078

SHEET TITLE  
LLANMAES VILLAGE  
FLOOD ALLEVIATION SCHEME  
PAVEMENT LAYOUT  
SHEET 4 OF 8

SHEET NUMBER

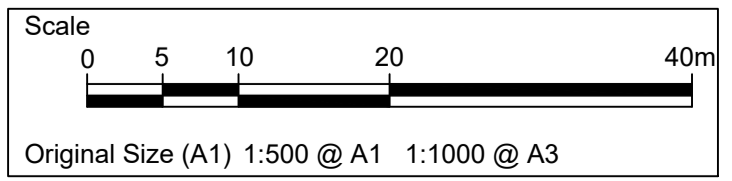

Original Size (A1) 1:500 @ A1 1:1000 @ A3