

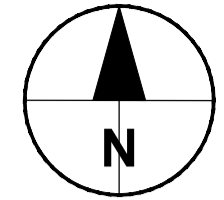

CONSULTANT

AECOM  
1 CALLAGHAN SQUARE  
CARDIFF  
CF10 5BT  
TEL: (029) 20674600  
FAX: (029) 20674699



Approved: ATZ  
Checked: MH  
Designer: RD  
Project Management Initials:  
ISO A1 90mm x 60mm  
Last saved by: RHYSDAVIES2(2021-07-15)  
Last Plotted: 2021-07-20  
Filename: F:\PROJECTS\HIGHWAYS - LLANMAES FLOOD ALLEVIATION SCHEMES\0 CADD\5.3 DRAWINGS\SERIES 0100 - PRELIM\30 0100 GENERAL ARRANGEMENT\60160078-ACM-SHT-30-0100-CT-01-01-0108.DWG

**KEY:**

	PLANNING APPLICATION BOUNDARY
	PROPOSED BUND
	PROPOSED DITCH
	ROAD TO BE RE-GRADED
	FOOTWAY TO BE RE-GRADED
	PROPOSED CENTER LINE AND CHAINAGE MARKER
	L.O.W. LIMIT OF WORK
	EXISTING VEGETATION (LOCATION INDICATIVE)
	EXISTING HEDGE (LOCATION INDICATIVE)
	PROPOSED HEDGE
	PROPOSED HALF BATTERED 75mm UPSTAND KERB
	PROPOSED HALF BATTERED 125mm UPSTAND KERB
	PROPOSED BULL NOSED 0mm UPSTAND KERB
	PROPOSED BUS STOP 200mm UPSTAND KERB
	PROPOSED STONE WALL
	PROPOSED GULLY
	PROPOSED CULVERT/HEADWALLS
	PROPOSED EROSION MATTING
	PROPOSED DRAINAGE NETWORK
	PROPOSED FILTER DRAIN
	EXISTING GULLY LOCATION
	PROPOSED FENCE
	EXISTING PUBLIC RIGHT OF WAY
	PROPOSED DIVERSION
	EXISTING PUBLIC RIGHT OF WAY TO BE CLOSED

**SAFETY, HEALTH AND ENVIRONMENTAL INFORMATION**

IN ADDITION TO THE HAZARDS/RISKS NORMALLY ASSOCIATED WITH THE TYPES OF WORK DETAILED ON THIS DRAWING, NOTE THE FOLLOWING SPECIFIC RESIDUAL RISKS (REFERENCE SHALL ALSO BE MADE TO THE DESIGN HAZARD LOG).
WORKING WITHIN LIVE TRAFFIC AND UNDER TRAFFIC MANAGEMENT
UNDERGROUND UTILITIES, ELECTRICITY
WORKING WITH HAZARDOUS MATERIAL (ASPHALT)
DITCH EXCAVATIONS

- NOTES**
- ALL WORKS ARE TO BE CARRIED OUT IN ACCORDANCE WITH THE CONTRACT SPECIFICATION AND THE MANUAL OF CONTRACT DOCUMENTS FOR HIGHWAY WORKS.
  - ALL WORKING HOURS AND TRAFFIC MANAGEMENT MEASURES ARE TO BE AGREED WITH THE LOCAL HIGHWAY AUTHORITY AND DEPLOYED IN ACCORDANCE WITH CHAPTER 8 OF THE TRAFFIC SIGNS MANUAL.
  - LOCATION OF SITE COMPOUND TO BE AGREED WITH THE LOCAL HIGHWAY AUTHORITY PRIOR TO WORKS COMMENCING. ALL MOVEMENT OF PLANT SHOULD BE IN ACCORDANCE WITH RECOGNIZED GOOD INDUSTRY PRACTICE. BANKSMEN SHOULD BE PROVIDED WHEN REQUIRED.
  - THE GENERAL PUBLIC SHOULD BE SEPARATED FROM THE WORKS WITH ADEQUATE LATERAL CLEARANCE AND APPROPRIATE SAFETY ZONES PROVIDED IN ACCORDANCE WITH CHAPTER 8 OF THE TRAFFIC SIGNS MANUAL.
  - ACCESS TO PRIVATE PROPERTIES MUST BE MAINTAINED AT ALL TIMES UNLESS OTHERWISE AGREED WITH THE AFFECTED PARTY AND THE LOCAL HIGHWAY AUTHORITY.
  - MEASURES SHOULD BE DEPLOYED TO ENSURE NOISE, VIBRATION AND DUST IS MINIMIZED.
  - ALL BURIED SERVICES ARE TO BE POSITIVELY LOCATED ON SITE PRIOR TO EXCAVATION. CAT SCANS SHALL BE COMPLETED PRIOR TO EXCAVATION WITH SERVICE LOCATIONS MARKED UP ON SITE. OPERATIVES SHALL EMPLOY HAND DIGGING METHODS WHEN WORKING IN CLOSE PROXIMITY TO BURIED SERVICES. STATUTORY UNDERTAKER'S PLANT SHALL BE PROTECTED AS NECESSARY. ADDITIONAL TRIAL PITS SHALL BE EXCAVATED AS REQUIRED.
  - THIS DRAWING TO BE READ IN CONJUNCTION WITH THE RELEVANT ENGINEERING DETAILS, DRAWINGS AND SPECIFICATIONS.
  - REFER TO DRAWING NUMBER 60160078-ACM-SHT-30-0150-CT-0001 TO 0005 & 60160078-ACM-SHT-30-0120-CT-0121 TO 0128 FOR LONG SECTIONS AND TYPICAL CROSS SECTION DETAILS.
  - REFER TO DRAWING NUMBERS 60160078-ACM-SHT-30-9000-CT-9000 TO 9005 FOR STANDARD DETAILS.
  - REFER TO DRAWING NUMBERS 60160078-ACM-SHT-30-0700-CT-0701 TO 0708 FOR PAVEMENT DETAILS.
  - DIMENSIONS AND LEVELS ARE IN METRES UNLESS OTHERWISE STATED. LEVELS RELATE TO ORDNANCE DATUM.
  - DO NOT SCALE FROM THIS DRAWING. USE ONLY PRINTED DIMENSIONS ONLY.
  - THE PROPOSED DITCH AND BUNDS ALIGNMENT IS TO BE CONFIRMED ON SITE AND IS BASED ON OS MAP AND LIDAR DATA AVAILABLE AT THE TIME OF THE DESIGN. ANY ALTERATIONS CAN BE PROPOSED TO THE SUPERVISOR AND HIGHWAYS AUTHORITY FOR APPROVAL.
  - VEGETATION LOCATIONS ARE INDICATIVE.

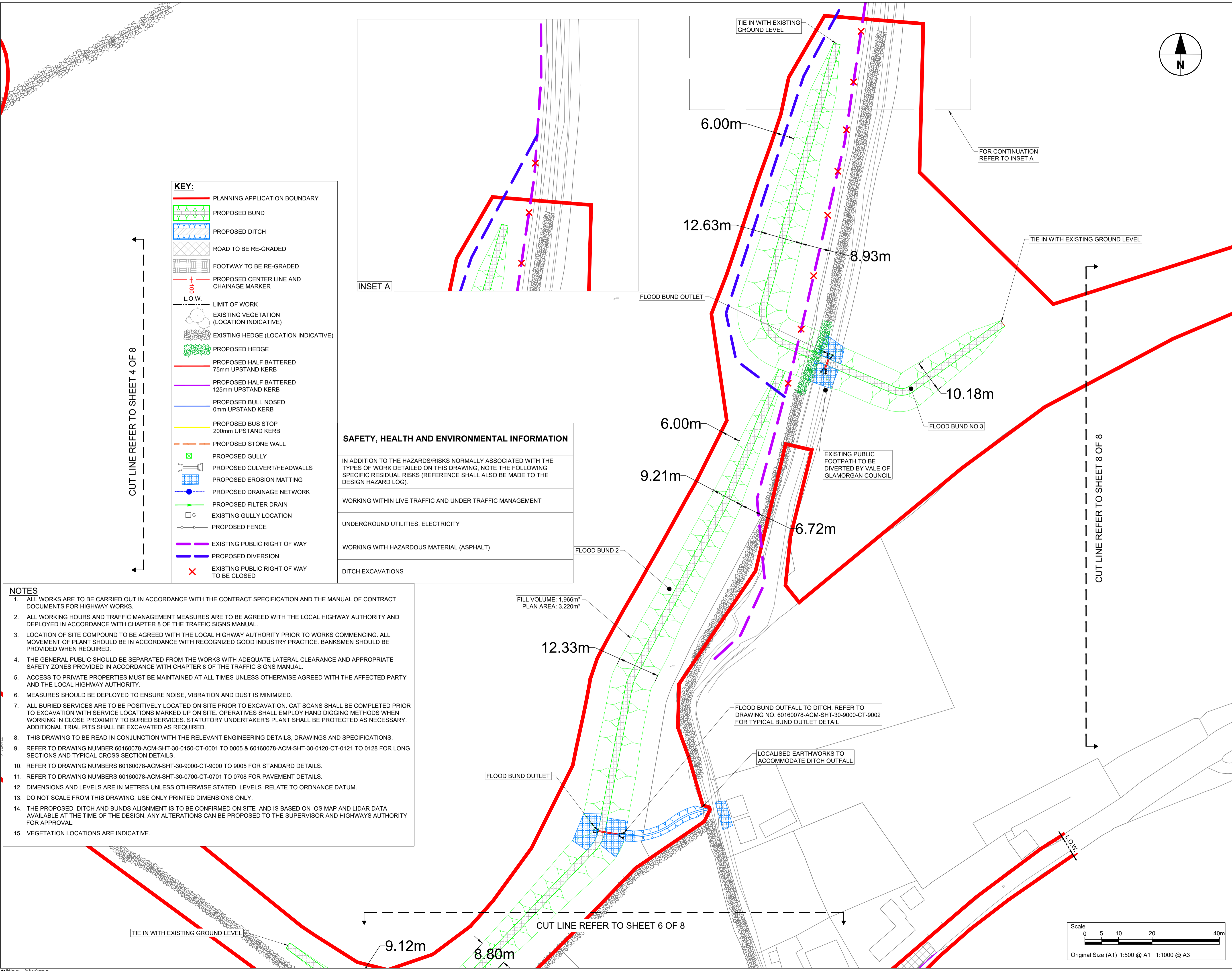

CUT LINE REFER TO SHEET 4 OF 8

CUT LINE REFER TO SHEET 8 OF 8

CUT LINE REFER TO SHEET 6 OF 8

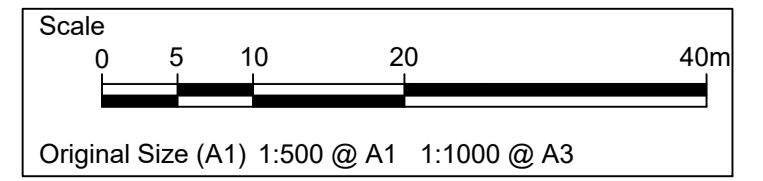

**STATUS**

DETAILED DESIGN		
<b>ISSUE/REVISION</b>		
C	07/07/2021	FOR PRICING
B	26/02/2021	DETAILED DESIGN
A	16/12/2020	DRAFT DETAILED DESIGN
IR	DATE	DESCRIPTION

**KEY PLAN**

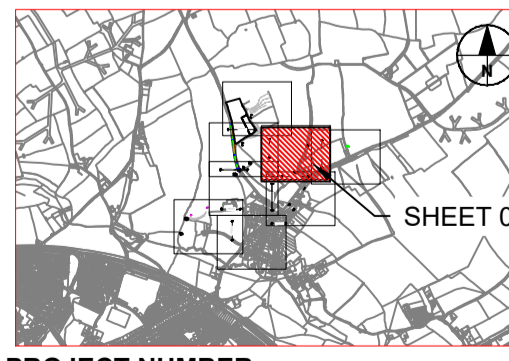

**PROJECT NUMBER**  
60160078

**SHEET TITLE**  
LLANMAES VILLAGE  
FLOOD ALLEVIATION SCHEME  
GENERAL ARRANGEMENT PLAN  
SHEET 7 OF 8

**SHEET NUMBER**  
60160078-ACM-SHT-30-0100-CT-0107

This drawing has been prepared for the use of AECOM's client. It may not be used, modified, reproduced or relied upon by third parties, except as agreed by AECOM or as required by law. AECOM accepts no responsibility, and denies any liability whatsoever, to any party that uses or relies on this drawing without AECOM's express written consent. Do not scale this document. All measurements must be obtained from the stated dimensions.