

ISO A1 594mm x 841mm
Approved: ATz
Checked: MH
Designer: RD
Project Management Initials:
Last saved by: RHYS DANIES(2021-07-15) Last Plotted: 2021-07-20
Filename: F:\PROJECTS\HIGHWAYS - LLANMAES FLOOD ALLEVIATION SCHEMES\0 CADDS\3 DRAWINGS\SERIES 0100 - PRELIM\30 0100 GENERAL ARRANGEMENT\60160078-ACM-SHT-30-0100-CT-01-01-0108.DWG

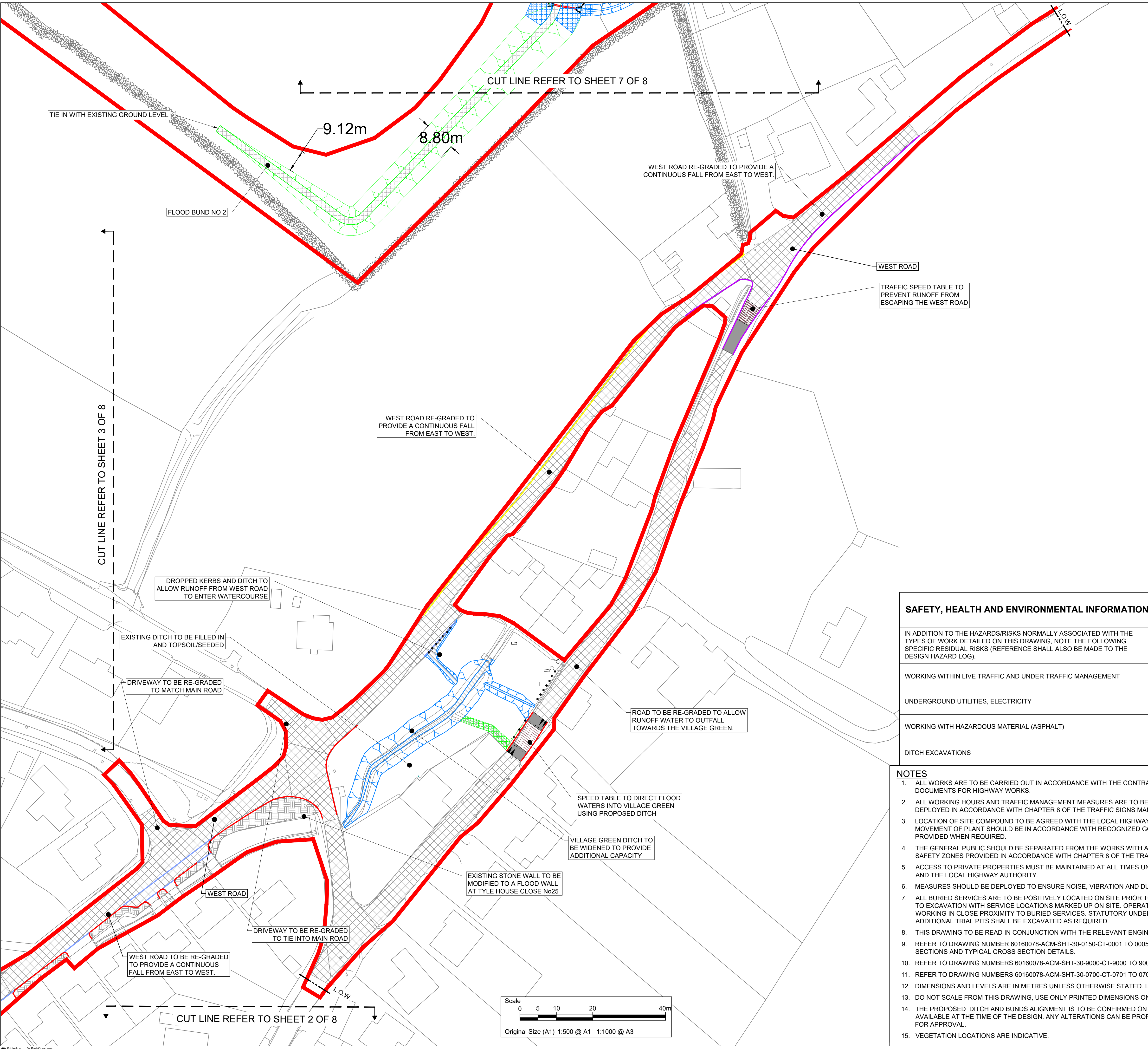

CUT LINE REFER TO SHEET 7 OF 8

CUT LINE REFER TO SHEET 3 OF 8

CUT LINE REFER TO SHEET 2 OF 8

KEY:

- PLANNING APPLICATION BOUNDARY
- PROPOSED BUND
- PROPOSED DITCH
- ROAD TO BE RE-GRADED
- FOOTWAY TO BE RE-GRADED
- PROPOSED CENTER LINE AND CHAINAGE MARKER
- L.O.W.
- LIMIT OF WORK (LOCATION INDICATIVE)
- EXISTING VEGETATION (LOCATION INDICATIVE)
- EXISTING HEDGE (LOCATION INDICATIVE)
- PROPOSED HEDGE
- PROPOSED HALF BATTERED 75mm UPSTAND KERB
- PROPOSED HALF BATTERED 125mm UPSTAND KERB
- PROPOSED BULL NOSED 0mm UPSTAND KERB
- PROPOSED BUS STOP 200mm UPSTAND KERB
- PROPOSED STONE WALL
- PROPOSED GULLY
- PROPOSED CULVERT/HEADWALLS
- PROPOSED EROSION MATTING
- PROPOSED DRAINAGE NETWORK
- PROPOSED FILTER DRAIN
- EXISTING GULLY LOCATION
- PROPOSED FENCE

SAFETY, HEALTH AND ENVIRONMENTAL INFORMATION

- IN ADDITION TO THE HAZARDS/RISKS NORMALLY ASSOCIATED WITH THE TYPES OF WORK DETAILED ON THIS DRAWING, NOTE THE FOLLOWING SPECIFIC RESIDUAL RISKS (REFERENCE SHALL ALSO BE MADE TO THE DESIGN HAZARD LOG).
- WORKING WITHIN LIVE TRAFFIC AND UNDER TRAFFIC MANAGEMENT
- UNDERGROUND UTILITIES, ELECTRICITY
- WORKING WITH HAZARDOUS MATERIAL (ASPHALT)
- DITCH EXCAVATIONS

NOTES

1. ALL WORKS ARE TO BE CARRIED OUT IN ACCORDANCE WITH THE CONTRACT SPECIFICATION AND THE MANUAL OF CONTRACT DOCUMENTS FOR HIGHWAY WORKS.
2. ALL WORKING HOURS AND TRAFFIC MANAGEMENT MEASURES ARE TO BE AGREED WITH THE LOCAL HIGHWAY AUTHORITY AND DEPLOYED IN ACCORDANCE WITH CHAPTER 8 OF THE TRAFFIC SIGNS MANUAL.
3. LOCATION OF SITE COMPOUND TO BE AGREED WITH THE LOCAL HIGHWAY AUTHORITY PRIOR TO WORKS COMMENCING. ALL MOVEMENT OF PLANT SHOULD BE IN ACCORDANCE WITH RECOGNIZED GOOD INDUSTRY PRACTICE. BANKSMEN SHOULD BE PROVIDED WHEN REQUIRED.
4. THE GENERAL PUBLIC SHOULD BE SEPARATED FROM THE WORKS WITH ADEQUATE LATERAL CLEARANCE AND APPROPRIATE SAFETY ZONES PROVIDED IN ACCORDANCE WITH CHAPTER 8 OF THE TRAFFIC SIGNS MANUAL.
5. ACCESS TO PRIVATE PROPERTIES MUST BE MAINTAINED AT ALL TIMES UNLESS OTHERWISE AGREED WITH THE AFFECTED PARTY AND THE LOCAL HIGHWAY AUTHORITY.
6. MEASURES SHOULD BE DEPLOYED TO ENSURE NOISE, VIBRATION AND DUST IS MINIMIZED.
7. ALL BURIED SERVICES ARE TO BE POSITIVELY LOCATED ON SITE PRIOR TO EXCAVATION. CAT SCANS SHALL BE COMPLETED PRIOR TO EXCAVATION WITH SERVICE LOCATIONS MARKED UP ON SITE. OPERATIVES SHALL EMPLOY HAND DIGGING METHODS WHEN WORKING IN CLOSE PROXIMITY TO BURIED SERVICES. STATUTORY UNDERTAKER'S PLANT SHALL BE PROTECTED AS NECESSARY. ADDITIONAL TRIAL PITS SHALL BE EXCAVATED AS REQUIRED.
8. THIS DRAWING IS TO BE READ IN CONJUNCTION WITH THE RELEVANT ENGINEERING DETAILS, DRAWINGS AND SPECIFICATIONS.
9. REFER TO DRAWING NUMBER 60160078-ACM-SHT-30-0150-CT-0001 TO 0005 & 60160078-ACM-SHT-30-0120-CT-0121 TO 0128 FOR LONG SECTIONS AND TYPICAL CROSS SECTION DETAILS.
10. REFER TO DRAWING NUMBERS 60160078-ACM-SHT-30-9000-CT-9000 TO 9005 FOR STANDARD DETAILS.
11. REFER TO DRAWING NUMBERS 60160078-ACM-SHT-30-0700-CT-0701 TO 0708 FOR PAVEMENT DETAILS.
12. DIMENSIONS AND LEVELS ARE IN METRES UNLESS OTHERWISE STATED. LEVELS RELATE TO ORDNANCE DATUM.
13. DO NOT SCALE FROM THIS DRAWING, USE ONLY PRINTED DIMENSIONS ONLY.
14. THE PROPOSED DITCH AND BUNDS ALIGNMENT IS TO BE CONFIRMED ON SITE AND IS BASED ON OS MAP AND LIDAR DATA AVAILABLE AT THE TIME OF THE DESIGN. ANY ALTERATIONS CAN BE PROPOSED TO THE SUPERVISOR AND HIGHWAYS AUTHORITY FOR APPROVAL.
15. VEGETATION LOCATIONS ARE INDICATIVE.

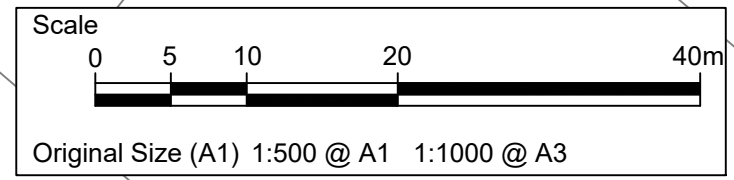

STATUS

DETAILED DESIGN

ISSUE/REVISION

NO	DATE	DESCRIPTION
C	07/07/2021	FOR PRICING
B	26/02/2021	DETAILED DESIGN
A	16/12/2020	DRAFT DETAILED DESIGN

KEY PLAN

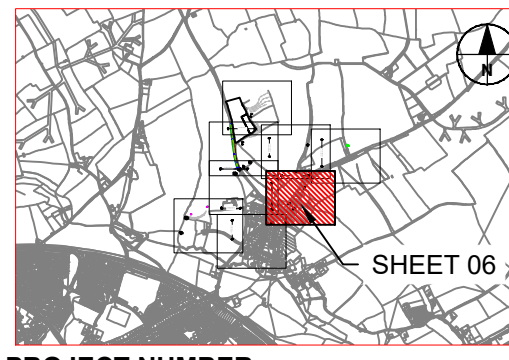

PROJECT NUMBER

60160078

SHEET TITLE

LLANMAES VILLAGE
FLOOD ALLEVIATION SCHEME
GENERAL ARRANGEMENT PLAN
SHEET 6 OF 8

SHEET NUMBER

60160078-ACM-SHT-30-0100-CT-0106