

Town and Country Planning (Development Management Procedure) (Wales) Order 2012 NOTICE UNDER ARTICLE 10 APPLICATION FOR PLANNING PERMISSION

(Notice 1: This notice is to be printed and served on individuals if Certificate B or C is completed)

Proposed development at:

Name or flat number	<input type="text"/>
Property number or name	<input type="text"/>
Street	<input type="text"/>
Locality	<input type="text"/>
Town	<input type="text"/>
County	<input type="text"/>
Postal town	<input type="text"/>
Postcode	<input type="text"/>

Take notice that application is being made by:

Organisation name	<input type="text"/>		
Applicant name	Title	Forename	<input type="text"/>
	Surname	<input type="text"/>	

For planning permission to:

Description of proposed development

Local Planning Authority to whom the application is being submitted:

Local Planning Authority address:

Any owner of the land or tenant who wishes to make representations about this application, should write to the council within 21 days of the date of this notice.

Signatory:

Signatory	Title	Forename	<input type="text"/>
	Surname	<input type="text"/>	

Signature

Date (dd-mm-yyyy)

Statement of owners' rights: The grant of planning permission does not affect owners' rights to retain or dispose of their property, unless there is some provision to the contrary in an agreement or lease.

Statement of agricultural tenants' rights: The grant of planning permission for non-agricultural development may affect agricultural tenants' security of tenure.

'Owner' means a person having a freehold interest or a leasehold interest the unexpired term of which is not less than seven years.

'Tenant' means a tenant of an agricultural holding any part of which is comprised in the land.

Once completed this form needs to be served on the owner(s) or tenant(s)

ISO A1 594mm x 841mm
Approved: RM
Checked: ATZ
Designer: RD
Project Management Initials:
Last saved by: RHYS DAVIES(2021-07-07) Last Plotted: 2021-07-07
Filename: P:\PROJECTS\HIGHWAY 5 - LLANMAES FLOOD ALLEVIATION SCHEME\5.0 CADD\5.0 DRAWINGS\SERIES 0000 - INTRO\30 0000 GENERAL\60160078-ACM-SHT-30-0000-CT-0001 (RD VERSION).DWG

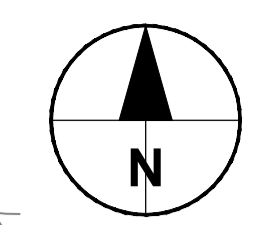

PROJECT
**LLANMAES VILLAGE
FLOOD ALLEVIATION
SCHEME**

CLIENT
VALE OF GLAMORGAN COUNCIL



CONSULTANT
AECOM
1 CALLAGHAN SQUARE
CARDIFF
CF10 5BT
TEL: (029) 20674600
FAX: (029) 20674699

- NOTES
1. TO BE READ IN CONJUNCTION WITH ALL OTHER RELEVANT DOCUMENTATION / INFORMATION.
 2. ALL LEVELS RELATE TO ORDNANCE DATUM.
 3. DO NOT SCALE FROM THIS DRAWING. USE PRINTED DIMENSIONS ONLY.

LEGEND

01	SHEET LAYOUT AND NUMBER
----	-------------------------

STATUS

DETAILED DESIGN

ISSUE/REVISION

IR	DATE	DESCRIPTION
C	07/07/2021	FOR PRICING
B	26/02/2021	DETAILED DESIGN
A	16/12/2020	DRAFT DETAILED DESIGN

PROJECT NUMBER
60160078
SHEET TITLE
LLANMAES VILLAGE
FLOOD ALLEVIATION SCHEME
LOCATION PLAN
SCALE: 1:2500
SHEET NUMBER
60160078-ACM-SHT-30-0000-CT-0001

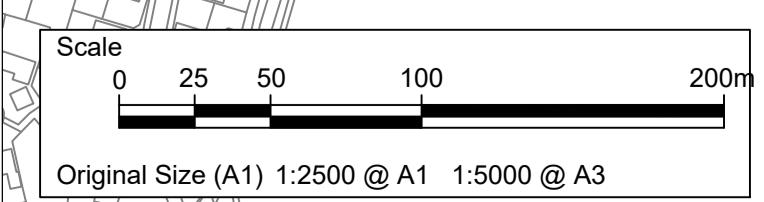
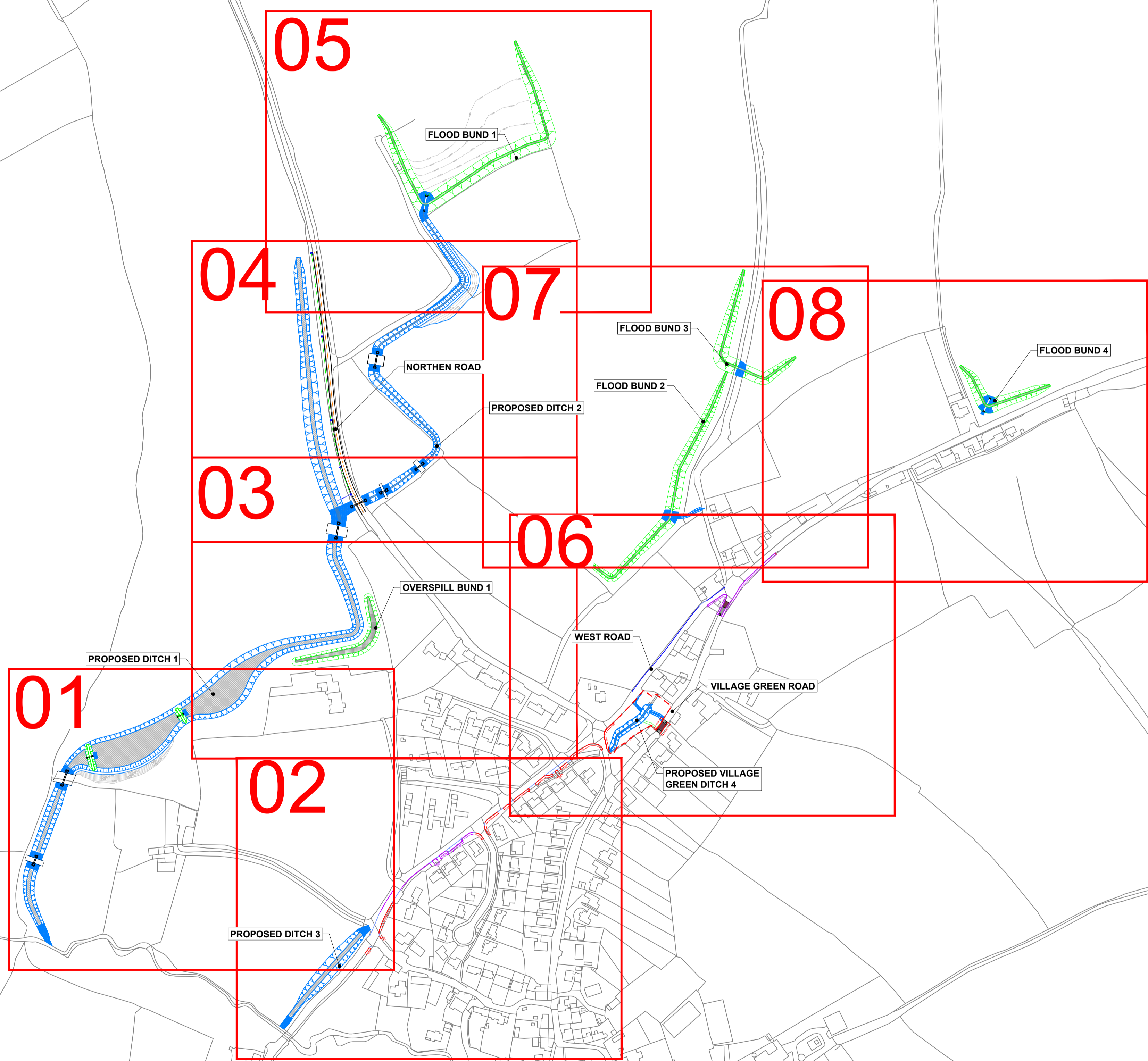



Project Management Initials: Designer: RD Checked: MH Approved: ATZ
Last saved by: RHYS DAVIES(2021-07-15) Last Plotted: 2021-07-20
Filename: F:\PROJECTS\HIGHWAYS - LLANMAES FLOOD ALLEVIATION SCHEMES\0 CADDS\3 DRAWINGS\SERIES 0100 - PRELIM\30 0100 GENERAL ARRANGEMENT\60160078-ACM-SHT-30-0100-CT-01-01-0108.DWG

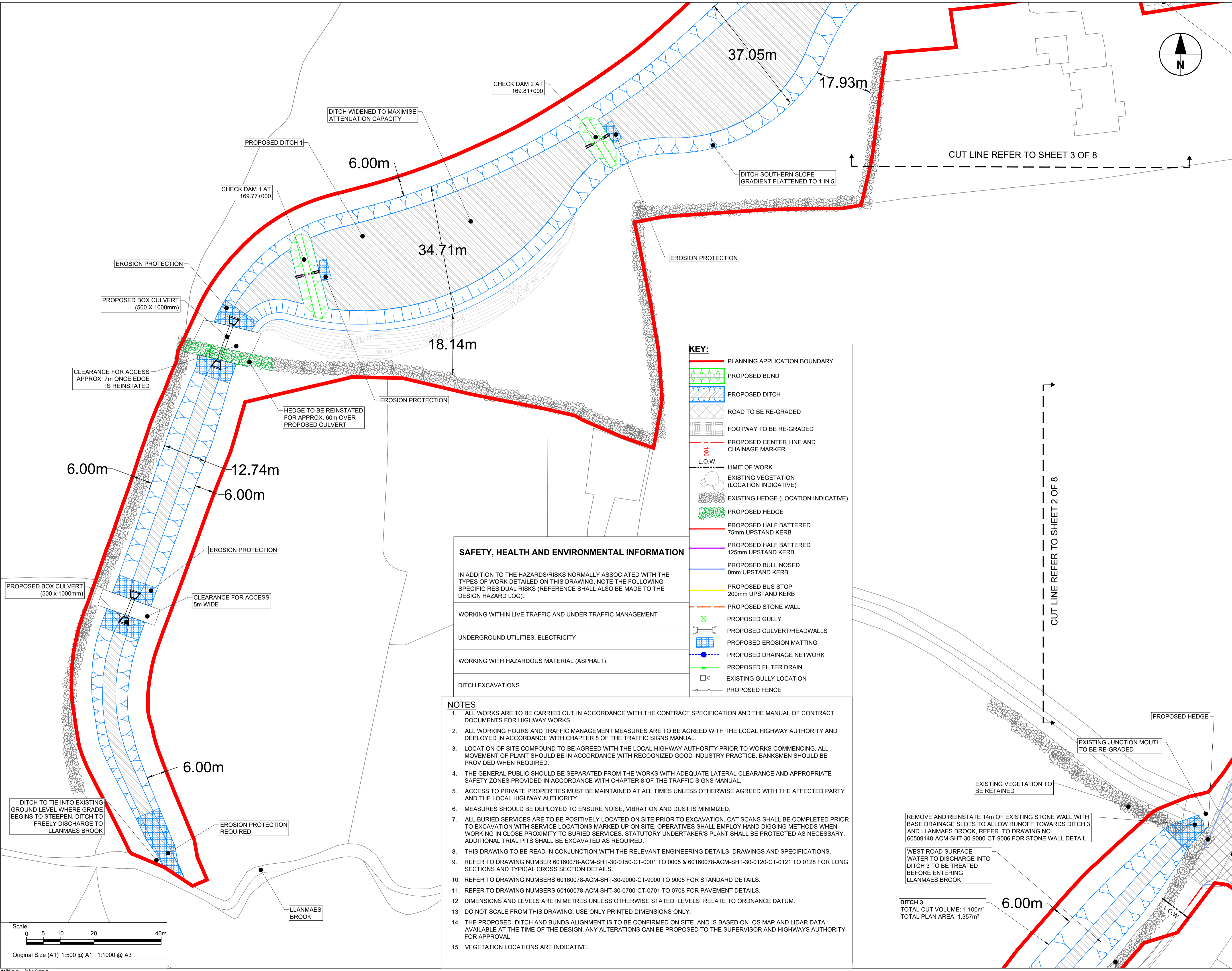

KEY:

- PLANNING APPLICATION BOUNDARY
- PROPOSED BUND
- PROPOSED DITCH
- ROAD TO BE RE-GRADED
- FOOTWAY TO BE RE-GRADED
- PROPOSED CENTER LINE AND CHAINAGE MARKER
- L.O.W. LIMIT OF WORK
- EXISTING VEGETATION (LOCATION INDICATIVE)
- EXISTING HEDGE (LOCATION INDICATIVE)
- PROPOSED HEDGE
- PROPOSED HALF BATTERED 75mm UPSTAND KERB
- PROPOSED HALF BATTERED 125mm UPSTAND KERB
- PROPOSED BULL NOSED 0mm UPSTAND KERB
- PROPOSED BUS STOP 200mm UPSTAND KERB
- PROPOSED STONE WALL
- PROPOSED GULLY
- PROPOSED CULVERT/HEADWALLS
- PROPOSED EROSION MATTING
- PROPOSED DRAINAGE NETWORK
- PROPOSED FILTER DRAIN
- EXISTING GULLY LOCATION
- PROPOSED FENCE

SAFETY, HEALTH AND ENVIRONMENTAL INFORMATION

- IN ADDITION TO THE HAZARDS/RISKS NORMALLY ASSOCIATED WITH THE TYPES OF WORK DETAILED ON THIS DRAWING, NOTE THE FOLLOWING SPECIFIC RESIDUAL RISKS (REFERENCE SHALL ALSO BE MADE TO THE DESIGN HAZARD LOG).
- WORKING WITHIN LIVE TRAFFIC AND UNDER TRAFFIC MANAGEMENT
- UNDERGROUND UTILITIES, ELECTRICITY
- WORKING WITH HAZARDOUS MATERIAL (ASPHALT)
- DITCH EXCAVATIONS

NOTES

- ALL WORKS ARE TO BE CARRIED OUT IN ACCORDANCE WITH THE CONTRACT SPECIFICATION AND THE MANUAL OF CONTRACT DOCUMENTS FOR HIGHWAY WORKS.
- ALL WORKING HOURS AND TRAFFIC MANAGEMENT MEASURES ARE TO BE AGREED WITH THE LOCAL HIGHWAY AUTHORITY AND DEPLOYED IN ACCORDANCE WITH CHAPTER 8 OF THE TRAFFIC SIGNS MANUAL.
- LOCATION OF SITE COMPOUND TO BE AGREED WITH THE LOCAL HIGHWAY AUTHORITY PRIOR TO WORKS COMMENCING. ALL MOVEMENT OF PLANT SHOULD BE IN ACCORDANCE WITH RECOGNIZED GOOD INDUSTRY PRACTICE. BANKSMEN SHOULD BE PROVIDED WHEN REQUIRED.
- THE GENERAL PUBLIC SHOULD BE SEPARATED FROM THE WORKS WITH ADEQUATE LATERAL CLEARANCE AND APPROPRIATE SAFETY ZONES PROVIDED IN ACCORDANCE WITH CHAPTER 8 OF THE TRAFFIC SIGNS MANUAL.
- ACCESS TO PRIVATE PROPERTIES MUST BE MAINTAINED AT ALL TIMES UNLESS OTHERWISE AGREED WITH THE AFFECTED PARTY AND THE LOCAL HIGHWAY AUTHORITY.
- MEASURES SHOULD BE DEPLOYED TO ENSURE NOISE, VIBRATION AND DUST IS MINIMIZED.
- ALL BURIED SERVICES ARE TO BE POSITIVELY LOCATED ON SITE PRIOR TO EXCAVATION. CAT SCANS SHALL BE COMPLETED PRIOR TO EXCAVATION WITH SERVICE LOCATIONS MARKED UP ON SITE. OPERATIVES SHALL EMPLOY HAND DIGGING METHODS WHEN WORKING IN CLOSE PROXIMITY TO BURIED SERVICES. STATUTORY UNDERTAKER'S PLANT SHALL BE PROTECTED AS NECESSARY. ADDITIONAL TRIAL PITS SHALL BE EXCAVATED AS REQUIRED.
- THIS DRAWING TO BE READ IN CONJUNCTION WITH THE RELEVANT ENGINEERING DETAILS, DRAWINGS AND SPECIFICATIONS.
- REFER TO DRAWING NUMBER 60160078-ACM-SHT-30-0150-CT-0001 TO 0005 & 60160078-ACM-SHT-30-0120-CT-0121 TO 0128 FOR LONG SECTIONS AND TYPICAL CROSS SECTION DETAILS.
- REFER TO DRAWING NUMBERS 60160078-ACM-SHT-30-9000-CT-9000 TO 9005 FOR STANDARD DETAILS.
- REFER TO DRAWING NUMBERS 60160078-ACM-SHT-30-0700-CT-0701 TO 0708 FOR PAVEMENT DETAILS.
- DIMENSIONS AND LEVELS ARE IN METRES UNLESS OTHERWISE STATED. LEVELS RELATE TO ORDNANCE DATUM.
- DO NOT SCALE FROM THIS DRAWING, USE ONLY PRINTED DIMENSIONS ONLY.
- THE PROPOSED DITCH AND BUNDS ALIGNMENT IS TO BE CONFIRMED ON SITE AND IS BASED ON OS MAP AND LIDAR DATA AVAILABLE AT THE TIME OF THE DESIGN. ANY ALTERATIONS CAN BE PROPOSED TO THE SUPERVISOR AND HIGHWAYS AUTHORITY FOR APPROVAL.
- VEGETATION LOCATIONS ARE INDICATIVE.

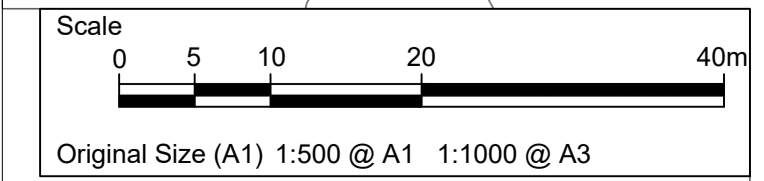

STATUS
DETAILED DESIGN

ISSUE/REVISION

NO	DATE	DESCRIPTION
C	07/07/2021	FOR PRICING
B	26/02/2021	DETAILED DESIGN
A	16/12/2020	DRAFT DETAILED DESIGN

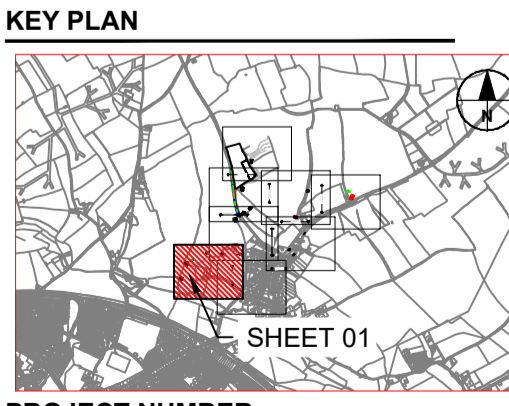

PROJECT NUMBER
60160078

SHEET TITLE
LLANMAES VILLAGE
FLOOD ALLEVIATION SCHEME
GENERAL ARRANGEMENT PLAN
SHEET 1 OF 8

SHEET NUMBER
60160078-ACM-SHT-30-0100-CT-0101

This drawing has been prepared for the use of AECOM's client. It may not be used, modified, reproduced or relied upon by third parties, except as agreed by AECOM or as required by law. AECOM accepts no responsibility, and denies any liability whatsoever, to any party that uses or relies on this drawing without AECOM's express written consent. Do not scale this document. All measurements must be obtained from the stated dimensions.



Project Management Initials: Designer: RD Checked: MH Approved: ATz

ISO A1 594mm x 841mm
Last saved by: RHYSDAVIES2(2021-07-15) Last Plotted: 2021-07-20
Filename: F:\PROJECTS\HIGHWAYS - LLANMAES FLOOD ALLEVIATION SCHEMES\0 CADDS\3 DRAWINGS\SERIES 0100 - PRELIM\30 0100 GENERAL ARRANGEMENT\60160078-ACM-SHT-30-0100-CT-01-01-0108.DWG

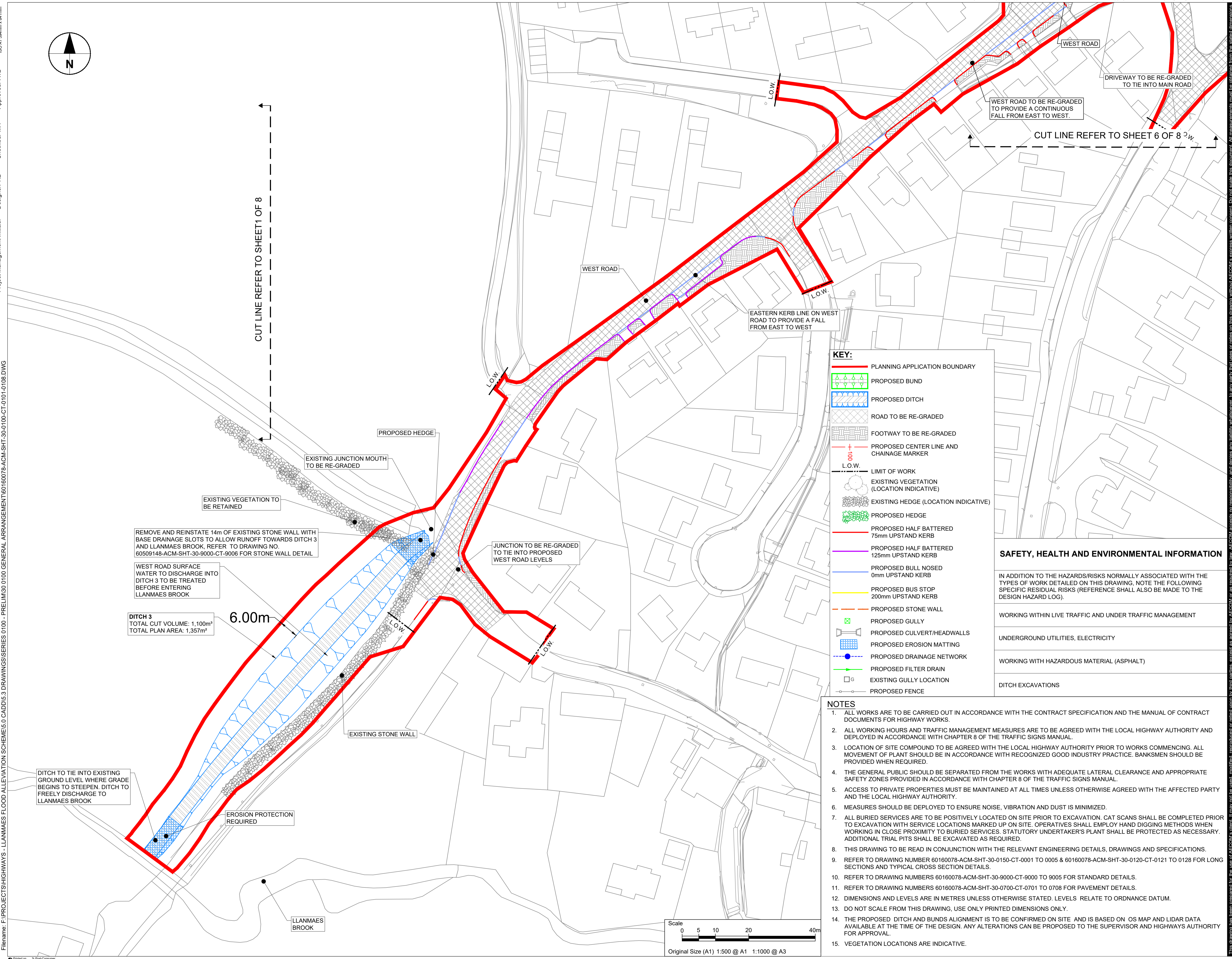
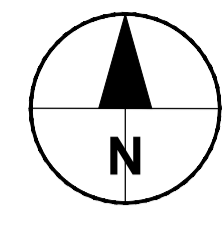

REMOVE AND REINSTATE 14m OF EXISTING STONE WALL WITH BASE DRAINAGE SLOTS TO ALLOW RUNOFF TOWARDS DITCH 3 AND LLANMAES BROOK. REFER TO DRAWING NO. 60509148-ACM-SHT-30-9000-CT-9006 FOR STONE WALL DETAIL

WEST ROAD SURFACE WATER TO DISCHARGE INTO DITCH 3 TO BE TREATED BEFORE ENTERING LLANMAES BROOK

DITCH 3
TOTAL CUT VOLUME: 1,100m³
TOTAL PLAN AREA: 1,357m²

6.00m

EXISTING VEGETATION TO BE RETAINED

EXISTING JUNCTION MOUTH TO BE RE-GRADED

PROPOSED HEDGE

JUNCTION TO BE RE-GRADED TO TIE INTO PROPOSED WEST ROAD LEVELS

EXISTING STONE WALL

EROSION PROTECTION REQUIRED

LLANMAES BROOK

KEY:

- PLANNING APPLICATION BOUNDARY
- PROPOSED BUND
- PROPOSED DITCH
- ROAD TO BE RE-GRADED
- FOOTWAY TO BE RE-GRADED
- PROPOSED CENTER LINE AND CHAINAGE MARKER
- L.O.W. LIMIT OF WORK
- EXISTING VEGETATION (LOCATION INDICATIVE)
- EXISTING HEDGE (LOCATION INDICATIVE)
- PROPOSED HEDGE
- PROPOSED HALF BATTERED 75mm UPSTAND KERB
- PROPOSED HALF BATTERED 125mm UPSTAND KERB
- PROPOSED BULL NOSED 0mm UPSTAND KERB
- PROPOSED BUS STOP 200mm UPSTAND KERB
- PROPOSED STONE WALL
- PROPOSED GULLY
- PROPOSED CULVERT/HEADWALLS
- PROPOSED EROSION MATTING
- PROPOSED DRAINAGE NETWORK
- PROPOSED FILTER DRAIN
- EXISTING GULLY LOCATION
- PROPOSED FENCE

SAFETY, HEALTH AND ENVIRONMENTAL INFORMATION

IN ADDITION TO THE HAZARDS/RISKS NORMALLY ASSOCIATED WITH THE TYPES OF WORK DETAILED ON THIS DRAWING, NOTE THE FOLLOWING SPECIFIC RESIDUAL RISKS (REFERENCE SHALL ALSO BE MADE TO THE DESIGN HAZARD LOG).

WORKING WITHIN LIVE TRAFFIC AND UNDER TRAFFIC MANAGEMENT

UNDERGROUND UTILITIES, ELECTRICITY

WORKING WITH HAZARDOUS MATERIAL (ASPHALT)

DITCH EXCAVATIONS

- NOTES**
- ALL WORKS ARE TO BE CARRIED OUT IN ACCORDANCE WITH THE CONTRACT SPECIFICATION AND THE MANUAL OF CONTRACT DOCUMENTS FOR HIGHWAY WORKS.
 - ALL WORKING HOURS AND TRAFFIC MANAGEMENT MEASURES ARE TO BE AGREED WITH THE LOCAL HIGHWAY AUTHORITY AND DEPLOYED IN ACCORDANCE WITH CHAPTER 8 OF THE TRAFFIC SIGNS MANUAL.
 - LOCATION OF SITE COMPOUND TO BE AGREED WITH THE LOCAL HIGHWAY AUTHORITY PRIOR TO WORKS COMMENCING. ALL MOVEMENT OF PLANT SHOULD BE IN ACCORDANCE WITH RECOGNIZED GOOD INDUSTRY PRACTICE. BANKSMEN SHOULD BE PROVIDED WHEN REQUIRED.
 - THE GENERAL PUBLIC SHOULD BE SEPARATED FROM THE WORKS WITH ADEQUATE LATERAL CLEARANCE AND APPROPRIATE SAFETY ZONES PROVIDED IN ACCORDANCE WITH CHAPTER 8 OF THE TRAFFIC SIGNS MANUAL.
 - ACCESS TO PRIVATE PROPERTIES MUST BE MAINTAINED AT ALL TIMES UNLESS OTHERWISE AGREED WITH THE AFFECTED PARTY AND THE LOCAL HIGHWAY AUTHORITY.
 - MEASURES SHOULD BE DEPLOYED TO ENSURE NOISE, VIBRATION AND DUST IS MINIMIZED.
 - ALL BURIED SERVICES ARE TO BE POSITIVELY LOCATED ON SITE PRIOR TO EXCAVATION. CAT SCANS SHALL BE COMPLETED PRIOR TO EXCAVATION WITH SERVICE LOCATIONS MARKED UP ON SITE. OPERATIVES SHALL EMPLOY HAND DIGGING METHODS WHEN WORKING IN CLOSE PROXIMITY TO BURIED SERVICES. STATUTORY UNDERTAKERS PLANT SHALL BE PROTECTED AS NECESSARY. ADDITIONAL TRIAL PITS SHALL BE EXCAVATED AS REQUIRED.
 - THIS DRAWING TO BE READ IN CONJUNCTION WITH THE RELEVANT ENGINEERING DETAILS, DRAWINGS AND SPECIFICATIONS.
 - REFER TO DRAWING NUMBER 60160078-ACM-SHT-30-0150-CT-0001 TO 0005 & 60160078-ACM-SHT-30-0120-CT-0121 TO 0128 FOR LONG SECTIONS AND TYPICAL CROSS SECTION DETAILS.
 - REFER TO DRAWING NUMBERS 60160078-ACM-SHT-30-9000-CT-9000 TO 9005 FOR STANDARD DETAILS.
 - REFER TO DRAWING NUMBERS 60160078-ACM-SHT-30-0700-CT-0701 TO 0708 FOR PAVEMENT DETAILS.
 - DIMENSIONS AND LEVELS ARE IN METRES UNLESS OTHERWISE STATED. LEVELS RELATE TO ORDNANCE DATUM.
 - DO NOT SCALE FROM THIS DRAWING. USE ONLY PRINTED DIMENSIONS ONLY.
 - THE PROPOSED DITCH AND BUNDS ALIGNMENT IS TO BE CONFIRMED ON SITE AND IS BASED ON OS MAP AND LIDAR DATA AVAILABLE AT THE TIME OF THE DESIGN. ANY ALTERATIONS CAN BE PROPOSED TO THE SUPERVISOR AND HIGHWAYS AUTHORITY FOR APPROVAL.
 - VEGETATION LOCATIONS ARE INDICATIVE.

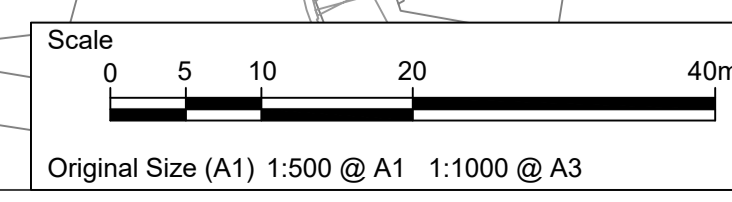

STATUS
DETAILED DESIGN

ISSUE/REVISION

NO	DATE	DESCRIPTION
C	07/07/2021	FOR PRICING
B	26/02/2021	DETAILED DESIGN
A	16/12/2020	DRAFT DETAILED DESIGN
IR		

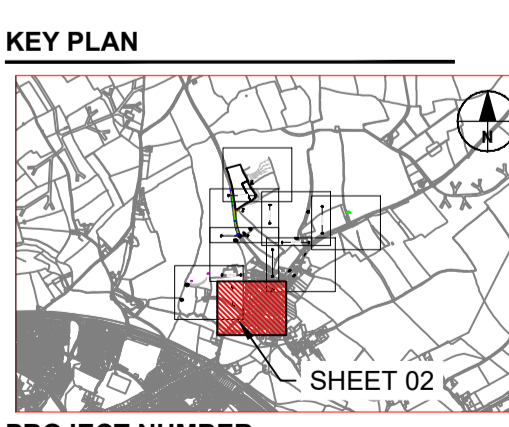

PROJECT NUMBER
60160078

SHEET TITLE
LLANMAES VILLAGE
FLOOD ALLEVIATION SCHEME
GENERAL ARRANGEMENT PLAN
SHEET 2 OF 8

SHEET NUMBER
60160078-ACM-SHT-30-0100-CT-0102

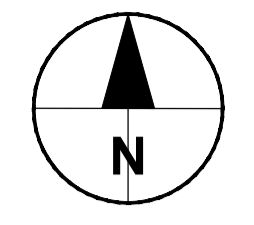
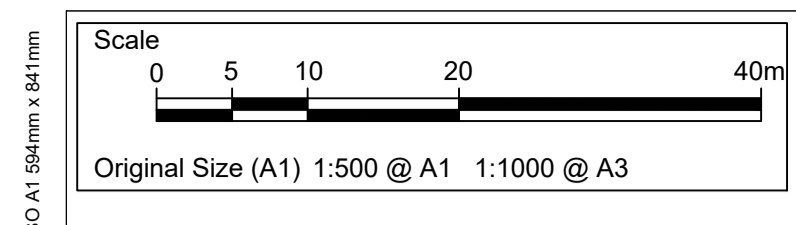

Approved: ATZ
Checked: MH
Designer: RD
Project Management Initials:

File name: F:\PROJECTS\HIGHWAYS - LLANMAES FLOOD ALLEVIATION SCHEMES\0 CADD\5.3 DRAWINGS\SERIES 0100 - PRELIM\30 0100 GENERAL ARRANGEMENT\60160078-ACM-SHT-30-0100-CT-01-01-0108.DWG
Last saved by: RHYS DAVIES(2021-07-15) Last Plotted: 2021-07-20

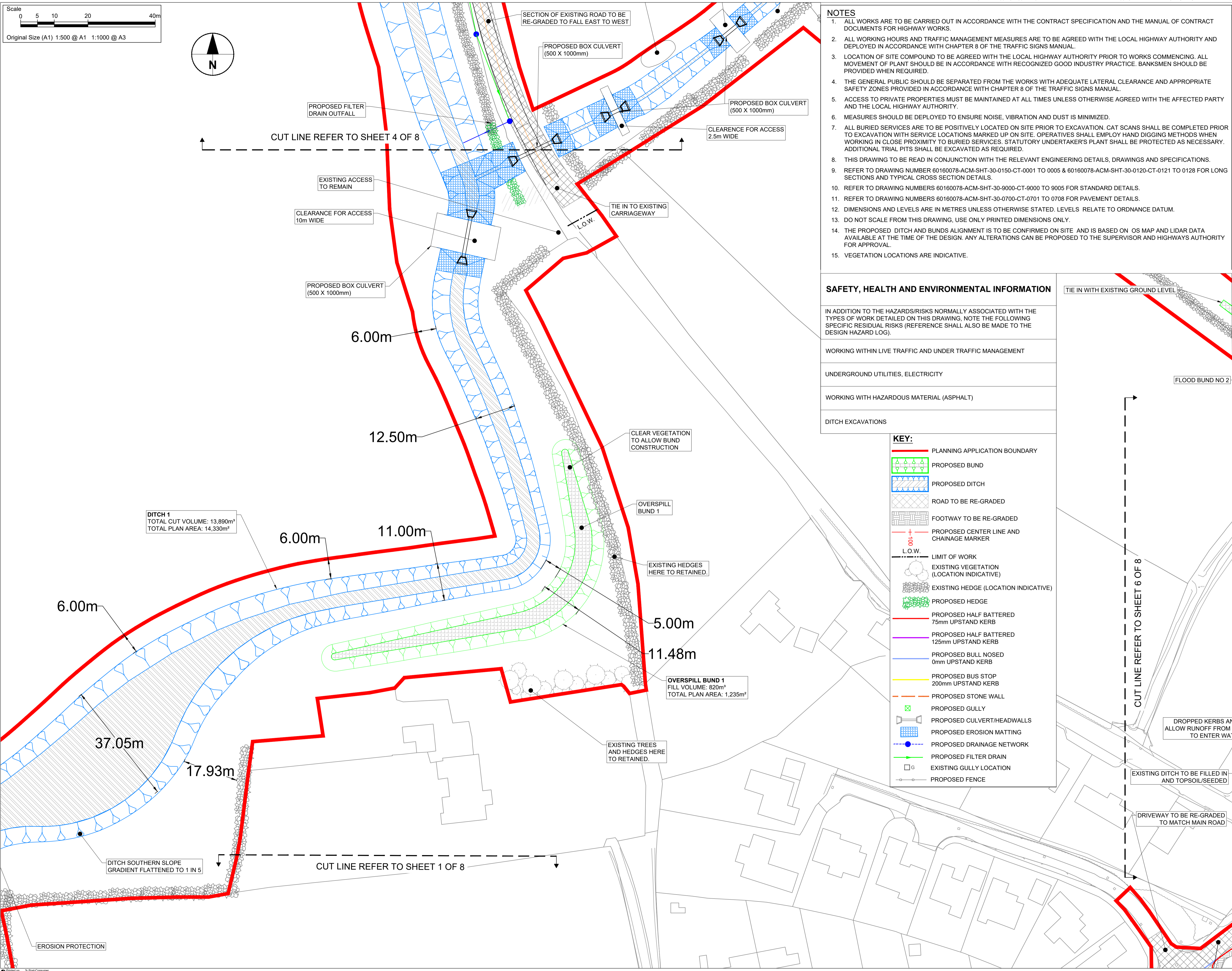

- ### NOTES
- ALL WORKS ARE TO BE CARRIED OUT IN ACCORDANCE WITH THE CONTRACT SPECIFICATION AND THE MANUAL OF CONTRACT DOCUMENTS FOR HIGHWAY WORKS.
 - ALL WORKING HOURS AND TRAFFIC MANAGEMENT MEASURES ARE TO BE AGREED WITH THE LOCAL HIGHWAY AUTHORITY AND DEPLOYED IN ACCORDANCE WITH CHAPTER 8 OF THE TRAFFIC SIGNS MANUAL.
 - LOCATION OF SITE COMPOUND TO BE AGREED WITH THE LOCAL HIGHWAY AUTHORITY PRIOR TO WORKS COMMENCING. ALL MOVEMENT OF PLANT SHOULD BE IN ACCORDANCE WITH RECOGNIZED GOOD INDUSTRY PRACTICE. BANKSMEN SHOULD BE PROVIDED WHEN REQUIRED.
 - THE GENERAL PUBLIC SHOULD BE SEPARATED FROM THE WORKS WITH ADEQUATE LATERAL CLEARANCE AND APPROPRIATE SAFETY ZONES PROVIDED IN ACCORDANCE WITH CHAPTER 8 OF THE TRAFFIC SIGNS MANUAL.
 - ACCESS TO PRIVATE PROPERTIES MUST BE MAINTAINED AT ALL TIMES UNLESS OTHERWISE AGREED WITH THE AFFECTED PARTY AND THE LOCAL HIGHWAY AUTHORITY.
 - MEASURES SHOULD BE DEPLOYED TO ENSURE NOISE, VIBRATION AND DUST IS MINIMIZED.
 - ALL BURIED SERVICES ARE TO BE POSITIVELY LOCATED ON SITE PRIOR TO EXCAVATION. CAT SCANS SHALL BE COMPLETED PRIOR TO EXCAVATION WITH SERVICE LOCATIONS MARKED UP ON SITE. OPERATIVES SHALL EMPLOY HAND DIGGING METHODS WHEN WORKING IN CLOSE PROXIMITY TO BURIED SERVICES. STATUTORY UNDERTAKER'S PLANT SHALL BE PROTECTED AS NECESSARY. ADDITIONAL TRIAL PITS SHALL BE EXCAVATED AS REQUIRED.
 - THIS DRAWING TO BE READ IN CONJUNCTION WITH THE RELEVANT ENGINEERING DETAILS, DRAWINGS AND SPECIFICATIONS.
 - REFER TO DRAWING NUMBER 60160078-ACM-SHT-30-0150-CT-0001 TO 0005 & 60160078-ACM-SHT-30-0120-CT-0121 TO 0128 FOR LONG SECTIONS AND TYPICAL CROSS SECTION DETAILS.
 - REFER TO DRAWING NUMBERS 60160078-ACM-SHT-30-9000-CT-9000 TO 9005 FOR STANDARD DETAILS.
 - REFER TO DRAWING NUMBERS 60160078-ACM-SHT-30-0700-CT-0701 TO 0708 FOR PAVEMENT DETAILS.
 - DIMENSIONS AND LEVELS ARE IN METRES UNLESS OTHERWISE STATED. LEVELS RELATE TO ORDNANCE DATUM.
 - DO NOT SCALE FROM THIS DRAWING. USE ONLY PRINTED DIMENSIONS ONLY.
 - THE PROPOSED DITCH AND BUNDS ALIGNMENT IS TO BE CONFIRMED ON SITE AND IS BASED ON OS MAP AND LIDAR DATA AVAILABLE AT THE TIME OF THE DESIGN. ANY ALTERATIONS CAN BE PROPOSED TO THE SUPERVISOR AND HIGHWAYS AUTHORITY FOR APPROVAL.
 - VEGETATION LOCATIONS ARE INDICATIVE.

SAFETY, HEALTH AND ENVIRONMENTAL INFORMATION

- IN ADDITION TO THE HAZARDS/RISKS NORMALLY ASSOCIATED WITH THE TYPES OF WORK DETAILED ON THIS DRAWING, NOTE THE FOLLOWING SPECIFIC RESIDUAL RISKS (REFERENCE SHALL ALSO BE MADE TO THE DESIGN HAZARD LOG).
- WORKING WITHIN LIVE TRAFFIC AND UNDER TRAFFIC MANAGEMENT
 - UNDERGROUND UTILITIES, ELECTRICITY
 - WORKING WITH HAZARDOUS MATERIAL (ASPHALT)
 - DITCH EXCAVATIONS

KEY:

- PLANNING APPLICATION BOUNDARY
- PROPOSED BUND
- PROPOSED DITCH
- ROAD TO BE RE-GRADED
- FOOTWAY TO BE RE-GRADED
- PROPOSED CENTER LINE AND CHAINAGE MARKER
- L.O.W.
- LIMIT OF WORK
- EXISTING VEGETATION (LOCATION INDICATIVE)
- EXISTING HEDGE (LOCATION INDICATIVE)
- PROPOSED HEDGE
- PROPOSED HALF BATTERED 75mm UPSTAND KERB
- PROPOSED HALF BATTERED 125mm UPSTAND KERB
- PROPOSED BULL NOSED 0mm UPSTAND KERB
- PROPOSED BUS STOP 200mm UPSTAND KERB
- PROPOSED STONE WALL
- PROPOSED GULLY
- PROPOSED CULVERT/HEADWALLS
- PROPOSED EROSION MATTING
- PROPOSED DRAINAGE NETWORK
- PROPOSED FILTER DRAIN
- EXISTING GULLY LOCATION
- PROPOSED FENCE

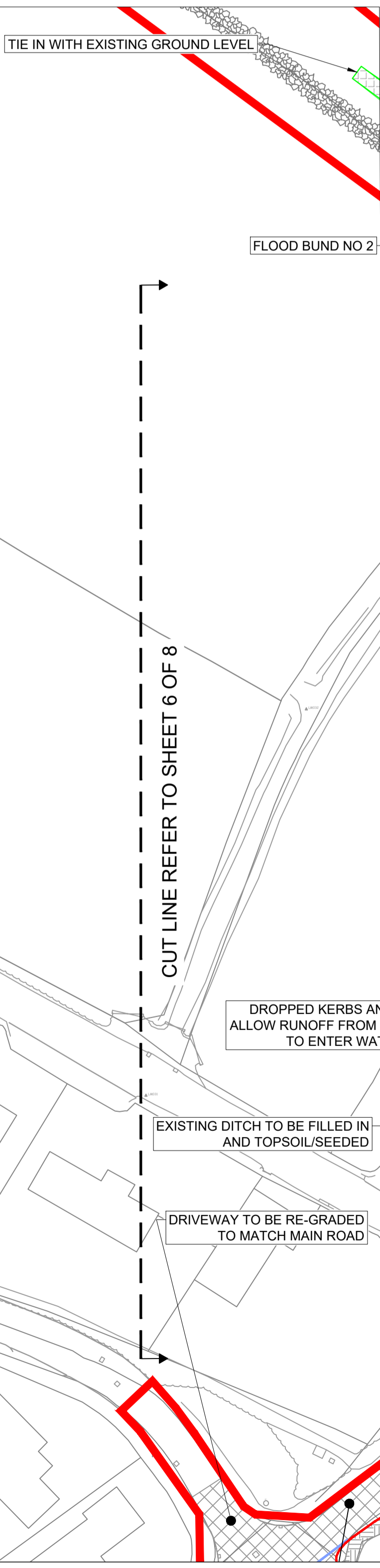

STATUS DETAILED DESIGN

ISSUE/REVISION	DATE	DESCRIPTION
C	07/07/2021	FOR PRICING
B	26/02/2021	DETAILED DESIGN
A	16/12/2020	DRAFT DETAILED DESIGN
IR		

KEY PLAN

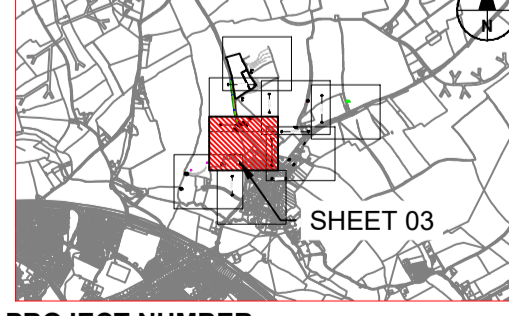

PROJECT NUMBER
60160078

SHEET TITLE
LLANMAES VILLAGE
FLOOD ALLEVIATION SCHEME
GENERAL ARRANGEMENT PLAN
SHEET 3 OF 8

SHEET NUMBER
60160078-ACM-SHT-30-0100-CT-0103

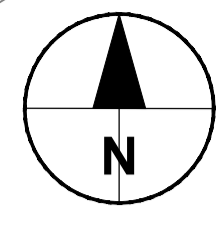

SAFETY, HEALTH AND ENVIRONMENTAL INFORMATION

IN ADDITION TO THE HAZARDS/RISKS NORMALLY ASSOCIATED WITH THE TYPES OF WORK DETAILED ON THIS DRAWING, NOTE THE FOLLOWING SPECIFIC RESIDUAL RISKS (REFERENCE SHALL ALSO BE MADE TO THE DESIGN HAZARD LOG).

WORKING WITHIN LIVE TRAFFIC AND UNDER TRAFFIC MANAGEMENT

UNDERGROUND UTILITIES, ELECTRICITY

WORKING WITH HAZARDOUS MATERIAL (ASPHALT)

DITCH EXCAVATIONS

- KEY:**
- PLANNING APPLICATION BOUNDARY
 - PROPOSED BUND
 - PROPOSED DITCH
 - ROAD TO BE RE-GRADED
 - FOOTWAY TO BE RE-GRADED
 - PROPOSED CENTER LINE AND CHAINAGE MARKER
 - L.O.W.
 - LIMIT OF WORK
 - EXISTING VEGETATION (LOCATION INDICATIVE)
 - EXISTING HEDGE (LOCATION INDICATIVE)
 - PROPOSED HEDGE
 - PROPOSED HALF BATTERED 75mm UPSTAND KERB
 - PROPOSED HALF BATTERED 125mm UPSTAND KERB
 - PROPOSED BULL NOSED 0mm UPSTAND KERB
 - PROPOSED BUS STOP 200mm UPSTAND KERB
 - PROPOSED STONE WALL
 - PROPOSED GULLY
 - PROPOSED CULVERT/HEADWALLS
 - PROPOSED EROSION MATTING
 - PROPOSED DRAINAGE NETWORK
 - PROPOSED FILTER DRAIN
 - EXISTING GULLY LOCATION
 - PROPOSED FENCE

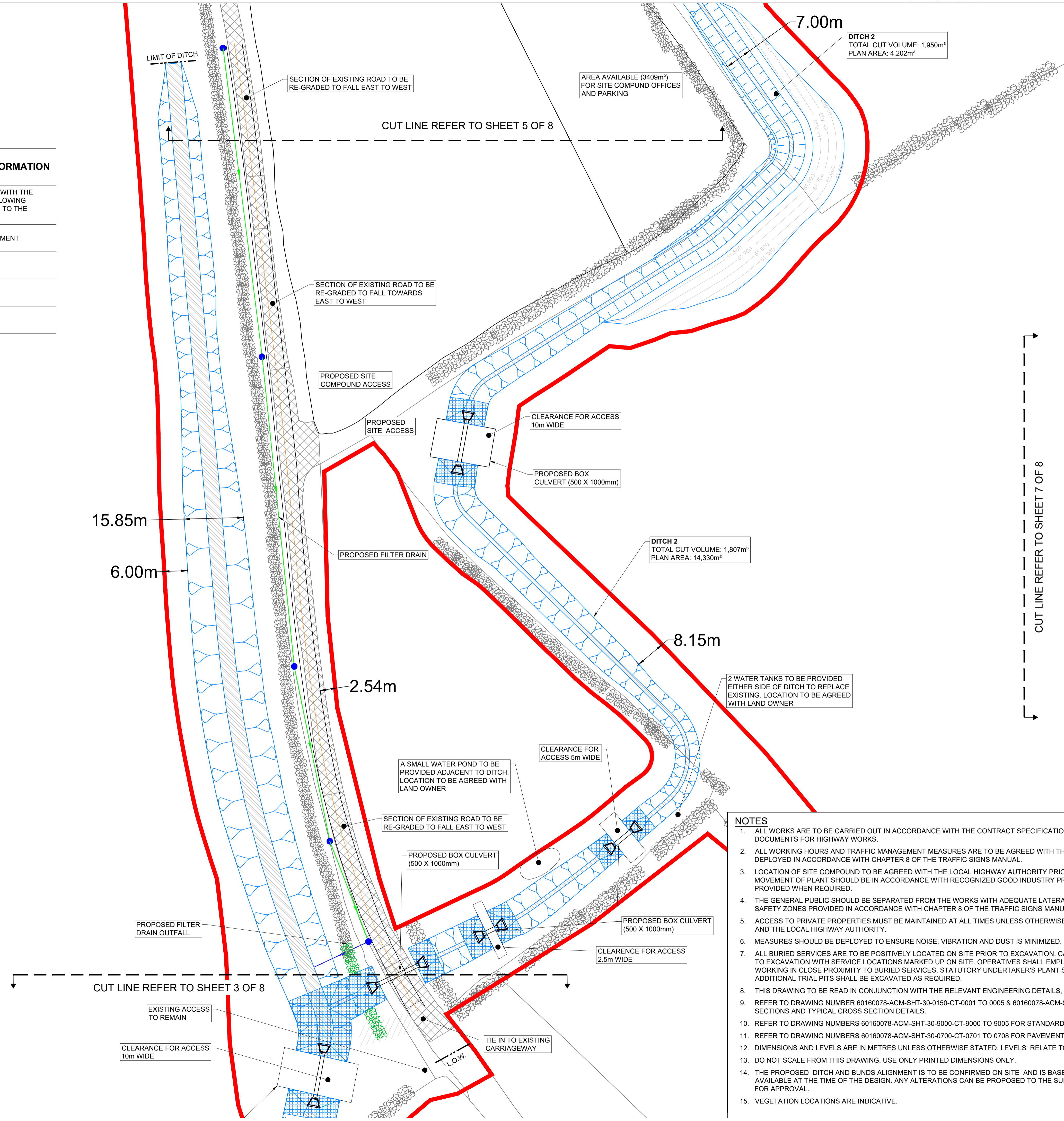

- NOTES**
- ALL WORKS ARE TO BE CARRIED OUT IN ACCORDANCE WITH THE CONTRACT SPECIFICATION AND THE MANUAL OF CONTRACT DOCUMENTS FOR HIGHWAY WORKS.
 - ALL WORKING HOURS AND TRAFFIC MANAGEMENT MEASURES ARE TO BE AGREED WITH THE LOCAL HIGHWAY AUTHORITY AND DEPLOYED IN ACCORDANCE WITH CHAPTER 8 OF THE TRAFFIC SIGNS MANUAL.
 - LOCATION OF SITE COMPOUND TO BE AGREED WITH THE LOCAL HIGHWAY AUTHORITY PRIOR TO WORKS COMMENCING. ALL MOVEMENT OF PLANT SHOULD BE IN ACCORDANCE WITH RECOGNIZED GOOD INDUSTRY PRACTICE. BANKSMEN SHOULD BE PROVIDED WHEN REQUIRED.
 - THE GENERAL PUBLIC SHOULD BE SEPARATED FROM THE WORKS WITH ADEQUATE LATERAL CLEARANCE AND APPROPRIATE SAFETY ZONES PROVIDED IN ACCORDANCE WITH CHAPTER 8 OF THE TRAFFIC SIGNS MANUAL.
 - ACCESS TO PRIVATE PROPERTIES MUST BE MAINTAINED AT ALL TIMES UNLESS OTHERWISE AGREED WITH THE AFFECTED PARTY AND THE LOCAL HIGHWAY AUTHORITY.
 - MEASURES SHOULD BE DEPLOYED TO ENSURE NOISE, VIBRATION AND DUST IS MINIMIZED.
 - ALL BURIED SERVICES ARE TO BE POSITIVELY LOCATED ON SITE PRIOR TO EXCAVATION. CAT SCANS SHALL BE COMPLETED PRIOR TO EXCAVATION WITH SERVICE LOCATIONS MARKED UP ON SITE. OPERATIVES SHALL EMPLOY HAND DIGGING METHODS WHEN WORKING IN CLOSE PROXIMITY TO BURIED SERVICES. STATUTORY UNDERTAKER'S PLANT SHALL BE PROTECTED AS NECESSARY. ADDITIONAL TRIAL PITS SHALL BE EXCAVATED AS REQUIRED.
 - THIS DRAWING TO BE READ IN CONJUNCTION WITH THE RELEVANT ENGINEERING DETAILS, DRAWINGS AND SPECIFICATIONS.
 - REFER TO DRAWING NUMBER 60160078-ACM-SHT-30-0150-CT-0001 TO 0005 & 60160078-ACM-SHT-30-0120-CT-0121 TO 0128 FOR LONG SECTIONS AND TYPICAL CROSS SECTION DETAILS.
 - REFER TO DRAWING NUMBERS 60160078-ACM-SHT-30-9000-CT-9000 TO 9005 FOR STANDARD DETAILS.
 - REFER TO DRAWING NUMBERS 60160078-ACM-SHT-30-0700-CT-0701 TO 0708 FOR PAVEMENT DETAILS.
 - DIMENSIONS AND LEVELS ARE IN METRES UNLESS OTHERWISE STATED. LEVELS RELATE TO ORDNANCE DATUM.
 - DO NOT SCALE FROM THIS DRAWING, USE ONLY PRINTED DIMENSIONS ONLY.
 - THE PROPOSED DITCH AND BUNDS ALIGNMENT IS TO BE CONFIRMED ON SITE AND IS BASED ON OS MAP AND LIDAR DATA AVAILABLE AT THE TIME OF THE DESIGN. ANY ALTERATIONS CAN BE PROPOSED TO THE SUPERVISOR AND HIGHWAYS AUTHORITY FOR APPROVAL.
 - VEGETATION LOCATIONS ARE INDICATIVE.

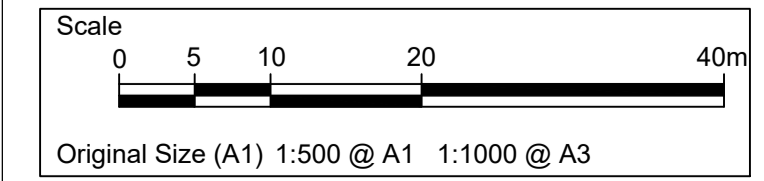

STATUS
DETAILED DESIGN

ISSUE/REVISION

NO	DATE	DESCRIPTION
C	07/07/2021	FOR PRICING
B	26/02/2021	DETAILED DESIGN
A	16/12/2020	DRAFT DETAILED DESIGN
IR		

KEY PLAN

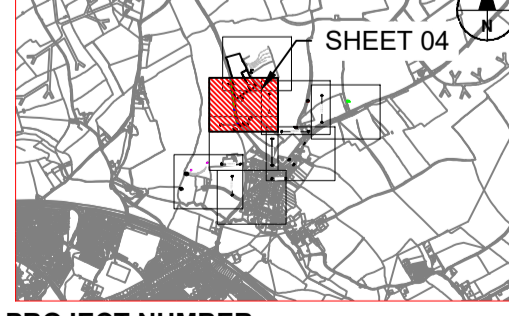

PROJECT NUMBER
60160078

SHEET TITLE
LLANMAES VILLAGE
FLOOD ALLEVIATION SCHEME
GENERAL ARRANGEMENT PLAN
SHEET 4 OF 8

SHEET NUMBER
60160078-ACM-SHT-30-0100-CT-0104

Last saved by: RHYSDAVIES(2021-07-15) Last Plotted: 2021-07-20
Filename: F:\PROJECTS\HIGHWAYS - LLANMAES FLOOD ALLEVIATION SCHEMES\0 CADDS\3 DRAWINGS\SERIES 0100 - PRELIM\30 0100 GENERAL ARRANGEMENT\60160078-ACM-SHT-30-0100-CT-0101-0108.DWG
Printed on: %Printer%
%Printer% Paper



SAFETY, HEALTH AND ENVIRONMENTAL INFORMATION

IN ADDITION TO THE HAZARDS/RISKS NORMALLY ASSOCIATED WITH THE TYPES OF WORK DETAILED ON THIS DRAWING, NOTE THE FOLLOWING SPECIFIC RESIDUAL RISKS (REFERENCE SHALL ALSO BE MADE TO THE DESIGN HAZARD LOG).

WORKING WITHIN LIVE TRAFFIC AND UNDER TRAFFIC MANAGEMENT

UNDERGROUND UTILITIES, ELECTRICITY

WORKING WITH HAZARDOUS MATERIAL (ASPHALT)

DITCH EXCAVATIONS

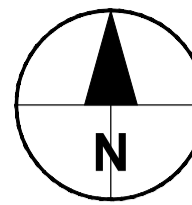

KEY:

- PLANNING APPLICATION BOUNDARY
- PROPOSED BUND
- PROPOSED DITCH
- ROAD TO BE RE-GRADED
- FOOTWAY TO BE RE-GRADED
- PROPOSED CENTER LINE AND CHAINAGE MARKER
- L.O.W. LIMIT OF WORK
- EXISTING VEGETATION (LOCATION INDICATIVE)
- EXISTING HEDGE (LOCATION INDICATIVE)
- PROPOSED HEDGE
- PROPOSED HALF BATTERED 75mm UPSTAND KERB
- PROPOSED HALF BATTERED 125mm UPSTAND KERB
- PROPOSED BULL NOSED 0mm UPSTAND KERB
- PROPOSED BUS STOP 200mm UPSTAND KERB
- PROPOSED STONE WALL
- PROPOSED GULLY
- PROPOSED CULVERT/HEADWALLS
- PROPOSED EROSION MATTING
- PROPOSED DRAINAGE NETWORK
- PROPOSED FILTER DRAIN
- EXISTING GULLY LOCATION
- PROPOSED FENCE

- NOTES**
- ALL WORKS ARE TO BE CARRIED OUT IN ACCORDANCE WITH THE CONTRACT SPECIFICATION AND THE MANUAL OF CONTRACT DOCUMENTS FOR HIGHWAY WORKS.
 - ALL WORKING HOURS AND TRAFFIC MANAGEMENT MEASURES ARE TO BE AGREED WITH THE LOCAL HIGHWAY AUTHORITY AND DEPLOYED IN ACCORDANCE WITH CHAPTER 8 OF THE TRAFFIC SIGNS MANUAL.
 - LOCATION OF SITE COMPOUND TO BE AGREED WITH THE LOCAL HIGHWAY AUTHORITY PRIOR TO WORKS COMMENCING. ALL MOVEMENT OF PLANT SHOULD BE IN ACCORDANCE WITH RECOGNIZED GOOD INDUSTRY PRACTICE. BANKSMEN SHOULD BE PROVIDED WHEN REQUIRED.
 - THE GENERAL PUBLIC SHOULD BE SEPARATED FROM THE WORKS WITH ADEQUATE LATERAL CLEARANCE AND APPROPRIATE SAFETY ZONES PROVIDED IN ACCORDANCE WITH CHAPTER 8 OF THE TRAFFIC SIGNS MANUAL.
 - ACCESS TO PRIVATE PROPERTIES MUST BE MAINTAINED AT ALL TIMES UNLESS OTHERWISE AGREED WITH THE AFFECTED PARTY AND THE LOCAL HIGHWAY AUTHORITY.
 - MEASURES SHOULD BE DEPLOYED TO ENSURE NOISE, VIBRATION AND DUST IS MINIMIZED.
 - ALL BURIED SERVICES ARE TO BE POSITIVELY LOCATED ON SITE PRIOR TO EXCAVATION. CAT SCANS SHALL BE COMPLETED PRIOR TO EXCAVATION WITH SERVICE LOCATIONS MARKED UP ON SITE. OPERATIVES SHALL EMPLOY HAND DIGGING METHODS WHEN WORKING IN CLOSE PROXIMITY TO BURIED SERVICES. STATUTORY UNDERTAKER'S PLANT SHALL BE PROTECTED AS NECESSARY. ADDITIONAL TRIAL PITS SHALL BE EXCAVATED AS REQUIRED.
 - THIS DRAWING TO BE READ IN CONJUNCTION WITH THE RELEVANT ENGINEERING DETAILS, DRAWINGS AND SPECIFICATIONS.
 - REFER TO DRAWING NUMBER 60160078-ACM-SHT-30-0150-CT-0001 TO 0005 & 60160078-ACM-SHT-30-0120-CT-0121 TO 0128 FOR LONG SECTIONS AND TYPICAL CROSS SECTION DETAILS.
 - REFER TO DRAWING NUMBERS 60160078-ACM-SHT-30-9000-CT-9000 TO 9005 FOR STANDARD DETAILS.
 - REFER TO DRAWING NUMBERS 60160078-ACM-SHT-30-0700-CT-0701 TO 0708 FOR PAVEMENT DETAILS.
 - DIMENSIONS AND LEVELS ARE IN METRES UNLESS OTHERWISE STATED. LEVELS RELATE TO ORDNANCE DATUM.
 - DO NOT SCALE FROM THIS DRAWING, USE ONLY PRINTED DIMENSIONS ONLY.
 - THE PROPOSED DITCH AND BUNDS ALIGNMENT IS TO BE CONFIRMED ON SITE AND IS BASED ON OS MAP AND LIDAR DATA AVAILABLE AT THE TIME OF THE DESIGN. ANY ALTERATIONS CAN BE PROPOSED TO THE SUPERVISOR AND HIGHWAYS AUTHORITY FOR APPROVAL.
 - VEGETATION LOCATIONS ARE INDICATIVE.

Project Management Initials: Designer: RD Checked: MH Approved: ATz 850 A1 84mm x 84mm

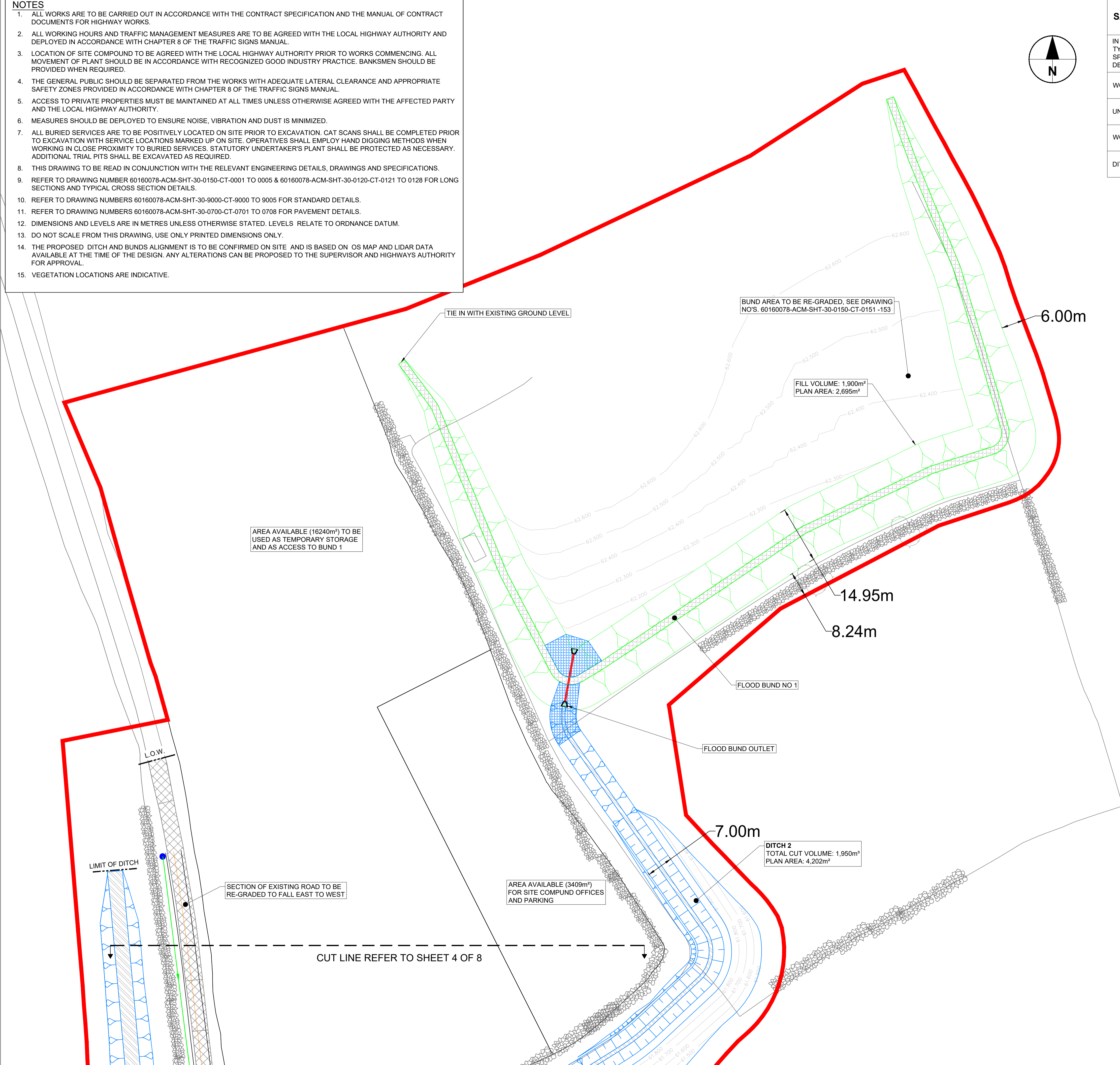

STATUS
DETAILED DESIGN

ISSUE/REVISION

NO	DATE	DESCRIPTION
C	07/07/2021	FOR PRICING
B	26/02/2021	DETAILED DESIGN
A	16/12/2020	DRAFT DETAILED DESIGN
IR		

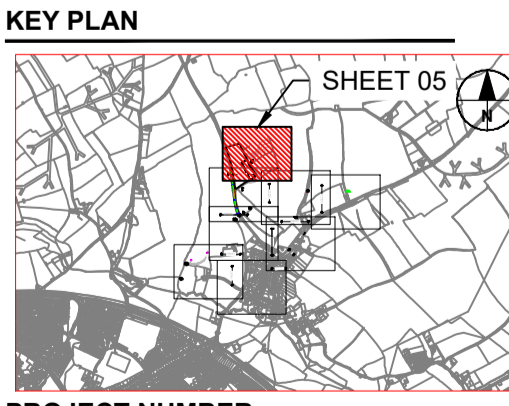

PROJECT NUMBER
60160078

SHEET TITLE
LLANMAES VILLAGE
FLOOD ALLEVIATION SCHEME
GENERAL ARRANGEMENT PLAN
SHEET 5 OF 8

SHEET NUMBER
60160078-ACM-SHT-30-0100-CT-0105

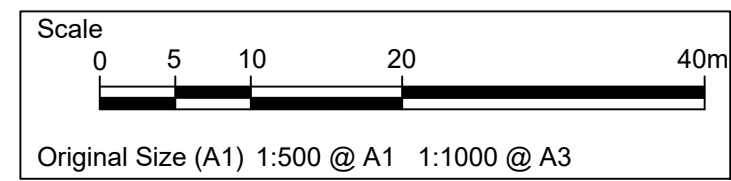

Last saved by: RHYSDAVIES(2021-07-15) Last Plotted: 2021-07-20
Filename: F:\PROJECTS\HIGHWAYS - LLANMAES FLOOD ALLEVIATION SCHEMES\0 CADD\5.3 DRAWINGS\SERIES 0100 - PRELIM\30 0100 GENERAL ARRANGEMENT\60160078-ACM-SHT-30-0100-CT-0101-0108.DWG

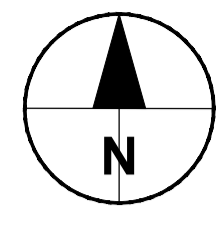

ISO A1 594mm x 841mm
Approved: ATz
Checked: MH
Designer: RD
Project Management Initials:
Last saved by: RHYS DAVIES(2021-07-15) Last Plotted: 2021-07-20
Filename: F:\PROJECTS\HIGHWAYS - LLANMAES FLOOD ALLEVIATION SCHEMES\0 CADDS\3 DRAWINGS\SERIES 0100 - PRELIM\30 0100 GENERAL ARRANGEMENT\60160078-ACM-SHT-30-0100-CT-01-01-0108.DWG

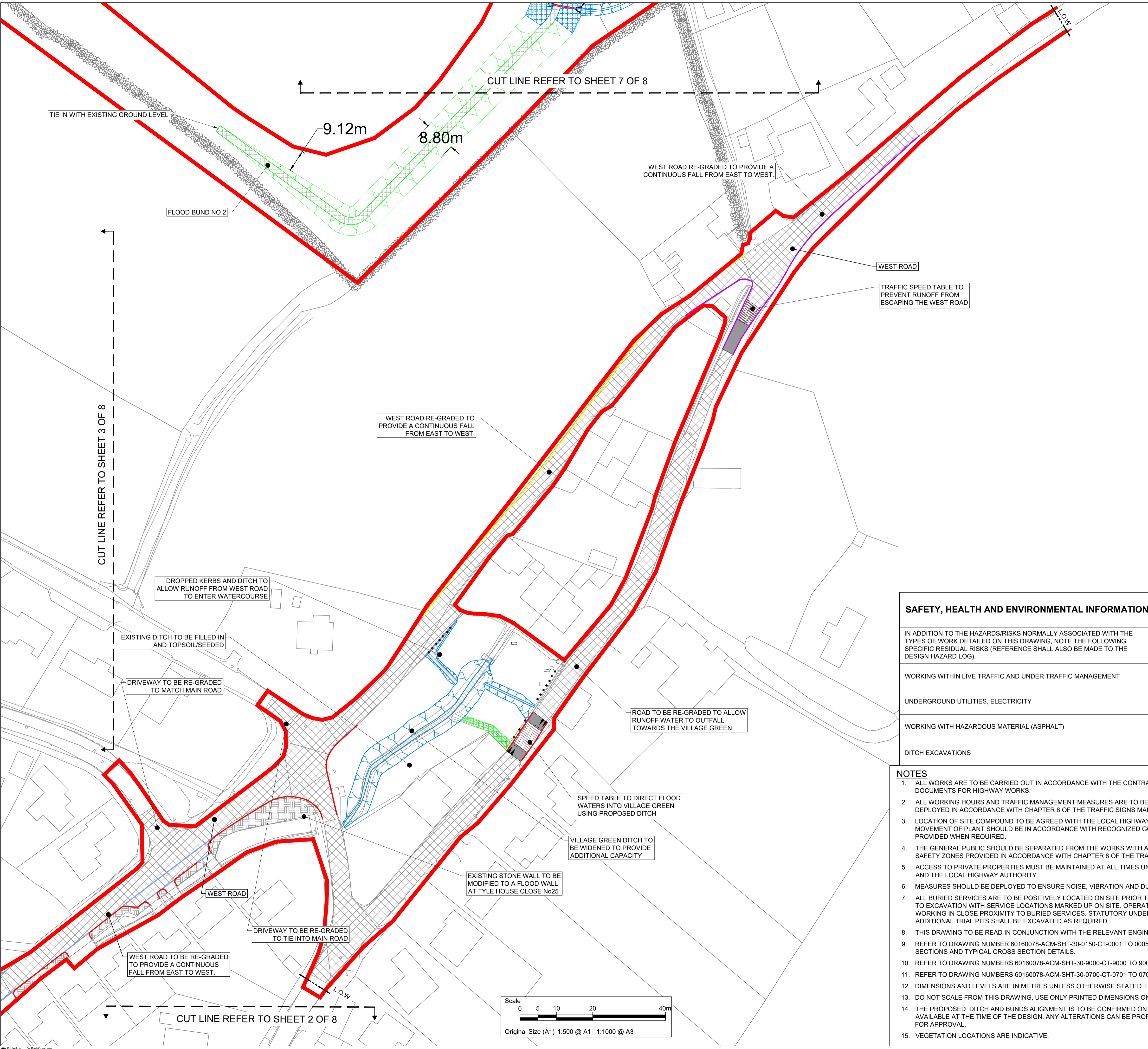

KEY:

- PLANNING APPLICATION BOUNDARY
- PROPOSED BUND
- PROPOSED DITCH
- ROAD TO BE RE-GRADED
- FOOTWAY TO BE RE-GRADED
- PROPOSED CENTER LINE AND CHAINAGE MARKER
- L.O.W.
- LIMIT OF WORK (LOCATION INDICATIVE)
- EXISTING VEGETATION (LOCATION INDICATIVE)
- EXISTING HEDGE (LOCATION INDICATIVE)
- PROPOSED HEDGE
- PROPOSED HALF BATTERED 75mm UPSTAND KERB
- PROPOSED HALF BATTERED 125mm UPSTAND KERB
- PROPOSED BULL NOSED 0mm UPSTAND KERB
- PROPOSED BUS STOP 200mm UPSTAND KERB
- PROPOSED STONE WALL
- PROPOSED GULLY
- PROPOSED CULVERT/HEADWALLS
- PROPOSED EROSION MATTING
- PROPOSED DRAINAGE NETWORK
- PROPOSED FILTER DRAIN
- EXISTING GULLY LOCATION
- PROPOSED FENCE

SAFETY, HEALTH AND ENVIRONMENTAL INFORMATION

- IN ADDITION TO THE HAZARDS/RISKS NORMALLY ASSOCIATED WITH THE TYPES OF WORK DETAILED ON THIS DRAWING, NOTE THE FOLLOWING SPECIFIC RESIDUAL RISKS (REFERENCE SHALL ALSO BE MADE TO THE DESIGN HAZARD LOG).
- WORKING WITHIN LIVE TRAFFIC AND UNDER TRAFFIC MANAGEMENT
- UNDERGROUND UTILITIES, ELECTRICITY
- WORKING WITH HAZARDOUS MATERIAL (ASPHALT)
- DITCH EXCAVATIONS

NOTES

1. ALL WORKS ARE TO BE CARRIED OUT IN ACCORDANCE WITH THE CONTRACT SPECIFICATION AND THE MANUAL OF CONTRACT DOCUMENTS FOR HIGHWAY WORKS.
2. ALL WORKING HOURS AND TRAFFIC MANAGEMENT MEASURES ARE TO BE AGREED WITH THE LOCAL HIGHWAY AUTHORITY AND DEPLOYED IN ACCORDANCE WITH CHAPTER 8 OF THE TRAFFIC SIGNS MANUAL.
3. LOCATION OF SITE COMPOUND TO BE AGREED WITH THE LOCAL HIGHWAY AUTHORITY PRIOR TO WORKS COMMENCING. ALL MOVEMENT OF PLANT SHOULD BE IN ACCORDANCE WITH RECOGNIZED GOOD INDUSTRY PRACTICE. BANKSMEN SHOULD BE PROVIDED WHEN REQUIRED.
4. THE GENERAL PUBLIC SHOULD BE SEPARATED FROM THE WORKS WITH ADEQUATE LATERAL CLEARANCE AND APPROPRIATE SAFETY ZONES PROVIDED IN ACCORDANCE WITH CHAPTER 8 OF THE TRAFFIC SIGNS MANUAL.
5. ACCESS TO PRIVATE PROPERTIES MUST BE MAINTAINED AT ALL TIMES UNLESS OTHERWISE AGREED WITH THE AFFECTED PARTY AND THE LOCAL HIGHWAY AUTHORITY.
6. MEASURES SHOULD BE DEPLOYED TO ENSURE NOISE, VIBRATION AND DUST IS MINIMIZED.
7. ALL BURIED SERVICES ARE TO BE POSITIVELY LOCATED ON SITE PRIOR TO EXCAVATION. CAT SCANS SHALL BE COMPLETED PRIOR TO EXCAVATION WITH SERVICE LOCATIONS MARKED UP ON SITE. OPERATIVES SHALL EMPLOY HAND DIGGING METHODS WHEN WORKING IN CLOSE PROXIMITY TO BURIED SERVICES. STATUTORY UNDERTAKER'S PLANT SHALL BE PROTECTED AS NECESSARY. ADDITIONAL TRIAL PITS SHALL BE EXCAVATED AS REQUIRED.
8. THIS DRAWING IS TO BE READ IN CONJUNCTION WITH THE RELEVANT ENGINEERING DETAILS, DRAWINGS AND SPECIFICATIONS.
9. REFER TO DRAWING NUMBER 60160078-ACM-SHT-30-0150-CT-0001 TO 0005 & 60160078-ACM-SHT-30-0120-CT-0121 TO 0128 FOR LONG SECTIONS AND TYPICAL CROSS SECTION DETAILS.
10. REFER TO DRAWING NUMBERS 60160078-ACM-SHT-30-9000-CT-9000 TO 9005 FOR STANDARD DETAILS.
11. REFER TO DRAWING NUMBERS 60160078-ACM-SHT-30-0700-CT-0701 TO 0708 FOR PAVEMENT DETAILS.
12. DIMENSIONS AND LEVELS ARE IN METRES UNLESS OTHERWISE STATED. LEVELS RELATE TO ORDNANCE DATUM.
13. DO NOT SCALE FROM THIS DRAWING, USE ONLY PRINTED DIMENSIONS ONLY.
14. THE PROPOSED DITCH AND BUNDS ALIGNMENT IS TO BE CONFIRMED ON SITE AND IS BASED ON OS MAP AND LIDAR DATA AVAILABLE AT THE TIME OF THE DESIGN. ANY ALTERATIONS CAN BE PROPOSED TO THE SUPERVISOR AND HIGHWAYS AUTHORITY FOR APPROVAL.
15. VEGETATION LOCATIONS ARE INDICATIVE.

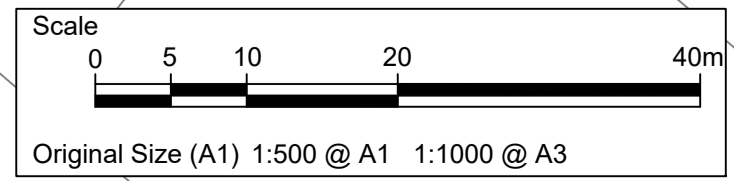

STATUS

DETAILED DESIGN

ISSUE/REVISION

NO	DATE	DESCRIPTION
C	07/07/2021	FOR PRICING
B	26/02/2021	DETAILED DESIGN
A	16/12/2020	DRAFT DETAILED DESIGN

KEY PLAN

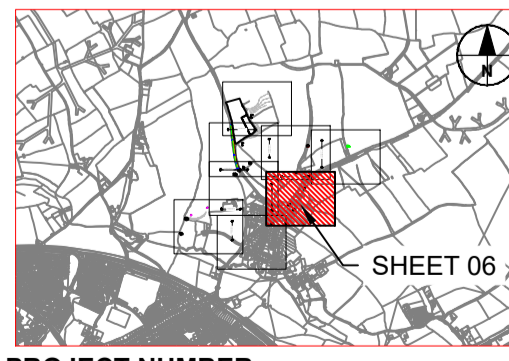

PROJECT NUMBER

60160078

SHEET TITLE

LLANMAES VILLAGE
FLOOD ALLEVIATION SCHEME
GENERAL ARRANGEMENT PLAN
SHEET 6 OF 8

SHEET NUMBER

60160078-ACM-SHT-30-0100-CT-0106



CONSULTANT

AECOM
1 CALLAGHAN SQUARE
CARDIFF
CF10 5BT
TEL: (029) 20674600
FAX: (029) 20674699

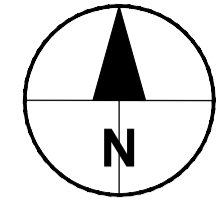

Approved: ATZ
Checked: MH
Designer: RD
Project Management Initials:
ISO A1 90mm x 60mm
Last saved by: RHYS DAVIES(2021-07-15)
Last Plotted: 2021-07-20
Filename: F:\PROJECTS\HIGHWAYS - LLANMAES FLOOD ALLEVIATION SCHEMES\0 CADD\5.3 DRAWINGS\SERIES 0100 - PRELIM\30 0100 GENERAL ARRANGEMENT\60160078-ACM-SHT-30-0100-CT-01-01-0108.DWG

KEY:

- PLANNING APPLICATION BOUNDARY
- PROPOSED BUND
- PROPOSED DITCH
- ROAD TO BE RE-GRADED
- FOOTWAY TO BE RE-GRADED
- PROPOSED CENTER LINE AND CHAINAGE MARKER
- L.O.W. LIMIT OF WORK
- EXISTING VEGETATION (LOCATION INDICATIVE)
- EXISTING HEDGE (LOCATION INDICATIVE)
- PROPOSED HEDGE
- PROPOSED HALF BATTERED 75mm UPSTAND KERB
- PROPOSED HALF BATTERED 125mm UPSTAND KERB
- PROPOSED BULL NOSED 0mm UPSTAND KERB
- PROPOSED BUS STOP 200mm UPSTAND KERB
- PROPOSED STONE WALL
- PROPOSED GULLY
- PROPOSED CULVERT/HEADWALLS
- PROPOSED EROSION MATTING
- PROPOSED DRAINAGE NETWORK
- PROPOSED FILTER DRAIN
- EXISTING GULLY LOCATION
- PROPOSED FENCE
- EXISTING PUBLIC RIGHT OF WAY
- PROPOSED DIVERSION
- EXISTING PUBLIC RIGHT OF WAY TO BE CLOSED

SAFETY, HEALTH AND ENVIRONMENTAL INFORMATION

IN ADDITION TO THE HAZARDS/RISKS NORMALLY ASSOCIATED WITH THE TYPES OF WORK DETAILED ON THIS DRAWING, NOTE THE FOLLOWING SPECIFIC RESIDUAL RISKS (REFERENCE SHALL ALSO BE MADE TO THE DESIGN HAZARD LOG).
WORKING WITHIN LIVE TRAFFIC AND UNDER TRAFFIC MANAGEMENT
UNDERGROUND UTILITIES, ELECTRICITY
WORKING WITH HAZARDOUS MATERIAL (ASPHALT)
DITCH EXCAVATIONS

- NOTES**
- ALL WORKS ARE TO BE CARRIED OUT IN ACCORDANCE WITH THE CONTRACT SPECIFICATION AND THE MANUAL OF CONTRACT DOCUMENTS FOR HIGHWAY WORKS.
 - ALL WORKING HOURS AND TRAFFIC MANAGEMENT MEASURES ARE TO BE AGREED WITH THE LOCAL HIGHWAY AUTHORITY AND DEPLOYED IN ACCORDANCE WITH CHAPTER 8 OF THE TRAFFIC SIGNS MANUAL.
 - LOCATION OF SITE COMPOUND TO BE AGREED WITH THE LOCAL HIGHWAY AUTHORITY PRIOR TO WORKS COMMENCING. ALL MOVEMENT OF PLANT SHOULD BE IN ACCORDANCE WITH RECOGNIZED GOOD INDUSTRY PRACTICE. BANKSMEN SHOULD BE PROVIDED WHEN REQUIRED.
 - THE GENERAL PUBLIC SHOULD BE SEPARATED FROM THE WORKS WITH ADEQUATE LATERAL CLEARANCE AND APPROPRIATE SAFETY ZONES PROVIDED IN ACCORDANCE WITH CHAPTER 8 OF THE TRAFFIC SIGNS MANUAL.
 - ACCESS TO PRIVATE PROPERTIES MUST BE MAINTAINED AT ALL TIMES UNLESS OTHERWISE AGREED WITH THE AFFECTED PARTY AND THE LOCAL HIGHWAY AUTHORITY.
 - MEASURES SHOULD BE DEPLOYED TO ENSURE NOISE, VIBRATION AND DUST IS MINIMIZED.
 - ALL BURIED SERVICES ARE TO BE POSITIVELY LOCATED ON SITE PRIOR TO EXCAVATION. CAT SCANS SHALL BE COMPLETED PRIOR TO EXCAVATION WITH SERVICE LOCATIONS MARKED UP ON SITE. OPERATIVES SHALL EMPLOY HAND DIGGING METHODS WHEN WORKING IN CLOSE PROXIMITY TO BURIED SERVICES. STATUTORY UNDERTAKER'S PLANT SHALL BE PROTECTED AS NECESSARY. ADDITIONAL TRIAL PITS SHALL BE EXCAVATED AS REQUIRED.
 - THIS DRAWING TO BE READ IN CONJUNCTION WITH THE RELEVANT ENGINEERING DETAILS, DRAWINGS AND SPECIFICATIONS.
 - REFER TO DRAWING NUMBER 60160078-ACM-SHT-30-0150-CT-0001 TO 0005 & 60160078-ACM-SHT-30-0120-CT-0121 TO 0128 FOR LONG SECTIONS AND TYPICAL CROSS SECTION DETAILS.
 - REFER TO DRAWING NUMBERS 60160078-ACM-SHT-30-9000-CT-9000 TO 9005 FOR STANDARD DETAILS.
 - REFER TO DRAWING NUMBERS 60160078-ACM-SHT-30-0700-CT-0701 TO 0708 FOR PAVEMENT DETAILS.
 - DIMENSIONS AND LEVELS ARE IN METRES UNLESS OTHERWISE STATED. LEVELS RELATE TO ORDNANCE DATUM.
 - DO NOT SCALE FROM THIS DRAWING. USE ONLY PRINTED DIMENSIONS ONLY.
 - THE PROPOSED DITCH AND BUNDS ALIGNMENT IS TO BE CONFIRMED ON SITE AND IS BASED ON OS MAP AND LIDAR DATA AVAILABLE AT THE TIME OF THE DESIGN. ANY ALTERATIONS CAN BE PROPOSED TO THE SUPERVISOR AND HIGHWAYS AUTHORITY FOR APPROVAL.
 - VEGETATION LOCATIONS ARE INDICATIVE.

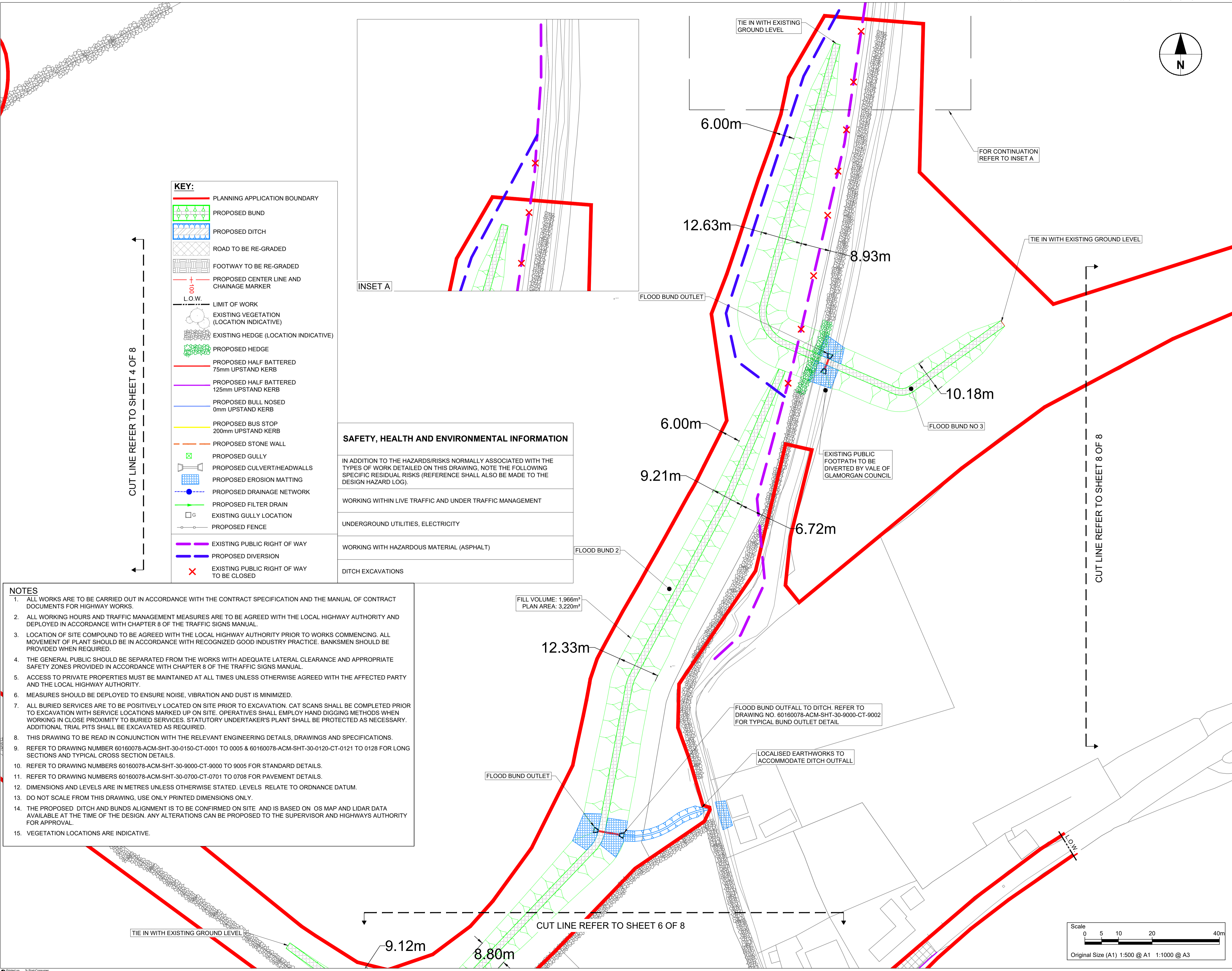

FILL VOLUME: 1,966m³
PLAN AREA: 3,220m²

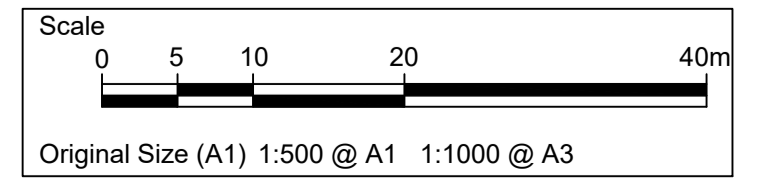

STATUS

DETAILED DESIGN

ISSUE/REVISION

NO	DATE	DESCRIPTION
C	07/07/2021	FOR PRICING
B	26/02/2021	DETAILED DESIGN
A	16/12/2020	DRAFT DETAILED DESIGN
IR		

KEY PLAN

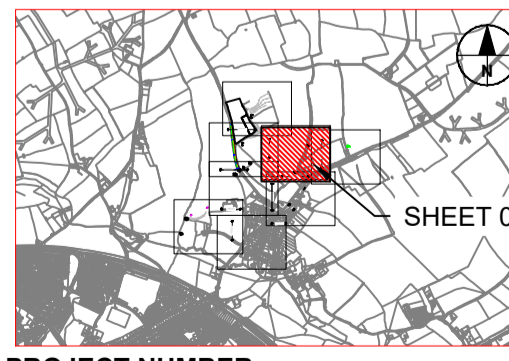

PROJECT NUMBER

60160078

SHEET TITLE

LLANMAES VILLAGE
FLOOD ALLEVIATION SCHEME
GENERAL ARRANGEMENT PLAN
SHEET 7 OF 8

SHEET NUMBER

60160078-ACM-SHT-30-0100-CT-0107

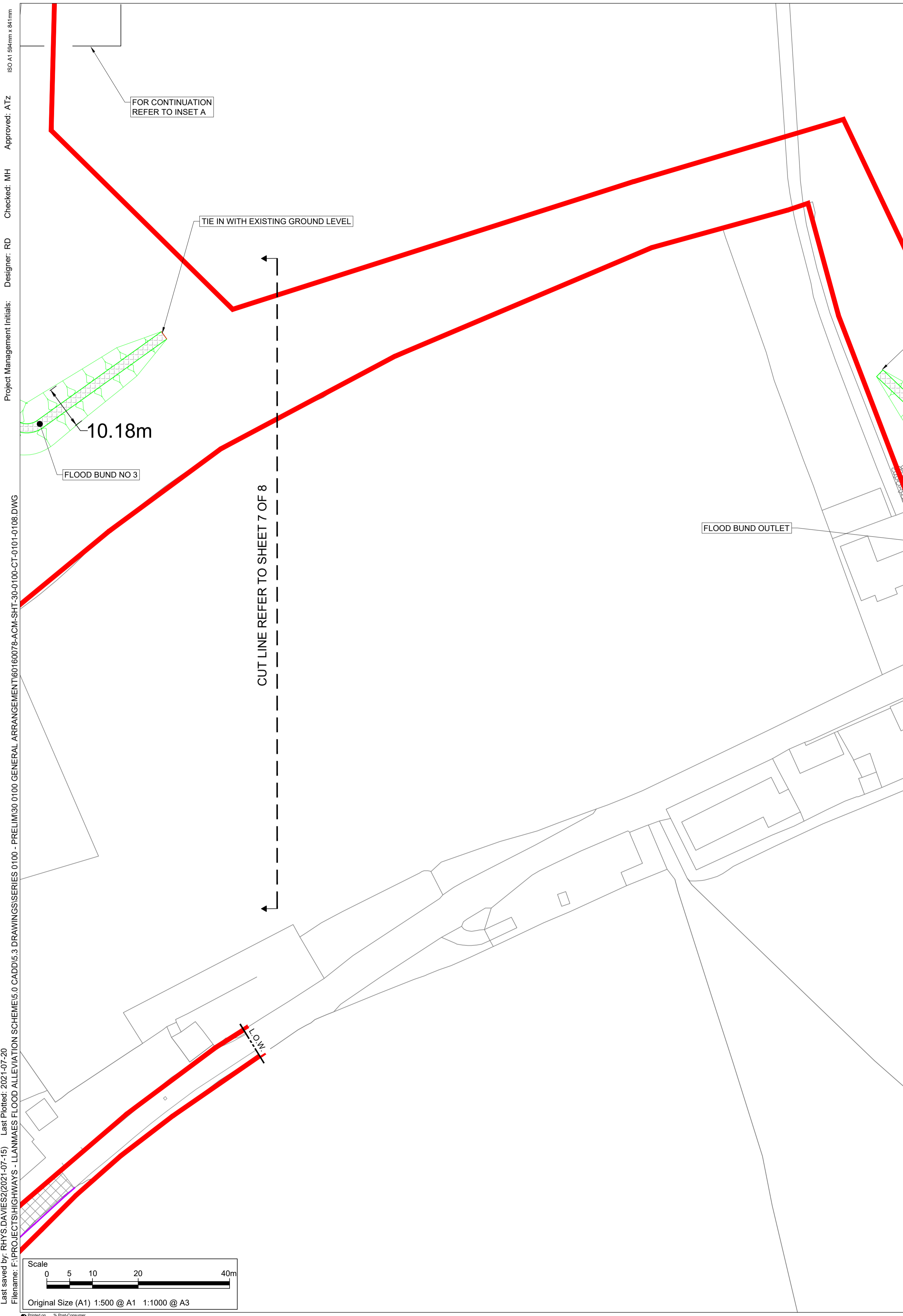
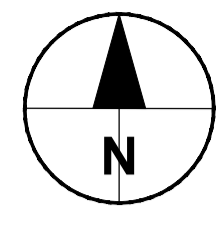

FOR CONTINUATION
REFER TO INSET A

TIE IN WITH EXISTING GROUND LEVEL

TIE IN WITH EXISTING GROUND LEVEL

TIE IN WITH EXISTING GROUND LEVEL

FILL VOLUME: 156m³
PLAN AREA: 534m²

10.18m

FLOOD BUND NO 3

CUT LINE REFER TO SHEET 7 OF 8

FLOOD BUND OUTLET

12.28m

6.01m

FLOOD BUND 4

6.99m

SAFETY, HEALTH AND ENVIRONMENTAL INFORMATION

IN ADDITION TO THE HAZARDS/RISKS NORMALLY ASSOCIATED WITH THE TYPES OF WORK DETAILED ON THIS DRAWING, NOTE THE FOLLOWING SPECIFIC RESIDUAL RISKS (REFERENCE SHALL ALSO BE MADE TO THE DESIGN HAZARD LOG).

- WORKING WITHIN LIVE TRAFFIC AND UNDER TRAFFIC MANAGEMENT
- UNDERGROUND UTILITIES, ELECTRICITY
- WORKING WITH HAZARDOUS MATERIAL (ASPHALT)
- DITCH EXCAVATIONS

KEY:

- PLANNING APPLICATION BOUNDARY
- PROPOSED BUND
- PROPOSED DITCH
- ROAD TO BE RE-GRADED
- FOOTWAY TO BE RE-GRADED
- PROPOSED CENTER LINE AND CHAINAGE MARKER
- L.O.W. LIMIT OF WORK
- EXISTING VEGETATION (LOCATION INDICATIVE)
- EXISTING HEDGE (LOCATION INDICATIVE)
- PROPOSED HEDGE
- PROPOSED HALF BATTERED 75mm UPSTAND KERB
- PROPOSED HALF BATTERED 125mm UPSTAND KERB
- PROPOSED BULL NOSED 0mm UPSTAND KERB
- PROPOSED BUS STOP 200mm UPSTAND KERB
- PROPOSED STONE WALL
- PROPOSED GULLY
- PROPOSED CULVERT/HEADWALLS
- PROPOSED EROSION MATTING
- PROPOSED DRAINAGE NETWORK
- PROPOSED FILTER DRAIN
- EXISTING GULLY LOCATION
- PROPOSED FENCE

NOTES

- ALL WORKS ARE TO BE CARRIED OUT IN ACCORDANCE WITH THE CONTRACT SPECIFICATION AND THE MANUAL OF CONTRACT DOCUMENTS FOR HIGHWAY WORKS.
- ALL WORKING HOURS AND TRAFFIC MANAGEMENT MEASURES ARE TO BE AGREED WITH THE LOCAL HIGHWAY AUTHORITY AND DEPLOYED IN ACCORDANCE WITH CHAPTER 8 OF THE TRAFFIC SIGNS MANUAL.
- LOCATION OF SITE COMPOUND TO BE AGREED WITH THE LOCAL HIGHWAY AUTHORITY PRIOR TO WORKS COMMENCING. ALL MOVEMENT OF PLANT SHOULD BE IN ACCORDANCE WITH RECOGNIZED GOOD INDUSTRY PRACTICE. BANKSMEN SHOULD BE PROVIDED WHEN REQUIRED.
- THE GENERAL PUBLIC SHOULD BE SEPARATED FROM THE WORKS WITH ADEQUATE LATERAL CLEARANCE AND APPROPRIATE SAFETY ZONES PROVIDED IN ACCORDANCE WITH CHAPTER 8 OF THE TRAFFIC SIGNS MANUAL.
- ACCESS TO PRIVATE PROPERTIES MUST BE MAINTAINED AT ALL TIMES UNLESS OTHERWISE AGREED WITH THE AFFECTED PARTY AND THE LOCAL HIGHWAY AUTHORITY.
- MEASURES SHOULD BE DEPLOYED TO ENSURE NOISE, VIBRATION AND DUST IS MINIMIZED.
- ALL BURIED SERVICES ARE TO BE POSITIVELY LOCATED ON SITE PRIOR TO EXCAVATION. CAT SCANS SHALL BE COMPLETED PRIOR TO EXCAVATION WITH SERVICE LOCATIONS MARKED UP ON SITE. OPERATIVES SHALL EMPLOY HAND DIGGING METHODS WHEN WORKING IN CLOSE PROXIMITY TO BURIED SERVICES. STATUTORY UNDERTAKER'S PLANT SHALL BE PROTECTED AS NECESSARY. ADDITIONAL TRIAL PITS SHALL BE EXCAVATED AS REQUIRED.
- THIS DRAWING TO BE READ IN CONJUNCTION WITH THE RELEVANT ENGINEERING DETAILS, DRAWINGS AND SPECIFICATIONS.
- REFER TO DRAWING NUMBER 60160078-ACM-SHT-30-0150-CT-0001 TO 0005 & 60160078-ACM-SHT-30-0120-CT-0121 TO 0128 FOR LONG SECTIONS AND TYPICAL CROSS SECTION DETAILS.
- REFER TO DRAWING NUMBERS 60160078-ACM-SHT-30-9000-CT-9000 TO 9005 FOR STANDARD DETAILS.
- REFER TO DRAWING NUMBERS 60160078-ACM-SHT-30-0700-CT-0701 TO 0708 FOR PAVEMENT DETAILS.
- DIMENSIONS AND LEVELS ARE IN METRES UNLESS OTHERWISE STATED. LEVELS RELATE TO ORDNANCE DATUM.
- DO NOT SCALE FROM THIS DRAWING, USE ONLY PRINTED DIMENSIONS ONLY.
- THE PROPOSED DITCH AND BUNDS ALIGNMENT IS TO BE CONFIRMED ON SITE AND IS BASED ON OS MAP AND LIDAR DATA AVAILABLE AT THE TIME OF THE DESIGN. ANY ALTERATIONS CAN BE PROPOSED TO THE SUPERVISOR AND HIGHWAYS AUTHORITY FOR APPROVAL.
- VEGETATION LOCATIONS ARE INDICATIVE.

STATUS

DETAILED DESIGN

ISSUE/REVISION

IR	DATE	DESCRIPTION
C	07/07/2021	FOR PRICING
B	26/02/2021	DETAILED DESIGN
A	16/12/2020	DRAFT DETAILED DESIGN

KEY PLAN

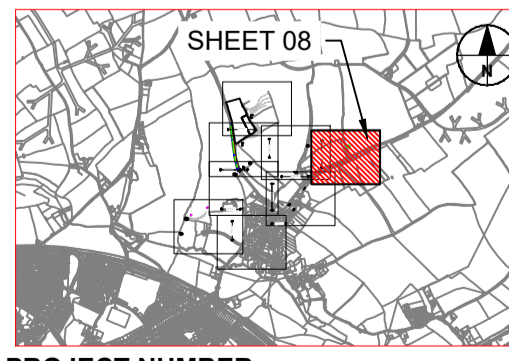

PROJECT NUMBER

60160078

SHEET TITLE

LLANMAES VILLAGE
FLOOD ALLEVIATION SCHEME
GENERAL ARRANGEMENT PLAN
SHEET 8 OF 8

SHEET NUMBER

60160078-ACM-SHT-30-0100-CT-0108

