

Existing Ground Floor Plan

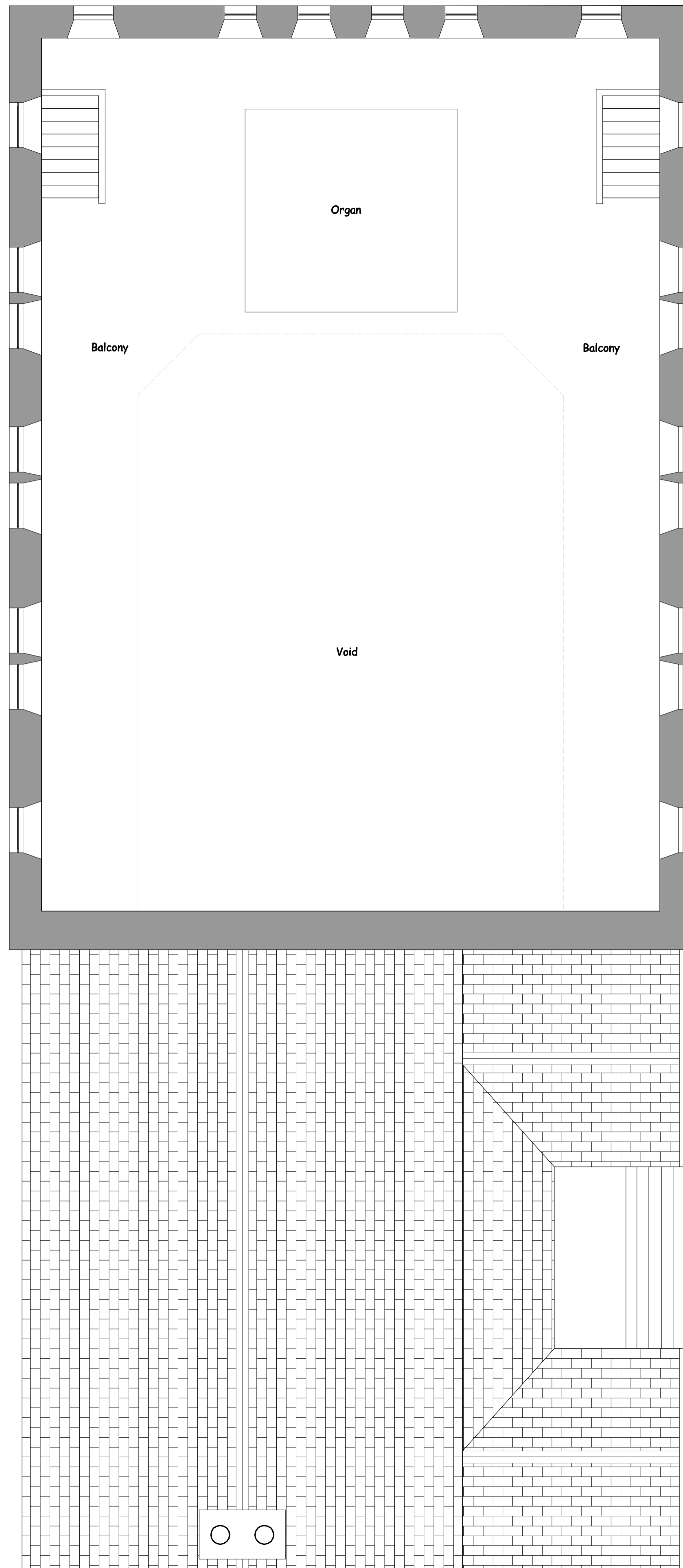

Existing First Floor Plan

Rev	Item	Date
		
Chartered Building Surveyors & Architectural Services 41 High Street Penarth Vale of Glamorgan CF64 1EY t: 029 2070 6242 f: 029 2070 6353 www.lapider.co.uk		
Client	Andrew Goodman	
Project	New Jerusalem Congregational Church Tynwydd Road Barry CF62 8HB	
Drawing Title	Existing Floor Plans	
Job Number	1320/PM/20	
Drawing Number	1320 / 110	Rev
Purpose of Issue	<input checked="" type="checkbox"/> Information <input type="checkbox"/> Comment <input type="checkbox"/> Scale <input type="checkbox"/> Drawn By	<input type="checkbox"/> Tender <input type="checkbox"/> Construction <input type="checkbox"/> Date <input type="checkbox"/> Checked By
Scale	1:50@A1	Date June 21
Drawn By	---	Checked By MN