

Ground Preparation

Imported soils should be certified to BS 3882:2015 (topsoil) and BS 8601:2013 (subsoil), but most importantly found via a soil scientists interpretive report to be fit for the specific landscape function.

Default soil profiles should be 300mm topsoil over 600mm subsoil wherever trees are planted, 300 over 300 for shrubs and 150 over 150 for grass only (though 300 over 300 is better in avoiding drought or drainage problems).

On delivery plants should be stored in a dry place remaining covered until required. Turf to be soaked on arrival and preferably stored in a shady location or covered by tarpaulin; it is recommended that turf be laid within 24 hours after cutting.

Area should be free of competing weeds, debris and rubbish;

Fertiliser should be applied after a soil analysis (if required);

Soil should be cultivated or remediated with a single tine ripping tooth on repeated passes to remove compaction without smearing and inverting soil profiles. Badly degraded soil will need to be replaced;

Debris or stones larger than 50mm should ideally be removed from the surface before laying/sowing/planting;

Ground should be sufficiently soaked before sowing/turfing/planting allowing water to fully permeate the soil;

All planting to be carried out in accordance with BS 4428:1989 and specified using The National Plant Specification NPS. Plant selection and specification to be in accordance with Landscape Architects drawings and Specifications

Plot Planting Plant Layout Guide

The mix of plants for each plot has been divided based on height and position within the border. Plants in the low category should go at the front, plants in the medium category, midway back, and plants in the high category should be placed at the back.

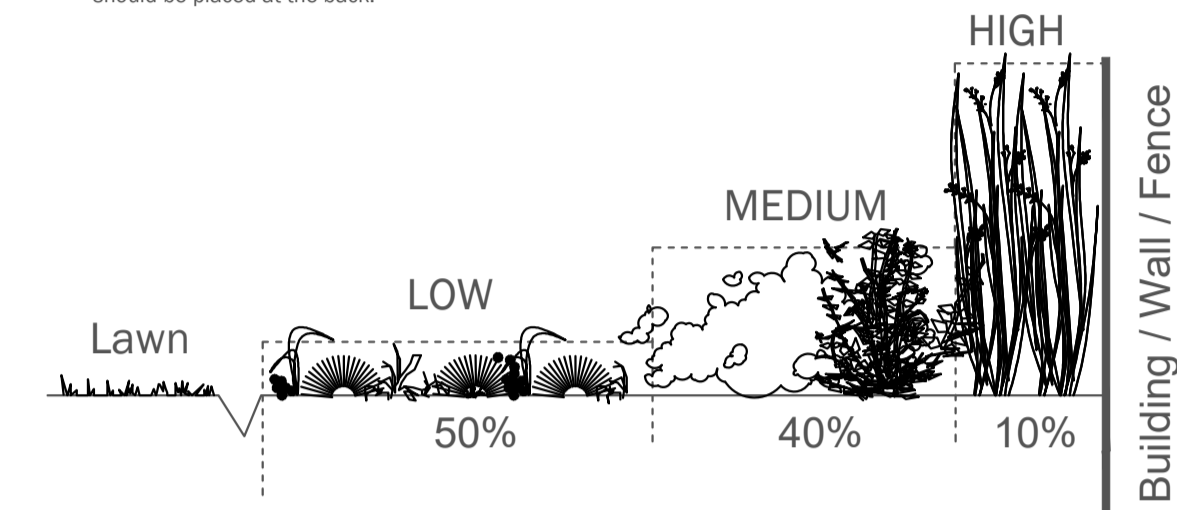

Plant Maintenance and Management During 5 Year Establishment Period

All planting to be carried out in accordance with BS 4428:1989 and specified using The National Plant Specification NPS. Plant selection and specification to be in accordance with Landscape Architects drawings and Specifications.

Plants should be stored in a suitable location on site where they can be positioned upright and sheltered from wind. Their pots/root balls should be sheltered from direct sunlight especially during hot dry weather.

Plants should be delivered in batches as required and planted within 48 hours of delivery from nursery, stock should be watered regularly before and after planting

On delivery, check plants are in accordance with original specification set out by landscape architect, are in a healthy condition, free of broken stems, wilting leaves and disease

Areas of beds to be planted must be:

- Free of weeds, litter and other debris, which may affect plant establishment and growth
- Well rotavated to a depth of 400mm to loosen soil, with the application of fertile organic matter to aid in plant growth and development
- Soaked before planting allowing water to sufficiently permeate the soil.

It is important to maintain a weed-free area and adequate levels of moisture especially in new planting beds. Before planting and applying any weed suppressants:

- The ground must be levelled whilst clearing all weeds, debris and rubbish;
- Dig over and rotavate soil breaking up any large clods of earth;
- Soak soil thoroughly prior to planting and after digging before applying mulch or membrane;
- Membrane must be rolled out before planting and secured to the ground using membrane staples;
- Position plants within bed, drawing around the pot base with chalk;
- Cut out the circle of membrane leaving some bare earth around the plant base;
- Apply mulch at a thickness of approximately 100-150mm (leave a sufficient area of bare ground around the stems or trunk so enough water can permeate the ground to the roots);
- Leave mulch 20-30mm below the level of adjacent hard surfaces at edges of planting beds to prevent mulch spilling over during watering.

Establishment period

During the establishment period following initial or reinstatement planting of native tree and shrub areas the following landscape operations to be undertaken to ensure establishment of healthy, vigorous plants.

Maintain weed-free area around each tree and shrub, a minimum radius of 150mm from the stem, using mulch mats or herbicide. Mulch to be maintained until plants have formed a close-knit ground cover; Any dead or dying plants to be replaced during the winter season (November/ March);

- Re-firm any plants loosened by frost heave, wind rock or vandalism by treading around the base;
- Watering to be undertaken regularly during the summer months and as required in the first five years following planting, to achieve successful plant establishment;
- Ameliorants to be added as necessary and in accordance with the on-going maintenance above

Ongoing Maintenance

- Watering to be undertaken regularly during the summer months and as required in the first five years following planting, to achieve successful plant establishment;
- Bi-annual weeding should take place in the the spring and end of the summer
- Ameliorants to be added as necessary and in accordance with the on-going maintenance above
- Seed heads to be left during winter months for wildlife

Rev	Date	Action

This drawing is copyright.
Dimensions to be checked on site and any discrepancies reported to the Architect immediately.
Do not scale, use figured dimensions only.

cfw ARCHITECTS
Newydd Housing
St Barrows Church Barry
Landscaping Site Plan
1:100 @ A1
2118 - 018

8 north road, cardiff, cf10 3du
029 2034 0491
www.cfw-architects.co.uk

landscaping site plan

1:100 @ A1 02 04 10m