

# Bolston House, Bonvilston

## Tree Retention/Removal Plan

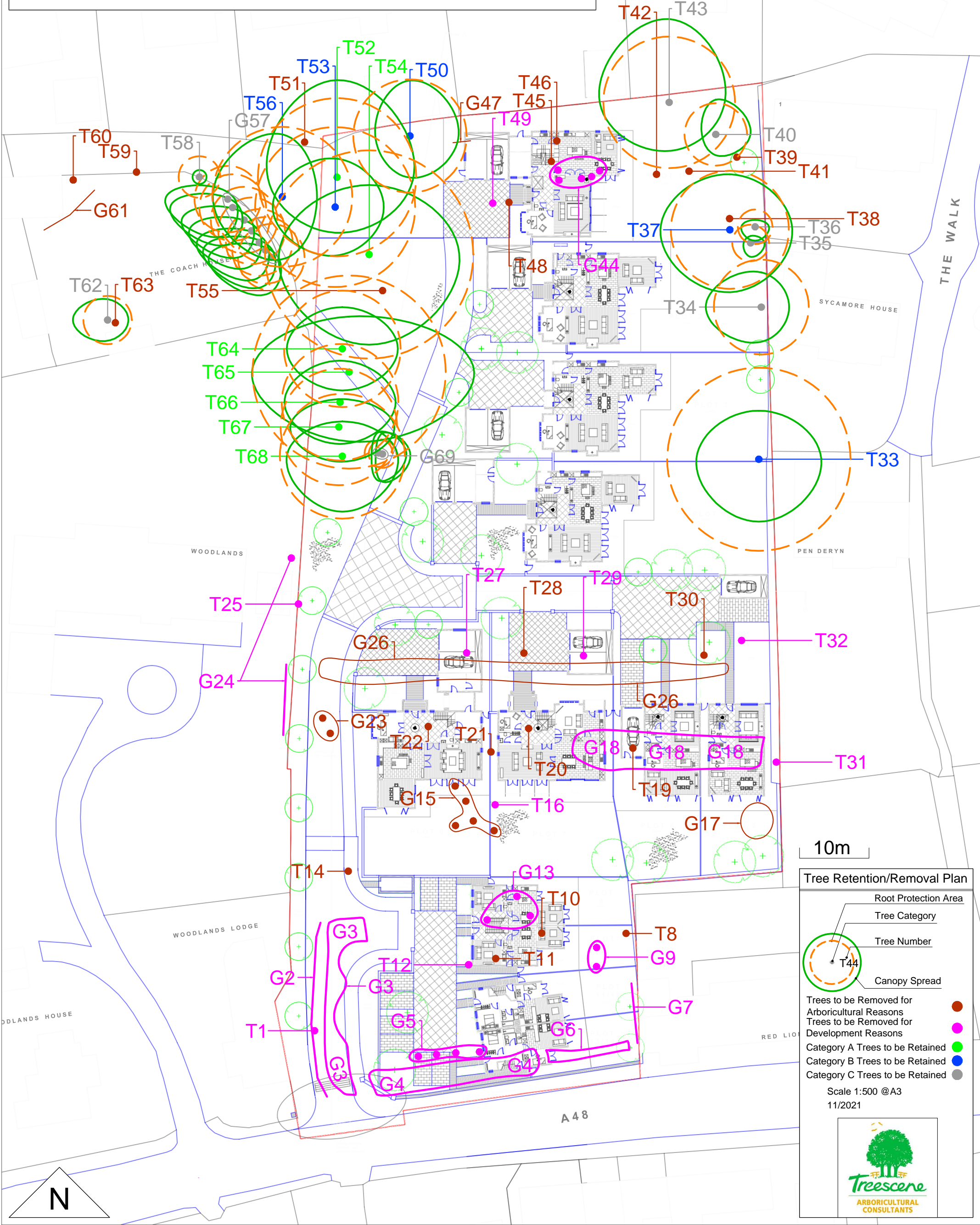

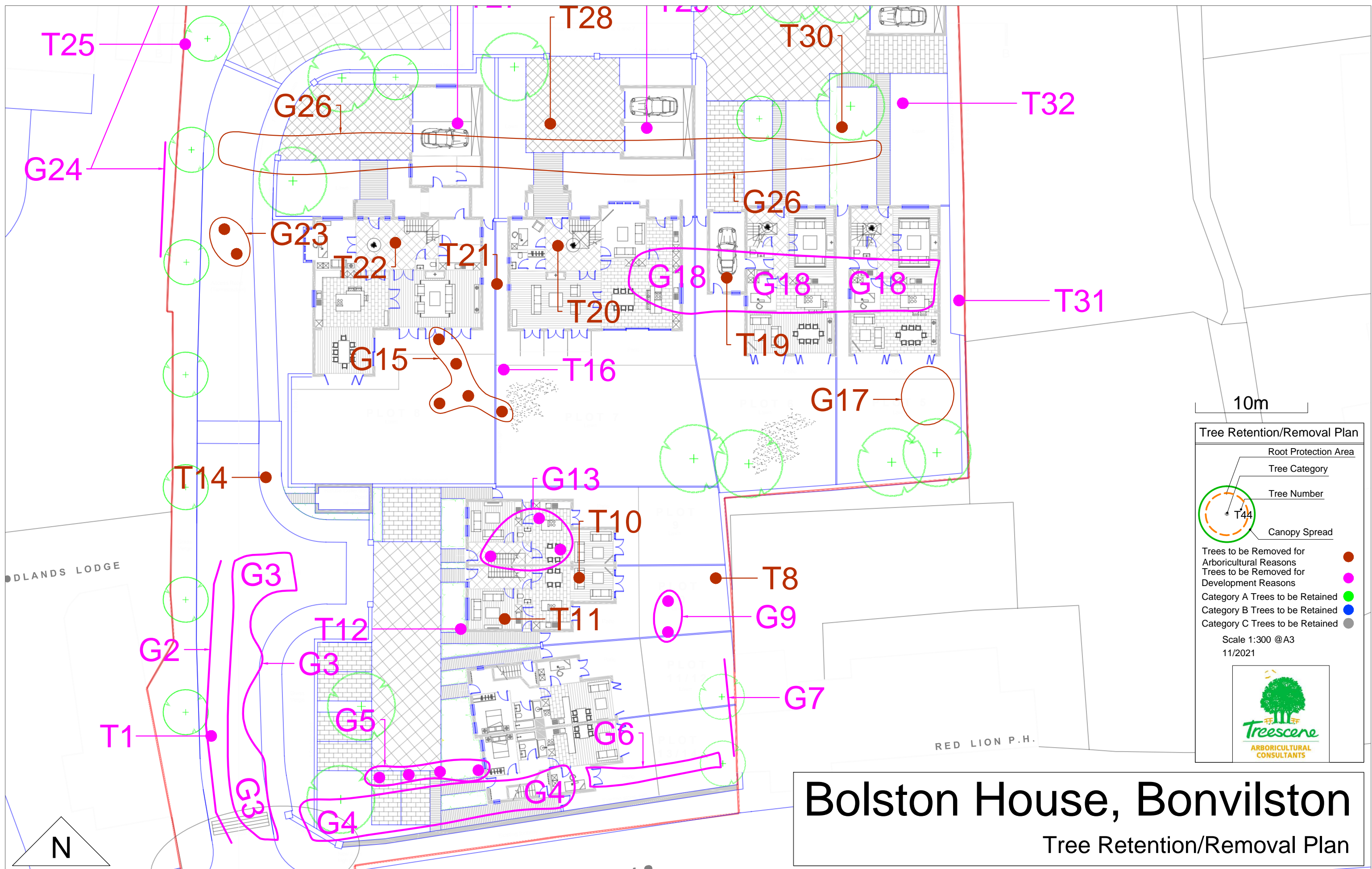



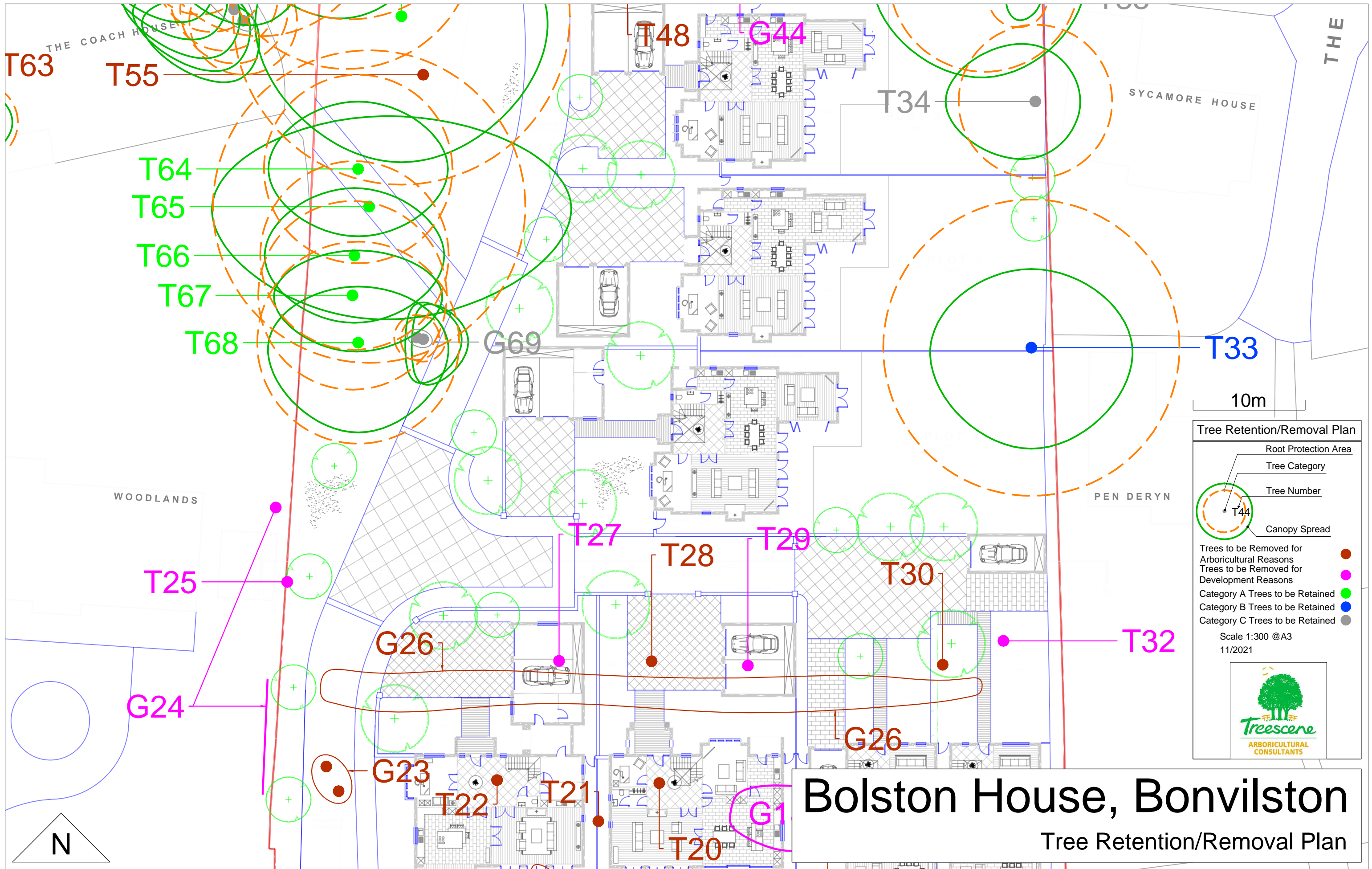

Tree Retention/Removal Plan

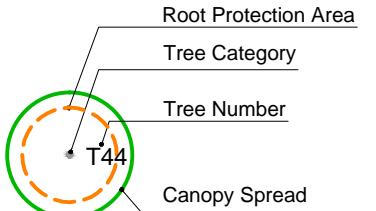

- Trees to be Removed for Arboricultural Reasons ●
- Trees to be Removed for Development Reasons ●
- Category A Trees to be Retained ●
- Category B Trees to be Retained ●
- Category C Trees to be Retained ●

Scale 1:300 @A3  
11/2021



# Bolston House, Bonvilston

Tree Retention/Removal Plan

# Bolston House, Bonvilston

## Tree Retention/Removal Plan

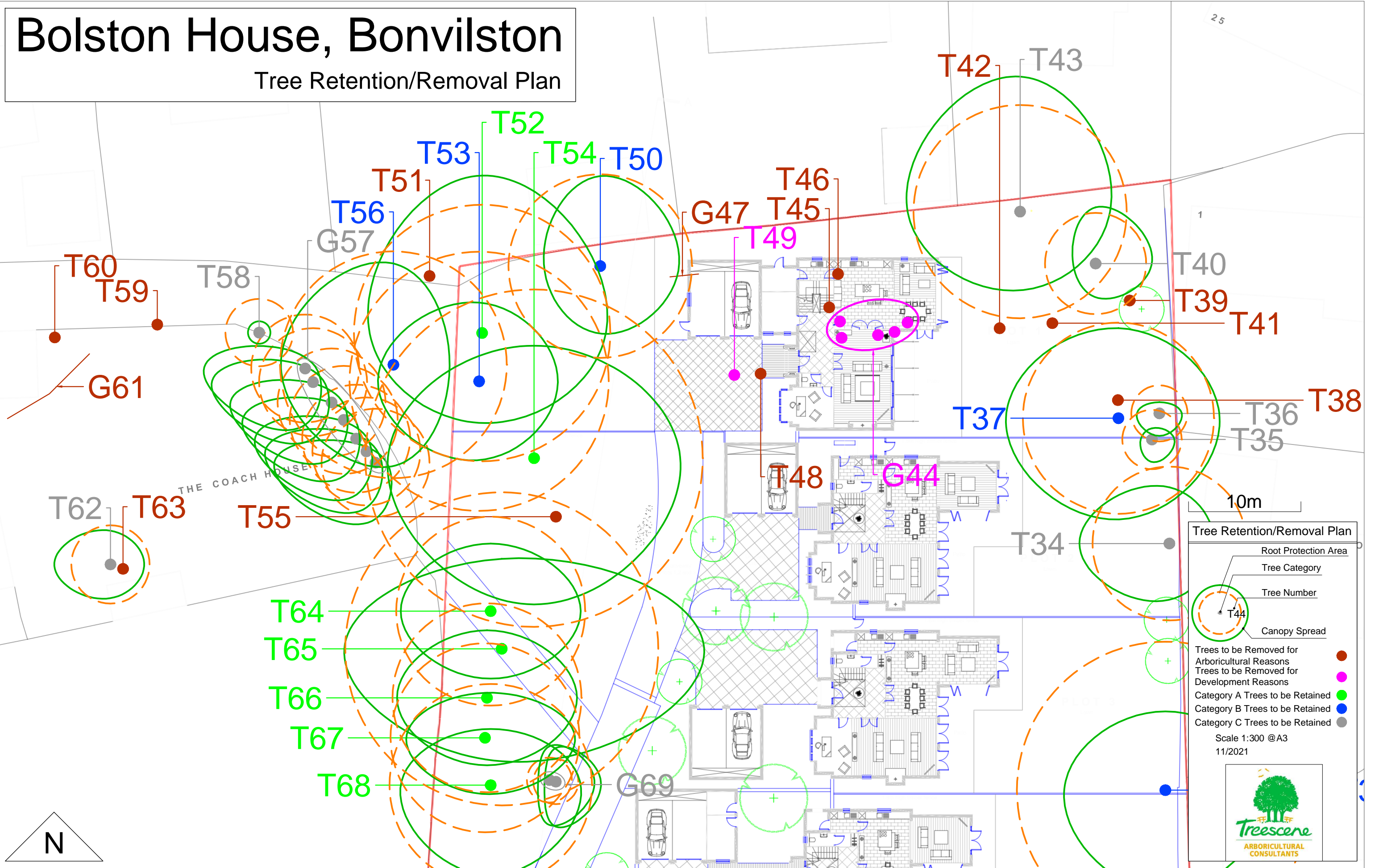

### Tree Retention/Removal Plan

- Root Protection Area
- Tree Category
- Tree Number
- Canopy Spread

- Trees to be Removed for Arboricultural Reasons
- Trees to be Removed for Development Reasons
- Category A Trees to be Retained
- Category B Trees to be Retained
- Category C Trees to be Retained

Scale 1:300 @ A3  
11/2021

