

NOTE THE PROPERTY OF THIS DRAWING AND DESIGN IS VESTED IN BINGHAM HALL PARTNERSHIP LIMITED AND MUST NOT BE COPIED OR REPRODUCED IN ANY WAY WITHOUT THEIR WRITTEN CONSENT

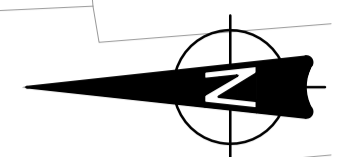
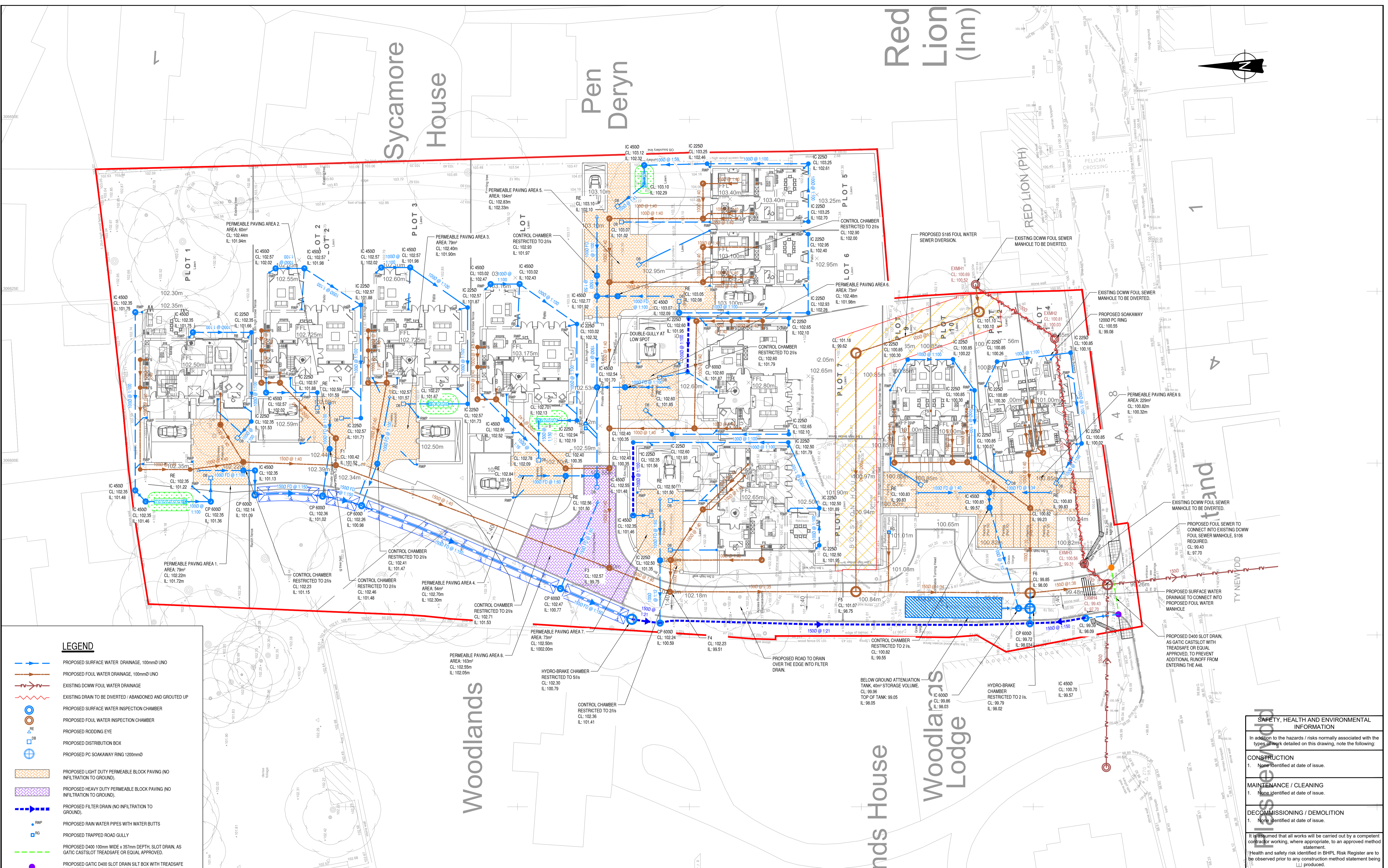

LEGEND

- PROPOSED SURFACE WATER DRAINAGE, 100mm Ø UNO
- PROPOSED FOUL WATER DRAINAGE, 100mm Ø UNO
- EXISTING DOWM FOUL WATER DRAINAGE
- EXISTING DRAIN TO BE DIVERTED / ABANDONED AND GROUTED UP
- PROPOSED SURFACE WATER INSPECTION CHAMBER
- PROPOSED FOUL WATER INSPECTION CHAMBER
- PROPOSED RODDING EYE
- PROPOSED DISTRIBUTION BOX
- PROPOSED PC SOAKAWAY RING 1200mm Ø
- PROPOSED LIGHT DUTY PERMEABLE BLOCK PAVING (NO INFILTRATION TO GROUND)
- PROPOSED HEAVY DUTY PERMEABLE BLOCK PAVING (NO INFILTRATION TO GROUND)
- PROPOSED FILTER DRAIN (NO INFILTRATION TO GROUND)
- PROPOSED RAIN WATER PIPES WITH WATER BUTTS
- PROPOSED TRAPPED ROAD GULLY
- PROPOSED D400 100mm WIDE x 357mm DEPTH, SLOTTED DRAIN, AS GATIC CASTSLOT TREADSAFE OR EQUAL APPROVED.
- PROPOSED GATIC D400 SLOTTED DRAIN SILT BOX WITH TREADSAFE DOUBLE TRIANGULAR GRATING OR EQUAL APPROVED.
- PROPOSED GATIC D400 SLOTTED DRAIN ACCESS BOX WITH TREADSAFE DOUBLE TRIANGULAR GRATING OR EQUAL APPROVED.
- PROPOSED COMBINED SWALE AND FILTER DRAIN (NO INFILTRATION TO GROUND)
- PROPOSED RAINWATER GARDEN (NO INFILTRATION TO GROUND)

Rev	By	Date	Revision
P10	MPC	19/11/2021	DRAINAGE UPDATED DUE TO CHANGES TO ARCHITECT'S LAYOUT
P01	MPC	20/05/2021	INITIAL ISSUE

Drawing Status					
WORK IN PROGRESS					
Architect C.W. ARCHITECTS					
Client PORTABELLA LTD					
Scale 1:250	Drawn MPC	Drawing Size A1	Date 09/04/21	Checked DTH	

Bingham Hall
PARTNERSHIP LTD

Consulting Civil & Structural Engineers
5 Ty-Nant Court
Margaretstown
Cardiff
CF15 8LW
Telephone (029) 2048 6588

Project Title HOUSING, BONVILSTON	
Drawing Title DRAINAGE PLAN	
Project No. - Originator - Volume - Level - Type - Role - Number 6709 - BHP - XX - XX - DR - C - (50)001	Rev P02

SAFETY, HEALTH AND ENVIRONMENTAL INFORMATION	
In addition to the hazards / risks normally associated with the types of work detailed on this drawing, note the following:	
CONSTRUCTION 1. None identified at date of issue.	
MAINTENANCE / CLEANING 1. None identified at date of issue.	
DECOMMISSIONING / DEMOLITION 1. None identified at date of issue.	
It is assumed that all works will be carried out by a competent contractor working, where appropriate, to an approved method statement. Health and safety risk identified in BHP/L Risk Register are to be observed prior to any construction method statement being produced.	