

Responsibility is not accepted for errors made by others in scaling from this drawing.
All construction information should be taken from figured dimensions only.

Legend

- **Site boundary.**
- **Secure site boundary fencing, minimum 1.8m high.**
Weld mesh anti-climb fence, to SbD standards e.g. Dulok double wire mesh fencing at 1830mm height, powder coated in black colour. With matching gates. Q40/126
- **Secondary secure fencing to playground zones.**
Weld mesh anti-climb fence, e.g. Dulok double wire mesh fencing at 1430mm height, powder coated in black colour. With matching gates. Q40/126
- **Fencing to refuse store and substation enclosure.**
Timber hit and miss fencing, with concrete support posts. Minimum 2400mm high. With matching gates. Roof not included. Q40/311A
- **Fencing to MUGA.**
Weld mesh anti-climb fence, to SbD standards e.g. Dulok double wire mesh fencing at 3000mm height, powder coated in black colour. With matching gates. Q40/126A
- **Existing fence**
to habitat area to be retained, including gate access.
- **Bollards.**
Refer to drawings:
SNPS-STL-XX-XX-DR-L-9002 Hard Landscape Plan and
SNPS-STL-XX-XX-DR-L-9407 Street Furniture Details.

NOTE:

Refer to drawing SNPS-STL-XX-XX-DR-L-9402 Bin Enclosure, Sprinkler Tank Enclosure, Substation and Plant Store for details.
Refer to drawing SNPS-STL-XX-XX-DR-L-9404 Weldmesh Fence Details.

GATE SCHEDULE:

- G1** Lockable pedestrian gate. Single leaf gate, min. 1.2m clear opening.
- G2** Lockable vehicular gate. Double leaf gate, min. 6.0m clear opening.
- G3** Lockable vehicular gate. Double leaf gate, min. 6.0m clear opening.
- G4** Lockable pedestrian gate. Single leaf gate, min. 1.2m clear opening.
- G5** Lockable maintenance gate to Bin Store enclosure. Double leaf gate, min. 2.0m clear opening.
- G6** Lockable maintenance gate to Substation. Double leaf gate, min. 2.4m clear opening.
- G7** Lockable maintenance gate to Plant. Double leaf gate, min. 2.0m clear opening.
- G8** Lockable pedestrian/ maintenance gate to Habitat area. Double leaf gate, min. 2.4m clear opening.
- G9** Lockable maintenance gate. Double leaf gate, min. 2.4m clear opening.
- G10** Lockable maintenance gate to Sprinkler tank. Double leaf gate, min. 2.0m clear opening.
- G11** Lockable pedestrian/ maintenance gate to Habitat area. Double leaf gate, min. 2.4m clear opening.
- G12** Lockable pedestrian/ maintenance gate. Double leaf gate, min. 2.4m clear opening.
- G13** Lockable pedestrian/ maintenance gate. Double leaf gate, min. 2.4m clear opening.
- G14** Lockable pedestrian/ maintenance gate. Double leaf gate, min. 2.4m clear opening.
- G15** Pedestrian/ maintenance gate. Double leaf gate, min. 1.2m clear opening.
- G16** Lockable pedestrian/ maintenance gate. Double leaf gate, min. 2.4m clear opening.
- G17** Lockable pedestrian gate. Single leaf gate, min. 1.2m clear opening.
- G18** Lockable maintenance gate. Double leaf gate, min. 2.4m clear opening.
- G19** Lockable pedestrian gate. Single leaf gate, min. 1.2m clear opening.

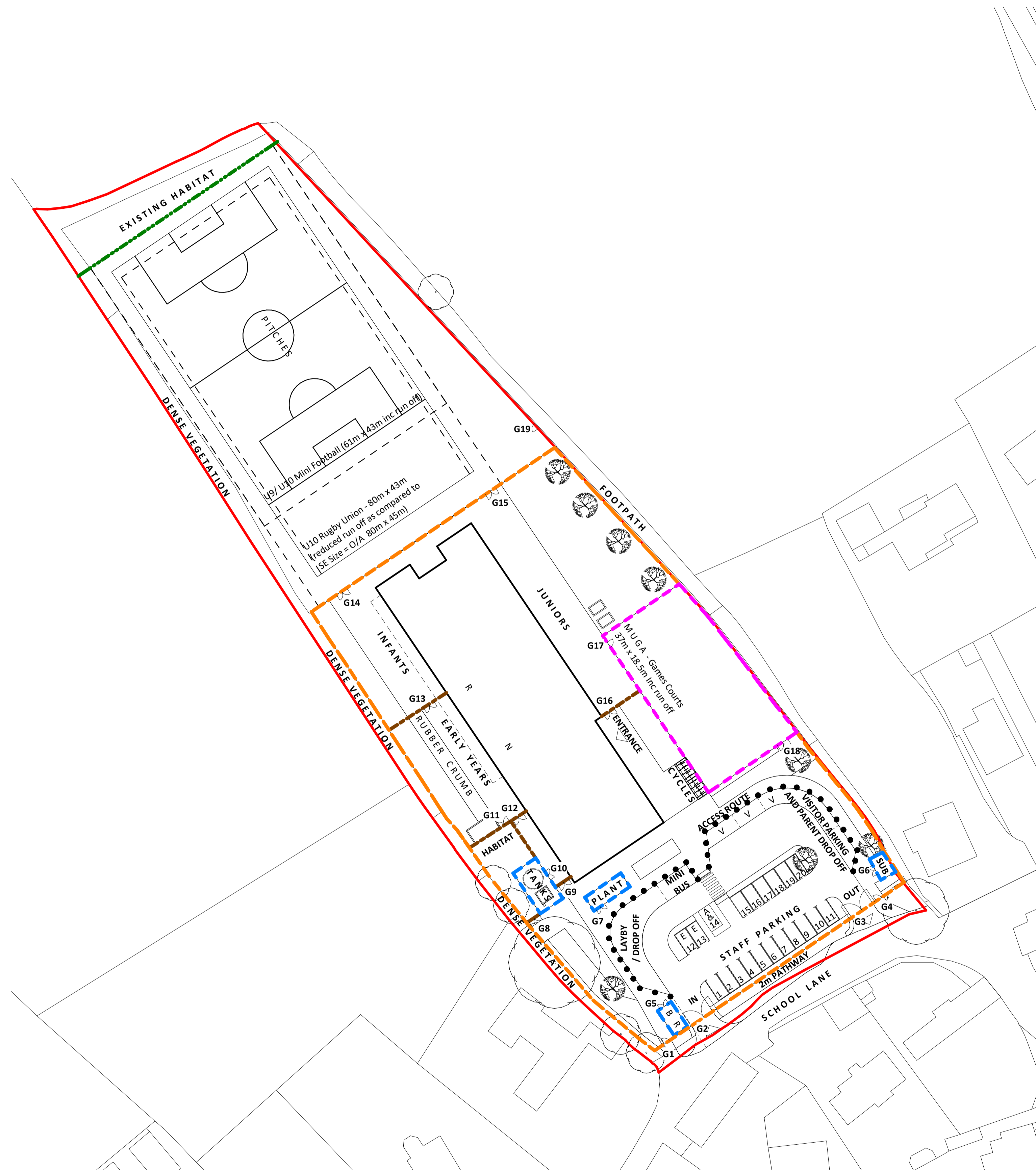

Fencing and Site Security Plan
1 : 500

STATUS	REV	DATE	DESCRIPTION	REVISED BY
S4	P03	29/10/20	Parking layout updated following comments from highways department.	CCM
S4	P02	16/10/20	Stage 4 Issue	CCM
PL	PL07	30/09/20	Updated anotation and planting for planning	CS
PL	PL06	17/09/20	Highways input update for discharge of conditions	CS
PL	PL05	11/09/20	For discharge of conditions	CS
PL	PL04	09/09/20	Amended for Planning Issue	CS
S4	P01	07/09/20	For Stage 3 Issue	CS
PL	PL03	25/06/20	For Planning	CS
PL	PL02	15/06/20	PAC Submission	CS
PL	PL01	12/06/20	PAC Submission	CS

Vale of Glamorgan Council
 CONSULTANT
STRIDE TREGLOWN
 www.stridetreglow.com © Stride Treglow Limited 2020
 PROJECT
 St Nicholas Primary School

STATUS CODE
S4 : Suitable for stage approval SCALE
 1 : 500@A1
 DRAWING USAGE:
 PROJECT - ORIGINATOR - VOLUME - LEVEL - TYPE - ROLE - CLASS - NUMBER STATUS - REVISION
 SNPS-STL-XX-XX-DR-L-9004 S4_P03

DRAWING TITLE
Fencing and Site Security Plan