

Responsibility is not accepted for errors made by others in scaling from this drawing.
All construction information should be taken from figured dimensions only.

Legend

- Site boundary.
- - - Fence.
Refer to drawing SNPS-STL-XX-XX-DR-L-9004 Fencing and Security Plan for details.
- Hard Landscape**
- Paving units to school building entrance. 'Academy' concrete paving units, by Charcon, 400x400x65mm in Grey colour. Build-ups to engineers spec, heavy loading build-ups to the maintenance zone.
- Tarmac surfacing to MUGA. Permeable tarmac to be confirmed by Drainage Engineers.
- Tarmac surfacing to vehicular zones. Heavy duty tarmac surfacing, recycled sub-base to gain BREEAM points. Build-ups to engineers details.
- Concrete surfacing to cycle shelter zone, plant, substation, refuse and sprinkler tank stores. Drainage to refuse store to engineers specification. In situ poured concrete with concrete 50mm pin kerb edging.
- Tarmac to playgrounds and maintenance zones. Build-ups to accommodate maintenance vehicle loading, recycled sub-base to gain BREEAM points. To engineers final specification.
- Play surfacing to nursery/reception zone. Wetpour surfacing, colour to match architectural facade panels. Critical fall height by DCM to 1.5m. Refer to manufacturers specification and build-ups.
- Thermoplastic paint markings to car parking and loading bays. White/yellow colour to British Standards.
- Tactile paving to pedestrian crossings. British Standard 'Blister' paving in Charcoal colour, by Charcon. 400x400x50mm. Build-ups to engineers specification.
- External Furniture and Special Features**
- Growing gardens. 3No. raised timber sleeper planters, to be planted up by the school children.
- Cycle canopy and stands. 2No. 'Apollo Junior' cycle shelters 4100mm length. Base plated, Galvanised steel. To include 2No. 'Sheffield' cycle stand racks 10No. hoops in total. Galvanised steel, surface fixed.
- Bollards. 40no. 'Swansea' galvanised steel bollards, 1000mm height above ground, 114mm diameter, root fixed at 2.5m centres. To include reflective banding. Removable bollards proposed where maintenance is required, including drop kerbs for maintenance vehicle access.

NOTE:
For drainage information refer to engineers plans and details

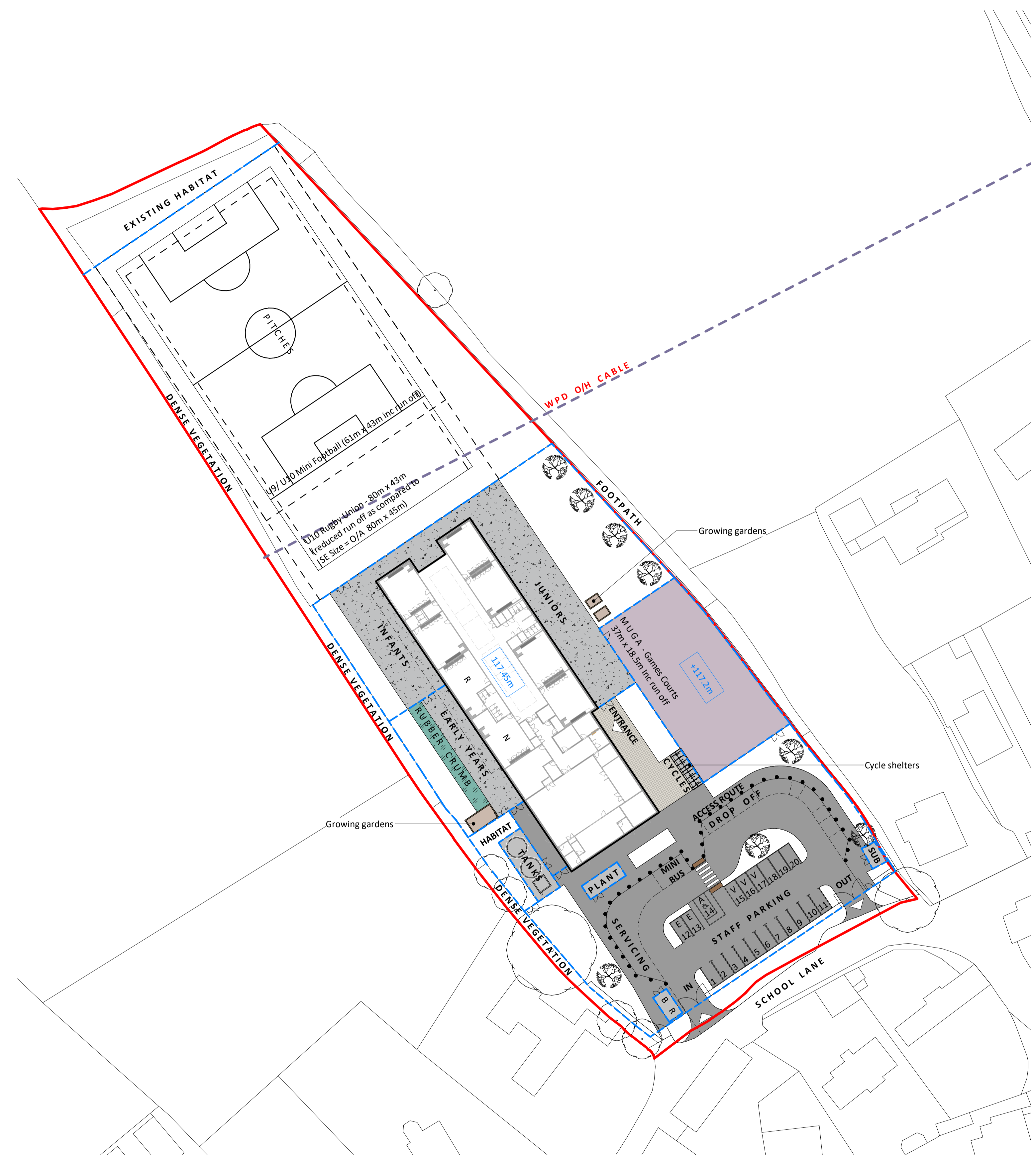

Hard Landscape and External Furniture Plan
1 : 500

PL	PL03	29/06/20	For Planning	REVISED BY	CCM
PL	PL02	15/06/20	PAC Submission	CHECKED BY	CS
PL	PL01	12/06/20	PAC Submission	ORIGINATOR NO	152853
CLIENT	Vale of Glamorgan Council				CONSULTANT
					STRIDE TREGLOWN
					www.stridetreglown.com © Stride Treglown Limited 2020
					PROJECT
					St Nicholas Primary School

DRAWING TITLE		SCALE
Hard Landscape and External Furniture Plan		1 : 500@A1
STATUS CODE	PL : Authorized and accepted	
DRAWING USAGE:		
PROJECT - ORIGINATOR - VOLUME - LEVEL - TYPE - ROLE - CLASS - NUMBER	STATUS - REVISION	
SNPS-STL-XX-XX-DR-9002	PL_PL03	