

VALE OF GLAMORGAN COUNCIL
AMENDED PLANS
RECEIVED Date.....

2015/00601/RES
Rec'd 1-10-2015

THE VALE OF GLAMORGAN COUNCIL
TOWN AND COUNTRY PLANNING ACT 1990
APPROVED
SUBJECT TO COMPLIANCE WITH CONDITIONS (IF ANY)

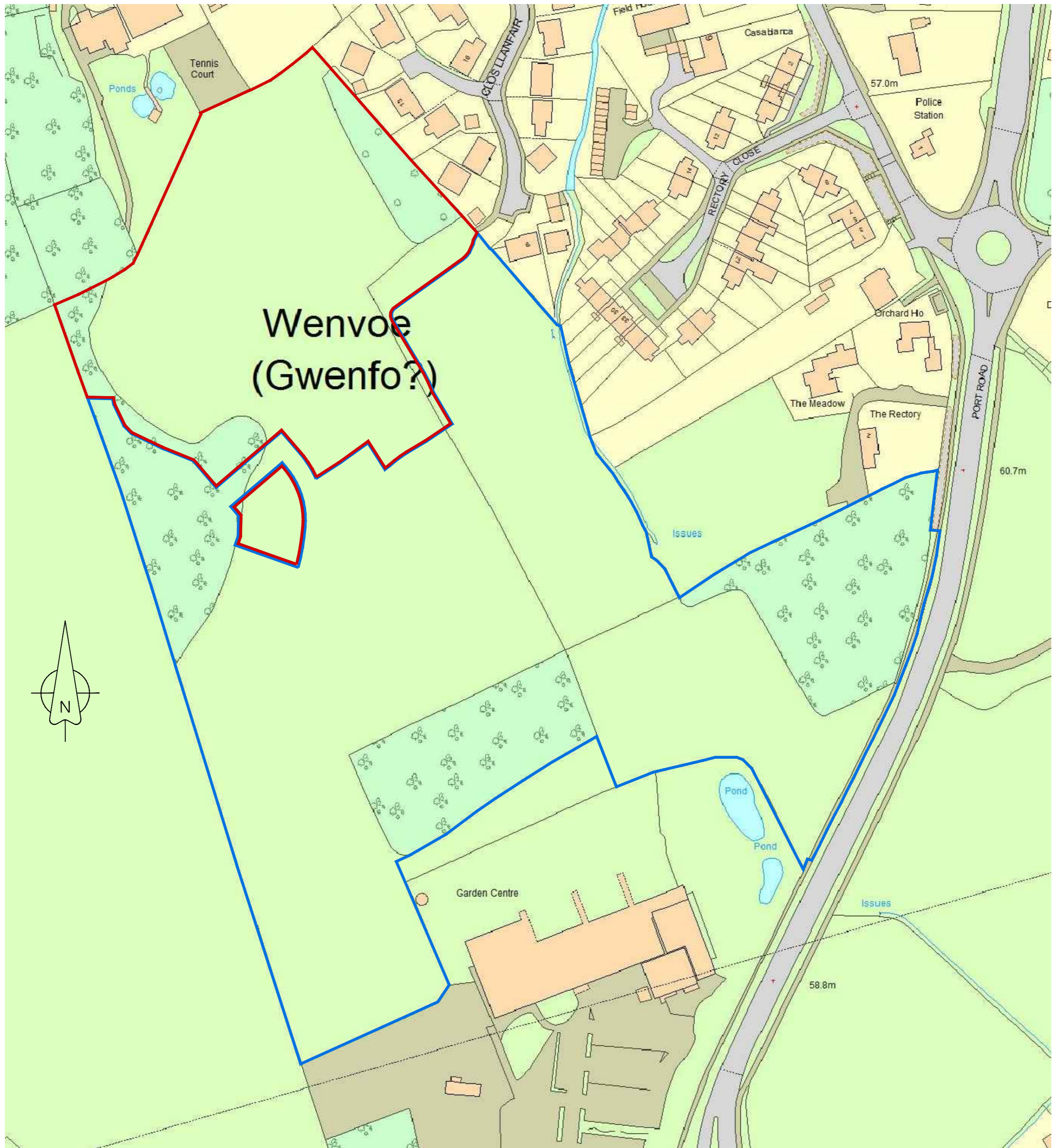

A AMENDED SITE BOUNDARY 30.09.15 AMLG

Revisions
Project: PORT ROAD, WENVOE (PHASE 2 RE-PLAN)

Client: 
REDROW

Drawing: LOCATION PLAN

Scale: 1/1250 @ A2 Date: 02.04.15 Drawn by: AMLG

Drawing No: 13034.PH2.100 Rev: A



CLANCY DESIGN SERVICES LTD
Unit 13, Capitol Park, Pearce Way, Gloucester, GL2 5YD
TEL/FAX: 01452 502003 email: mail@clancydesignservices.com

This drawing is the copyright of Clancy Design Services Ltd. No liability will be accepted for amendments by others to either the printed or digital format.

Drg. Status: PLANNING