

Refer to YYDE-HLM-00-00-DR-L-45002

Refer to YYDE-HLM-00-00-DR-L-45004

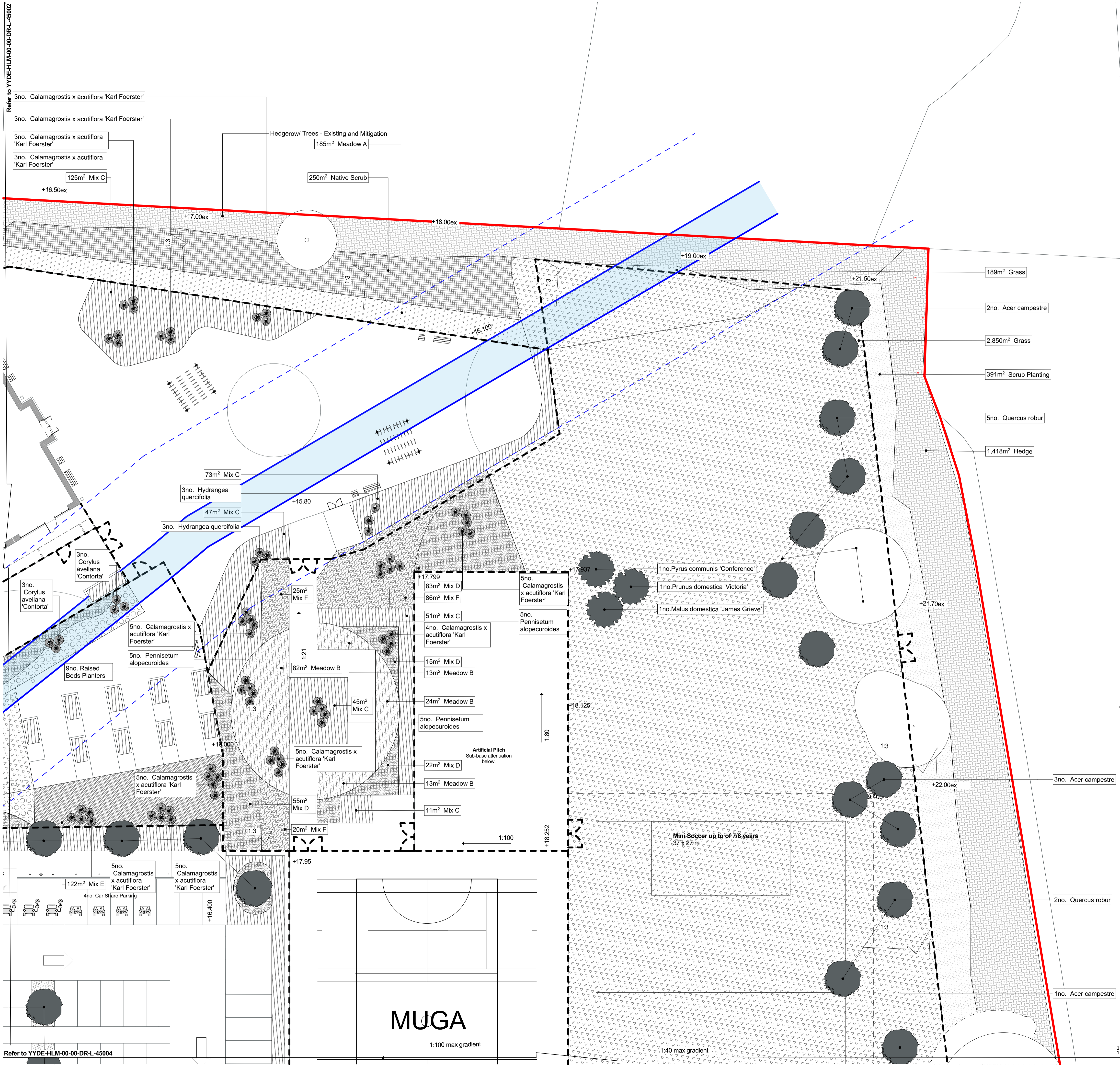

KEY

- SITE BOUNDARY**
- EXISTING UNDERGROUND SEWER**
To be retained
- TREES AND FEATURE PLANTING**
Tree locations subject to change slightly once fully coordinated with underground services
- EXISTING TREE PLANTING**
To be retained
- EXISTING TREE PLANTING**
To be removed
- PROPOSED TREE PLANTING**
- PROPOSED ORCHARD TREE PLANTING**
- ROOT PROTECTION BARRIER**
Location and extent to be co-ordinated in conjunction with underground services.
- PROPOSED SPECIMENS**
- EXISTING HEDGE**
To be protected and retained.
- TRANSLOCATION OF EXISTING HEDGE (TEH)**
To be retained
- ORNAMENTAL PLANTING MIXES**
 - MIX A**
Rain garden planting
 - MIX B**
Simple groundcover planting
 - MIX C**
Groundcover mix with wide species variety
 - MIX D**
Medium height planting
 - MIX E**
Shade tolerant planting
 - MIX F**
Tall planting
 - MIX G**
Sensory planting
- GRASS AND MEADOW MIXES**
 - PROPOSED ECOLOGICAL MEADOW MIX A**
e.g. EM3F Special General Purpose Wild Flowers mix by Emorsgate seeds or equal and approved
 - PROPOSED MEADOW MIX B**
e.g. Pictorial Meadow's 'Cottage Garden' perennial mix or equal and approved
 - PROPOSED AMENITY GRASS SEED TO GENERAL AREAS**
e.g. Germinall Seeds 'A19 All Purpose Landscaping' or equal and approved
 - PROPOSED PLANTING TO RAISED BEDS IN HORTICULTURE AREA**
To be planted by school students
- SCURB PLANTING**
 - PROPOSED NATIVE SCRUB PLANTING**
Acer campestre
Carpinus betulus
Calluna vulgaris
Corylus avellana 'Contorta'
Viburnum opulus
 - PROPOSED NATIVE SCRUB RECLAIMED PLANTING**
Acer campestre
Cornus alba
Crataegus monogyna
Corylus avellana 'Contorta'
Rosa canina
Prunus spinosa
Viburnum opulus
- BULBS PLANTING**
 - PROPOSED BULBS PLANTING MIX**
Allium afflatunense
Galanthus nivalis
Narcissus pseudonarcissus 'Lobularis'
Tulipa 'Spring Green'
- SWALE PLANTING**
 - PROPOSED SWALE PLANTING MIX**
Iris pseudacorus
Carex riparia
Carex nigra
Carex acutiformis
Sparganium erectum
Typha angustifolia

Notes
Check all dimensions on site. Do not scale from this drawing
Report any discrepancies and omissions to HLM Architects
This Drawing is Copyright ©

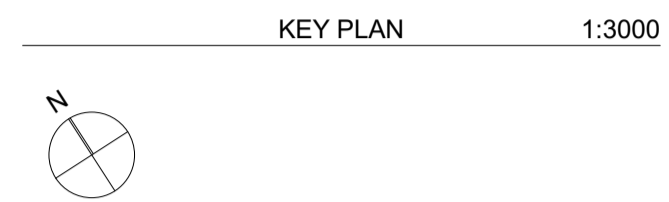
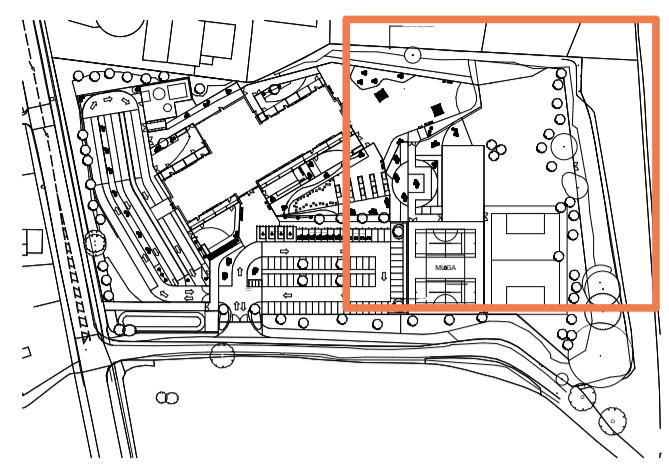

Rev	Description	Date	By	Chk	Suitability
P05	ISSUED FOR PLANNING	11.10.22	SL	AO	
P04	ISSUED FOR PLANNING	08.10.22	SL	IB	
P03	ISSUED FOR STAGE 4	01.05.22	SL	IB	
P02	ISSUED FOR COMMENT	28.07.22	SL	IB	
P01	ISSUED FOR COMMENT	21.06.22	SL	IB	

15-1077-01
Ysgol Y Deri -
Primary School

Client
Vale of Glamorgan Council
Title

SOFT LANDSCAPE PLANTING PLAN - SHEET 2 OF 3

Drawing No. **YYDE-HLM-00-00-DR-L-45003** Revision **P05**

Scale @ A1
1:200, 1:3000
Date
11.10.22
Drawn
SL
Checked
AO



© HLM Architects
Suite 104
The Creative Quarter
Morgan Arcade
The Hayes
Cardiff CF10 1AF
www.hlmarchitects.com
T. +44 (0) 29 2039 6070
F. +44 (0) 29 2039 6080
cardiff@hlmarchitects.com