

Refer to YYDE-HLM-00-00-DR-L-30002

Refer to YYDE-HLM-00-00-DR-L-30004

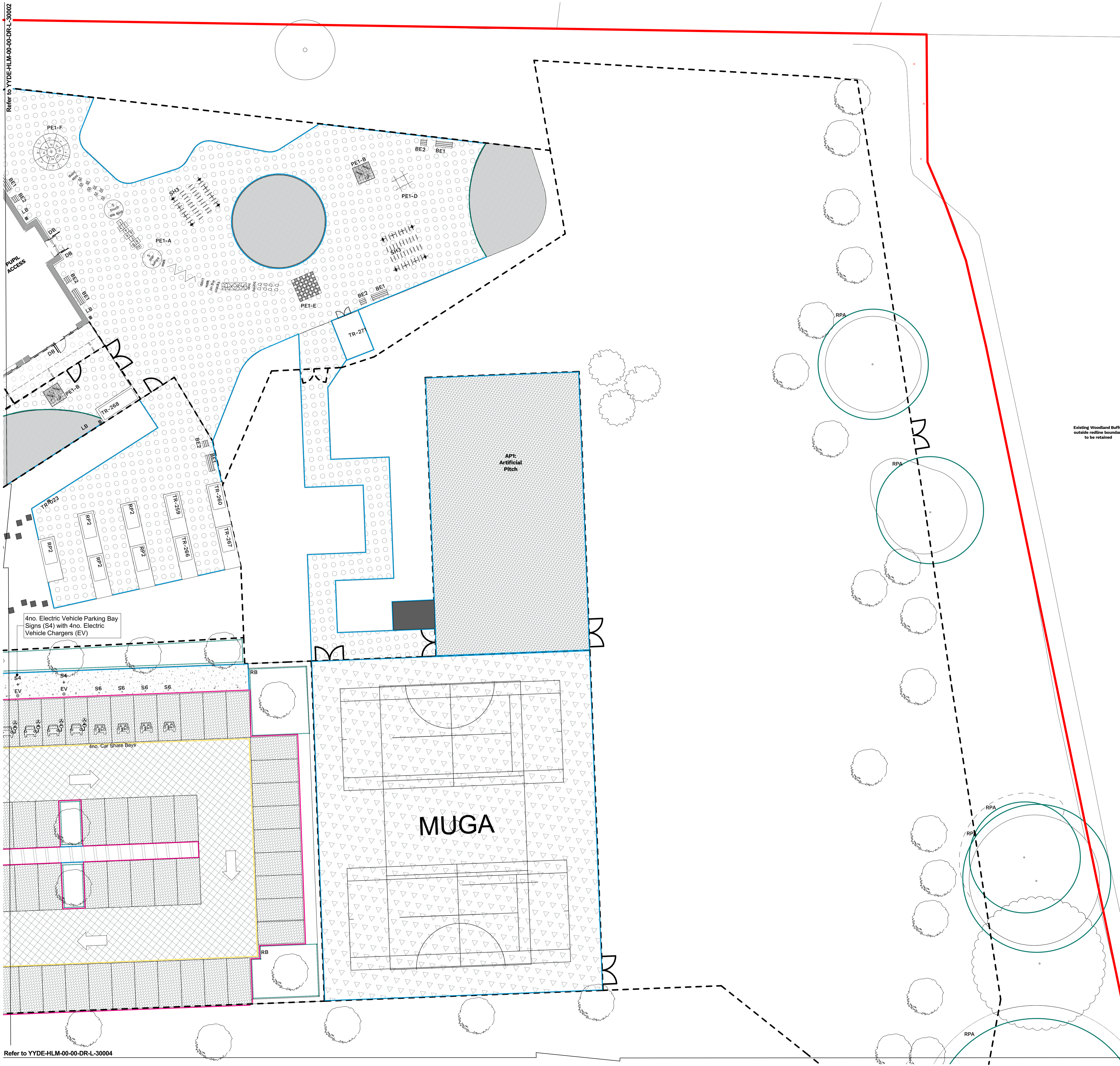

- KEY**
- SITE BOUNDARY**
- HARD LANDSCAPE**
- AP1 - Artificial pitch**
To Engineer's specification
SS_30_14_14_50_80
 - AS2 - Porous Asphalt - Vehicular grade**
To Engineer's specification
 - AS3 - Porous asphalt - To MUGA**
Black with thermoplastic line markings for up to 3 sports in various colours
To Engineer's specification
SS_30_14_05_70
 - CC1 - Concrete**
To Engineer's specification
 - GV1 - Resin bound gravel suitable for pedestrian / MEWP access**
Addagrip 'Addabound' or equal approved 6mm, Golden Beach
Ss_30_14_02_70
 - GV2 - Resin bound gravel suitable for pedestrian / MEWP access**
Addagrip 'Addabound' or equal approved 6mm, Oyster Resin
Ss_30_14_02_70
 - GV2 - Resin bound gravel suitable for vehicular access**
Addagrip 'Addabound' or equal approved 6mm, Oyster Resin. Refer to Engineer's specification.
Ss_30_14_02_70
 - PA1 - Paving flags**
Silver Granite
Spec ref: Ss_30_14_90_85
 - PB - Porous block paving**
To Engineer's specification
Ss_30_14_90_62
 - WP1 - Wet Pour Rubber Mat**
Wet pour rubber safety matting for play areas
To Engineer's specification
Indicative area for future play equipment to be installed by others. Note that MEWP access has been designed around these locations, so any proposed play equipment put in must take this into account.
Ss_30_14_02_41
- FENCING**
- Fencing**
Refer to fencing drawing YYDE-HLM-00-00-DR-L-25000 SITE SECURITY & FENCING PLAN
 - Gate**
Refer to gate drawing YYDE-HLM-00-00-DR-L-25000 SITE SECURITY & FENCING PLAN
- FURNITURE**
- BE1 & BE2 Fixed Seating**
Material: Powder coated steel, timber
Spec ref: Ss_40_20_30_28
 - RP1 Raised Planters**
Langley Design Sheldon SPL305 or equal approved.
Spec ref: Ss_45_40_28_25
 - RP2 Raised Planters with table**
Langley Design Sheldon SPL305 or equal approved.
Spec ref: Ss_45_40_28_25
 - DB Door barrier**
Stainless steel
450 x 1020mm
Spec ref: Ss_25_15_60_37
 - LB Litter Bin**
Material: Timber clad galvanised steel
Size: 75L
Spec ref: Ss_40_20_30_30
 - SH1 Storage Shelter**
A large metal shed, with security features to keep all playground equipment locked away safely.
Spec reference: Pr_40_30_28_34
 - SH2 Canopy / shelter**
Anticlimb design. Located around building canopy. To Architect's detail.
 - SH3 Pergola**
Pergola
Ss_20_10_70_62
 - SH4 Cycle Shelter**
With green roof
Ss_20_10_70_84
 - SH5 Scooter Storage Unit**
Pr_40_30_21_76
 - PE1 Thermoplastic playground markings**
A range of playground linemarkings in various colours to be provided across all play areas.
Pr_35_31_85_88
 - Root Protection Area (RPA)**
 - Sewage Pumping Station (SPS)**
Sewage pumping station for foul drainage, pumping approximately 300m to the north east along Lavernock Rd, connecting to DCWW manhole ST17699103. Refer to Civil Engineer drawing:

Notes
Check all dimensions on site. Do not scale from this drawing
Report any discrepancies and omissions to HLM Architects
This Drawing is Copyright ©

KEY PLAN 1:3000

MA Motorbike anchors
Motor cycle security ground anchor-retractable-extra heavy duty with zinc plated finish, 100 x 100mm
Spec ref: Ss_25_16_94_10

BL1 Bollards
To protect building from accidental vehicle collision where there is a dropped kerb.
Stainless steel. 114mm dia. x 900mm high
Spec ref: Ss_25_16_94_10

EV EV Charger
EV charger to be high impact resistant polycarbonate finish
1440mm high, 382.5 x 262.5mm
Spec ref: Ss_25_16_94_10

EG1 - HB2 kerb
Concrete
125mm upstand, 125 x 255mm
Spec ref: Ss_30_75_45_85

EG2 - Edging pin kerb
Concrete
0mm upstand, 50 x 150mm
Spec ref: Ss_30_75_45_45

EG3 - Bullnosed kerb
Concrete
0-6mm upstand, 125 x 255mm
Spec ref: Ss_30_75_45_85

EG4 - Flush kerb
Concrete
0mm upstand, 125 x 255mm
Spec ref: Ss_30_75_45_85

EG5 - Dropper / transition kerb
Concrete
Spec ref: Ss_30_75_45_85

EG6 - Metal landscape edge
Steel
Spec Ref: Ss_30_75_45_45

EG7 - Crash Barrier
Steel
To Engineer's specification

Revisions	Submittal
Project	S4

15-1077-01
Ysgol Y Deri -
Primary School

Client
Vale of Glamorgan Council

HARD LANDSCAPE
PLAN SHEET 2 OF 3

Drawing No. **YYDE-HLM-00-00-DR-L-30003** P05

Scale @ A1 1:3000, 1:200 Drawn SL
Date 21.10.22 Checked IB

HLM Architects

© HLM Architects
Suite 104
The Creative Quarter
Morgan Arcade
The Hayes
Cardiff CF10 1AF

www.hlmarchitects.com
T. +44 (0) 29 2039 6070
F. +44 (0) 29 2039 6080
cardiff@hlmarchitects.com