

© COPYRIGHT
The copyright in this drawing is vested in Sheppard Robson and no license or assignment of any kind has been, or is, granted to any third party whether by provision of copies or originals or otherwise unless agreed in writing.

DO NOT SCALE FROM THIS DRAWING
The contractor shall check and verify all dimensions on site and report any discrepancies in writing to Sheppard Robson before proceeding work

FOR ELECTRONIC DATA ISSUE
Electronic Data / drawings are issued as "read only" and should not be interrogated for measurement. All dimensions and levels should read, only from those values stated in text on the drawing.

— Site application boundary

REV.	DATE	AMENDMENT
P01	18.12.2023	Issued for Pre Application Consultation
C01	25.03.2024	Issued for Planning
C02	04.04.2024	Issued for Planning
C03	23.04.2024	Issued for Planning
C04	24.04.2024	Issued for Planning

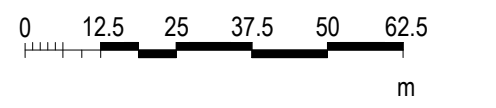

KEYPLAN

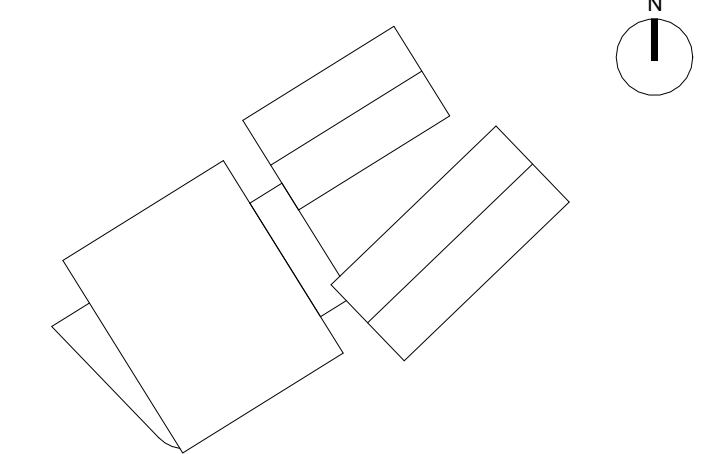

CLIENT

Cardiff and Vale College



SHEPPARD ROBSON

77 Parkway Camden Town London NW1 7PU
T: +44 (0)20 7504 1700 E: enquiries@sheppardrobson.com

PROJECT
Advanced Technology Centre

SCALE@A1	DATE	ORIGINATOR	CHECKED	AUTHORISED
1: 1250	24.04.2024	DC	MC	JJ

Location Plan

WEPCo 2 / RIBA 4

STATUS	PURPOSE FOR ISSUE	SR NO.
A2	Planning Application Submission	6653

DRAWING NO.	REV.
VG0101-SRA-ZZ-ZZ-DR-A-02000	C04

