

Location Plan

KEY CONTINUED

	Concrete surface To Engineer's specification
	Resinbound Gravel Location: To external social areas
	Blister Paving Location: To crossing points
	Decorative Gravel
Furniture	
	S1 Double Stacked Cycle Rack For long stay cycle parking
	S2 Cycle Shelter
	S3 Seating Bench
	S4 Picnic Bench
	S5 EVCP To Engineers Specification For short stay cycle parking
	S6 Cycle Stands For short stay cycle parking
	S7 Dining Furniture
	S8 Timber Feature Bench Location: To entrance areas
	S9 Raised Planter with Timber Seating
	S10 Door Protection Barrier
	S11 Motorcycle Anchor
	S12 Litter Bin
	S13 Removable Bollard
	S14 Fixed Bollard
	S15 Boulders
	S16 Rising Arm Barrier
Fencing and Structures	
	Proposed Fencing Refer to Fencing General Arrangement for details
	Proposed Gates Refer to Fencing General Arrangement for details
	W1 Retaining Wall Gabion baskets Details TBC
	W2 Feature Wall As per Architect's drawings

Note
 1. Do not scale from this drawing
 2. To be read in conjunction with Project Risk Register REF: XXX
 3. To be read in conjunction with all other Landscape Architect's drawings

KEY

	Site Boundary
	Proposed Building
	Canopy / Building Overhang
	Existing Tree
	Existing Tree to be removed
	Existing Wall to be removed
	Primary Building Entrance
	Secondary Building Entrance
	Vehicle Workshop Entrance
Planting	
	Proposed Tree Refer to Planting Strategy
	Proposed Multi-stem Tree Refer to Planting Strategy
	Grass Seed Refer to Planting Strategy
	Turf Refer to Planting Strategy
	Amenity Planting Refer to Planting Strategy
	Rain garden Planting Refer to Planting Strategy
	Swale Planting Refer to Planting Strategy
	Wildflower Meadow Planting Refer to Planting Strategy
	Woodland Edge Planting Refer to Planting Strategy
	Native Buffer Planting Refer to Planting Strategy
	Dense Native Buffer Planting Refer to Planting Strategy
	Ornamental Planting Refer to Planting Strategy
	Hedge Planting Refer to Planting Strategy
Paving	
	P1 Pedestrian Macadam To Engineer's Specification
	P2 Vehicular Macadam To Engineer's Specification
	P3a Concrete Block Paving Laid in a stretcher bond Location: To entrances and pathways
	P3b Concrete Block Paving Laid in a stretcher bond Location: To entrances and pathways
	P4 Concrete Block Paving Laid in a stretcher bond Location: To entrances and pathways
	P5 Permeable Block Paving Laid in herringbone bond Location: To parking bays
	P6 MUGA Permeable Surface As per engineer's specification

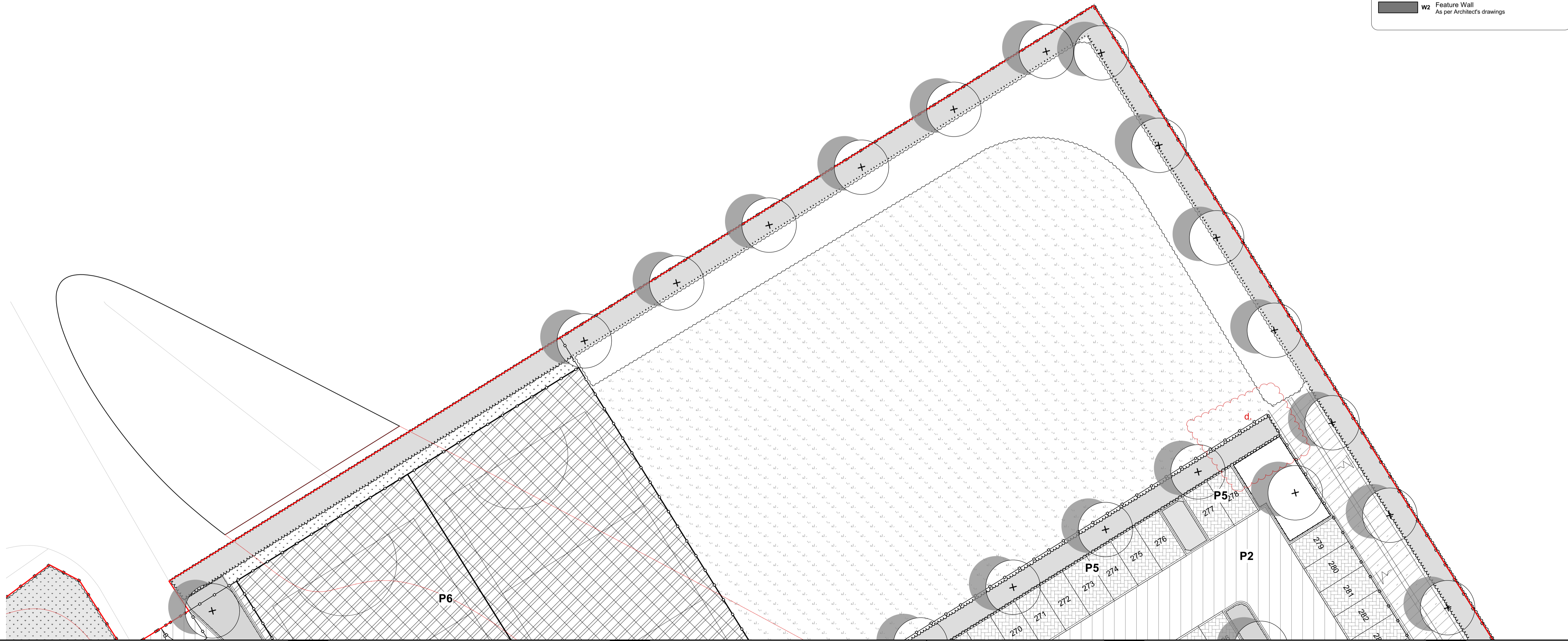

Refer to Drawing : VG0101-ALA-00-XX-DR-L-00013

Refer to Drawing : VG0101-ALA-00-XX-DR-L-00014

ID	RISK	MITIGATION	DATE MITIGATED
RESIDUAL PROJECT RISKS			

DATE	REV	DESCRIPTION OF REVISION	DRAWN BY	APPROVED BY
31/05/2024	P07	Issued for Planning a. Arm barrier added to vehicular entrance and road widened to allow for pedestrian access b. Retaining gabion wall layout updated c. Service yard hard surface changed from vehicular lanes to concrete surfacing d. Extended hedgerow added as a response to ecological officer comment	MDS	MH

REVISIONS

STATUS
A2 - Authorised and Accepted as Planning Application Submission

Ares Landscape Architects LTD
 Gatecrasher,
 51 Eyre Lane
 Sheffield
 S1 4RB
 t: 0114 276 2000
 e: hello@aresdesign.co.uk
 w: ares.eu.com

CLIENT:
Cardiff and Vale College

PROJECT TITLE:
Advanced Technology Centre

DRAWING TITLE:
Detailed General Arrangement 5 of 5

DRAWING SCALE: 1:200
 PAPER SIZE: A1

DRAWN BY: MDS
 APPROVED BY: HT

DRAWN DATE: 12/10/2023
 ALA PROJECT CODE: ALA723

DRAWING NUMBER:
VG0101-ALA-ZZ-DR-L-00015 A2

STATUS:
P07