

Refer to Drawing : VG0101-ALA-00-XX-DR-L-00015

**Note**  
 1. Do not scale from this drawing  
 2. To be read in conjunction with Project Risk Register REF: XXX  
 3. To be read in conjunction with all other Landscape Architect's drawings

**KEY CONTINUED**

- P7** Concrete surface  
To Engineer's specification
- P8** Resinbound Gravel  
Location: To external social areas
- P9** Blister Paving  
Location: To crossing points
- P10** Decorative Gravel

**Furniture**

- S1** Double Stacked Cycle Rack  
For long stay cycle parking
- S2** Cycle Shelter
- S3** Seating Bench
- S4** Picnic Bench
- S5** EVCP  
To Engineers Specification
- S6** Cycle Stands  
For short stay cycle parking
- S7** Dining Furniture
- S8** Timber Feature Bench  
Location: To entrance areas
- S9** Raised Planter with Timber Seating
- S10** Door Protection Barrier
- S11** Motorcycle Anchor
- S12** Litter Bin
- S13** Removable Bollard
- S14** Fixed Bollard
- S15** Boulders
- S16** Rising Arm Barrier

**Fencing and Structures**

- Proposed Fencing  
Refer to Fencing General Arrangement for details
- Proposed Gates  
Refer to Fencing General Arrangement for details
- W1** Retaining Wall  
Gabion baskets  
Details TBC
- W2** Feature Wall  
As per Architect's drawings

**KEY**

- Site Boundary
- Proposed Building
- Canopy / Building Overhang
- Existing Tree
- Existing Tree to be removed
- Existing Wall to be removed
- Primary Building Entrance
- Secondary Building Entrance
- Vehicular Workshop Entrance

**Planting**

- Proposed Tree  
Refer to Planting Strategy
- Proposed Multi-stem Tree  
Refer to Planting Strategy
- Grass Seed  
Refer to Planting Strategy
- Turf  
Refer to Planting Strategy
- Amenity Planting  
Refer to Planting Strategy
- Rain garden Planting  
Refer to Planting Strategy
- Swale Planting  
Refer to Planting Strategy
- Wildflower Meadow Planting  
Refer to Planting Strategy
- Woodland Edge Planting  
Refer to Planting Strategy
- Native Buffer Planting  
Refer to Planting Strategy
- Dense Native Buffer Planting  
Refer to Planting Strategy
- Ornamental Planting  
Refer to Planting Strategy
- Hedge Planting  
Refer to Planting Strategy

**Paving**

- P1** Pedestrian Macadam  
To Engineer's Specification
- P2** Vehicular Macadam  
To Engineer's Specification
- P3a** Concrete Block Paving  
Laid in a stretcher bond  
Location: To entrances and pathways
- P3b** Concrete Block Paving  
Laid in a stretcher bond  
Location: To entrances and pathways
- P4** Concrete Block Paving  
Laid in a stretcher bond  
Location: To entrances and pathways
- P5** Permeable Block Paving  
Laid in herringbone bond  
Location: To parking bays
- P6** MUGA Permeable Surface  
As per engineer's specification

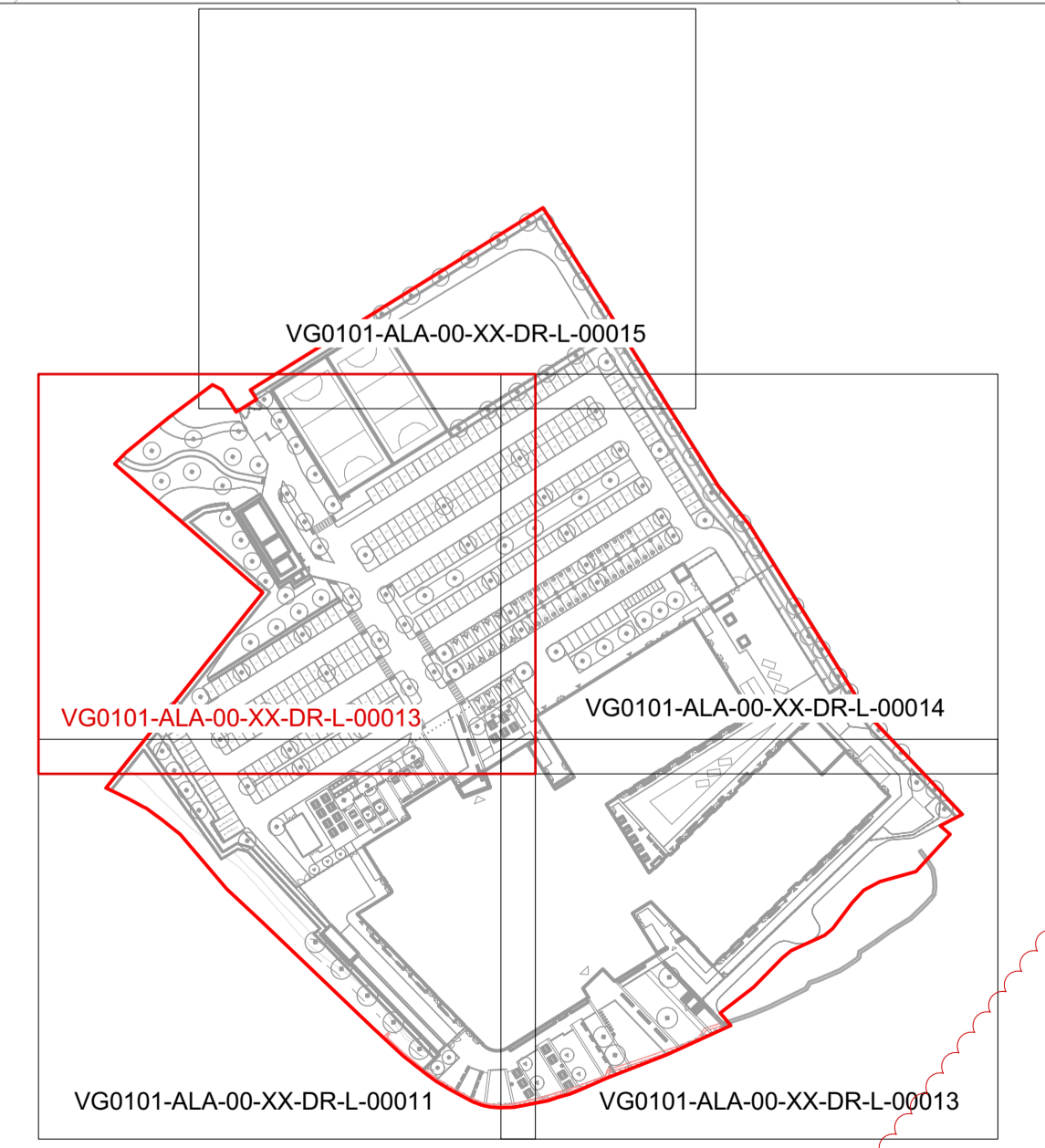

Location Plan

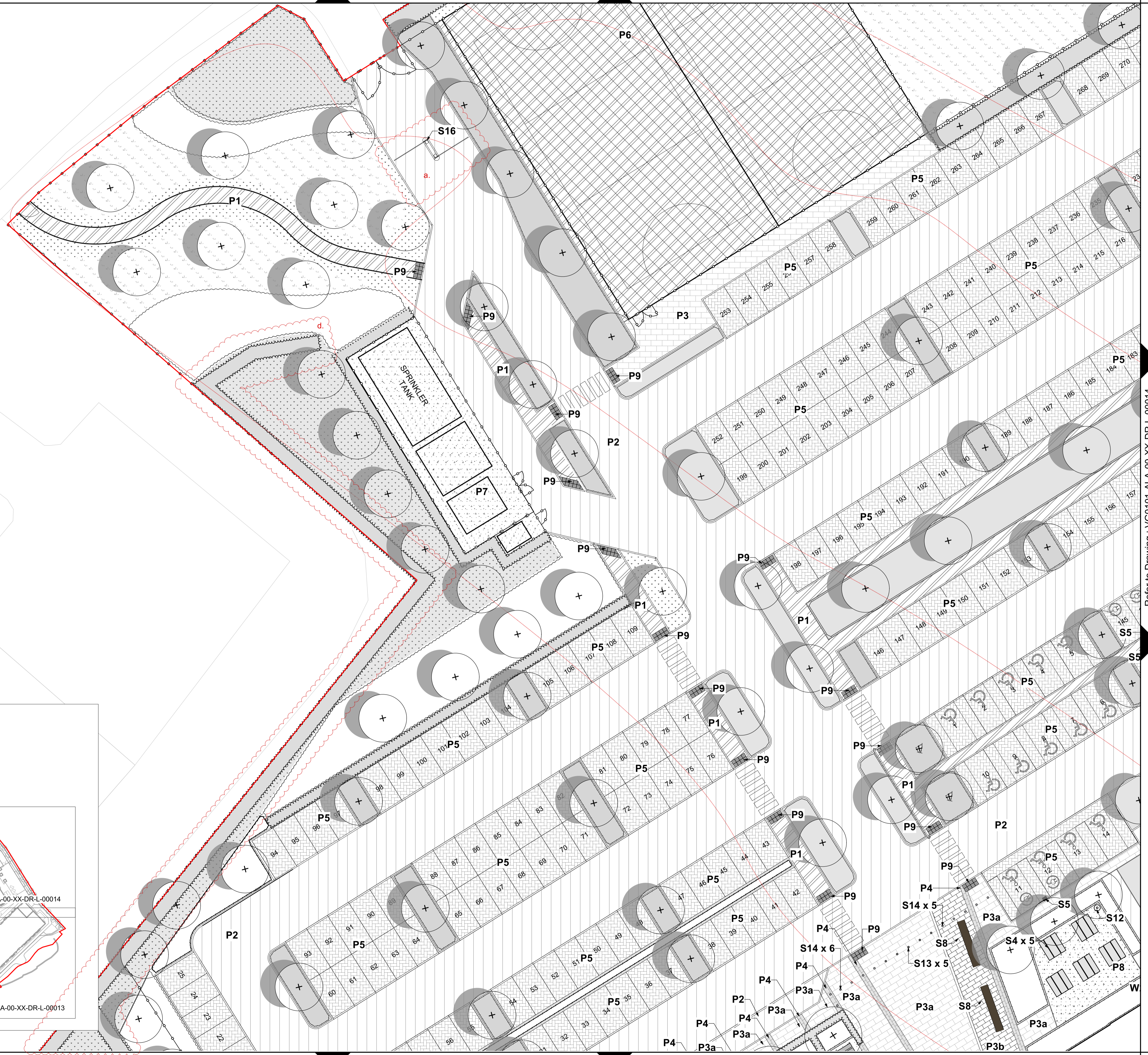

Refer to Drawing : VG0101-ALA-00-XX-DR-L-00011

Refer to Drawing : VG0101-ALA-00-XX-DR-L-00014

ID	RISK	MITIGATION	DATE MITIGATED
<b>RESIDUAL PROJECT RISKS</b>			

DATE	REV	DESCRIPTION OF REVISION	DRAWN BY	APPROVED BY
31/05/2024	P07	Issued for Planning a. Arm barrier added to vehicular entrance and road widened to allow for reduced access b. Retaining gabion wall layout updated c. Service yard hard surface changed from vehicular to concrete surfacing d. Extended hedgerow added as a response to ecological officer comment	MDS	MH

**REVISIONS**

STATUS  
**A2 - Authorised and Accepted as Planning Application Submission**

**ares**  
 LANDSCAPE ARCHITECTS

Ares Landscape Architects LTD  
 Gatecrasher,  
 51 Eyre Lane  
 Sheffield  
 S1 4RB  
 t: 0114 276 2000  
 e: hello@aresdesign.co.uk  
 w: ares.eu.com

CLIENT:  
**Cardiff and Vale College**

PROJECT TITLE:  
**Advanced Technology Centre**

DRAWING TITLE:  
**Detailed General Arrangement 3 of 5**

DRAWING SCALE: 1:200  
 PAPER SIZE: A1

DRAWN BY: MDS  
 APPROVED BY: HT

DRAWN DATE: 12/10/2023  
 ALA PROJECT CODE: ALAT23

DRAWING NUMBER:  
**VG0101-ALA-ZZ-DR-L-00013 A2**

STATUS:  
**P07**