

Refer to Drawing : VG0101-ALA-00-XX-DR-L-00015

Note
 1. Do not scale from this drawing
 2. To be read in conjunction with Project Risk Register REF: XXX
 3. To be read in conjunction with all other Landscape Architect's drawings

KEY CONTINUED

- P7** Concrete surface
To Engineer's specification
- P8** Resinbound Gravel
Location: To external social areas
- P9** Blister Paving
Location: To crossing points
- P10** Decorative Gravel

Furniture

- S1** Double Stacked Cycle Rack
For long stay cycle parking
- S2** Cycle Shelter
- S3** Seating Bench
- S4** Picnic Bench
- S5** EVCP
To Engineers Specification
- S6** Cycle Stands
For short stay cycle parking
- S7** Dining Furniture
- S8** Timber Feature Bench
Location: To entrance areas
- S9** Raised Planter with Timber Seating
- S10** Door Protection Barrier
- S11** Motorcycle Anchor
- S12** Litter Bin
- S13** Removable Bollard
- S14** Fixed Bollard
- S15** Boulders

Fencing and Structures

- Proposed Fencing
Refer to Fencing General Arrangement for details
- Proposed Gates
Refer to Fencing General Arrangement for details
- W1** Retaining Wall
Gabion baskets
Details TBC
- W2** Feature Wall
As per Architect's drawings

KEY

- Site Boundary
- Proposed Building
- Canopy / Building Overhang
- Existing Tree
- Existing Tree to be removed
- Existing Wall to be removed
- Primary Building Entrance
- Secondary Building Entrance
- Vehicular Workshop Entrance

Planting

- Proposed Tree
Refer to Planting Strategy
- Proposed Multi-stem Tree
Refer to Planting Strategy
- Grass Seed
Refer to Planting Strategy
- Turf
Refer to Planting Strategy
- Amenity Planting
Refer to Planting Strategy
- Rain garden Planting
Refer to Planting Strategy
- Swale Planting
Refer to Planting Strategy
- Wildflower Meadow Planting
Refer to Planting Strategy
- Woodland Edge Planting
Refer to Planting Strategy
- Native Buffer Planting
Refer to Planting Strategy
- Dense Native Buffer Planting
Refer to Planting Strategy
- Ornamental Planting
Refer to Planting Strategy
- Hedge Planting
Refer to Planting Strategy

Paving

- P1** Pedestrian Macadam
To Engineer's Specification
- P2** Vehicular Macadam
To Engineer's Specification
- P3a** Concrete Block Paving
Laid in a stretcher bond
Location: To entrances and pathways
- P3b** Concrete Block Paving
Laid in a stretcher bond
Location: To entrances and pathways
- P4** Concrete Block Paving
Laid in a stretcher bond
Location: To entrances and pathways
- P5** Permeable Block Paving
Laid in herringbone bond
Location: To parking bays
- P6** MUGA Permeable Surface
As per engineer's specification

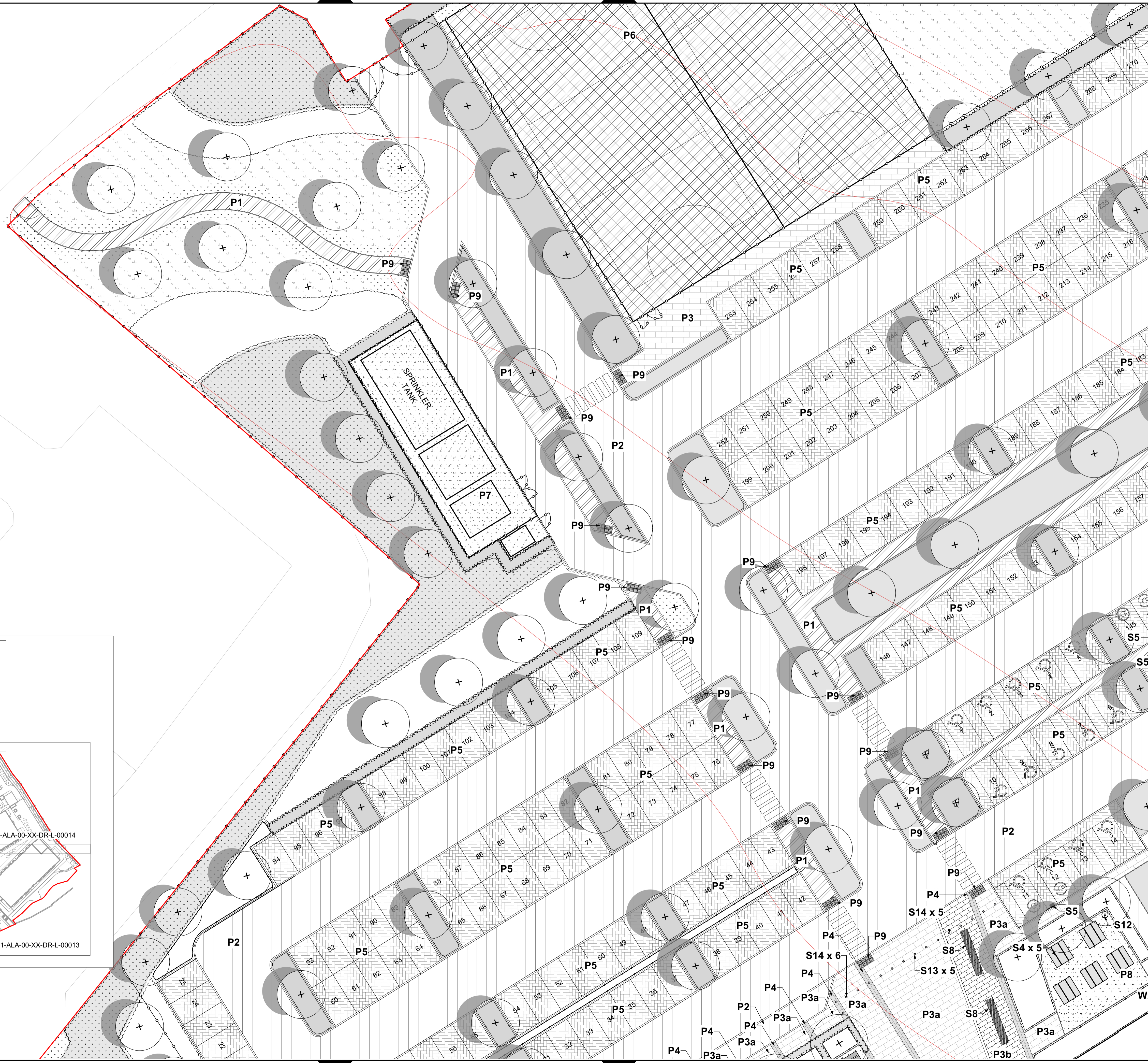
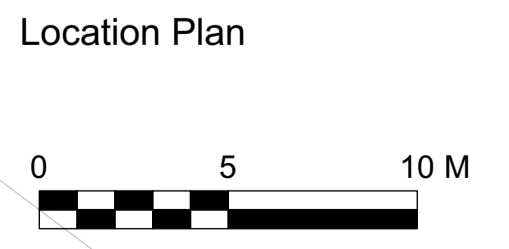
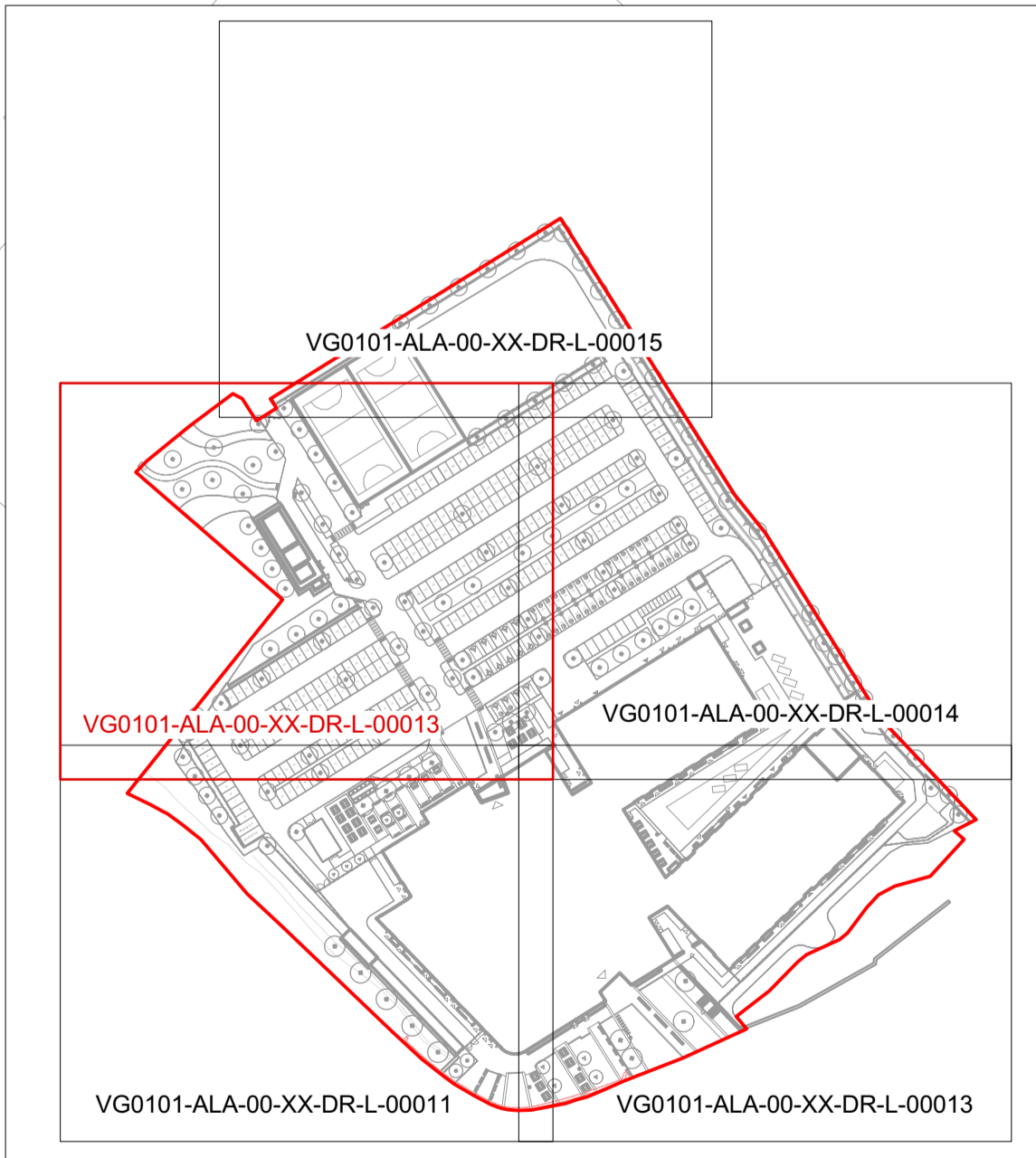

Refer to Drawing : VG0101-ALA-00-XX-DR-L-00014

Refer to Drawing : VG0101-ALA-00-XX-DR-L-00011

ID	RISK	MITIGATION	DATE MITIGATED
RESIDUAL PROJECT RISKS			

DATE	REV	DESCRIPTION OF REVISION	DRAWN BY	APPROVED BY
05/04/2024	P06	Issued for Planning	MH	BH

REVISIONS

STATUS
A2 - Authorised and Accepted as Planning Application Submission

Ares Landscape Architects LTD
 Gatecrasher,
 51 Eyre Lane
 Sheffield
 S1 4RS
 t: 0114 276 2000
 e: hello@aresdesign.co.uk
 w: ares.eu.com

CLIENT:
Cardiff and Vale College

PROJECT TITLE:
Advanced Technology Centre

DRAWING TITLE:
Detailed General Arrangement 3 of 5

DRAWING SCALE: 1:200
 PAPER SIZE: A1

DRAWN BY: MDS
 APPROVED BY: HT

DRAWN DATE: 12/10/2023
 ALA PROJECT CODE: ALAT23

DRAWING NUMBER: VG0101-ALA-00-XX-DR-L-00013
 STATUS: A2
 REVISION: P06