

Station	Easting	Northing	Level
A1	308265.868	176557.543	38.756
A2	308249.472	176580.332	40.728
A3	308234.047	176568.919	39.560

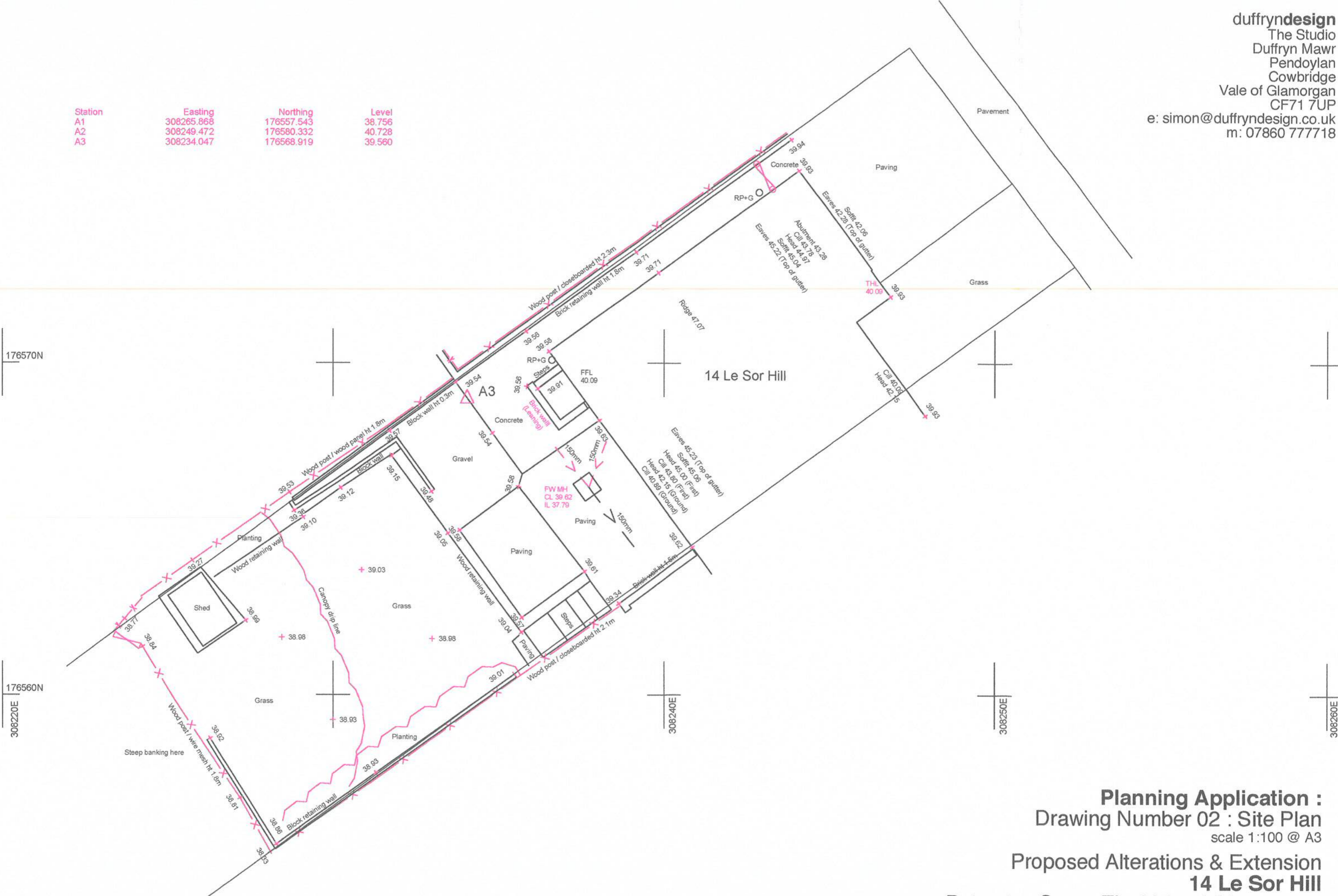

**Planning Application :**  
 Drawing Number 02 : Site Plan  
 scale 1:100 @ A3

**Proposed Alterations & Extension**  
**14 Le Sor Hill**  
 Peterston Super Ely, Vale of Glamorgan,  
 CF5 6LW