

County Series 1:10,560 scale

VEGETATION

	Fir Wood		Deciduous Wood
	Mixed Wood		Brushwood
	Orchard		Reeds
	Rough Pasture		Furze
	Marsh		Osiers

ROADS

	Railway over Road		Road over Railway
	Road over River or Canal		Level Crossing
	Railway over River		Road over Stream
	Road over Stream		Sunken Road
	Raised Road		

RAILWAYS

	Double Lines of Railway		Single Lines of Railway and Tramway
--	-------------------------	--	-------------------------------------

GENERAL FEATURES

	Gravel Pit		Sand Pit
	Quarry		Shingle
	Other Pits		Antiquities, Site of
			Arrow, showing direction of flow of water
			Trigonometrical Station

BOUNDARIES

	County Boundary		Parliamentary Division Boundary
	Parish Boundary		Union Boundary
	Contours		Rural District Boundary

National Grid 1:10,000 scale

HEIGHTS (METRES)

Values are given in metres above mean sea level at Newlyn.

Surface heights determined by ground survey $\pm 163m$
 air survey ± 100

Bench marks and their values are shown on large scale maps, and bench mark lists containing fuller and possibly later levelling information are obtainable from the Director General, Ordnance Survey.

Contours are at 5 metres vertical interval.

ROCK FEATURES

	Loose rock		Vertical face
	Boulders		
	Outcrop		
	Scree		

CONVERSION SCALE

Metres - Feet

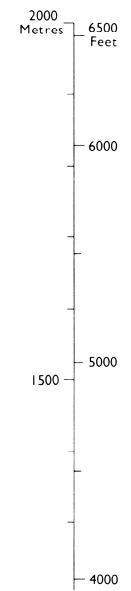

ABBREVIATIONS

BP,BS	Boundary Post or Stone	PO	Post Office
Ch	Church	PC	Public Convenience
CH	Club House	PH	Public House
F Sta	Fire Station	S	Stone
FB	Foot Bridge	Spr	Spring
Fn	Fountain	TCB	Telephone Call Box
GP	Guide Post	TCP	Telephone Call Post
MP,MS	Mile Post or Stone	TH	Town Hall
P	Pole or Post	W	Well
Pol Sta	Police Station	Y	Youth hostel

ROADS

	Road		Track		Path
--	------	--	-------	--	------

Where unfenced shown by pecked lines.

RAILWAYS

	Cutting		Embankment	} Standard gauge
	Multiple track		Single track	
	Road under		Road over	} Siding, tramway or mineral line
	Level crossing		Foot Bridge	
	Narrow gauge			

GENERAL FEATURES

	Antiquity, (site of)		Lake, loch or pond
	Boulders		Sloping masonry
	Building		Chalk pit, clay pit or quarry
	Pylon		Gravel pit
	Pole		Sand pit
	Glasshouse		Refuse or slag heap
	Triangulation station		

VEGETATION

	Bracken, rough grassland		Marsh		Coppice
	Scrub		Saltings		Orchard
	Heath		Reeds		Coniferous trees
					Non-coniferous trees

In some areas bracken () and rough grassland () are shown separately.



Historical Map Pack Legend

County Series & National Grid 1:10,560 scale

Information present on these legends is sourced from the same Ordnance Survey mapping as the maps used in this product.

If you have a query regarding any of the maps provided please contact GroundSure's technical helpline. We will endeavour to answer any queries you may have.

Technical Helpline

Tel 08444159000

groundsureinsight@groundsure.com
www.groundsure.com

County Series 1:2,500 scale

National Grid 1:2,500 / 1:1,250 scale



Historical Map Pack Legend

GENERAL FEATURES

Wood	Marsh	Reeds
Fir	Mixed Wood	Brush Wood
Osiers	Orchard	Bush
Rough Pasture	Furze	Ford
Stepping Stones	Ferry	Sloping Masonry
Flat Rock	Lock	Waterfall
Shingle	Gravel Pit	Quarry
Sand Pit	Refuse Heap	Clay Pit

Trigonometrical Station	Sluice
Altitude at Trigonometrical Station	Trough
Bench Mark	Spring
Surface Level	Well
Permanent Traverse Station	Mooring Ring
Antiquities (site of)	Mooring Post
Arrow denotes flow of water	Boundary Stone
	Boundary Post

GENERAL FEATURES

Non-coniferous Trees	Slopes	Antiquity (site of)
Coniferous Trees	Cliff	Culvert
Surveyed Trees	Cave Entrance	Direction of water flow
Orchard Trees	Rock	Electricity Pylon
Coppice, Osier	Boulders	Electricity Transmission Line
Scrub	Sloping Masonry	Triangulation Station
Bracken	Roofed Building	Traverse Station (permanent)
Heath	Glasshouse	Bench Mark
Rough Grassland	Archway	Surface Level
Marsh, Saltings	Change of boundary marking	Revision Point (instrumentally fixed)
Reeds	see AREAS notes	Revision Point & Bench Mark coincident

Top	Slopes	Quarry	Refuse Heap	Sloping Masonry
Flat Rock	Sand	Sand Pit	Culvert	Archway
Shingle	Boulders	Gravel Pit	Cliff Face	Glazed Roof Building

ROADS

Road over single stream	Road crossing railway
Road over River or Canal	

RAILWAYS

Railway crossing River or Canal	Railway crossing Road
Level Crossing	Embankment
Cutting	

BOUNDARIES

England & Wales

- County Boundary (geographical)
- County & Civil Parish Boundary coterminous
- Admin County or County Borough Boundary
- London Borough Boundary
- County District Boundaries based on civil parish

England, Wales & Scotland

- Civil Parish Boundary
- Parly & Ward Boundaries based on civil parish
- Parly & Ward Boundaries not based on civil parish

Scotland

- County Boundary (geographical)
- County Council Boundary
- County of the City Boundary
- " " " " " "
- Burgh Boundary
- " " " " " "
- District Council Boundary
- " " " " " "

* Not with parish † Coincident with parish

ABBREVIATIONS

Trigonometrical Station	Sluice
Altitude at Trigonometrical Station	Trough
Bench Mark	Spring
Surface Level	Well
Permanent Traverse Station	Mooring Ring
Antiquities (site of)	Mooring Post
Arrow denotes flow of water	Boundary Stone
	Boundary Post

ABBREVIATIONS

Beer House	Fire Station	Mail Pick-up	Signal Light
Bench Mark	Guide Post	Mile Stone	Sluice
Boundary Post	Gas Valve Compound	National Trust	Signal Post
Boundary Stone	Hydrant or Hydraulic	Normal Tidal Limit	Spring
Crane	Hectares	National Trust for Scotland	Signal Station
Club House	Letter Box	Pillar, Pole or Post	Telephone Call Box
Chimney	Lifeboat Station	Public Convenience	Telephone Call Post
Capstan	Level Crossing	Police Call Box	Tank or Track
Drinking Fountain	Loading Gauge	Public House	Trough
Dock	Lighthouse	Post Office	Traverse Station
Electricity Pillar or Post	Lighting Tower	Pump	Well
Electricity Transmission Line	Metres	Police Telephone Pillar	Weighbridge
Fire Alarm	Mean High Water	Reservoir	Wind Pump
Fire Alarm Pillar	Mean High Water Springs	Road House	Works
Filter Bed, Foot Bridge	Mean Low Water	Water Point	Water Tap
Fundamental Bench Mark	Mean Low Water Springs	Stone	
Flagstaff	Mile or Mooring Post	Signal Box	

County Series 1:1,250 scale ~ County Series & National Grid 1:2,500 scale

Information present on these legends is sourced from the same Ordnance Survey mapping as the maps used in this product.

If you have a query regarding any of the maps provided within this map pack, please contact GroundSure's technical helpline. We will endeavour to answer any queries you may have.

Technical Helpline:
Tel 08444159000

groundsureinsight@groundsure.com
www.groundsure.com

Site Details:

Client Ref: EMS_608216_812597
Report Ref: EMS-608216_812597
Grid Ref: 307473, 167768

Map Name: County Series

Map date: 1880

Scale: 1:2,500

Printed at: 1:2,500



Surveyed 1880
 Revised 1880
 Edition N/A
 Copyright N/A
 Levelled N/A

Surveyed 1880
 Revised 1880
 Edition N/A
 Copyright N/A
 Levelled N/A

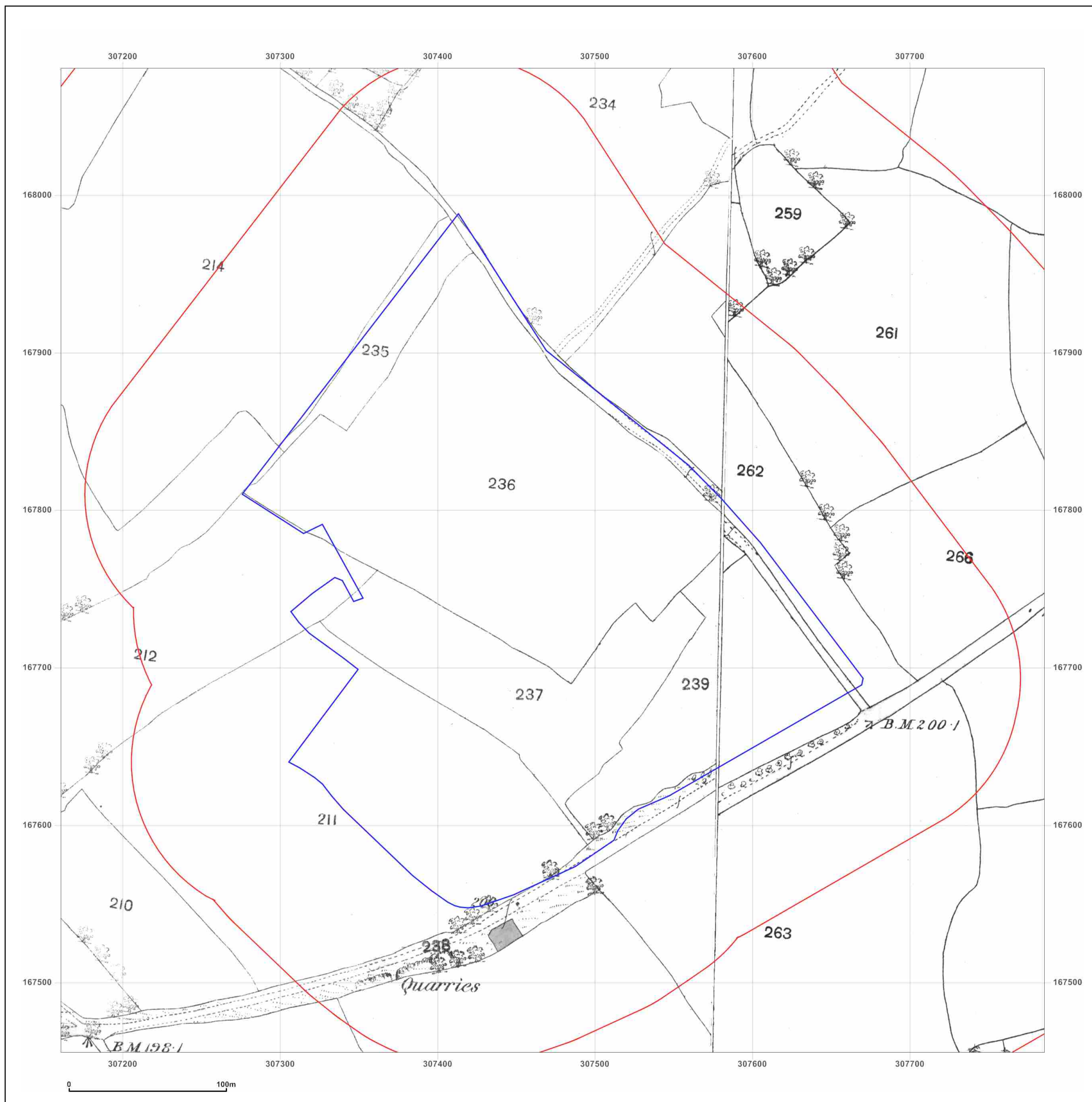
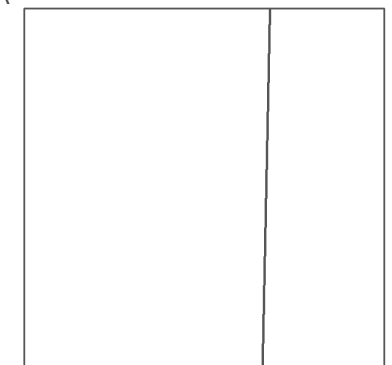

Produced by
 Groundsure Insights
www.groundsure.com



Supplied by:
www.emapsite.com
sales@emapsite.com

© Crown copyright and database rights 2019 Ordnance Survey 100035207

Production date: 05 May 2020

Map legend available at:
www.groundsure.com/sites/default/files/groundsure_legend.pdf

Site Details:

Client Ref: EMS_608216_812597
Report Ref: EMS-608216_812597
Grid Ref: 307473, 167768

Map Name: County Series

Map date: 1900

Scale: 1:2,500

Printed at: 1:2,500



Surveyed 1900
 Revised 1900
 Edition N/A
 Copyright N/A
 Levelled N/A

Surveyed 1900
 Revised 1900
 Edition N/A
 Copyright N/A
 Levelled N/A

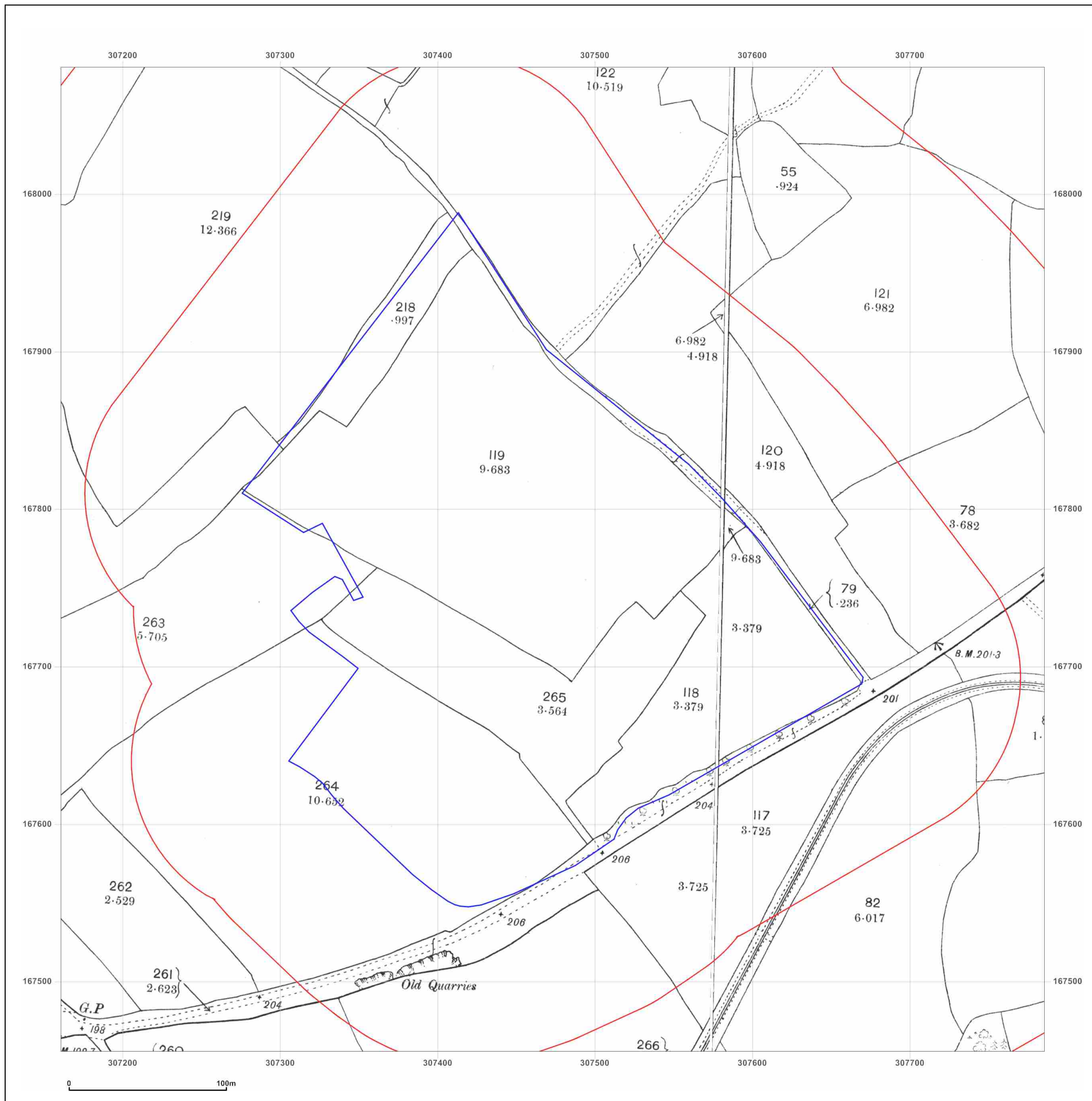
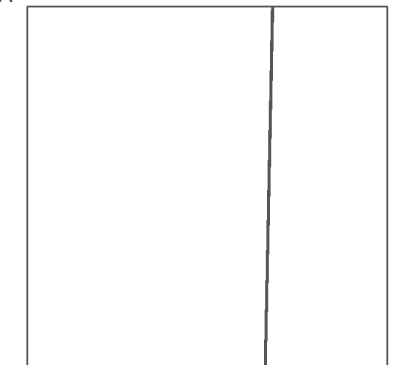

Produced by
 Groundsure Insights
www.groundsure.com



Supplied by:
www.emapsite.com
sales@emapsite.com

Site Details:

Client Ref: EMS_608216_812597
Report Ref: EMS-608216_812597
Grid Ref: 307473, 167768

Map Name: County Series

Map date: 1919-1920

Scale: 1:2,500

Printed at: 1:2,500



Surveyed 1920
 Revised 1920
 Edition N/A
 Copyright N/A
 Levelled N/A

Surveyed 1919
 Revised 1919
 Edition N/A
 Copyright N/A
 Levelled N/A

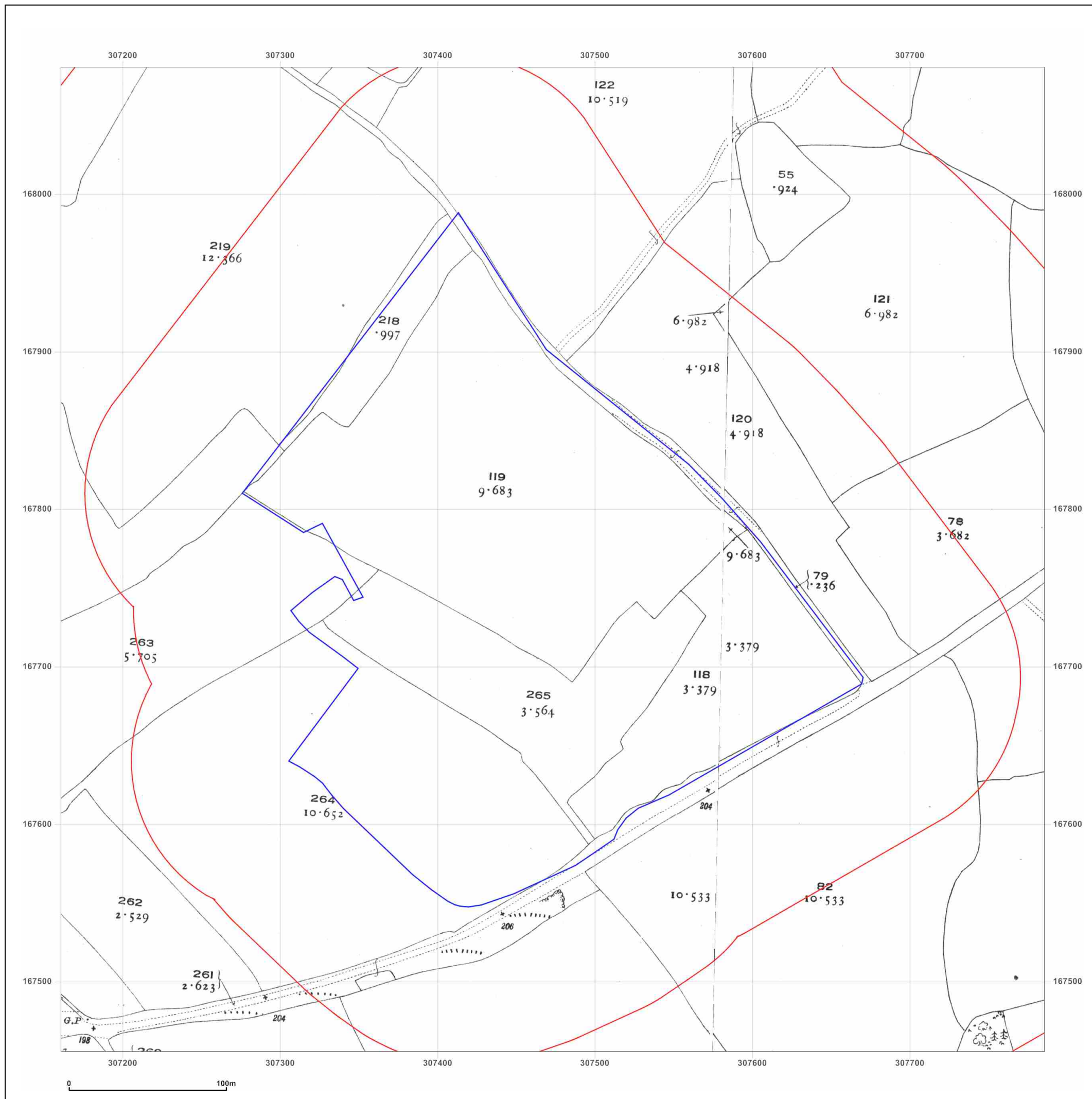
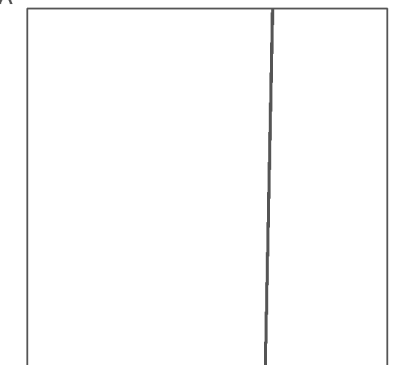

Produced by
 Groundsure Insights
www.groundsure.com



Supplied by:
www.emapsite.com
sales@emapsite.com

© Crown copyright and database rights 2019 Ordnance Survey 100035207

Production date: 05 May 2020

Map legend available at:
www.groundsure.com/sites/default/files/groundsure_legend.pdf

Site Details:

Client Ref: EMS_608216_812597
Report Ref: EMS-608216_812597
Grid Ref: 307473, 167768

Map Name: County Series

Map date: 1935

Scale: 1:2,500

Printed at: 1:2,500



Surveyed 1935
 Revised 1935
 Edition N/A
 Copyright N/A
 Levelled N/A

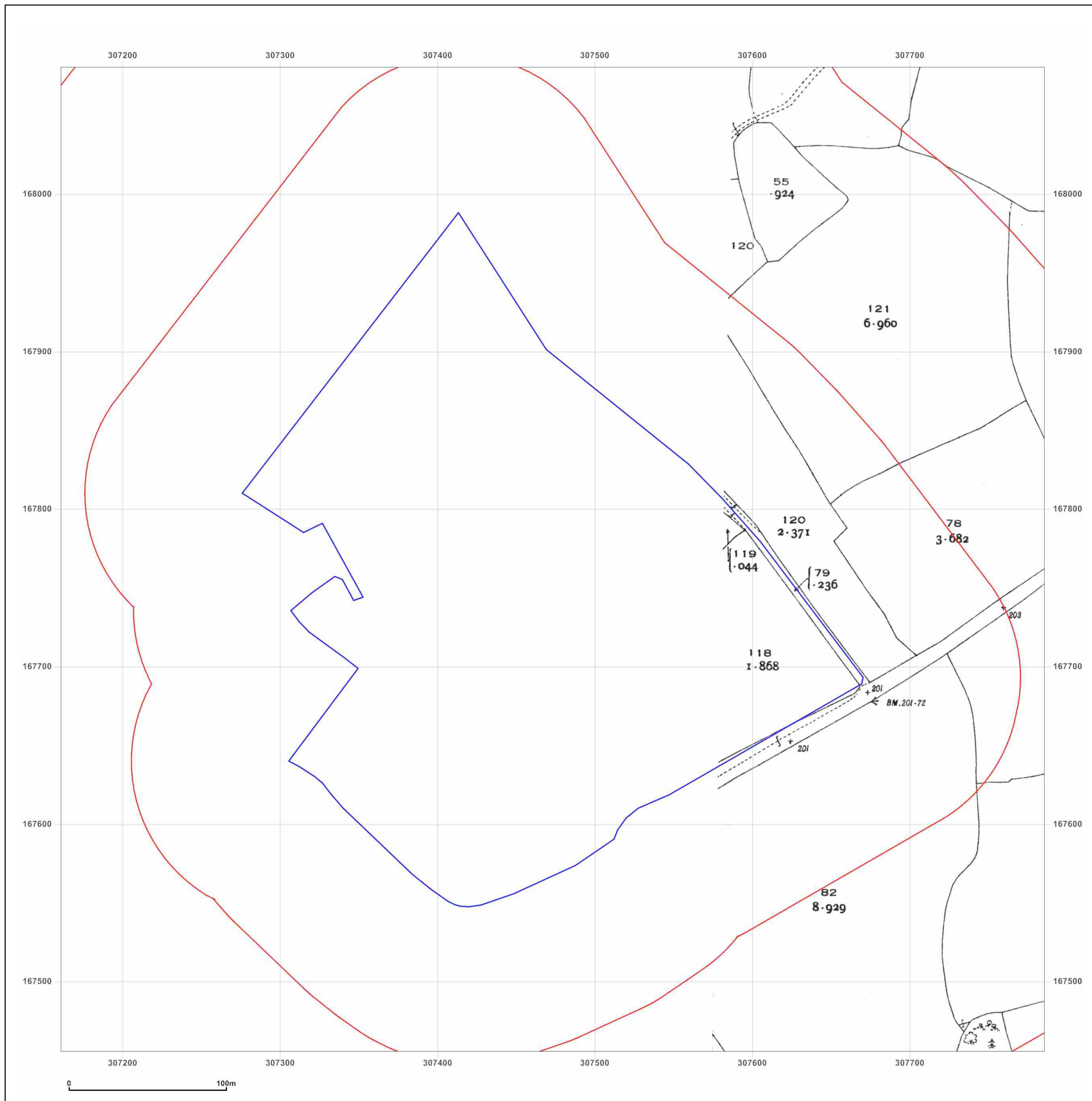
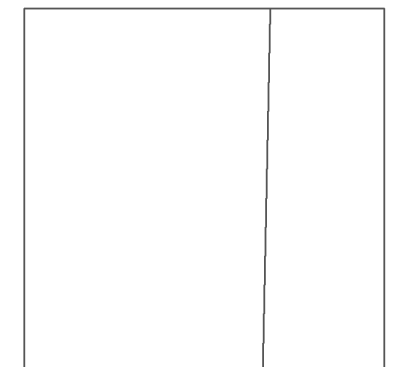

Produced by
 Groundsure Insights
www.groundsure.com



Supplied by:
www.emapsite.com
sales@emapsite.com

© Crown copyright and database rights 2019 Ordnance Survey 100035207

Production date: 05 May 2020

Map legend available at:
www.groundsure.com/sites/default/files/groundsure_legend.pdf

Site Details:

Client Ref: EMS_608216_812597
Report Ref: EMS-608216_812597
Grid Ref: 307473, 167768

Map Name: County Series

Map date: 1943

Scale: 1:2,500

Printed at: 1:2,500



Surveyed 1943
 Revised 1943
 Edition N/A
 Copyright N/A
 Levelled N/A

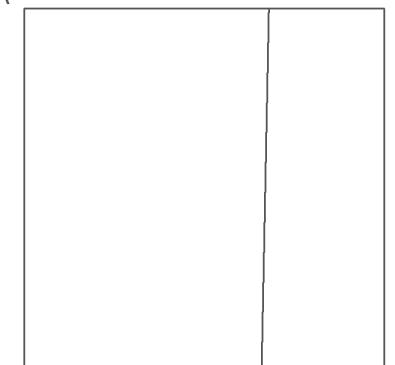

Produced by
 Groundsure Insights
www.groundsure.com



Supplied by:
www.emapsite.com
sales@emapsite.com

© Crown copyright and database rights 2019 Ordnance Survey 100035207

Production date: 05 May 2020

Map legend available at:
www.groundsure.com/sites/default/files/groundsure_legend.pdf

