

Bolston House, Bonvilston

Arboricultural Impact Assessment

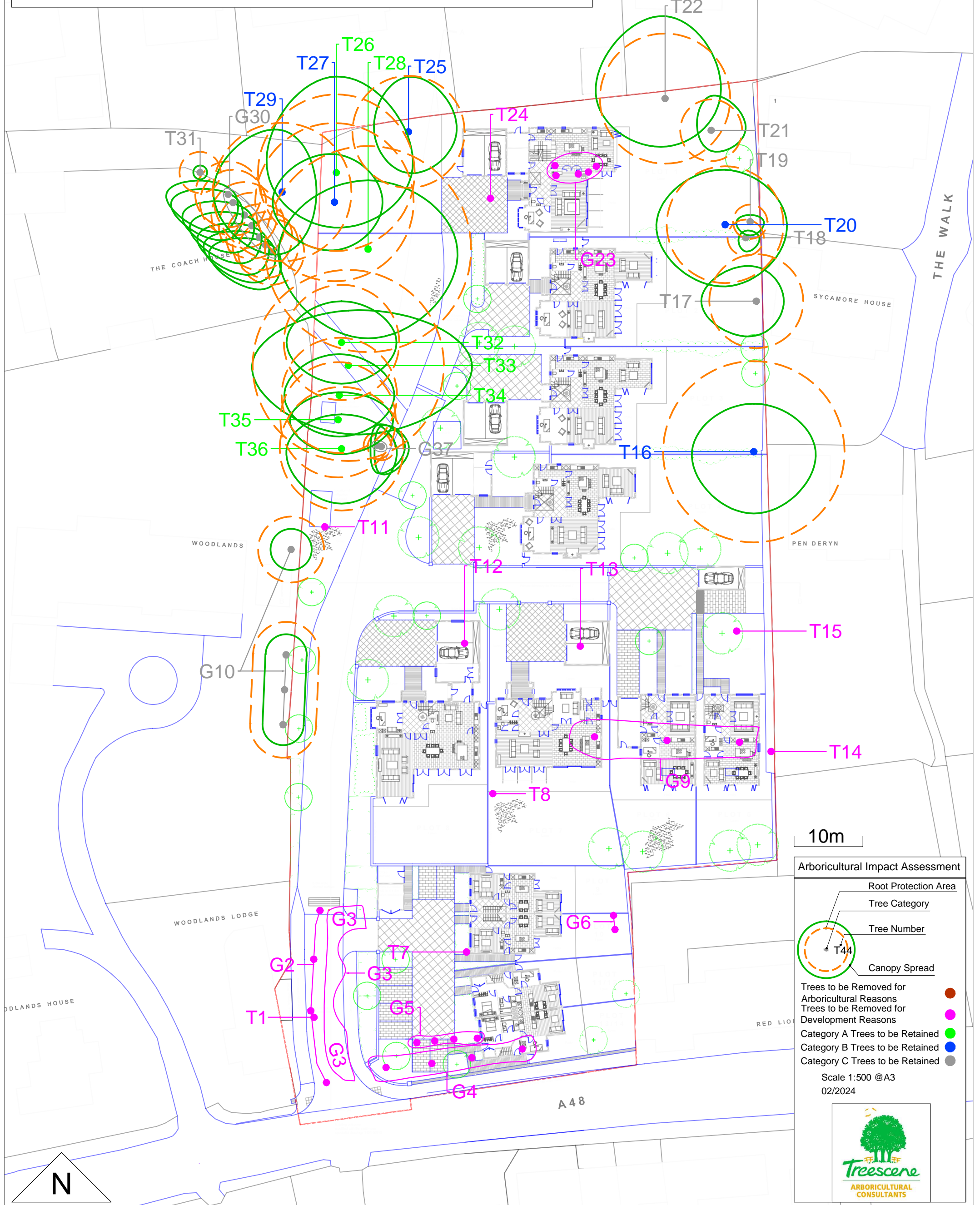

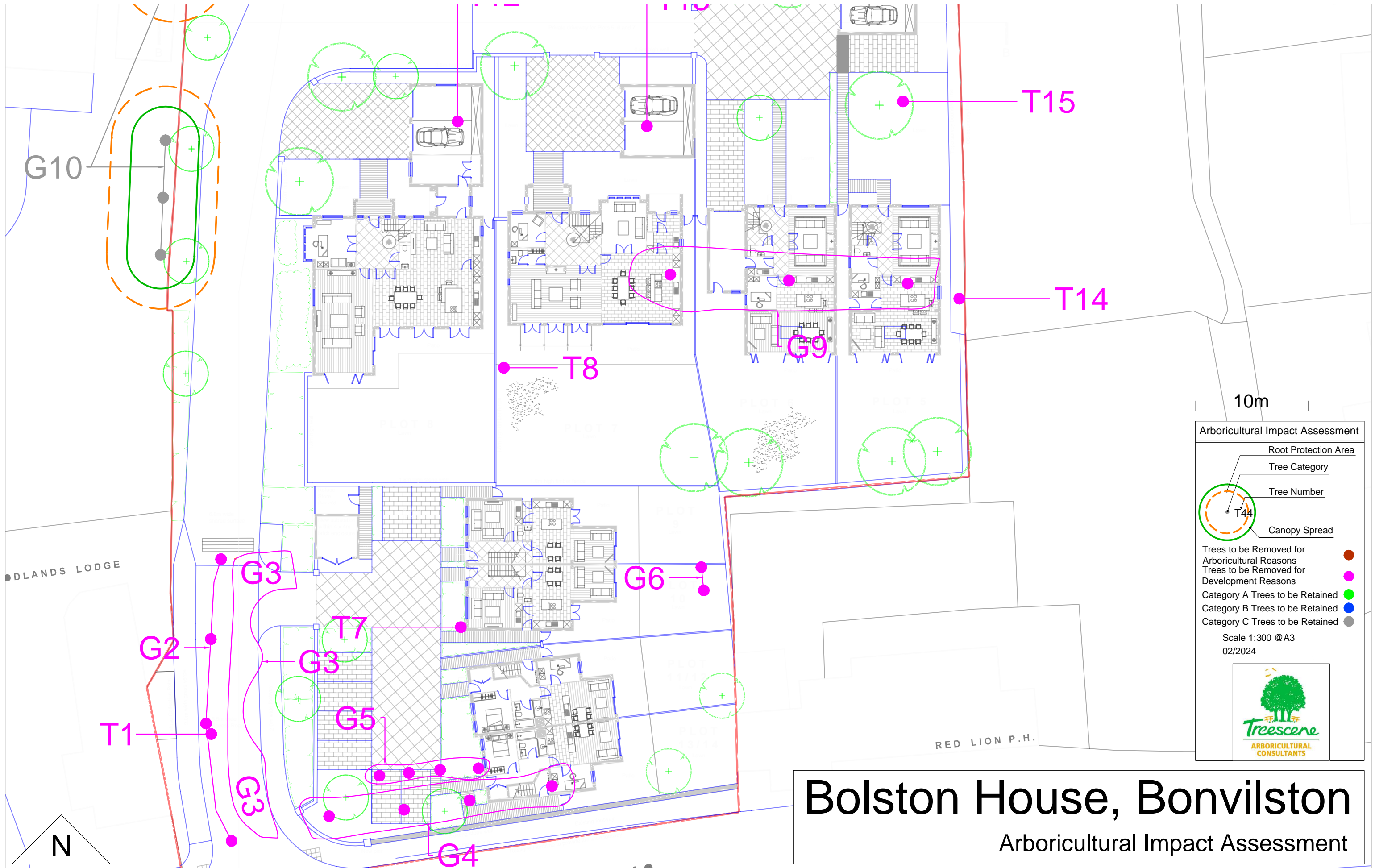

Bolston House, Bonvilston

Arboricultural Impact Assessment

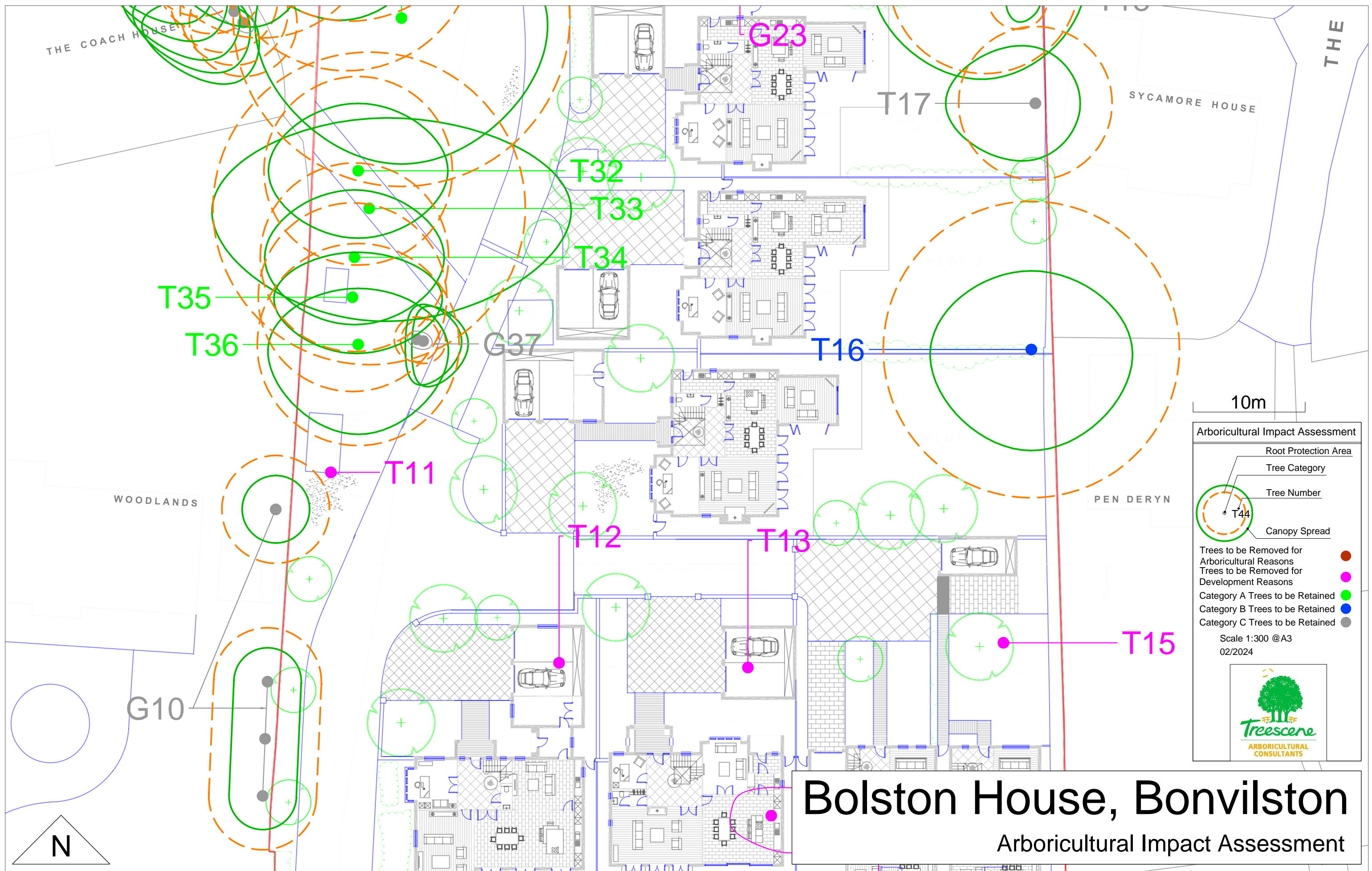

Arboricultural Impact Assessment

- Root Protection Area
- Tree Category
- Tree Number
- Canopy Spread

Trees to be Removed for Arboricultural Reasons ●

Trees to be Removed for Development Reasons ●

Category A Trees to be Retained ●

Category B Trees to be Retained ●

Category C Trees to be Retained ●

Scale 1:300 @A3
02/2024

Bolston House, Bonvilston

Arboricultural Impact Assessment

Bolston House, Bonvilston

Arboricultural Impact Assessment

