

DO NOT SCALE

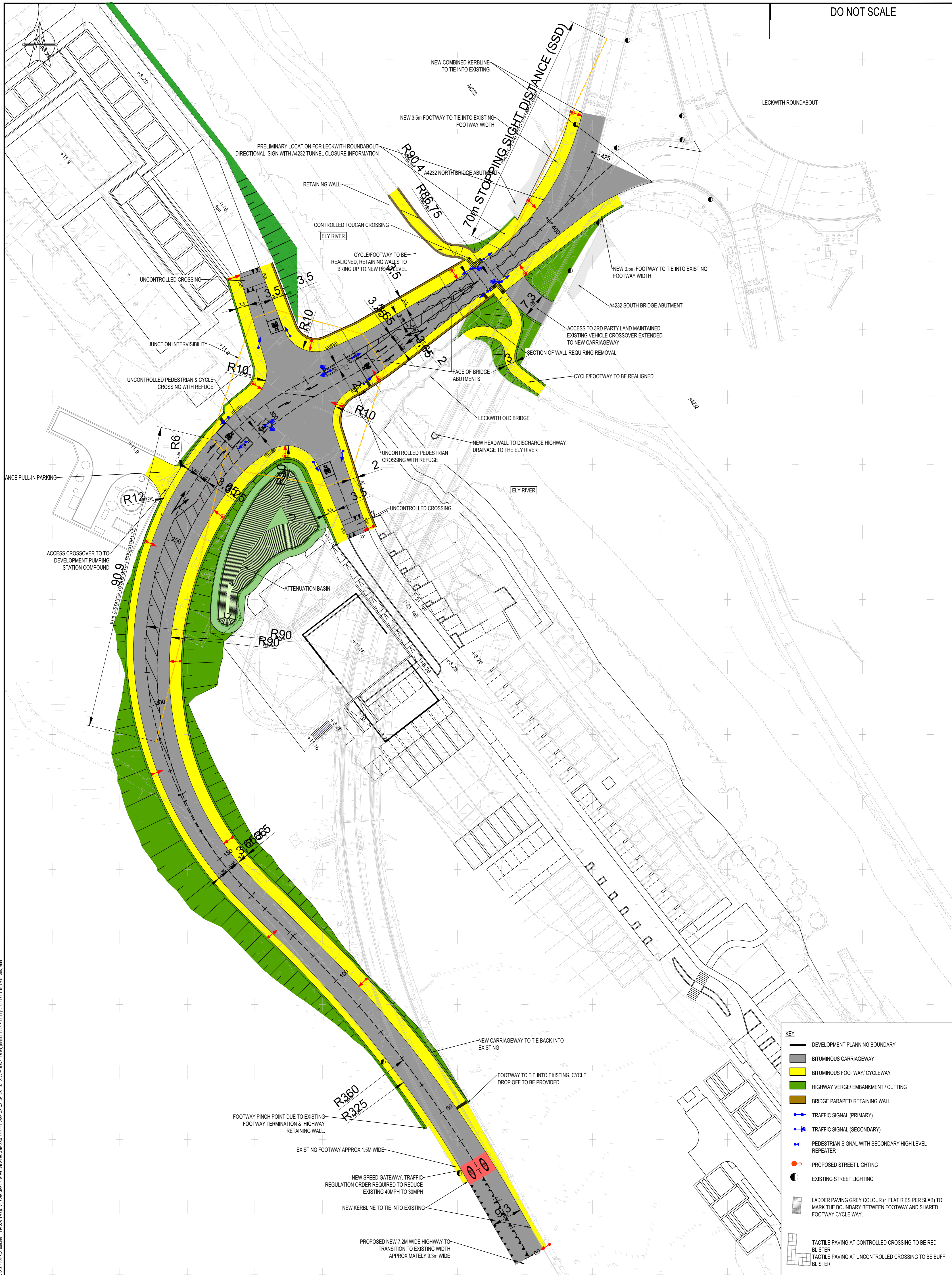

KEY	
[Symbol]	DEVELOPMENT PLANNING BOUNDARY
[Symbol]	BITUMINOUS CARRIAGEWAY
[Symbol]	BITUMINOUS FOOTWAY / CYCLEWAY
[Symbol]	HIGHWAY VERGE / EMBANKMENT / CUTTING
[Symbol]	BRIDGE PARAPET / RETAINING WALL
[Symbol]	TRAFFIC SIGNAL (PRIMARY)
[Symbol]	TRAFFIC SIGNAL (SECONDARY)
[Symbol]	PEDESTRIAN SIGNAL WITH SECONDARY HIGH LEVEL REPEATER
[Symbol]	PROPOSED STREET LIGHTING
[Symbol]	EXISTING STREET LIGHTING
[Symbol]	LADDER PAVING GREY COLOUR (4 FLAT RIBS PER SLAB) TO MARK THE BOUNDARY BETWEEN FOOTWAY AND SHARED FOOTWAY CYCLE WAY.
[Symbol]	TACTILE PAVING AT CONTROLLED CROSSING TO BE RED BLISTER
[Symbol]	TACTILE PAVING AT UNCONTROLLED CROSSING TO BE BUFF BLISTER

NOTES

- DO NOT SCALE FROM THIS DRAWING. USE FIGURED DIMENSIONS ONLY.
- ALL LEVELS ARE IN METRES ABOVE ORDNANCE DATUM (AOD)
- ALL DIMENSIONS ARE IN METRES UNLESS OTHERWISE STATED.
- THIS DRAWING IS FOR PLANNING PURPOSES ONLY AND IS SUBJECT TO DETAILED DESIGN
- HIGHWAY GEOMETRY & DESIGN IS SUBJECT TO TECHNICAL APPROVAL OF THE ADOPTING HIGHWAY AUTHORITIES

DRAWING STATUS: **FOR PLANNING**



1 Capital Quarter
Tyndall St
Cardiff
CF10 4BZ, UK

T+ 44 (0) 292 076 9200
wsp.com

CLIENT: **PHILLIP WORTHING**

ARCHITECT: **LOYN ARCHITECTS**

PROJECT: **LECKWITH QUAY**

TITLE: **B4267 LECKWITH ROAD HIGHWAY IMPROVEMENTS
GENERAL ARRANGEMENT (OPTION 2)**

SCALE @ A1	CHECKED:	APPROVED:
1:500	GW	GW
PROJECT No:	DESIGNED:	DRAWN:
70053561	SID	SID
	DATE:	September 19
DRAWING No:	70053561-WSP-XX-XX-CE-DR-102	
	REV: P01	
© WSP UK Ltd		

File name: \\UK_VSPGROUP\COMMON\DATA\PROJECTS\70053561-LECKWITH QUAY_CARDIFF\02_WSP\CAD\DRAWINGS\70053561-WSP-XX-XX-CE-DR-102_GA_OPTION2_DWG.dwg, printed on 28 February 2020 11:01:15, by David, Sion