

DRAWING NOTES:

1. THE DETAILS IN THIS DRAWING ARE FOR PLANNING AND ARE SUBJECT TO APPROVAL BY VALE OF GLAMORGAN COUNTY COUNCIL.
2. WORKING PRESSURE = T.B.C (APPROX. 5 BAR)
3. TEST PRESSURE = T.B.C (APPROX. 7.5 BAR)
4. ALL FITTINGS TO BE PN16 RATED
5. ALL PIPEWORK TO BE SDR17 HPPE
6. PIPE SHOULD BE LAID AT A MINIMUM DEPTH OF 1100mm WHERE PIPE IS UNDERNEATH A ROAD, EVERYWHERE ELSE SHALL BE LAID AT A MINIMUM DEPTH OF 900mm
7. PIPE IS REQUIRED TO HAVE A MINIMUM GRADIENT OF 1:300 WHEN FLOWING DOWN AND 1:500 WHEN FLOWING UP
8. FOR EXTERNAL CONNECTIONS REFER TO THE RELEVANT WSCO. 1, 3, 5, 7
9. FOR INTERNAL CONNECTIONS REFER TO THE RELEVANT WSCO. 2, 4, 6, 8
10. BARRIER PIPE SHALL BE REQUIRED IN CERTAIN LOCATIONS - CHAINAGES AND BARRIER DETAILS TO BE CONFIRMED FOLLOWING FURTHER GI
11. PIPES SHALL BE LAID IN DUCTING UNDER ALL AREAS OF HARD STANDING
12. THIS DRAWING IS TO BE READ IN CONJUNCTION WITH THE FOLLOWING SPECIFICATIONS:
 - a. THE CIVIL ENGINEERING SPECIFICATION FOR THE WATER INDUSTRY REVISION 7 (CESWI 7)
 - b. DCWW STANDARD DETAIL DRAWINGS
 - c. DCWW CIVIL ENGINEERING SPECIFICATION
11. IT IS ASSUMED THAT ALL WORKS WILL BE CARRIED OUT BY A COMPETENT PERSON WORKING TO APPROVED SAFE SYSTEMS OF WORK.
12. ALL WORK IN PRIVATE LAND IS TO BE CARRIED OUT IN ACCORDANCE WITH DCWW'S CODE OF PRACTICE FOR PIPELAYING
13. LEVELS AND DISTANCES ARE TO BE VERIFIED ON SITE BY CONTRACTOR. ANY SIGNIFICANT DEVIATION FROM THAT SHOWN SHOULD BE REFERRED BACK TO THE ENGINEER FOR COMMENT
14. ALL AREAS AFFECTED BY THE WORKS SHALL RECEIVE LIKE FOR LIKE REINSTATEMENT IN ACCORDANCE WITH DCWW CODE OF PRACTICE FOR PIPE LAYING
15. THE CONTRACTOR SHALL BE RESPONSIBLE FOR UTILITIES INTERFACES AND CONTACTING UTILITY COMPANIES FOR ARRANGING APPARATUS TO BE MARKED AND IDENTIFIED ON SITE, PRIOR TO ANY EXCAVATION.
16. CAUTION - WHERE OVERHEAD CABLES ARE PRESENT WITHIN THE WORKING AREA. CONTRACTOR TO REFER TO HSE GUIDANCE NOTE GS6 "AVOIDANCE OF DANGER FROM OVERHEAD LINES".
17. CAUTION! - NO CHLORINATED / CONTAMINATED WATER OR DRILLING FLUIDS ARE ALLOWED TO ENTER ANY WATER COURSE OR STORM DRAIN. CONTRACTOR TO REFER TO GUIDELINES ON POLLUTION PREVENTION AND INSTRUCTIONS IN CASE OF EMERGENCY
18. CONTRACTOR TO BE AWARE THAT WATER MAINS MATERIALS MAY NOT BE MARKED OR MARKED INCORRECTLY TO WHAT IS INDICATED. IT IS THEREFORE ADVISABLE THAT THE POSSIBLE PRESENCE OF ASBESTOS (AC) OR PITCH FIBRE (PF) BE ANTICIPATED AND INCLUDED IN RAMS.
19. THE DEPTH AND LINE OF THE NEW MAIN IS TO BE SUPPLIED BY THE CONTRACTOR AT 50m INTERVALS AND AS-BUILT DRAWINGS SUPPLIED AT THE END OF THE WORKS

LEGEND:

- PROPOSED
- EXISTING LIVE
- EXISTING GROUND LEVEL

50192-BUR-ULT-XX-DR-C-2736	04/08/23	SL	RS	RS
REV	DESCRIPTION	DATE	DRW	CHK

Drawing Title:
**SERIES 2700 - UTILITIES
PROPOSED POTABLE WATER
DETAILS SHEET 1**

Burroughs Project No.: 50192
Scale: 1:25
Original Paper Size: A1

Drawing Number:
50192-BUR-ULT-XX-DR-C-2736

Status: S2 - FOR INFORMATION
Revision: P1.0 - ISSUED FOR PLANNING

This document is copyright of Burroughs Ltd. Use figured measurements only! DO NOT SCALE FROM DRAWING. Verify all dimensions prior to construction. Immediately report any discrepancies to Burroughs and if in doubt ASK. This drawing should be read in conjunction with all other associated project information

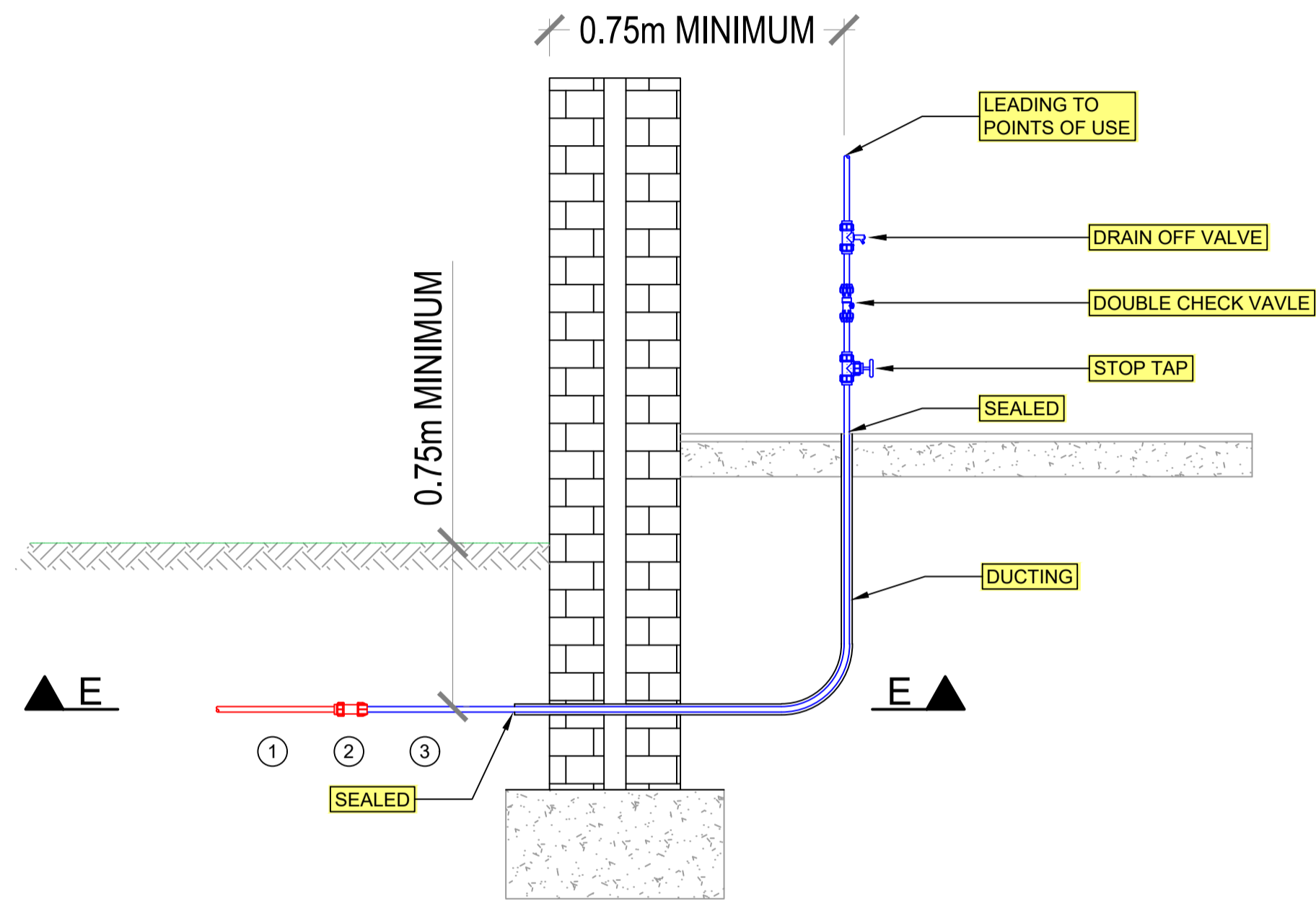

SECTION E-E

SCHEDULE OF PARTS

REF.	QTY.	DESCRIPTION:
1	AS REQ'D	SDR17 HPPE MAIN CUT TO-SUIT
2	1	PE x UNIVERSAL COUPLING TO-SUIT
3	AS REQ'D	EXISTING PIPE

**WSCO NO.05 HPPE TO EXISTING PIPE
EXTERNAL SERVICE CONNECTION**
SCALE 1:25

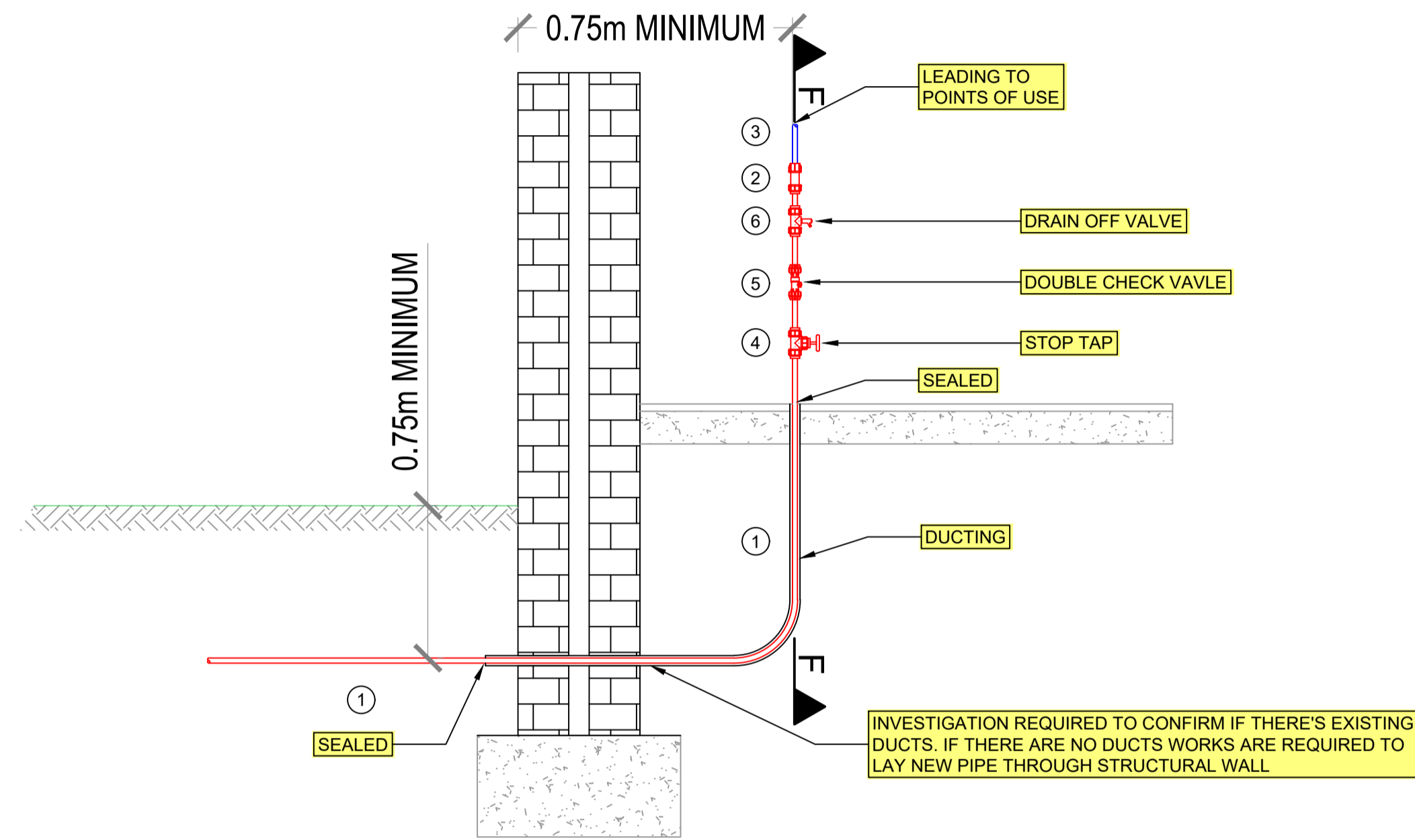

SECTION F-F

SCHEDULE OF PARTS

REF.	QTY.	DESCRIPTION:
1	AS REQ'D	SDR17 HPPE MAIN CUT TO-SUIT
2	1	PE x UNIVERSAL COUPLING TO-SUIT
3	AS REQ'D	EXISTING PIPE
4	1	STOP TAP
5	1	DOUBLE CHECK VAVLE
6	1	DRAIN OFF VALVE

**WSCO NO.06 HPPE TO EXISTING PIPE
INTERNAL SERVICE CONNECTION**
SCALE 1:25

