

01



Approximate Discharge Rate = 5.4 l/s
 Impermeable area Incl. UC = 0.75ha
 Estimated Storage = 538-640m3 (Circa 645m3 required based on hydrobrake)
 Available Volume in Pond Basin with Retaining Wall = 645m3
 Confirmation required from the VOG for the wall arrangement and adoption

LEGEND:-

- Proposed Retaining Wall - Slab on edge to be considered for walls adjacent gardens / patios for heights up to 0.45m
- Proposed Basin Retaining Wall (Refer to SK200)
- Proposed Underbuild
- Proposed Tanking
- Proposed Gravel Board
- Proposed Ground Level
- Proposed Finished Floor Level
- Proposed Embankment
- Proposed Permeable Paving (Unlined)
- Proposed Permeable Paving (Lined)
- Proposed Permeable Paving (Unlined)
- Proposed Swale position
- Proposed Rain Garden and Overflow
- Permeoid Distribution Crate
- Aquacell 250mm dia Silt Trap - Adoptable
- SAB Adoptable Filter / Carrier Drain
- Offsite Connection SAB and Welsh Water Easement (TBC)
- Planter
- Proposed Impermeable Service Corridor
- Proposed Trench for SW conveyance
- Private Storm drainage

- NOTES**
- Bio-retention Trenches to be provided to all plot surface water drainage
 - Steps not indicated, to be considered with adjacent retaining wall also
 - SUD's features indicative only and subject to discussions with VOG CC
 - Permeable paving to be considered within plot driveways - privately maintained by house owner

- GENERAL NOTES**
1. This drawing is to be read in conjunction with and checked against all other drawings, engineering details, specifications and any structural, geotechnical or other specialist document provided.
 2. Any discrepancies within all relevant drawings are to be reported to QuadConsult Ltd immediately.
 3. All dimensions and levels are in metres, U.N.O.
 4. Do not scale from this drawing - use figured dimensions only.
 5. This drawing is schematic for clarity only, positions of pipe runs and manholes may vary on site due to site conditions.
 6. Surface water drainage subject to S104 / SAB approval where appropriate with the relevant authority.
 7. Foul Drainage subject to S104 approval with relevant water authority.
 8. All private drainage to be installed in accordance with Part H of building regulations and the developers warranty provider.
 9. The contractor is at risk if construction is progressed without relevant S104, S106, S278, S38, OWC etc agreement being in place with the relevant authorities.

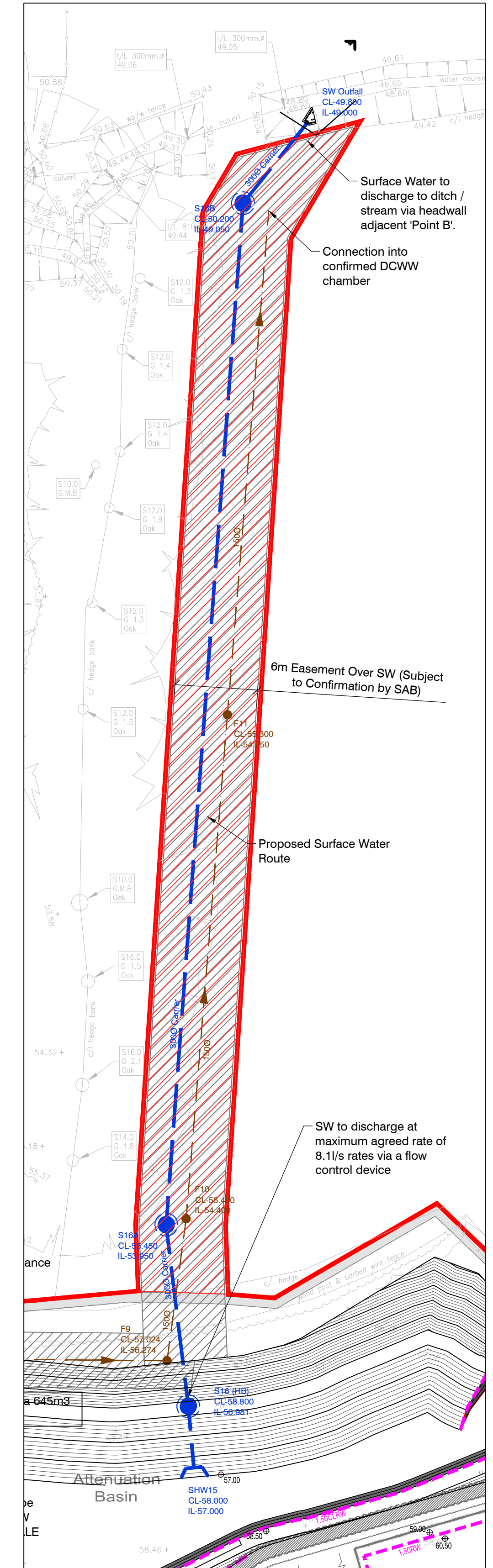

Rev	Date	Description	By
01	11.08.24	Site Layout and engineering updated	ML
02	18.08.24	Site Layout and engineering updated	ML
03	19.08.24	Site Layout and engineering updated	ML
04	20.08.24	Site Layout and engineering updated	ML
05	21.08.24	Site Layout and engineering updated	ML
06	22.08.24	Site Layout and engineering updated	ML
07	23.08.24	Site Layout and engineering updated	ML
08	24.08.24	Site Layout and engineering updated	ML
09	25.08.24	Site Layout and engineering updated	ML
10	26.08.24	Site Layout and engineering updated	ML
11	27.08.24	Site Layout and engineering updated	ML
12	28.08.24	Site Layout and engineering updated	ML
13	29.08.24	Site Layout and engineering updated	ML
14	30.08.24	Site Layout and engineering updated	ML
15	31.08.24	Site Layout and engineering updated	ML
16	01.09.24	Site Layout and engineering updated	ML
17	02.09.24	Site Layout and engineering updated	ML
18	03.09.24	Site Layout and engineering updated	ML
19	04.09.24	Site Layout and engineering updated	ML
20	05.09.24	Site Layout and engineering updated	ML
21	06.09.24	Site Layout and engineering updated	ML
22	07.09.24	Site Layout and engineering updated	ML
23	08.09.24	Site Layout and engineering updated	ML
24	09.09.24	Site Layout and engineering updated	ML
25	10.09.24	Site Layout and engineering updated	ML
26	11.09.24	Site Layout and engineering updated	ML
27	12.09.24	Site Layout and engineering updated	ML
28	13.09.24	Site Layout and engineering updated	ML
29	14.09.24	Site Layout and engineering updated	ML
30	15.09.24	Site Layout and engineering updated	ML
31	16.09.24	Site Layout and engineering updated	ML
32	17.09.24	Site Layout and engineering updated	ML
33	18.09.24	Site Layout and engineering updated	ML
34	19.09.24	Site Layout and engineering updated	ML
35	20.09.24	Site Layout and engineering updated	ML
36	21.09.24	Site Layout and engineering updated	ML
37	22.09.24	Site Layout and engineering updated	ML
38	23.09.24	Site Layout and engineering updated	ML
39	24.09.24	Site Layout and engineering updated	ML
40	25.09.24	Site Layout and engineering updated	ML
41	26.09.24	Site Layout and engineering updated	ML
42	27.09.24	Site Layout and engineering updated	ML
43	28.09.24	Site Layout and engineering updated	ML
44	29.09.24	Site Layout and engineering updated	ML
45	30.09.24	Site Layout and engineering updated	ML
46	01.10.24	Site Layout and engineering updated	ML
47	02.10.24	Site Layout and engineering updated	ML
48	03.10.24	Site Layout and engineering updated	ML
49	04.10.24	Site Layout and engineering updated	ML
50	05.10.24	Site Layout and engineering updated	ML
51	06.10.24	Site Layout and engineering updated	ML
52	07.10.24	Site Layout and engineering updated	ML
53	08.10.24	Site Layout and engineering updated	ML
54	09.10.24	Site Layout and engineering updated	ML
55	10.10.24	Site Layout and engineering updated	ML
56	11.10.24	Site Layout and engineering updated	ML
57	12.10.24	Site Layout and engineering updated	ML
58	13.10.24	Site Layout and engineering updated	ML
59	14.10.24	Site Layout and engineering updated	ML
60	15.10.24	Site Layout and engineering updated	ML
61	16.10.24	Site Layout and engineering updated	ML
62	17.10.24	Site Layout and engineering updated	ML
63	18.10.24	Site Layout and engineering updated	ML
64	19.10.24	Site Layout and engineering updated	ML
65	20.10.24	Site Layout and engineering updated	ML
66	21.10.24	Site Layout and engineering updated	ML
67	22.10.24	Site Layout and engineering updated	ML
68	23.10.24	Site Layout and engineering updated	ML
69	24.10.24	Site Layout and engineering updated	ML
70	25.10.24	Site Layout and engineering updated	ML
71	26.10.24	Site Layout and engineering updated	ML
72	27.10.24	Site Layout and engineering updated	ML
73	28.10.24	Site Layout and engineering updated	ML
74	29.10.24	Site Layout and engineering updated	ML
75	30.10.24	Site Layout and engineering updated	ML
76	31.10.24	Site Layout and engineering updated	ML
77	01.11.24	Site Layout and engineering updated	ML
78	02.11.24	Site Layout and engineering updated	ML
79	03.11.24	Site Layout and engineering updated	ML
80	04.11.24	Site Layout and engineering updated	ML
81	05.11.24	Site Layout and engineering updated	ML
82	06.11.24	Site Layout and engineering updated	ML
83	07.11.24	Site Layout and engineering updated	ML
84	08.11.24	Site Layout and engineering updated	ML
85	09.11.24	Site Layout and engineering updated	ML
86	10.11.24	Site Layout and engineering updated	ML
87	11.11.24	Site Layout and engineering updated	ML
88	12.11.24	Site Layout and engineering updated	ML
89	13.11.24	Site Layout and engineering updated	ML
90	14.11.24	Site Layout and engineering updated	ML
91	15.11.24	Site Layout and engineering updated	ML
92	16.11.24	Site Layout and engineering updated	ML
93	17.11.24	Site Layout and engineering updated	ML
94	18.11.24	Site Layout and engineering updated	ML
95	19.11.24	Site Layout and engineering updated	ML
96	20.11.24	Site Layout and engineering updated	ML
97	21.11.24	Site Layout and engineering updated	ML
98	22.11.24	Site Layout and engineering updated	ML
99	23.11.24	Site Layout and engineering updated	ML
100	24.11.24	Site Layout and engineering updated	ML

QuadConsult Limited
 Columbia House, Village Way
 Cooperatives Business Park
 CF15 9HE
 030 2971 9444
 01656 684000
 www.quadconsult.co.uk

Consulting Civil & Structural Engineers

The key is quality

Lewis Homes

Project: Ystradowen
 Title: Preliminary Engineering Appraisal

FOR INFORMATION ONLY

Drawn by	Checked by	Date	Scale
RWP	SM	Oct '19	1:250
Project No	Drawing No	Revision	
19351	SK101	16	

