

DESIGN NOTES:

1. This drawing is to be read in conjunction with all other RWV Consulting Ltd. project drawings and specifications.
2. All levels are in metres above ordnance datum based on the topographical survey drawing supplied by the Client.
3. All dimensions are in millimetres unless stated otherwise.
4. Do not scale from this drawing, use figured dimensions only.
5. All setting out details shall be verified on site with the Engineer. The Engineer may require minor amendment to the setting out and/or level details to ensure proper tie in to the existing carriageway and/or footways.
6. No private surface water run off shall discharge onto the public highway.
7. Private drainage and external works shall comply with Building Regulations and all associated British Standards (BSEN where applicable).
8. All work within the public highway will be carried out in accordance with the requirements and specification of the Local Highway Authority, no work shall be undertaken within the public highway until a license has been issued by the Highway Authority.
9. The contractor shall be responsible for verifying the locations of any existing statutory utilities, along with any adoptable and private drainage that may be affected by the proposed works. Identification should be carried out by means of either a CAT scan or hand dug trial holes. Any damage to existing plant or equipment shall be repaired /made good.
10. Details of the proposed statutory undertakers supply routes to be confirmed by the relevant undertaker.
11. Traffic signs and road markings to be in accordance with traffic signs regulations and general directions, 2016.
12. All paver and sett paving to be laid in accordance with BS 7533-3.
13. All kerbs to be in accordance with BS EN 1340.
14. For external works locations refer to Landscape architects Drawings.

LEGEND

46.65	EXISTING LEVEL
+46.600	PROPOSED FINISHED SURFACE LEVEL
1:58	PROPOSED FALL

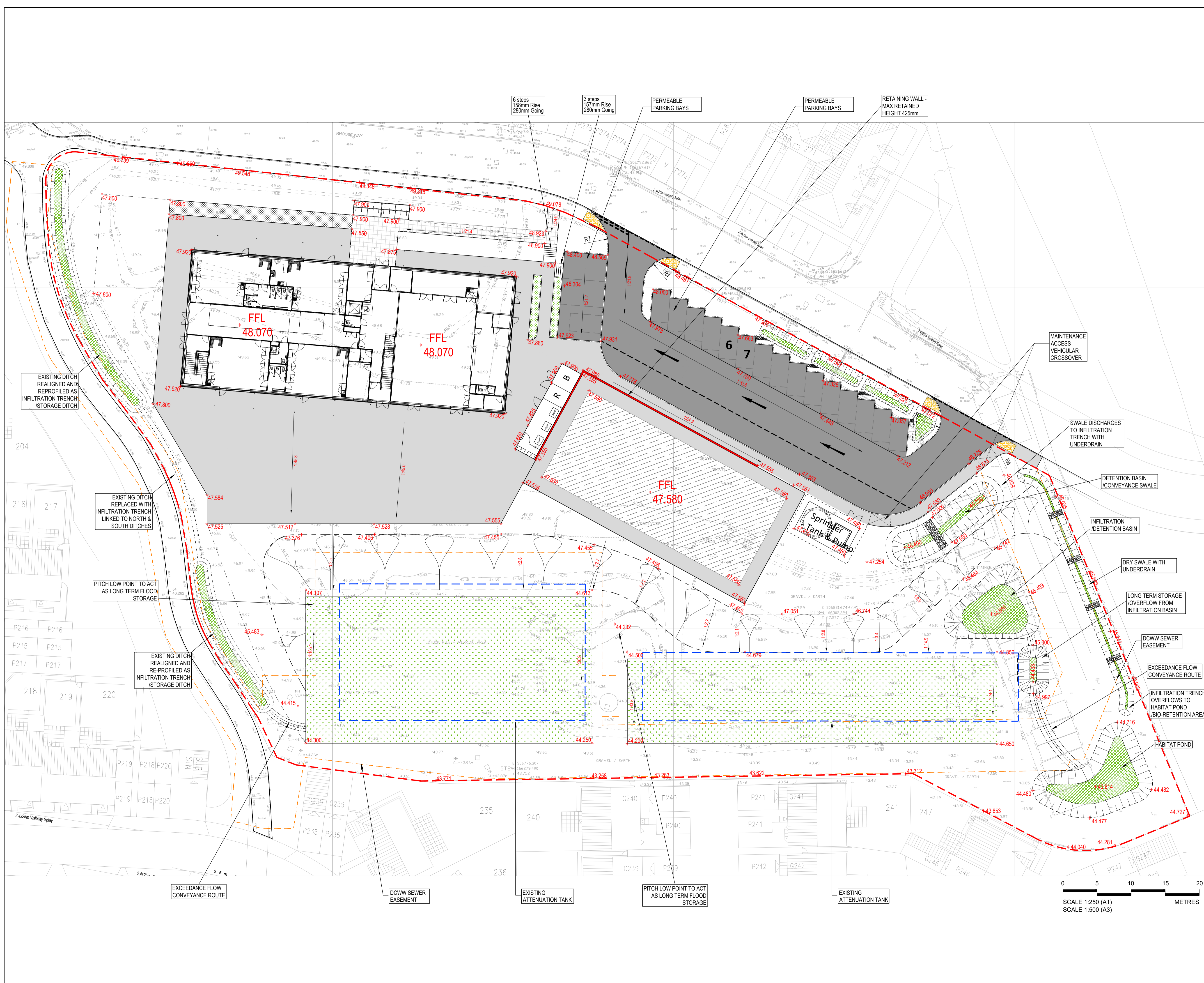

Rev.	Date	Details	By	Chk.
P3	24.04.20	Site layout altered, levels etc. revised to suit. Minor amendments to school entrance area, levels updated.	DRW	DRW
P2	01.04.20	Position of M&GSA Earth retention amended to avoid obstruction surcharge. Minor amendments to school entrance area, levels updated.	DRW	DRW

RWV CONSULTING

6 NEPTUNE COURT
VANGUARD WAY
OCEAN PARK
CARDIFF CF24 5PJ

T. 029 20461000
F. 029 20460799
www.rvwconsulting.co.uk

Project:
LLANCCARFAN SCHOOL
RHOOSE

Title:
EXTERNAL WORKS GA & LEVELS

Drawn:	Checked:	Scale(s) at A1:
DRW	ABP	AS SHOWN
Date:	RWV Job N°:	Revision:
09.01.20	C6906	P3
Drawing Status:	Suitability:	S0
PLANNING		
Drawing N°:	LPS-RVV-ZZ-00-DR-C-1000	

