

© Crown Copyright. All Rights Reserved. License Number 100022432.



## Combined Surface Geology

The Combined Surface Geology map combines all the previous maps into one combined geological overview of your site.

Please consult the legends to the previous maps to interpret the Combined "Surface Geology" map.

## Additional Information

More information on 1:50,000 Geological mapping and explanations of rock classifications can be found on the BGS website. Using the LEX Codes in this report, further descriptions of rock types can be obtained by interrogating the 'BGS Lexicon of Named Rock Units'. This database can be accessed by following the 'Information and Data' link on the BGS website.

## Contact

British Geological Survey  
Kingsley Dunham Centre  
Keyworth  
Nottingham  
NG12 5GG  
Telephone: 0115 936 3143  
Fax: 0115 936 3276  
email: [enquiries@bgs.ac.uk](mailto:enquiries@bgs.ac.uk)  
website: [www.bgs.ac.uk](http://www.bgs.ac.uk)

## Combined Geology Map - Slice A

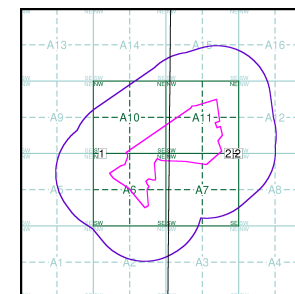

## Order Details:

Order Number:	164178613_1_1
Customer Reference:	Land at Model Farm
National Grid Reference:	307860, 167510
Slice:	A
Site Area (Ha):	41.25
Search Buffer (m):	500

## Site Details:

Land at Model Farm, CF62 3BD

**Landmark**  
INFORMATION GROUP

Tel: 0844 844 9952  
Fax: 0844 844 9951  
Web: [www.envirocheck.co.uk](http://www.envirocheck.co.uk)

v15.0 26-Apr-2018

Page 5 of 5

# Historical Mapping Legends

## Ordnance Survey County Series 1:10,560

	Gravel Pit		Sand Pit		Other Pits
	Quarry		Shingle		Orchard
	Osiers		Reeds		Marsh
	Mixed Wood		Deciduous		Brushwood
	Fir		Furze		Rough Pasture
	Arrow denotes flow of water		Trigonometrical Station		
	Site of Antiquities		Bench Mark		
	Pump, Guide Post, Signal Post		Well, Spring, Boundary Post		
	•285 Surface Level				
	Sketched Contour		Instrumental Contour		
	Main Roads		Minor Roads		
	Sunken Road		Raised Road		
	Road over Railway		Railway over River		
	Railway over Road		Level Crossing		
	Road over River or Canal		Road over Stream		
	Road over Stream				
	County Boundary (Geographical)				
	County & Civil Parish Boundary				
	Administrative County & Civil Parish Boundary				
	County Borough Boundary (England)				
	County Borough Boundary (Scotland)				
	Rural District Boundary				
	Civil Parish Boundary				

## Ordnance Survey Plan 1:10,000

	Chalk Pit, Clay Pit or Quarry		Gravel Pit
	Sand Pit		Disused Pit or Quarry
	Refuse or Slag Heap		Lake, Loch or Pond
	Dunes		Boulders
	Coniferous Trees		Non-Coniferous Trees
	Orchard		Scrub
	Bracken		Heath
	Marsh		Reeds
	Building		Glasshouse
	Sloping Masonry		Pylon
	Cutting		Embankment
	Road Under		Road Over
	Level Crossing		Foot Bridge
	Standard Gauge Multiple Track		Standard Gauge Single Track
	Siding, Tramway or Mineral Line		Narrow Gauge
	Geographical County		Administrative County, County Borough or County of City
	Municipal Borough, Urban or Rural District, Burgh or District Council		Borough, Burgh or County Constituency
	Civil Parish		
	BP, BS Boundary Post or Stone		Police Station
	Church		Post Office
	Club House		Public Convenience
	Fire Engine Station		Public House
	Foot Bridge		Signal Box
	Fountain		Spring
	Guide Post		Telephone Call Box
	Mile Post		Telephone Call Post
	Mile Stone		Well

## 1:10,000 Raster Mapping

	Gravel Pit		Refuse tip or slag heap
	Rock		Rock (scattered)
	Boulders		Boulders (scattered)
	Shingle		Mud
	Sand		Sand Pit
	Slopes		Top of cliff
	General detail		Underground detail
	Overhead detail		Narrow gauge railway
	Multi-track railway		Single track railway
	County boundary (England only)		Civil, parish or community boundary
	District, Unitary, Metropolitan, London Borough boundary		Constituency boundary
	Area of wooded vegetation		Non-coniferous trees
	Non-coniferous trees (scattered)		Coniferous trees
	Coniferous trees (scattered)		Positioned tree
	Orchard		Coppice or Osiers
	Rough Grassland		Heath
	Scrub		Marsh, Salt Marsh or Reeds
	Water feature		Flow arrows
	Mean high water (springs)		Mean low water (springs)
	Telephone line (where shown)		Electricity transmission line (with poles)
	Bench mark (where shown)		Triangulation station
	Point feature (e.g. Guide Post or Mile Stone)		Pylon, flare stack or lighting tower
	Site of (antiquity)		Glasshouse
	General Building		Important Building



## Historical Mapping & Photography included:

Mapping Type	Scale	Date	Pg
Glamorganshire	1:10,560	1885	2
Glamorganshire	1:10,560	1900 - 1901	3
Glamorganshire	1:10,560	1921	4
Glamorganshire	1:10,560	1936	5
Glamorganshire	1:10,560	1938 - 1947	6
Historical Aerial Photography	1:10,560	1947	7
Historical Aerial Photography	1:10,560	1947	8
Ordnance Survey Plan	1:10,000	1965	9
Ordnance Survey Plan	1:10,000	1975	10
Ordnance Survey Plan	1:10,000	1982	11
Ordnance Survey Plan	1:10,000	1995	12
10K Raster Mapping	1:10,000	1999	13
10K Raster Mapping	1:10,000	2006	14
VectorMap Local	1:10,000	2018	15

## Historical Map - Slice A

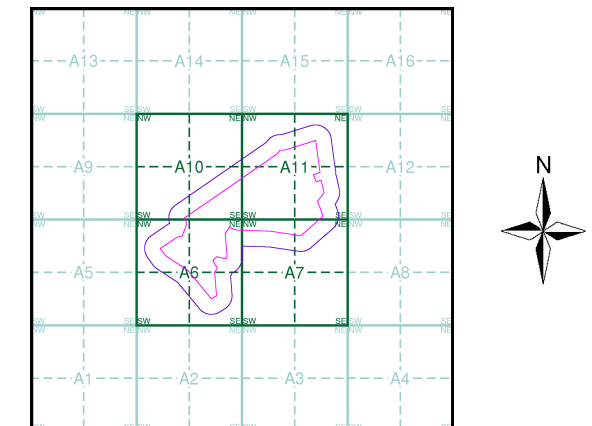

## Order Details

Order Number: 164178613\_1\_1  
Customer Ref: Land at Model Farm  
National Grid Reference: 307860, 167510  
Slice: A  
Site Area (Ha): 41.25  
Search Buffer (m): 500

## Site Details

Land at Model Farm, CF62 3BD

**Landmark**  
INFORMATION GROUP

Tel: 0844 844 9952  
Fax: 0844 844 9951  
Web: www.envirocheck.co.uk





The historical maps shown were reproduced from maps predominantly held at the scale adopted for England, Wales and Scotland in the 1840's. In 1854 the 1:2,500 scale was adopted for mapping urban areas; these maps were used to update the 1:10,560 maps. The published date given therefore is often some years later than the surveyed date. Before 1938, all OS maps were based on the Cassini Projection, with independent surveys of a single county or group of counties, giving rise to significant inaccuracies in outlying areas. In the late 1940's, a Provisional Edition was produced, which updated the 1:10,560 mapping from a number of sources. The maps appear unfinished - with all military camps and other strategic sites removed. These maps were initially overprinted with the National Grid. In 1970, the first 1:10,000 maps were produced using the Transverse Mercator Projection. The revision process continued until recently, with new editions appearing every 10 years or so for urban areas.

### Map Name(s) and Date(s)

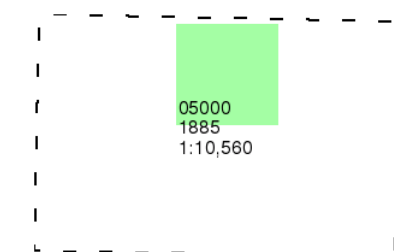

### Historical Map - Slice A

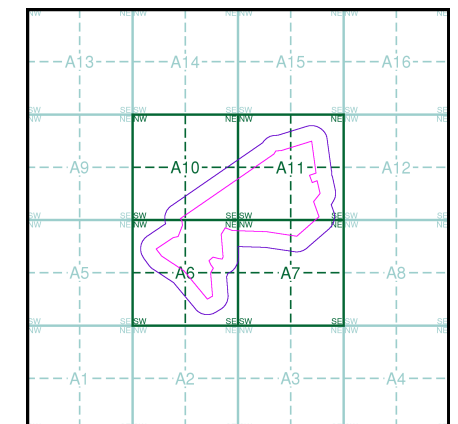

## Order Details

Order Number: 164178613\_1\_1  
Customer Ref: Land at Model Farm  
National Grid Reference: 307860, 167510  
Slice: A  
Site Area (Ha): 41.25  
Search Buffer (m): 500

## Site Details

Land at Model Farm, CF62 3BD

**Landmark®**  
INFORMATION GROUP

Tel: 0844 844 9952  
Fax: 0844 844 9951  
Web: [www.envirocheck.co.uk](http://www.envirocheck.co.uk)





## Glamorganshire

Published 1900 - 1901

Source map scale - 1:10,560

The historical maps shown were reproduced from maps predominantly held at the scale adopted for England, Wales and Scotland in the 1840's. In 1854 the 1:2,500 scale was adopted for mapping urban areas; these maps were used to update the 1:10,560 maps. The published date given therefore is often some years later than the surveyed date. Before 1938, all OS maps were based on the Cassini Projection, with independent surveys of a single county or group of counties, giving rise to significant inaccuracies in outlying areas. In the late 1940's, a Provisional Edition was produced, which updated the 1:10,560 mapping from a number of sources. The maps appear unfinished - with all military camps and other strategic sites removed. These maps were initially overprinted with the National Grid. In 1970, the first 1:10,000 maps were produced using the Transverse Mercator Projection. The revision process continued until recently, with new editions appearing every 10 years or so for urban areas.

### Map Name(s) and Date(s)

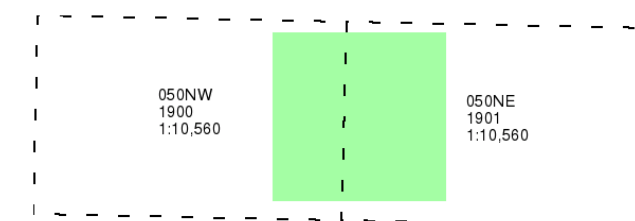

### Historical Map - Slice A

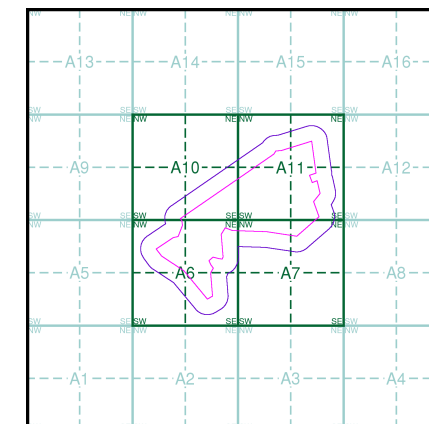

### Order Details

Order Number: 164178613\_1\_1  
Customer Ref: Land at Model Farm  
National Grid Reference: 307860, 167510  
Slice: A  
Site Area (Ha): 41.25  
Search Buffer (m): 500

### Site Details

Land at Model Farm, CF62 3BD

**Landmark**  
INFORMATION GROUP

Tel: 0844 844 9952  
Fax: 0844 844 9951  
Web: [www.envirocheck.co.uk](http://www.envirocheck.co.uk)

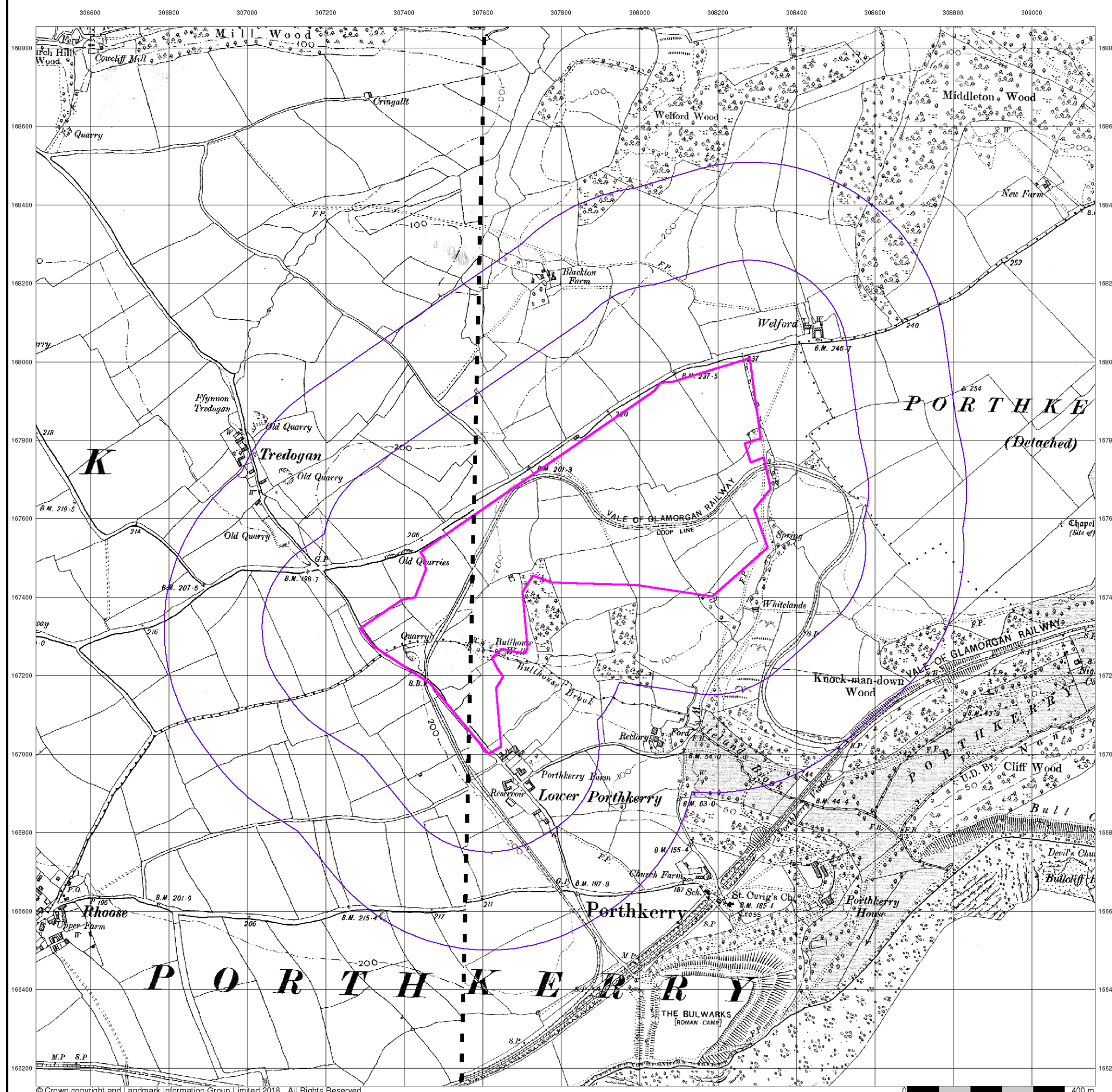





Glamorganshire

Published 1921

Source map scale - 1:10,560

The historical maps shown were reproduced from maps predominantly held at the scale adopted for England, Wales and Scotland in the 1840's. In 1854 the 1:2,500 scale was adopted for mapping urban areas; these maps were used to update the 1:10,560 maps. The published date given therefore is often some years later than the surveyed date. Before 1938, all OS maps were based on the Cassini Projection, with independent surveys of a single county or group of counties, giving rise to significant inaccuracies in outlying areas. In the late 1940's, a Provisional Edition was produced, which updated the 1:10,560 mapping from a number of sources. The maps appear unfinished - with all military camps and other strategic sites removed. These maps were initially overprinted with the National Grid. In 1970, the first 1:10,000 maps were produced using the Transverse Mercator Projection. The revision process continued until recently, with new editions appearing every 10 years or so for urban areas.

### Map Name(s) and Date(s)

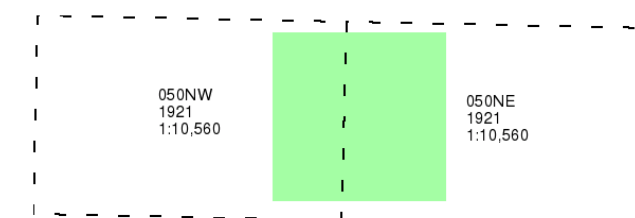

### Historical Map - Slice A

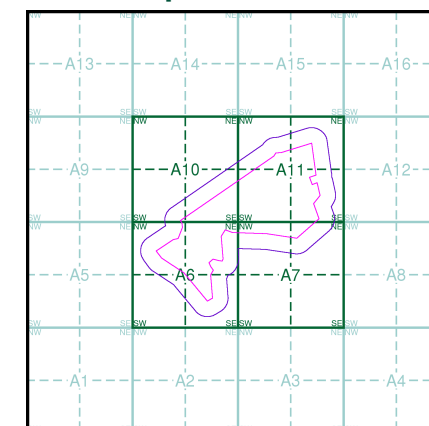

### Order Details

Order Number: 164178613\_1\_1  
Customer Ref: Land at Model Farm  
National Grid Reference: 307860, 167510  
Slice: A  
Site Area (Ha): 41.25  
Search Buffer (m): 500

### Site Details

Land at Model Farm, CF62 3BD

**Landmark**  
INFORMATION GROUP

Tel: 0844 844 9952  
Fax: 0844 844 9951  
Web: [www.envirocheck.co.uk](http://www.envirocheck.co.uk)

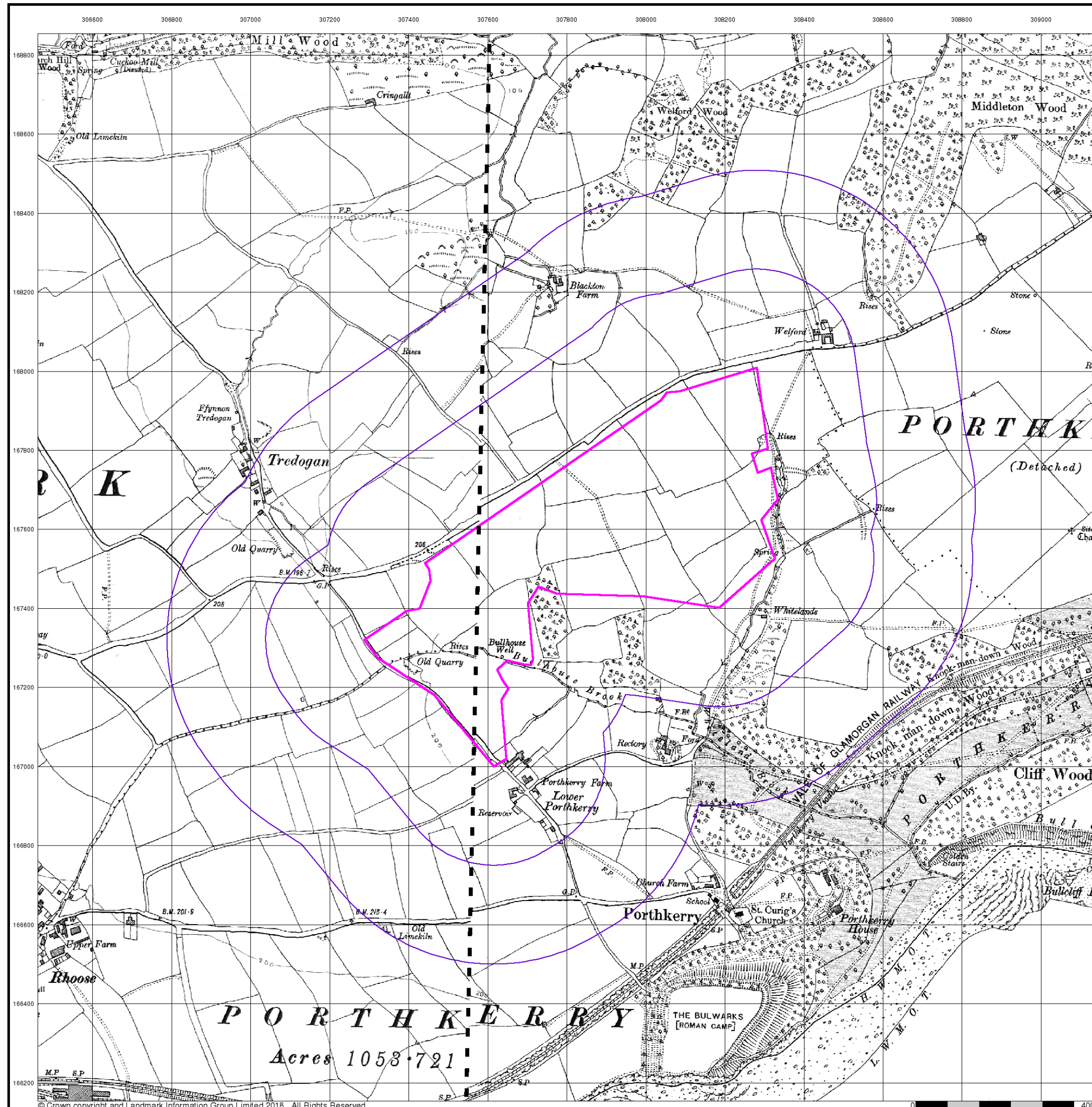





## Glamorganshire

Published 1936

Source map scale - 1:10,560

The historical maps shown were reproduced from maps predominantly held at the scale adopted for England, Wales and Scotland in the 1840's. In 1854 the 1:2,500 scale was adopted for mapping urban areas; these maps were used to update the 1:10,560 maps. The published date given therefore is often some years later than the surveyed date. Before 1938, all OS maps were based on the Cassini Projection, with independent surveys of a single county or group of counties, giving rise to significant inaccuracies in outlying areas. In the late 1940's, a Provisional Edition was produced, which updated the 1:10,560 mapping from a number of sources. The maps appear unfinished - with all military camps and other strategic sites removed. These maps were initially overprinted with the National Grid. In 1970, the first 1:10,000 maps were produced using the Transverse Mercator Projection. The revision process continued until recently, with new editions appearing every 10 years or so for urban areas.

### Map Name(s) and Date(s)

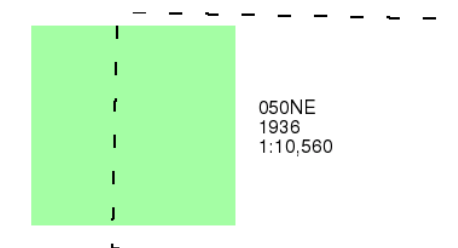

### Historical Map - Slice A

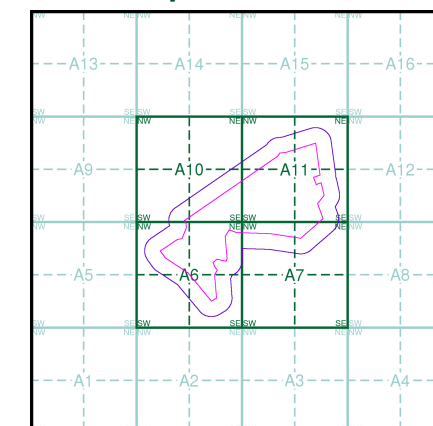

### Order Details

Order Number: 164178613\_1\_1  
Customer Ref: Land at Model Farm  
National Grid Reference: 307860, 167510  
Slice: A  
Site Area (Ha): 41.25  
Search Buffer (m): 500

### Site Details

Land at Model Farm, CF62 3BD



Tel: 0844 844 9952  
Fax: 0844 844 9951  
Web: www.envirocheck.co.uk

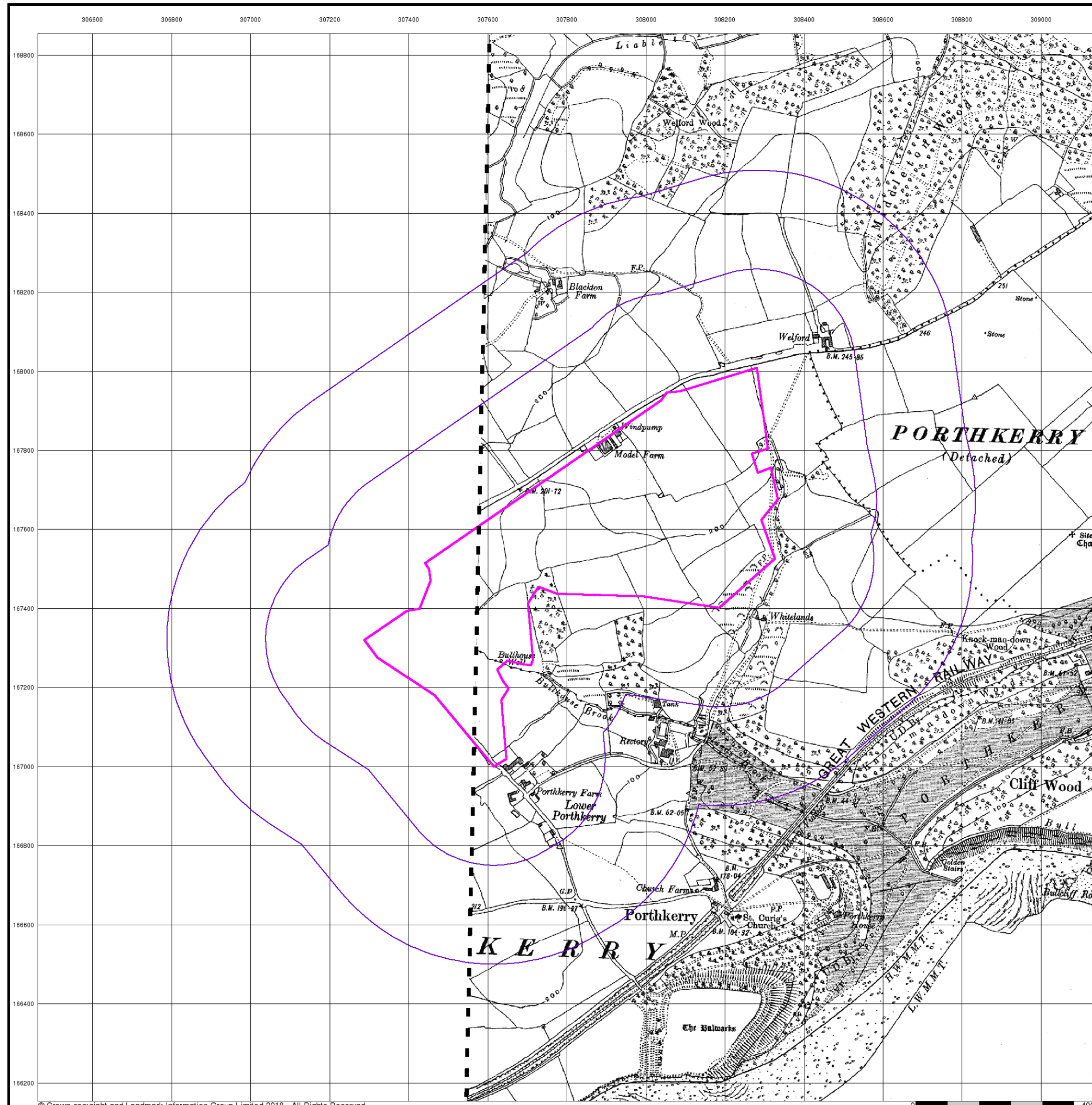





## Glamorganshire

Published 1938 - 1947

Source map scale - 1:10,560

The historical maps shown were reproduced from maps predominantly held at the scale adopted for England, Wales and Scotland in the 1840's. In 1854 the 1:2,500 scale was adopted for mapping urban areas; these maps were used to update the 1:10,560 maps. The published date given therefore is often some years later than the surveyed date. Before 1938, all OS maps were based on the Cassini Projection, with independent surveys of a single county or group of counties, giving rise to significant inaccuracies in outlying areas. In the late 1940's, a Provisional Edition was produced, which updated the 1:10,560 mapping from a number of sources. The maps appear unfinished - with all military camps and other strategic sites removed. These maps were initially overprinted with the National Grid. In 1970, the first 1:10,000 maps were produced using the Transverse Mercator Projection. The revision process continued until recently, with new editions appearing every 10 years or so for urban areas.

### Map Name(s) and Date(s)

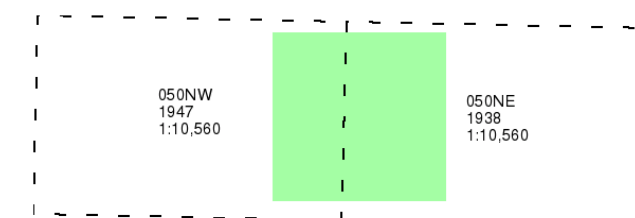

### Historical Map - Slice A

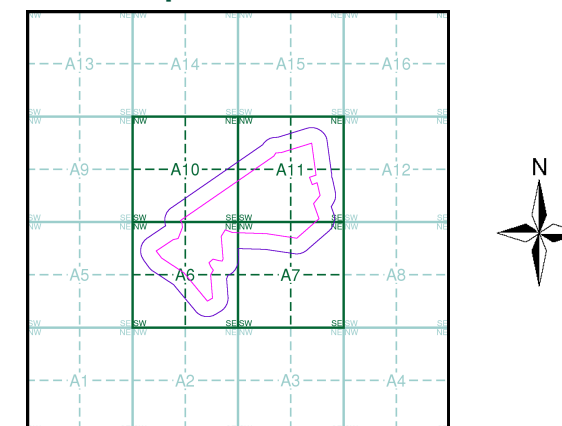

### Order Details

Order Number: 164178613\_1\_1  
Customer Ref: Land at Model Farm  
National Grid Reference: 307860, 167510  
Slice: A  
Site Area (Ha): 41.25  
Search Buffer (m): 500

### Site Details

Land at Model Farm, CF62 3BD

**Landmark**  
INFORMATION GROUP

Tel: 0844 844 9952  
Fax: 0844 844 9951  
Web: [www.envirocheck.co.uk](http://www.envirocheck.co.uk)

