

This graph is a visual representation of the trip rate calculation results screen. The same time periods and trip rates are displayed, but in addition there is an additional column showing the percentage of the total trip rate by individual time period, allowing peak periods to be easily identified through observation. Note that the type of count and the selected direction is shown at the top of the graph.

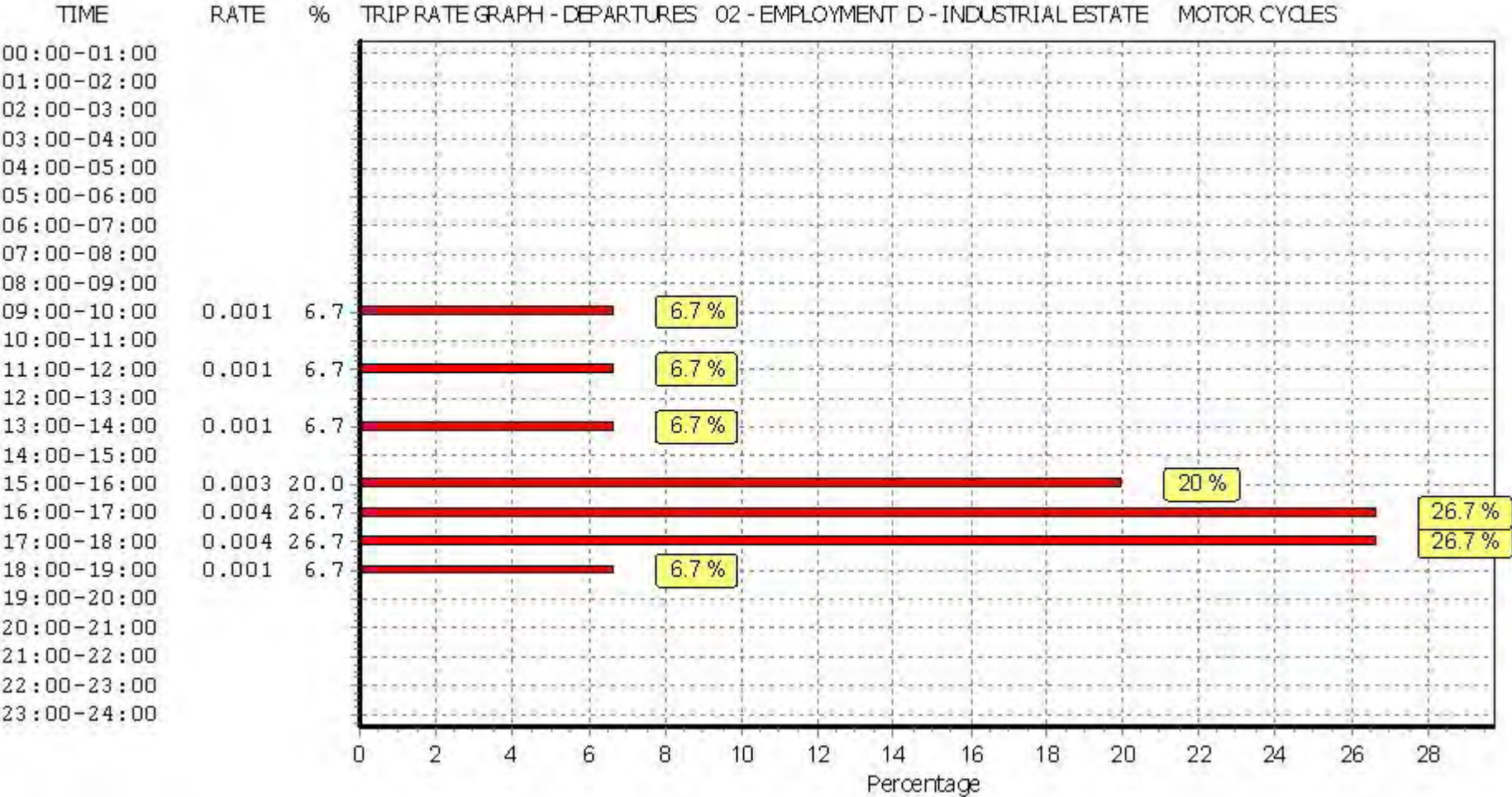

This graph is a visual representation of the trip rate calculation results screen. The same time periods and trip rates are displayed, but in addition there is an additional column showing the percentage of the total trip rate by individual time period, allowing peak periods to be easily identified through observation. Note that the type of count and the selected direction is shown at the top of the graph.

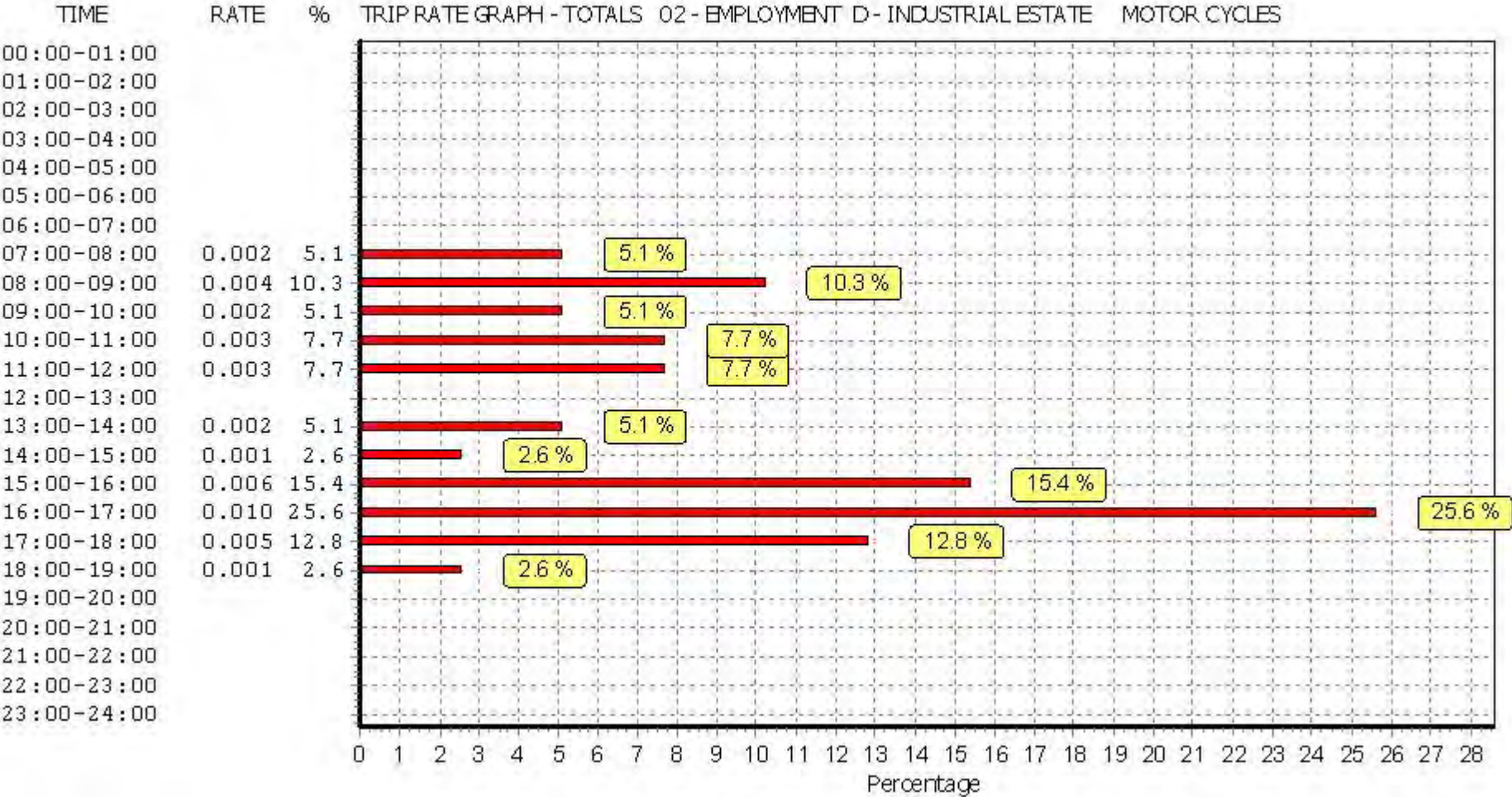

This graph is a visual representation of the trip rate calculation results screen. The same time periods and trip rates are displayed, but in addition there is an additional column showing the percentage of the total trip rate by individual time period, allowing peak periods to be easily identified through observation. Note that the type of count and the selected direction is shown at the top of the graph.

Appendix E – B8 Use TRICS Output Report

Calculation Reference: AUDIT-515501-190213-0205

TRIP RATE CALCULATION SELECTION PARAMETERS:

Land Use : 02 - EMPLOYMENT
Category : F - WAREHOUSING (COMMERCIAL)
VEHICLES

Selected regions and areas:

02	SOUTH EAST	
	HF HERTFORDSHIRE	1 days
	KC KENT	1 days
05	EAST MIDLANDS	
	LN LINCOLNSHIRE	1 days
10	WALES	
	WR WREXHAM	1 days

This section displays the number of survey days per TRICS® sub-region in the selected set

Secondary Filtering selection:

This data displays the chosen trip rate parameter and its selected range. Only sites that fall within the parameter range are included in the trip rate calculation.

Parameter: Gross floor area
Actual Range: 9000 to 76000 (units: sqm)
Range Selected by User: 5000 to 80066 (units: sqm)

Parking Spaces Range: Selected: 4 to 832 Actual: 4 to 832

Public Transport Provision:

Selection by: Include all surveys

Date Range: 01/01/08 to 22/09/17

This data displays the range of survey dates selected. Only surveys that were conducted within this date range are included in the trip rate calculation.

Selected survey days:

Monday	1 days
Tuesday	1 days
Thursday	1 days
Friday	1 days

This data displays the number of selected surveys by day of the week.

Selected survey types:

Manual count	4 days
Directional ATC Count	0 days

This data displays the number of manual classified surveys and the number of unclassified ATC surveys, the total adding up to the overall number of surveys in the selected set. Manual surveys are undertaken using staff, whilst ATC surveys are undertaken using machines.

Selected Locations:

Edge of Town	3
Free Standing (PPS6 Out of Town)	1

This data displays the number of surveys per main location category within the selected set. The main location categories consist of Free Standing, Edge of Town, Suburban Area, Neighbourhood Centre, Edge of Town Centre, Town Centre and Not Known.

Selected Location Sub Categories:

Industrial Zone	2
Commercial Zone	1
No Sub Category	1

This data displays the number of surveys per location sub-category within the selected set. The location sub-categories consist of Commercial Zone, Industrial Zone, Development Zone, Residential Zone, Retail Zone, Built-Up Zone, Village, Out of Town, High Street and No Sub Category.

Secondary Filtering selection:

Use Class:

B8	4 days
----	--------

This data displays the number of surveys per Use Class classification within the selected set. The Use Classes Order 2005 has been used for this purpose, which can be found within the Library module of TRICS®.

Population within 1 mile:

1,000 or Less	1 days
1,001 to 5,000	1 days
10,001 to 15,000	1 days
15,001 to 20,000	1 days

This data displays the number of selected surveys within stated 1-mile radii of population.

Population within 5 miles:

25,001 to 50,000	1 days
50,001 to 75,000	1 days
125,001 to 250,000	2 days

This data displays the number of selected surveys within stated 5-mile radii of population.

Car ownership within 5 miles:

0.6 to 1.0	1 days
1.1 to 1.5	3 days

This data displays the number of selected surveys within stated ranges of average cars owned per residential dwelling, within a radius of 5-miles of selected survey sites.

Travel Plan:

No	4 days
----	--------

This data displays the number of surveys within the selected set that were undertaken at sites with Travel Plans in place, and the number of surveys that were undertaken at sites without Travel Plans.

PTAL Rating:

No PTAL Present	4 days
-----------------	--------

This data displays the number of selected surveys with PTAL Ratings.

LIST OF SITES relevant to selection parameters

1	HF-02-F-03	DISTRIBUTION CEN.	HERTFORDSHIRE
	HATFIELD		
	HATFIELD BUSINESS CEN.		
	Edge of Town		
	Commercial Zone		
	Total Gross floor area:	80000 sqm	
	Survey date: THURSDAY	10/07/08	Survey Type: MANUAL
2	KC-02-F-02	COMMERCIAL WAREHOUSING	KENT
	MILLS ROAD		
	AYLESFORD		
	QUARRY WOOD		
	Edge of Town		
	Industrial Zone		
	Total Gross floor area:	11200 sqm	
	Survey date: FRIDAY	22/09/17	Survey Type: MANUAL
3	LN-02-F-01	BOOK SERVICE	LINCOLNSHIRE
	TRENT ROAD		
	GRANTHAM		
	Edge of Town		
	No Sub Category		
	Total Gross floor area:	32300 sqm	
	Survey date: MONDAY	29/11/10	Survey Type: MANUAL
4	WR-02-F-01	WAREHOUSE	WREXHAM
	UNIT 1-2 PACIFIC PARK		
	NEAR WREXHAM		
	WREXHAM IND. ESTATE		
	Free Standing (PPS6 Out of Town)		
	Industrial Zone		
	Total Gross floor area:	9000 sqm	
	Survey date: TUESDAY	18/10/11	Survey Type: MANUAL

This section provides a list of all survey sites and days in the selected set. For each individual survey site, it displays a unique site reference code and site address, the selected trip rate calculation parameter and its value, the day of the week and date of each survey, and whether the survey was a manual classified count or an ATC count.

MANUALLY DESELECTED SITES

Site Ref	Reason for Deselection
TW-02-F-01	HIGH PT

TRIP RATE for Land Use 02 - EMPLOYMENT/F - WAREHOUSING (COMMERCIAL)
VEHICLES
Calculation factor: 100 sqm
BOLD print indicates peak (busiest) period

Time Range	ARRIVALS			DEPARTURES			TOTALS		
	No. Days	Ave. GFA	Trip Rate	No. Days	Ave. GFA	Trip Rate	No. Days	Ave. GFA	Trip Rate
00:00 - 01:00									
01:00 - 02:00									
02:00 - 03:00									
03:00 - 04:00									
04:00 - 05:00									
05:00 - 06:00									
06:00 - 07:00									
07:00 - 08:00	4	31721	0.110	4	31721	0.080	4	31721	0.190
08:00 - 09:00	4	31721	0.091	4	31721	0.048	4	31721	0.139
09:00 - 10:00	4	31721	0.084	4	31721	0.066	4	31721	0.150
10:00 - 11:00	4	31721	0.065	4	31721	0.065	4	31721	0.130
11:00 - 12:00	4	31721	0.064	4	31721	0.069	4	31721	0.133
12:00 - 13:00	4	31721	0.068	4	31721	0.074	4	31721	0.142
13:00 - 14:00	4	31721	0.095	4	31721	0.085	4	31721	0.180
14:00 - 15:00	4	31721	0.106	4	31721	0.126	4	31721	0.232
15:00 - 16:00	4	31721	0.106	4	31721	0.128	4	31721	0.234
16:00 - 17:00	4	31721	0.080	4	31721	0.125	4	31721	0.205
17:00 - 18:00	4	31721	0.024	4	31721	0.086	4	31721	0.110
18:00 - 19:00	4	31721	0.013	4	31721	0.054	4	31721	0.067
19:00 - 20:00									
20:00 - 21:00									
21:00 - 22:00									
22:00 - 23:00									
23:00 - 24:00									
Total Rates:			0.906			1.006			1.912

This section displays the trip rate results based on the selected set of surveys and the selected count type (shown just above the table). It is split by three main columns, representing arrivals trips, departures trips, and total trips (arrivals plus departures). Within each of these main columns are three sub-columns. These display the number of survey days where count data is included (per time period), the average value of the selected trip rate calculation parameter (per time period), and the trip rate result (per time period). Total trip rates (the sum of the column) are also displayed at the foot of the table.

*To obtain a trip rate, the average (mean) trip rate parameter value (TRP) is first calculated for all selected survey days that have count data available for the stated time period. The average (mean) number of arrivals, departures or totals (whichever applies) is also calculated (COUNT) for all selected survey days that have count data available for the stated time period. Then, the average count is divided by the average trip rate parameter value, and multiplied by the stated calculation factor (shown just above the table and abbreviated here as FACT). So, the method is: COUNT/TRP*FACT. Trip rates are then rounded to 3 decimal places.*

The survey data, graphs and all associated supporting information, contained within the TRICS Database are published by TRICS Consortium Limited ("the Company") and the Company claims copyright and database rights in this published work. The Company authorises those who possess a current TRICS licence to access the TRICS Database and copy the data contained within the TRICS Database for the licence holders' use only. Any resulting copy must retain all copyrights and other proprietary notices, and any disclaimer contained thereon.

The Company accepts no responsibility for loss which may arise from reliance on data contained in the TRICS Database. [No warranty of any kind, express or implied, is made as to the data contained in the TRICS Database.]

Parameter summary

Trip rate parameter range selected:	9000 - 76000 (units: sqm)
Survey date date range:	01/01/08 - 22/09/17
Number of weekdays (Monday-Friday):	4
Number of Saturdays:	0
Number of Sundays:	0
Surveys automatically removed from selection:	0
Surveys manually removed from selection:	1

This section displays a quick summary of some of the data filtering selections made by the TRICS® user. The trip rate calculation parameter range of all selected surveys is displayed first, followed by the range of minimum and maximum survey dates selected by the user. Then, the total number of selected weekdays and weekend days in the selected set of surveys are show. Finally, the number of survey days that have been manually removed from the selected set outside of the standard filtering procedure are displayed.



This graph is a visual representation of the trip rate calculation results screen. The same time periods and trip rates are displayed, but in addition there is an additional column showing the percentage of the total trip rate by individual time period, allowing peak periods to be easily identified through observation. Note that the type of count and the selected direction is shown at the top of the graph.

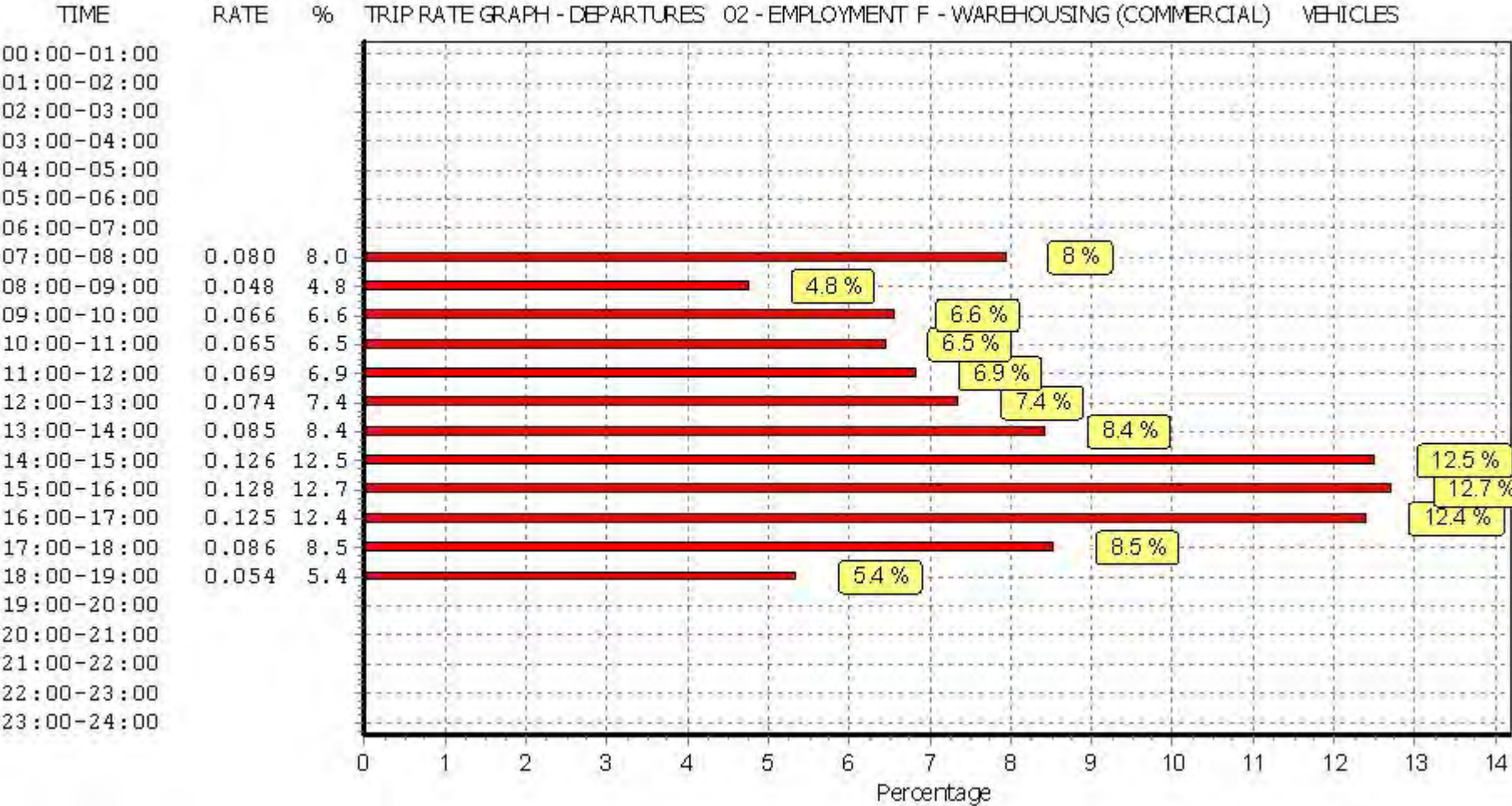

This graph is a visual representation of the trip rate calculation results screen. The same time periods and trip rates are displayed, but in addition there is an additional column showing the percentage of the total trip rate by individual time period, allowing peak periods to be easily identified through observation. Note that the type of count and the selected direction is shown at the top of the graph.

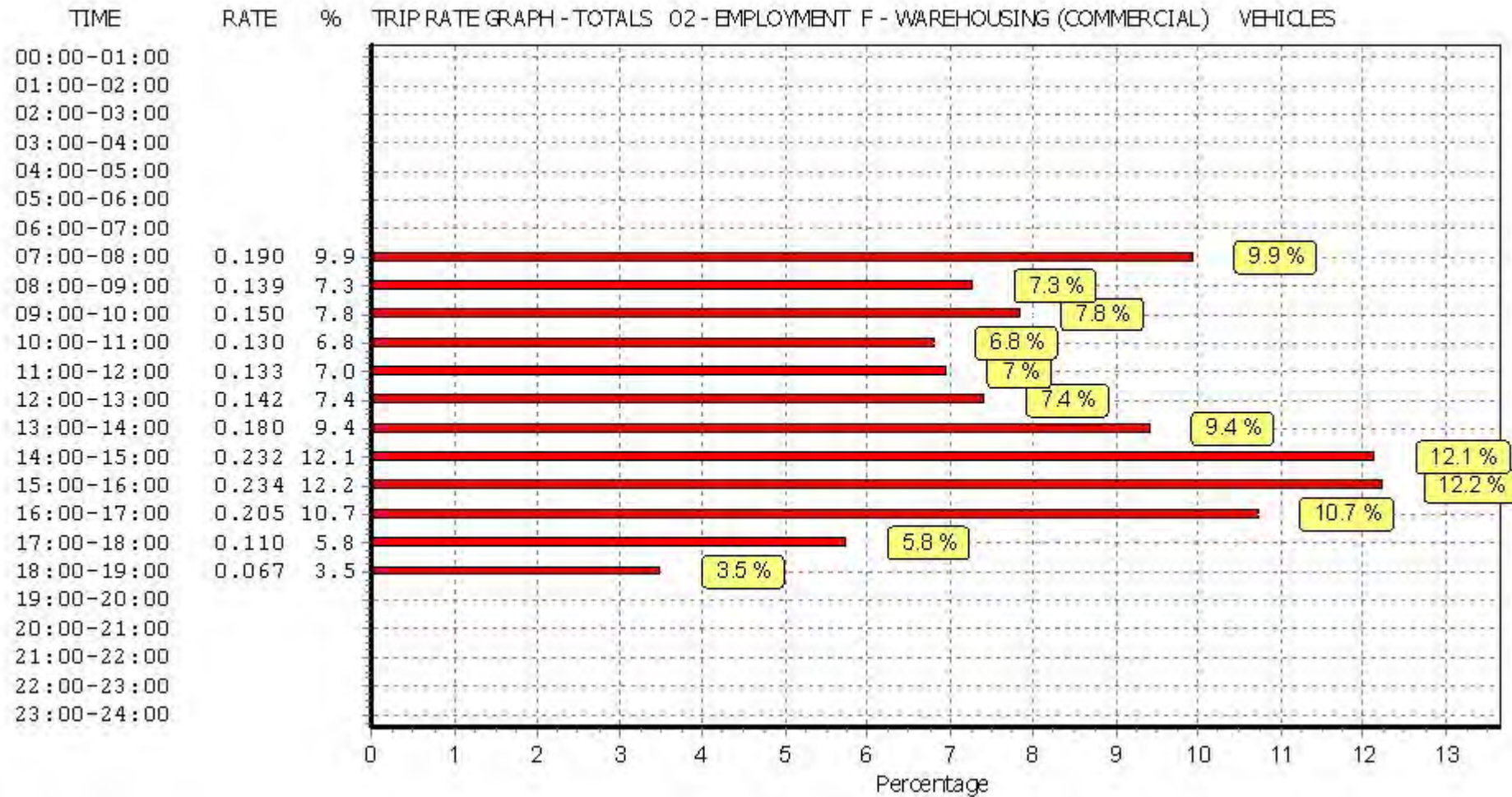

This graph is a visual representation of the trip rate calculation results screen. The same time periods and trip rates are displayed, but in addition there is an additional column showing the percentage of the total trip rate by individual time period, allowing peak periods to be easily identified through observation. Note that the type of count and the selected direction is shown at the top of the graph.

TRIP RATE for Land Use 02 - EMPLOYMENT/F - WAREHOUSING (COMMERCIAL)

TAXIS

Calculation factor: 100 sqm

BOLD print indicates peak (busiest) period

Time Range	ARRIVALS			DEPARTURES			TOTALS		
	No. Days	Ave. GFA	Trip Rate	No. Days	Ave. GFA	Trip Rate	No. Days	Ave. GFA	Trip Rate
00:00 - 01:00									
01:00 - 02:00									
02:00 - 03:00									
03:00 - 04:00									
04:00 - 05:00									
05:00 - 06:00									
06:00 - 07:00									
07:00 - 08:00	4	31721	0.000	4	31721	0.000	4	31721	0.000
08:00 - 09:00	4	31721	0.000	4	31721	0.000	4	31721	0.000
09:00 - 10:00	4	31721	0.000	4	31721	0.000	4	31721	0.000
10:00 - 11:00	4	31721	0.000	4	31721	0.000	4	31721	0.000
11:00 - 12:00	4	31721	0.000	4	31721	0.000	4	31721	0.000
12:00 - 13:00	4	31721	0.000	4	31721	0.000	4	31721	0.000
13:00 - 14:00	4	31721	0.000	4	31721	0.000	4	31721	0.000
14:00 - 15:00	4	31721	0.000	4	31721	0.000	4	31721	0.000
15:00 - 16:00	4	31721	0.001	4	31721	0.001	4	31721	0.002
16:00 - 17:00	4	31721	0.002	4	31721	0.002	4	31721	0.004
17:00 - 18:00	4	31721	0.000	4	31721	0.000	4	31721	0.000
18:00 - 19:00	4	31721	0.000	4	31721	0.000	4	31721	0.000
19:00 - 20:00									
20:00 - 21:00									
21:00 - 22:00									
22:00 - 23:00									
23:00 - 24:00									
Total Rates:	0.003			0.003			0.006		

This section displays the trip rate results based on the selected set of surveys and the selected count type (shown just above the table). It is split by three main columns, representing arrivals trips, departures trips, and total trips (arrivals plus departures). Within each of these main columns are three sub-columns. These display the number of survey days where count data is included (per time period), the average value of the selected trip rate calculation parameter (per time period), and the trip rate result (per time period). Total trip rates (the sum of the column) are also displayed at the foot of the table.

To obtain a trip rate, the average (mean) trip rate parameter value (TRP) is first calculated for all selected survey days that have count data available for the stated time period. The average (mean) number of arrivals, departures or totals (whichever applies) is also calculated (COUNT) for all selected survey days that have count data available for the stated time period. Then, the average count is divided by the average trip rate parameter value, and multiplied by the stated calculation factor (shown just above the table and abbreviated here as FACT). So, the method is: $COUNT/TRP*FACT$. Trip rates are then rounded to 3 decimal places.

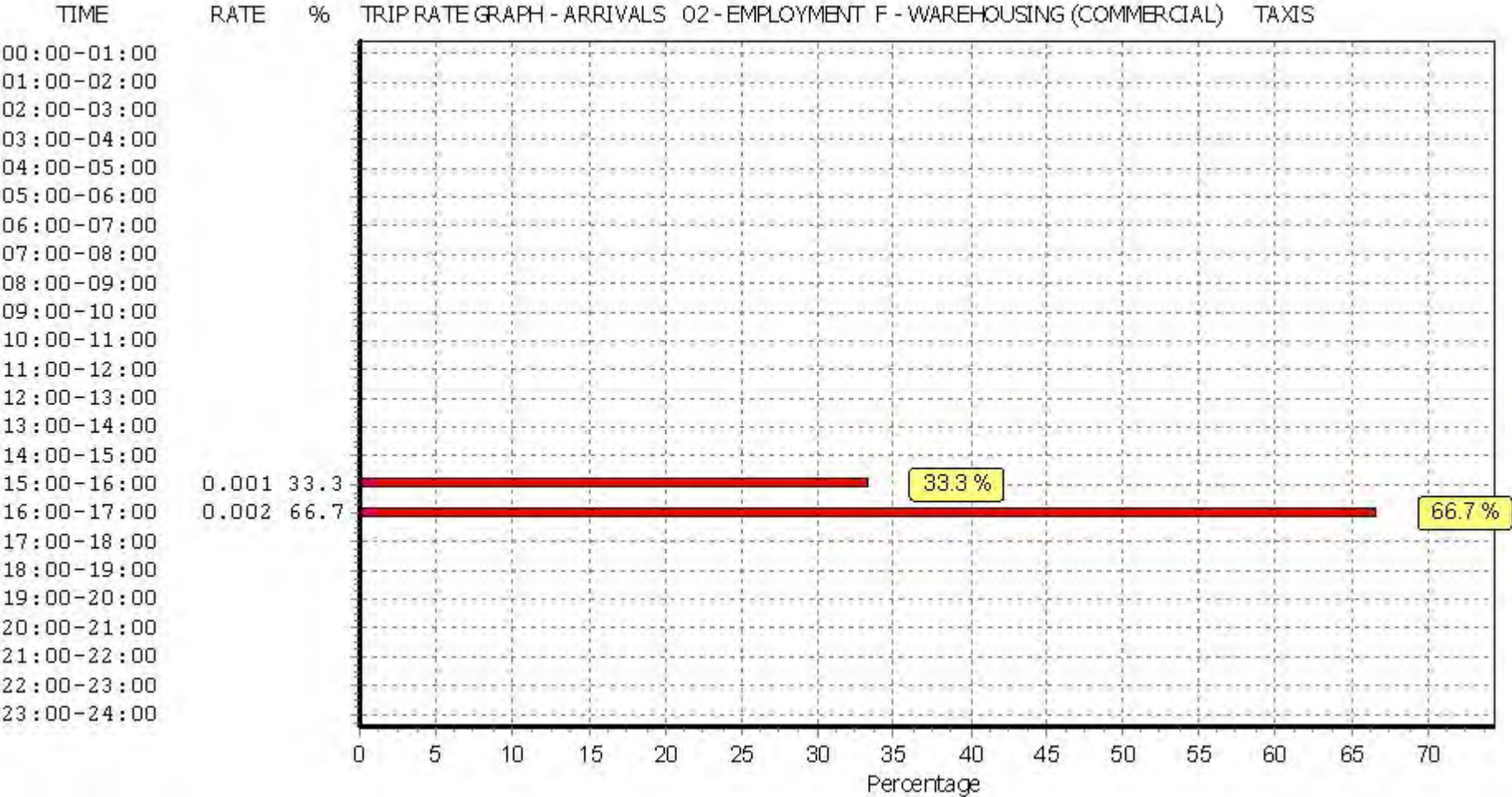

This graph is a visual representation of the trip rate calculation results screen. The same time periods and trip rates are displayed, but in addition there is an additional column showing the percentage of the total trip rate by individual time period, allowing peak periods to be easily identified through observation. Note that the type of count and the selected direction is shown at the top of the graph.

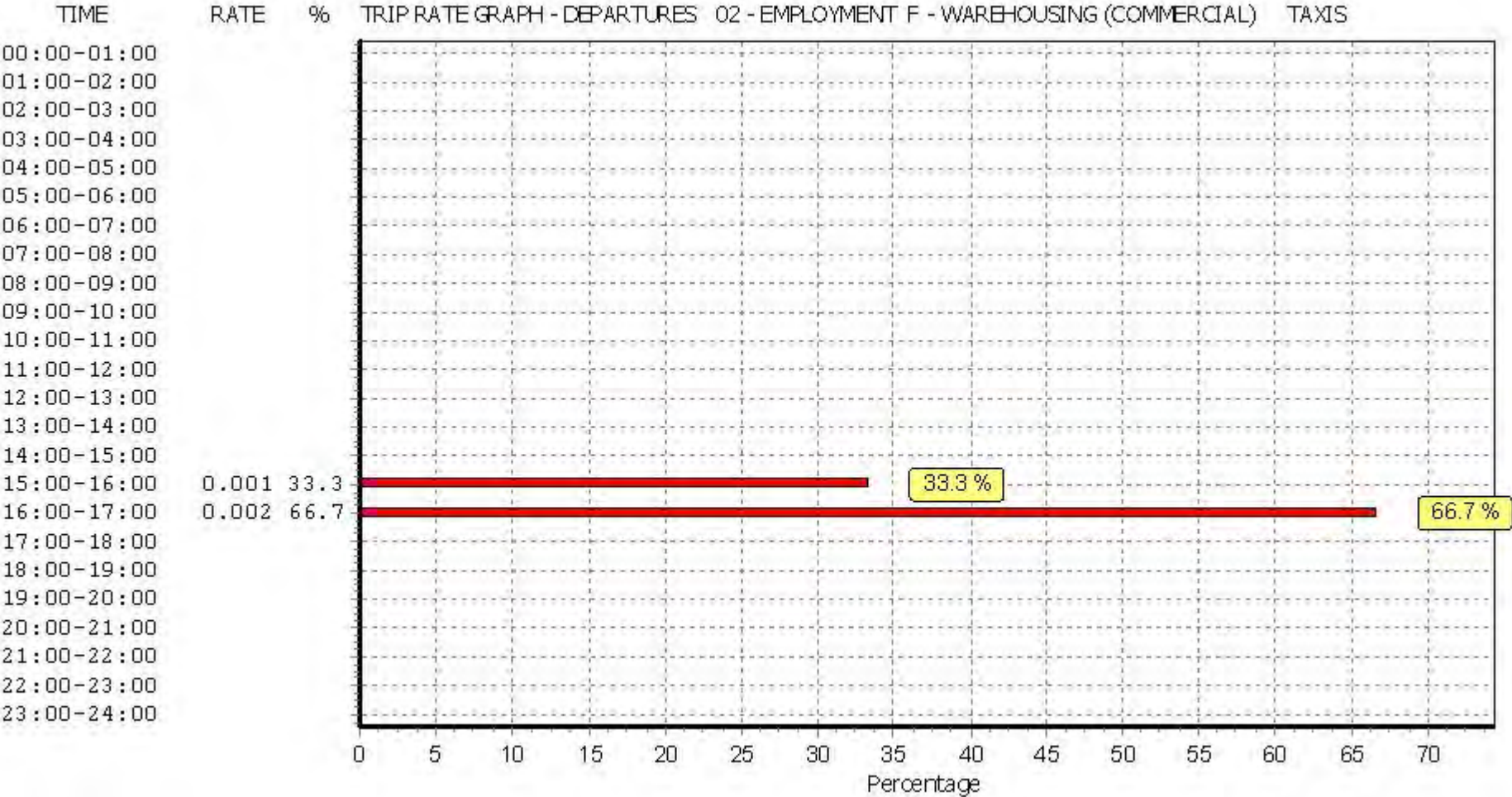

This graph is a visual representation of the trip rate calculation results screen. The same time periods and trip rates are displayed, but in addition there is an additional column showing the percentage of the total trip rate by individual time period, allowing peak periods to be easily identified through observation. Note that the type of count and the selected direction is shown at the top of the graph.

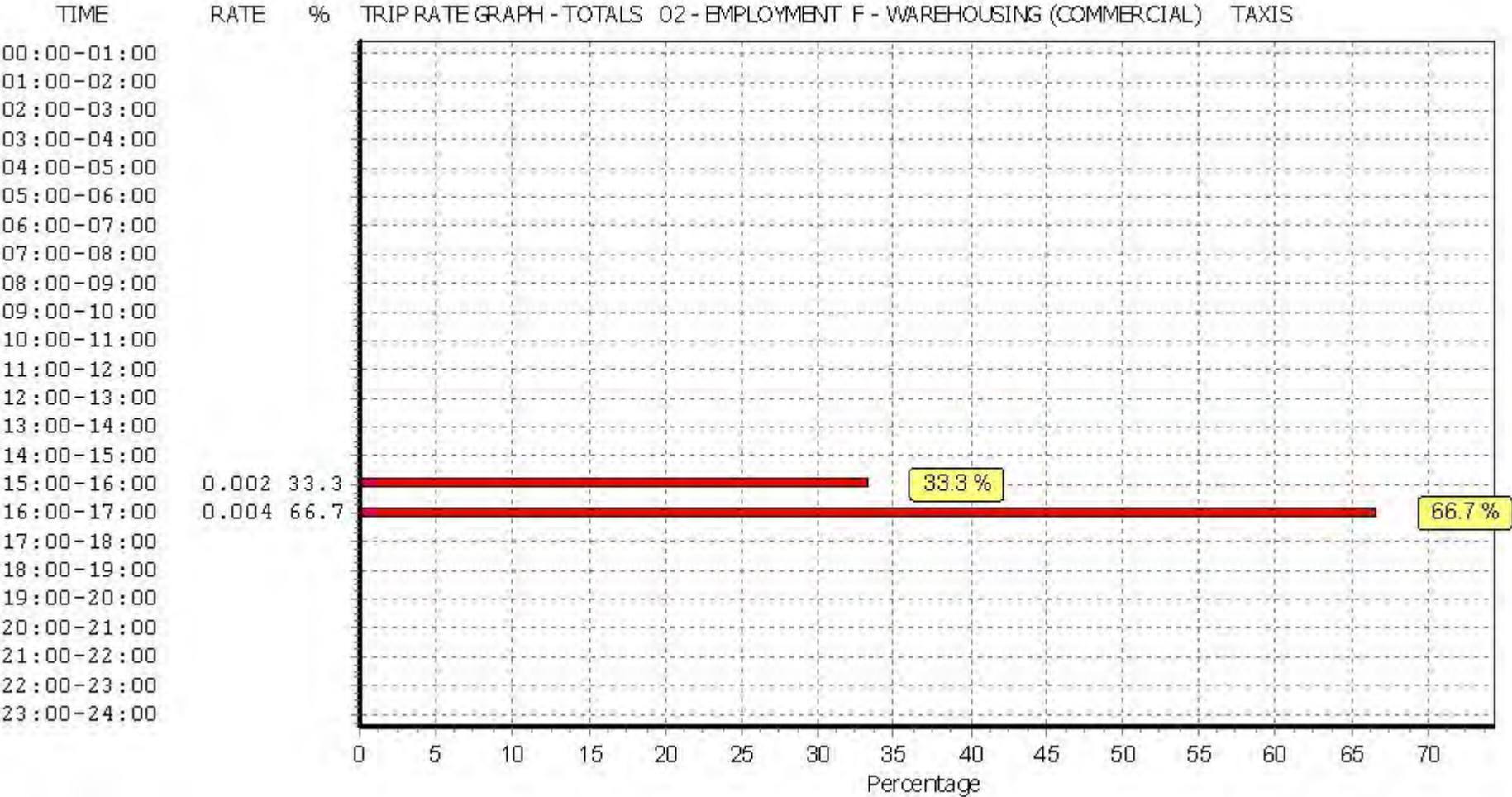

This graph is a visual representation of the trip rate calculation results screen. The same time periods and trip rates are displayed, but in addition there is an additional column showing the percentage of the total trip rate by individual time period, allowing peak periods to be easily identified through observation. Note that the type of count and the selected direction is shown at the top of the graph.

TRIP RATE for Land Use 02 - EMPLOYMENT/F - WAREHOUSING (COMMERCIAL)

OGVS

Calculation factor: 100 sqm

BOLD print indicates peak (busiest) period

Time Range	ARRIVALS			DEPARTURES			TOTALS		
	No. Days	Ave. GFA	Trip Rate	No. Days	Ave. GFA	Trip Rate	No. Days	Ave. GFA	Trip Rate
00:00 - 01:00									
01:00 - 02:00									
02:00 - 03:00									
03:00 - 04:00									
04:00 - 05:00									
05:00 - 06:00									
06:00 - 07:00									
07:00 - 08:00	4	31721	0.009	4	31721	0.008	4	31721	0.017
08:00 - 09:00	4	31721	0.008	4	31721	0.004	4	31721	0.012
09:00 - 10:00	4	31721	0.014	4	31721	0.013	4	31721	0.027
10:00 - 11:00	4	31721	0.017	4	31721	0.018	4	31721	0.035
11:00 - 12:00	4	31721	0.011	4	31721	0.020	4	31721	0.031
12:00 - 13:00	4	31721	0.009	4	31721	0.017	4	31721	0.026
13:00 - 14:00	4	31721	0.013	4	31721	0.011	4	31721	0.024
14:00 - 15:00	4	31721	0.014	4	31721	0.009	4	31721	0.023
15:00 - 16:00	4	31721	0.010	4	31721	0.011	4	31721	0.021
16:00 - 17:00	4	31721	0.013	4	31721	0.002	4	31721	0.015
17:00 - 18:00	4	31721	0.004	4	31721	0.004	4	31721	0.008
18:00 - 19:00	4	31721	0.002	4	31721	0.002	4	31721	0.004
19:00 - 20:00									
20:00 - 21:00									
21:00 - 22:00									
22:00 - 23:00									
23:00 - 24:00									
Total Rates:	0.124			0.119			0.243		

This section displays the trip rate results based on the selected set of surveys and the selected count type (shown just above the table). It is split by three main columns, representing arrivals trips, departures trips, and total trips (arrivals plus departures). Within each of these main columns are three sub-columns. These display the number of survey days where count data is included (per time period), the average value of the selected trip rate calculation parameter (per time period), and the trip rate result (per time period). Total trip rates (the sum of the column) are also displayed at the foot of the table.

*To obtain a trip rate, the average (mean) trip rate parameter value (TRP) is first calculated for all selected survey days that have count data available for the stated time period. The average (mean) number of arrivals, departures or totals (whichever applies) is also calculated (COUNT) for all selected survey days that have count data available for the stated time period. Then, the average count is divided by the average trip rate parameter value, and multiplied by the stated calculation factor (shown just above the table and abbreviated here as FACT). So, the method is: COUNT/TRP*FACT. Trip rates are then rounded to 3 decimal places.*

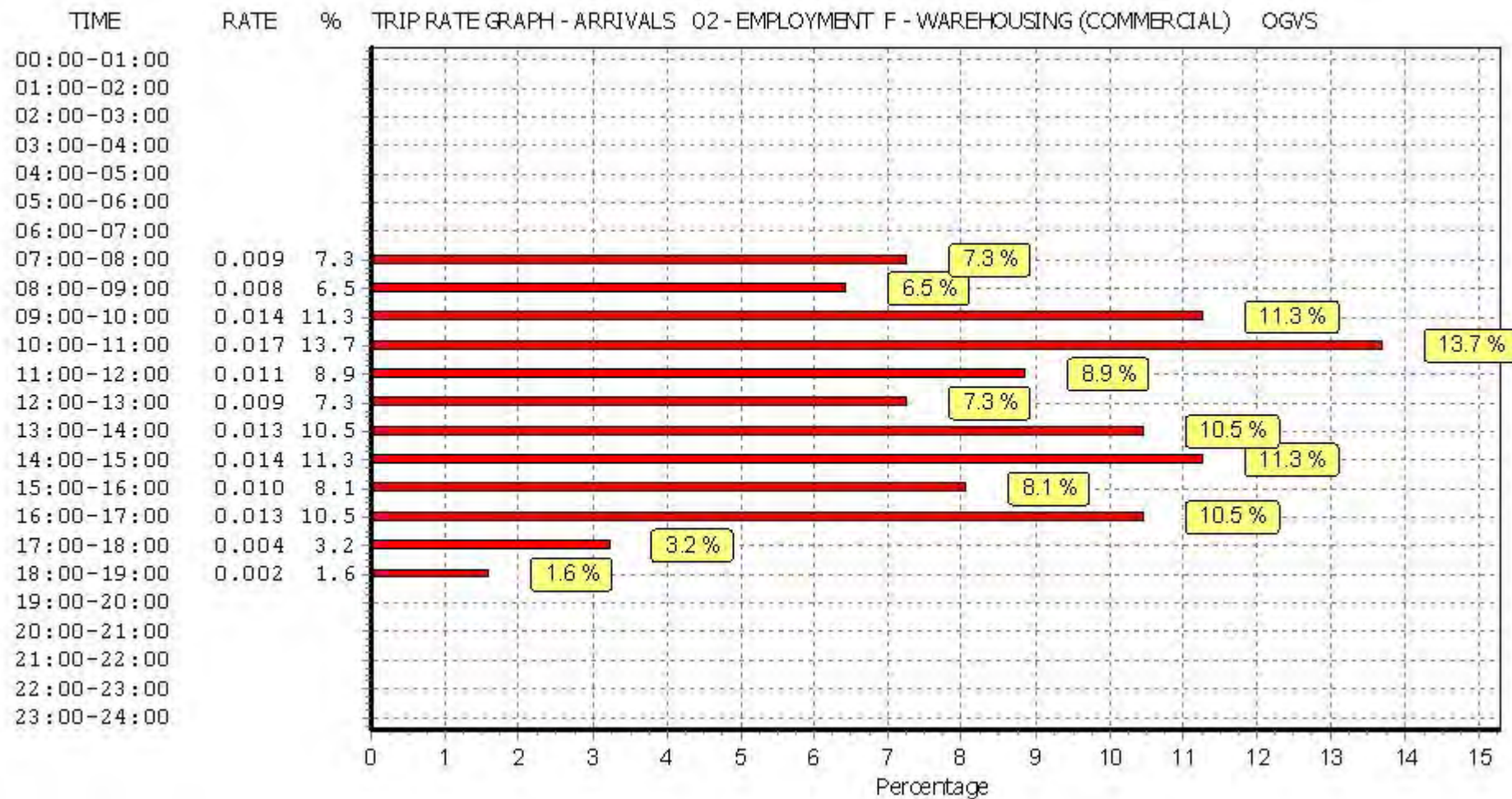

This graph is a visual representation of the trip rate calculation results screen. The same time periods and trip rates are displayed, but in addition there is an additional column showing the percentage of the total trip rate by individual time period, allowing peak periods to be easily identified through observation. Note that the type of count and the selected direction is shown at the top of the graph.

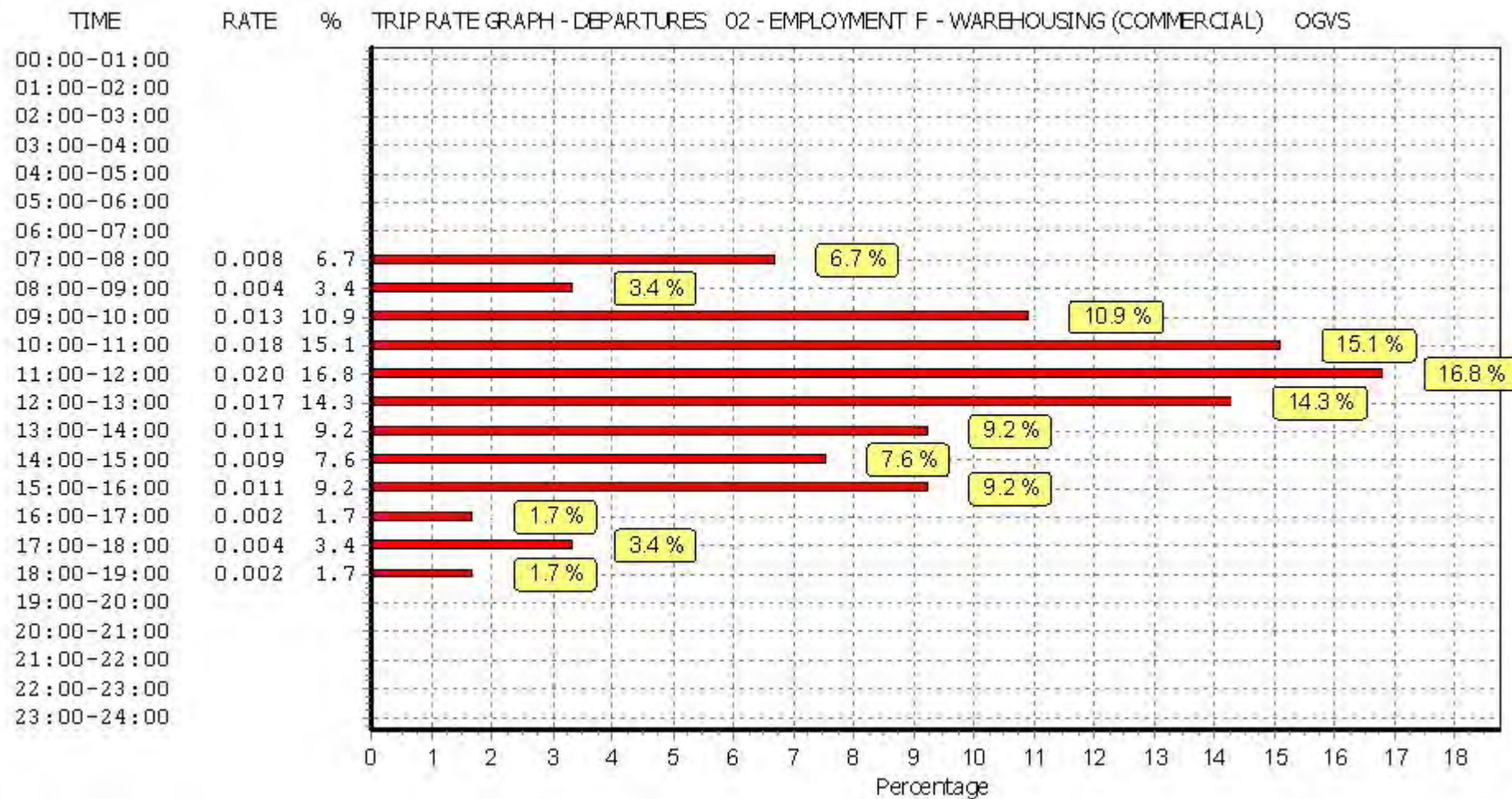

This graph is a visual representation of the trip rate calculation results screen. The same time periods and trip rates are displayed, but in addition there is an additional column showing the percentage of the total trip rate by individual time period, allowing peak periods to be easily identified through observation. Note that the type of count and the selected direction is shown at the top of the graph.

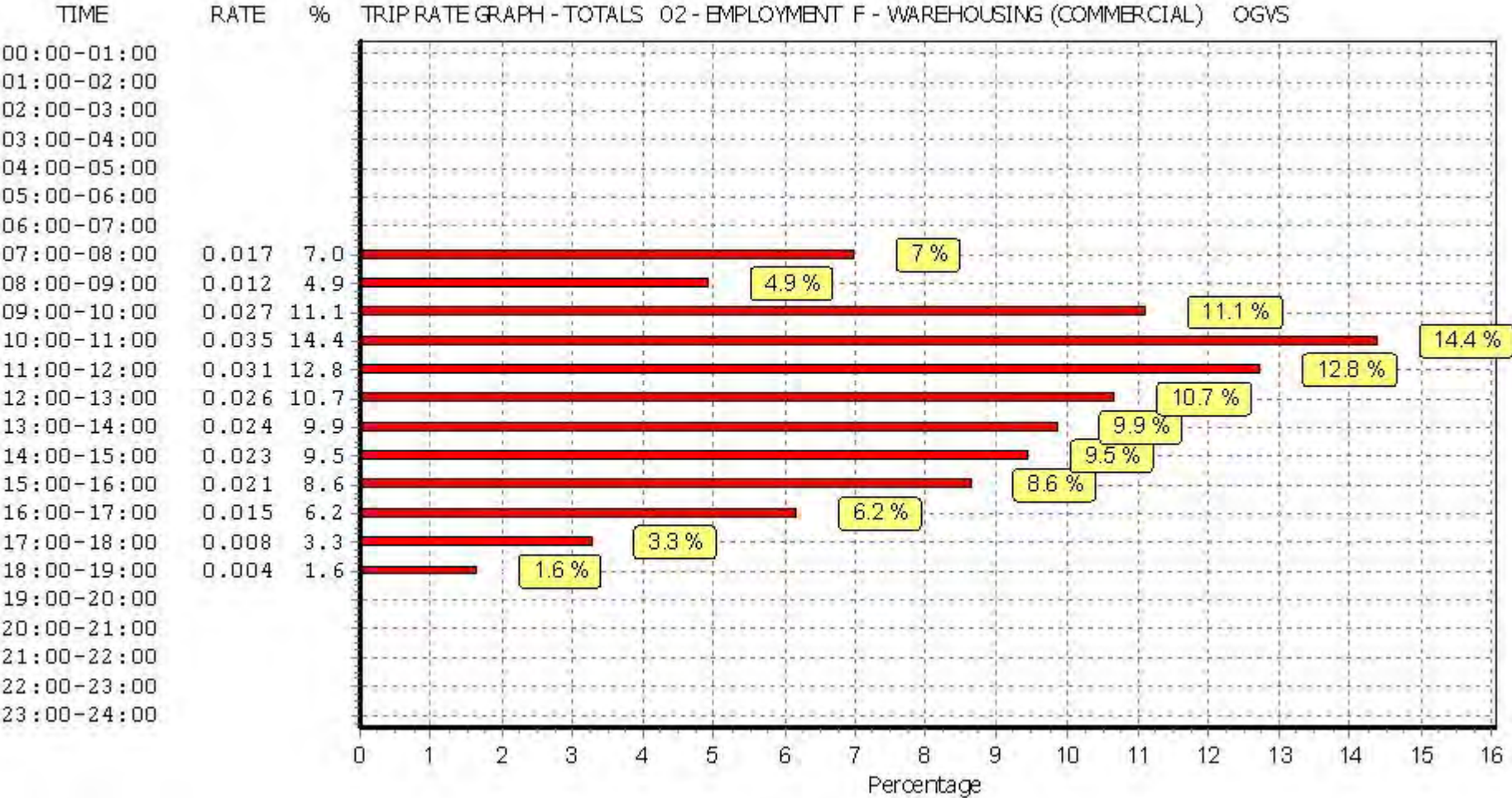

This graph is a visual representation of the trip rate calculation results screen. The same time periods and trip rates are displayed, but in addition there is an additional column showing the percentage of the total trip rate by individual time period, allowing peak periods to be easily identified through observation. Note that the type of count and the selected direction is shown at the top of the graph.

TRIP RATE for Land Use 02 - EMPLOYMENT/F - WAREHOUSING (COMMERCIAL)

PSVS

Calculation factor: 100 sqm

BOLD print indicates peak (busiest) period

Time Range	ARRIVALS			DEPARTURES			TOTALS		
	No. Days	Ave. GFA	Trip Rate	No. Days	Ave. GFA	Trip Rate	No. Days	Ave. GFA	Trip Rate
00:00 - 01:00									
01:00 - 02:00									
02:00 - 03:00									
03:00 - 04:00									
04:00 - 05:00									
05:00 - 06:00									
06:00 - 07:00									
07:00 - 08:00	4	31721	0.000	4	31721	0.001	4	31721	0.001
08:00 - 09:00	4	31721	0.000	4	31721	0.000	4	31721	0.000
09:00 - 10:00	4	31721	0.000	4	31721	0.000	4	31721	0.000
10:00 - 11:00	4	31721	0.000	4	31721	0.000	4	31721	0.000
11:00 - 12:00	4	31721	0.000	4	31721	0.000	4	31721	0.000
12:00 - 13:00	4	31721	0.000	4	31721	0.000	4	31721	0.000
13:00 - 14:00	4	31721	0.000	4	31721	0.000	4	31721	0.000
14:00 - 15:00	4	31721	0.000	4	31721	0.000	4	31721	0.000
15:00 - 16:00	4	31721	0.000	4	31721	0.000	4	31721	0.000
16:00 - 17:00	4	31721	0.000	4	31721	0.000	4	31721	0.000
17:00 - 18:00	4	31721	0.000	4	31721	0.000	4	31721	0.000
18:00 - 19:00	4	31721	0.000	4	31721	0.000	4	31721	0.000
19:00 - 20:00									
20:00 - 21:00									
21:00 - 22:00									
22:00 - 23:00									
23:00 - 24:00									
Total Rates:	0.000			0.001			0.001		

This section displays the trip rate results based on the selected set of surveys and the selected count type (shown just above the table). It is split by three main columns, representing arrivals trips, departures trips, and total trips (arrivals plus departures). Within each of these main columns are three sub-columns. These display the number of survey days where count data is included (per time period), the average value of the selected trip rate calculation parameter (per time period), and the trip rate result (per time period). Total trip rates (the sum of the column) are also displayed at the foot of the table.

To obtain a trip rate, the average (mean) trip rate parameter value (TRP) is first calculated for all selected survey days that have count data available for the stated time period. The average (mean) number of arrivals, departures or totals (whichever applies) is also calculated (COUNT) for all selected survey days that have count data available for the stated time period. Then, the average count is divided by the average trip rate parameter value, and multiplied by the stated calculation factor (shown just above the table and abbreviated here as FACT). So, the method is: $COUNT/TRP*FACT$. Trip rates are then rounded to 3 decimal places.

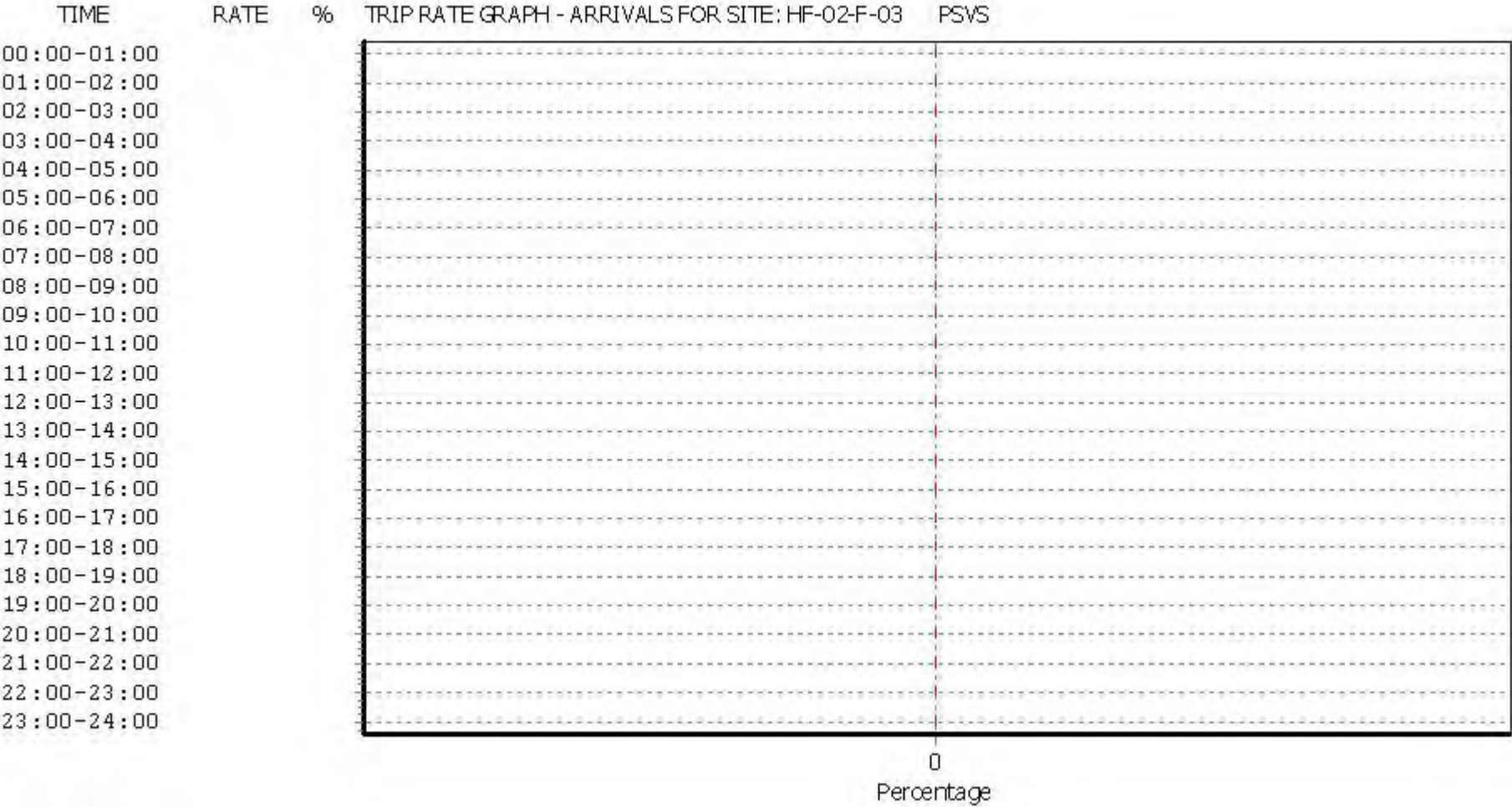

This graph is a visual representation of the trip rate calculation results screen. The same time periods and trip rates are displayed, but in addition there is an additional column showing the percentage of the total trip rate by individual time period, allowing peak periods to be easily identified through observation. Note that the type of count and the selected direction is shown at the top of the graph.

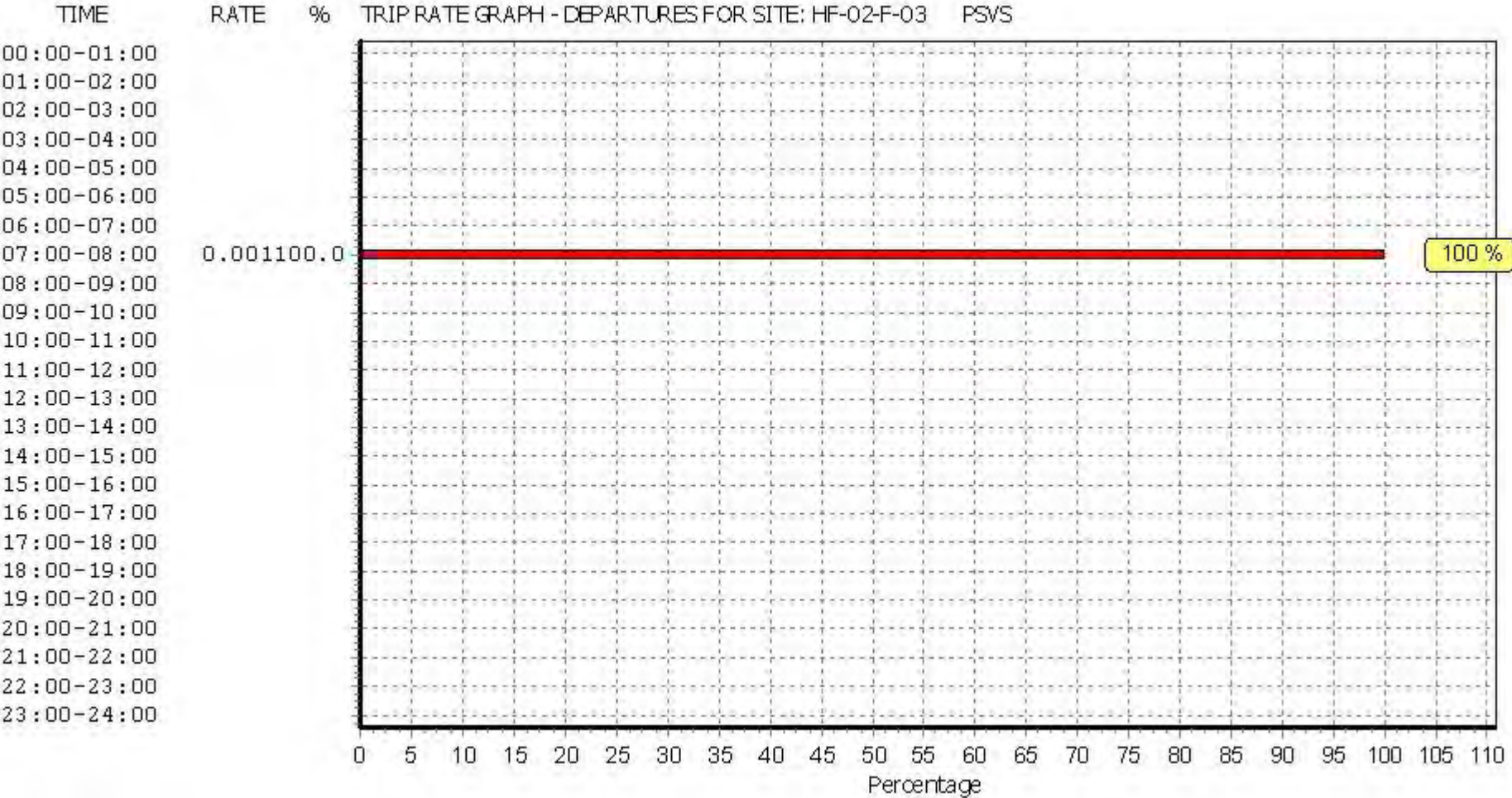

This graph is a visual representation of the trip rate calculation results screen. The same time periods and trip rates are displayed, but in addition there is an additional column showing the percentage of the total trip rate by individual time period, allowing peak periods to be easily identified through observation. Note that the type of count and the selected direction is shown at the top of the graph.

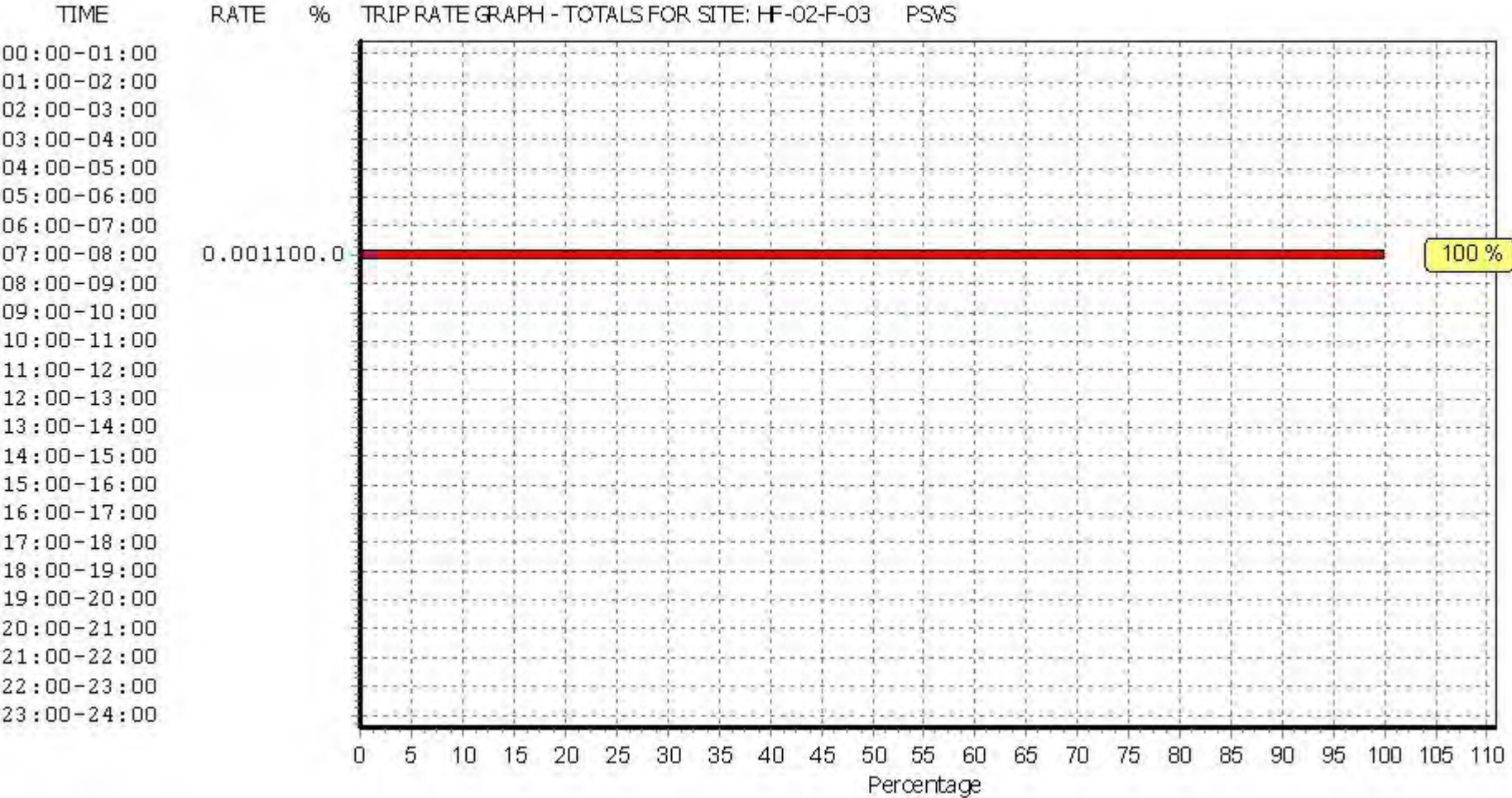

This graph is a visual representation of the trip rate calculation results screen. The same time periods and trip rates are displayed, but in addition there is an additional column showing the percentage of the total trip rate by individual time period, allowing peak periods to be easily identified through observation. Note that the type of count and the selected direction is shown at the top of the graph.

TRIP RATE for Land Use 02 - EMPLOYMENT/F - WAREHOUSING (COMMERCIAL)

CYCLISTS

Calculation factor: 100 sqm

BOLD print indicates peak (busiest) period

Time Range	ARRIVALS			DEPARTURES			TOTALS		
	No. Days	Ave. GFA	Trip Rate	No. Days	Ave. GFA	Trip Rate	No. Days	Ave. GFA	Trip Rate
00:00 - 01:00									
01:00 - 02:00									
02:00 - 03:00									
03:00 - 04:00									
04:00 - 05:00									
05:00 - 06:00									
06:00 - 07:00									
07:00 - 08:00	4	31721	0.006	4	31721	0.001	4	31721	0.007
08:00 - 09:00	4	31721	0.004	4	31721	0.001	4	31721	0.005
09:00 - 10:00	4	31721	0.002	4	31721	0.000	4	31721	0.002
10:00 - 11:00	4	31721	0.001	4	31721	0.002	4	31721	0.003
11:00 - 12:00	4	31721	0.001	4	31721	0.003	4	31721	0.004
12:00 - 13:00	4	31721	0.002	4	31721	0.003	4	31721	0.005
13:00 - 14:00	4	31721	0.006	4	31721	0.008	4	31721	0.014
14:00 - 15:00	4	31721	0.002	4	31721	0.011	4	31721	0.013
15:00 - 16:00	4	31721	0.006	4	31721	0.005	4	31721	0.011
16:00 - 17:00	4	31721	0.000	4	31721	0.005	4	31721	0.005
17:00 - 18:00	4	31721	0.001	4	31721	0.007	4	31721	0.008
18:00 - 19:00	4	31721	0.002	4	31721	0.005	4	31721	0.007
19:00 - 20:00									
20:00 - 21:00									
21:00 - 22:00									
22:00 - 23:00									
23:00 - 24:00									
Total Rates:	0.033			0.051			0.084		

This section displays the trip rate results based on the selected set of surveys and the selected count type (shown just above the table). It is split by three main columns, representing arrivals trips, departures trips, and total trips (arrivals plus departures). Within each of these main columns are three sub-columns. These display the number of survey days where count data is included (per time period), the average value of the selected trip rate calculation parameter (per time period), and the trip rate result (per time period). Total trip rates (the sum of the column) are also displayed at the foot of the table.

To obtain a trip rate, the average (mean) trip rate parameter value (TRP) is first calculated for all selected survey days that have count data available for the stated time period. The average (mean) number of arrivals, departures or totals (whichever applies) is also calculated (COUNT) for all selected survey days that have count data available for the stated time period. Then, the average count is divided by the average trip rate parameter value, and multiplied by the stated calculation factor (shown just above the table and abbreviated here as FACT). So, the method is: $COUNT/TRP*FACT$. Trip rates are then rounded to 3 decimal places.



This graph is a visual representation of the trip rate calculation results screen. The same time periods and trip rates are displayed, but in addition there is an additional column showing the percentage of the total trip rate by individual time period, allowing peak periods to be easily identified through observation. Note that the type of count and the selected direction is shown at the top of the graph.

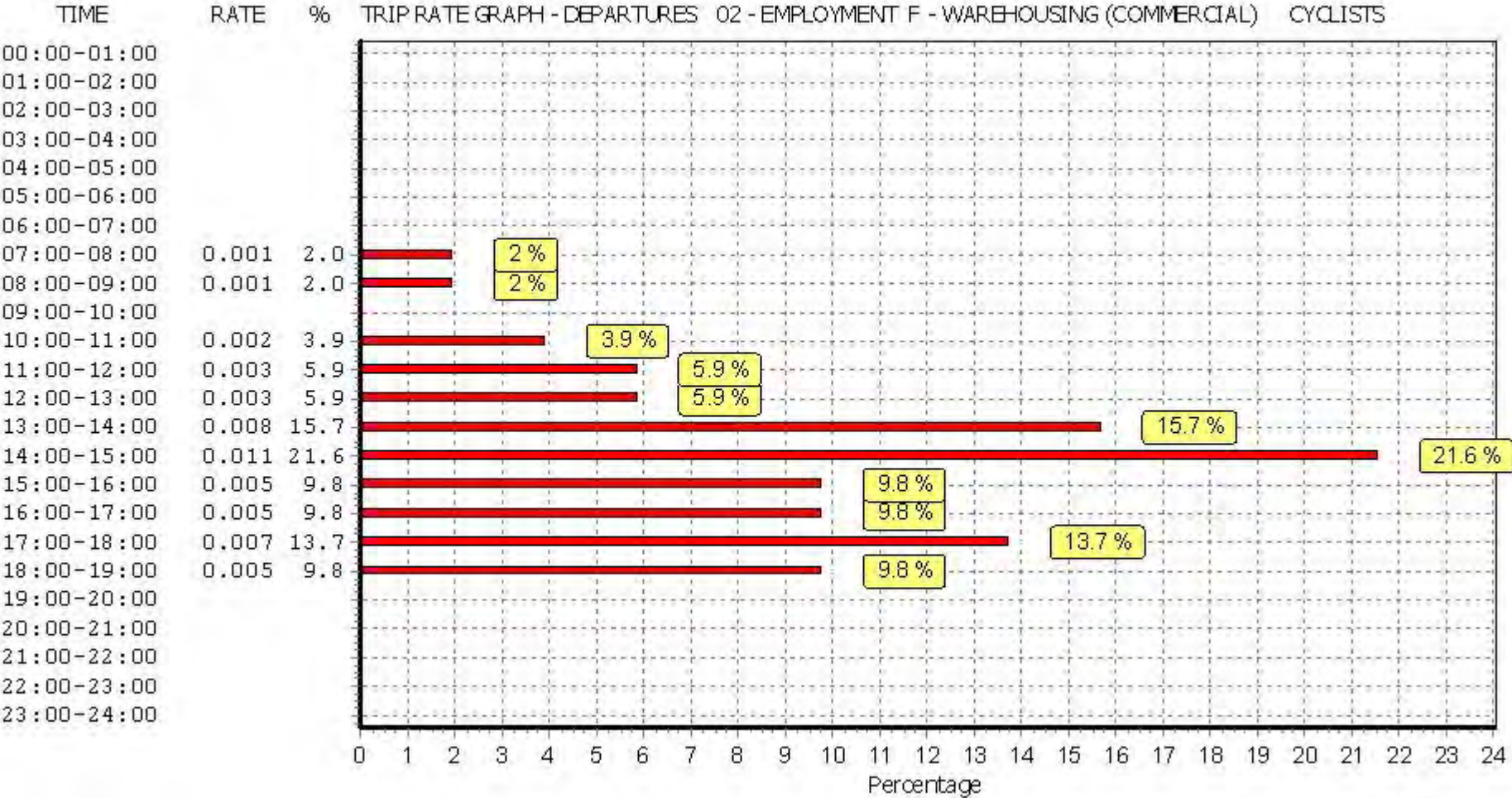

This graph is a visual representation of the trip rate calculation results screen. The same time periods and trip rates are displayed, but in addition there is an additional column showing the percentage of the total trip rate by individual time period, allowing peak periods to be easily identified through observation. Note that the type of count and the selected direction is shown at the top of the graph.

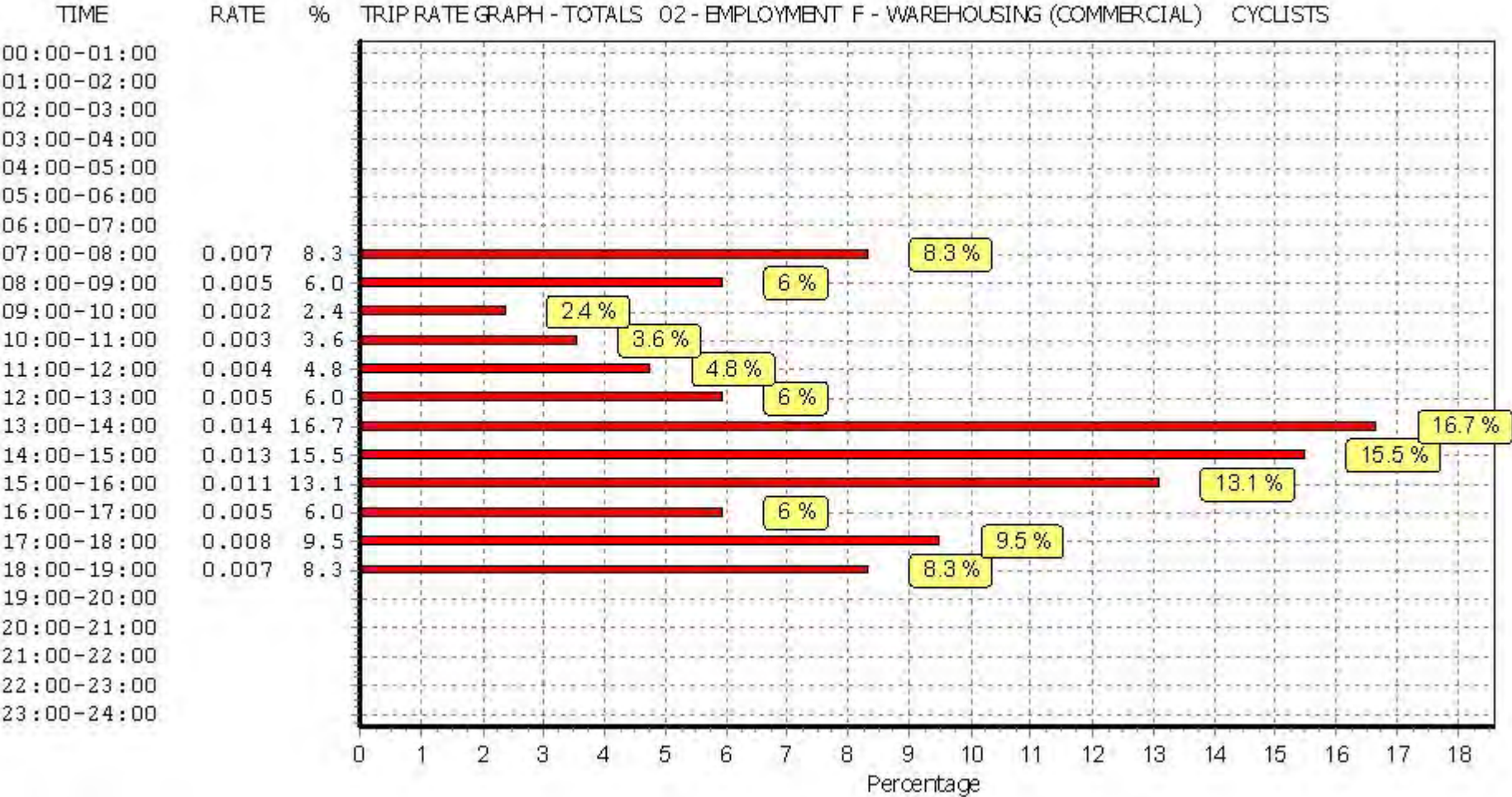

This graph is a visual representation of the trip rate calculation results screen. The same time periods and trip rates are displayed, but in addition there is an additional column showing the percentage of the total trip rate by individual time period, allowing peak periods to be easily identified through observation. Note that the type of count and the selected direction is shown at the top of the graph.

Appendix F – 2011 Census Journey to Work Data

WP703EW - Method of travel to work (2001 specification) (Workplace population)

ONS Crown Copyright Reserved [from Nomis on 15 February 2019]

population	All usual residents aged 16 to 74 in employment in the area the week before the census
units	Persons
area type	2011 super output areas - middle layer
area name	W02000250 : The Vale of Glamorgan 014

Method of travel to work	2011
All categories: Method of travel	5,648
Work mainly at or from home	529
Underground, metro, light rail o	1
Train	62
Bus, minibus or coach	91
Taxi	16
Motorcycle, scooter or moped	59
Driving a car or van	3,629
Passenger in a car or van	255
Bicycle	198
On foot	736
Other method of travel to work	72

In order to protect against disclosure of personal information, records have been swapped between different geographic areas. Some counts will be affected, particularly small counts at the lowest geographies.

Appendix G – 12-Hour Vehicle Trip Rates and Vehicle Trip Profiles

B1 12-Hour Initial and Proposed Vehicle Trip Rates and Vehicle Trips

Time	Initial						Proposed					
	Arrivals		Departures		Two-way		Arrivals		Departures		Two-way	
	Trip Rate	Trips	Trip Rate	Trips	Trip Rate	Trips	Trip Rate	Trips	Trip Rate	Trips	Trip Rate	Trips
07:00 – 08:00	0.595	452	0.089	68	0.684	519	0.483	366	0.072	55	0.555	421
08:00 – 09:00	1.313	996	0.217	165	1.530	1,161	1.065	808	0.176	134	1.241	942
09:00 – 10:00	0.718	545	0.258	196	0.976	741	0.582	442	0.209	159	0.792	601
10:00 – 11:00	0.276	209	0.208	158	0.484	367	0.224	170	0.169	128	0.393	298
11:00 – 12:00	0.221	168	0.236	179	0.457	347	0.179	136	0.191	145	0.371	281
12:00 – 13:00	0.327	248	0.429	326	0.756	574	0.265	201	0.348	264	0.613	465
13:00 – 14:00	0.400	304	0.354	269	0.754	572	0.324	246	0.287	218	0.611	464
14:00 – 15:00	0.248	188	0.288	219	0.536	407	0.201	153	0.234	177	0.435	330
15:00 – 16:00	0.195	148	0.405	307	0.600	455	0.158	120	0.328	249	0.487	369
16:00 – 17:00	0.175	133	0.861	653	1.036	786	0.142	108	0.698	530	0.840	638
17:00 – 18:00	0.156	118	0.995	755	1.151	873	0.127	96	0.807	612	0.933	708
18:00 – 19:00	0.073	55	0.358	272	0.431	327	0.059	45	0.290	220	0.350	265
07:00 – 19:00	4.697	3,565	4.698	3,565	9.395	7,130	3.809	2,891	3.810	2,891	7.619	5,782

B2 12-Hour Initial and Proposed Vehicle Trip Rates and Vehicle Trips

Time	Initial						Proposed					
	Arrivals		Departures		Two-way		Arrivals		Departures		Two-way	
	Trip Rate	Trips	Trip Rate	Trips	Trip Rate	Trips	Trip Rate	Trips	Trip Rate	Trips	Trip Rate	Trips
07:00 – 08:00	0.253	96	0.099	38	0.352	134	0.205	78	0.080	30	0.285	108
08:00 – 09:00	0.276	105	0.118	45	0.394	150	0.224	85	0.096	36	0.320	121
09:00 – 10:00	0.131	50	0.106	40	0.237	90	0.106	40	0.086	33	0.192	73
10:00 – 11:00	0.118	45	0.112	42	0.230	87	0.096	36	0.091	34	0.187	71
11:00 – 12:00	0.124	47	0.125	47	0.249	94	0.101	38	0.101	38	0.202	77
12:00 – 13:00	0.116	44	0.127	48	0.243	92	0.094	36	0.103	39	0.197	75
13:00 – 14:00	0.160	61	0.126	48	0.286	109	0.130	49	0.102	39	0.232	88
14:00 – 15:00	0.107	41	0.144	55	0.251	95	0.087	33	0.117	44	0.204	77
15:00 – 16:00	0.111	42	0.167	63	0.278	105	0.090	34	0.135	51	0.225	86
16:00 – 17:00	0.188	71	0.245	93	0.433	164	0.152	58	0.199	75	0.351	133
17:00 – 18:00	0.053	20	0.325	123	0.378	143	0.043	16	0.264	100	0.307	116
18:00 – 19:00	0.058	22	0.107	41	0.165	63	0.047	18	0.087	33	0.134	51
07:00 – 19:00	1.695	643	1.801	683	3.496	1,327	1.375	522	1.461	554	2.835	1,076

B8 12-Hour Initial and Proposed Vehicle Trip Rates and Vehicle Trips

Time	Initial						Proposed					
	Arrivals		Departures		Two-way		Arrivals		Departures		Two-way	
	Trip Rate	Trips	Trip Rate	Trips	Trip Rate	Trips	Trip Rate	Trips	Trip Rate	Trips	Trip Rate	Trips
07:00 – 08:00	0.11	83	0.080	61	0.190	144	0.089	68	0.065	49	0.154	117
08:00 – 09:00	0.091	69	0.048	36	0.139	105	0.074	56	0.039	30	0.113	86
09:00 – 10:00	0.084	64	0.066	50	0.150	114	0.068	52	0.054	41	0.122	92
10:00 – 11:00	0.065	49	0.065	49	0.130	99	0.053	40	0.053	40	0.105	80
11:00 – 12:00	0.064	49	0.069	52	0.133	101	0.052	39	0.056	42	0.108	82
12:00 – 13:00	0.068	52	0.074	56	0.142	108	0.055	42	0.060	46	0.115	87
13:00 – 14:00	0.095	72	0.085	65	0.180	137	0.077	58	0.069	52	0.146	111
14:00 – 15:00	0.106	80	0.126	96	0.232	176	0.086	65	0.102	78	0.188	143
15:00 – 16:00	0.106	80	0.128	97	0.234	178	0.086	65	0.104	79	0.190	144
16:00 – 17:00	0.080	61	0.125	95	0.205	156	0.065	49	0.101	77	0.166	126
17:00 – 18:00	0.024	18	0.086	65	0.110	83	0.019	15	0.070	53	0.089	68
18:00 – 19:00	0.013	10	0.054	41	0.067	51	0.011	8	0.044	33	0.054	41
07:00 – 19:00	0.906	688	1.006	763	1.912	1,451	0.735	558	0.816	619	1.551	1,177

B1, B2, B8 Total 12-Hour Initial and Proposed Vehicle Trips

Time	Initial						Proposed					
	Arrivals		Departures		Two-way		Arrivals		Departures		Two-way	
	Trip Rate	Trips	Trip Rate	Trips	Trip Rate	Trips	Trip Rate	Trips	Trip Rate	Trips	Trip Rate	Trips
07:00 – 08:00		631		166		797		512		134		646
08:00 – 09:00		1,170		246		1,416		949		199		1,148
09:00 – 10:00		658		286		944		534		232		766
10:00 – 11:00		304		250		553		246		202		449
11:00 – 12:00		263		279		542		214		226		440
12:00 – 13:00		344		430		774		279		349		627
13:00 – 14:00		436		381		817		354		309		663
14:00 – 15:00		309		369		678		251		299		550
15:00 – 16:00		271		468		738		219		379		599
16:00 – 17:00		265		841		1,106		215		682		897
17:00 – 18:00		157		944		1,100		127		765		892
18:00 – 19:00		87		353		441		71		287		357
07:00 – 19:00		4,895		5,012		9,907		3,970		4,065		8,035

Contact

RPS Consulting Services Ltd
260 Park Avenue
Aztec West
Almondsbury
Bristol BS32 4SY
T: +44(0) 1454 853 000
transport@rpsgroup.com

Appendix E – Rhoose & Barry Existing Active Travel Route Maps

Rhoose Pedestrian

Produced by the Active Travel web site. Gynhyrchwyd gan y wefan Teithio Llesol.

Vale of Glamorgan Council
Civic Offices
Holton Road
Barry, CF63 4RU



Legend / Eglurhad

Active Travel Routes / Llwybrau Teithio Llesol

Undefined path design / Dyluniad llwybr heb ei ddiffinio

Footpath (away from road) / Llwybr troed (i ffwrdd o'r ffordd)

Footway (alongside road) / Troedffordd (ochr yn ochr â ffordd)

Cycle track (away from road) / Trac beicio (i ffwrdd o'r ffordd)

Cycle track (alongside road) / Trac beicio (ochr yn ochr â ffordd)

Shared use foot/cycle path (away from road) / Llwybr cerdded/beicio a rennir (i ffwrdd o'r ffordd)

Shared use foot/cycle path (alongside road) / Llwybr cerdded/beicio a rennir (ochr yn ochr â ffordd)

Segregated foot/cycle path (away from road) / Llwybr cerdded/beicio wedi'i wahanu (i ffwrdd o'r ffordd)

Segregated foot/cycle path (alongside road) / Llwybr cerdded/beicio wedi'i wahanu (ochr yn ochr â ffordd)

Cycle route (on road, not segregated) / Lôn feicio (ar y ffordd, heb ei gwahanu)

Cycle lane (on road, segregated) / Lôn feicio (ar y ffordd, wedi'i gwahanu)

Pedestrian zone / Ardal cerdded

Pedestrian and cycle zone / Ardal cerdded a beicio

Road without footway / Ffordd heb droedffordd

Statement / Datganiad

Line end points / Pwyntiau diwedd llinell

Integrated Network / Rhwydwaith Integredig

© Crown Copyright and database right 2014. Ordnance Survey 100021874. Welsh Government. © Hawlfraint a hawliau cronfa ddata'r Goron 2014. Rhif Trwydded yr Arolwg Ordnans 100021874. Whilst the Welsh Government have made every effort to ensure that the information on this website is accurate and up-to-date, the Welsh Government takes no responsibility for any incorrect information. The data is compiled from Public Rights of Way, Ordnance Survey ITN, Ordnance Survey ITN Urban Path and aerial photography derived data supplemented by field survey. The online map is provided for guidance only and is not a legal record. Er bod Llywodraeth Cymru wedi gwneud pob ymdrech i sicrhau bod y wybodaeth ar y wefan hon yn gywir ac yn gyfredol, mae Llywodraeth Cymru yn cymryd unrhyw gyfrifoldeb am unrhyw wybodaeth anghywir. Lluniwyd y data o hawliau tramwy cyhoeddus, RhTI yr AO, Llwybrau Trefol RhTI yr AO a data sy'n deillio o ffotograffau o'r awyr wedi'i ategu gan arolwg maes. Yn y map ar-lein yn darparu canllaw yn unig ac nid yw cofnod cyfreithiol.

19 Jan 2016 12:32 PM

Rhoose Cycle

Produced by the Active Travel web site. Gynhyrchwyd gan y wefan Teithio Llesol.

Vale of Glamorgan Council
Civic Offices
Holton Road
Barry, CF63 4RU



Legend / Eglurhad

Active Travel Routes / Llwybrau Teithio Llesol

- Undefined path design / Dyluniad llwybr heb ei ddiffinio
- Footpath (away from road) / Llwybr troed (i ffwrdd o'r ffordd)
- Footway (alongside road) / Troedffordd (ochr yn ochr â ffordd)
- Cycle track (away from road) / Trac beicio (i ffwrdd o'r ffordd)
- Cycle track (alongside road) / Trac beicio (ochr yn ochr â ffordd)
- Shared use foot/cycle path (away from road) / Llwybr cerdded/beicio a rennir (i ffwrdd o'r ffordd)
- Shared use foot/cycle path (alongside road) / Llwybr cerdded/beicio a rennir (ochr yn ochr â ffordd)
- Segregated foot/cycle path (away from road) / Llwybr cerdded/beicio wedi'i wahanu (i ffwrdd o'r ffordd)
- Segregated foot/cycle path (alongside road) / Llwybr cerdded/beicio wedi'i wahanu (ochr yn ochr â ffordd)
- Cycle route (on road, not segregated) / Lôn feicio (ar y ffordd, heb ei gwahanu)
- Cycle lane (on road, segregated) / Lôn feicio (ar y ffordd, wedi'i gwahanu)
- Pedestrian zone / Ardal cerdded
- Pedestrian and cycle zone / Ardal cerdded a beicio
- Road without footway / Ffordd heb droedffordd
- Statement / Datganiad

Line end points / Pwyntiau diwedd llinell

Integrated Network / Rhwydwaith Integredig



© Crown Copyright and database right 2014. Ordnance Survey 100021874. Welsh Government. © Hawlfraint a hawliau cronfa ddata'r Goron 2014. Rhif Trwydded yr Arolwg Ordnans 100021874. Whilst the Welsh Government have made every effort to ensure that the information on this website is accurate and up-to-date, the Welsh Government takes no responsibility for any incorrect information. The data is compiled from Public Rights of Way, Ordnance Survey ITN, Ordnance Survey ITN Urban Path and aerial photography derived data supplemented by field survey. The online map is provided for guidance only and is not a legal record. Er bod Llywodraeth Cymru wedi gwneud pob ymdrech i sicrhau bod y wybodaeth ar y wefan hon yn gywir ac yn gyfredol, mae Llywodraeth Cymru yn cymryd unrhyw gyfrifoldeb am unrhyw wybodaeth anghywir. Lluniwyd y data o hawliau tramwy cyhoeddus, RhTI yr AO, Llwybrau Trefol RhTI yr AO a data sy'n deillio o ffotograffau o'r awyr wedi'i ategu gan arolwg maes. Yn y map ar-lein yn darparu canllaw yn unig ac nid yw cofnod cyfreithiol.



Barry Pedestrian

Produced by the Active Travel web site. Gynhyrchwyd gan y wefan Teithio Llesol.

Vale of Glamorgan Council
Civic Offices
Holton Road
Barry, CF63 4RU

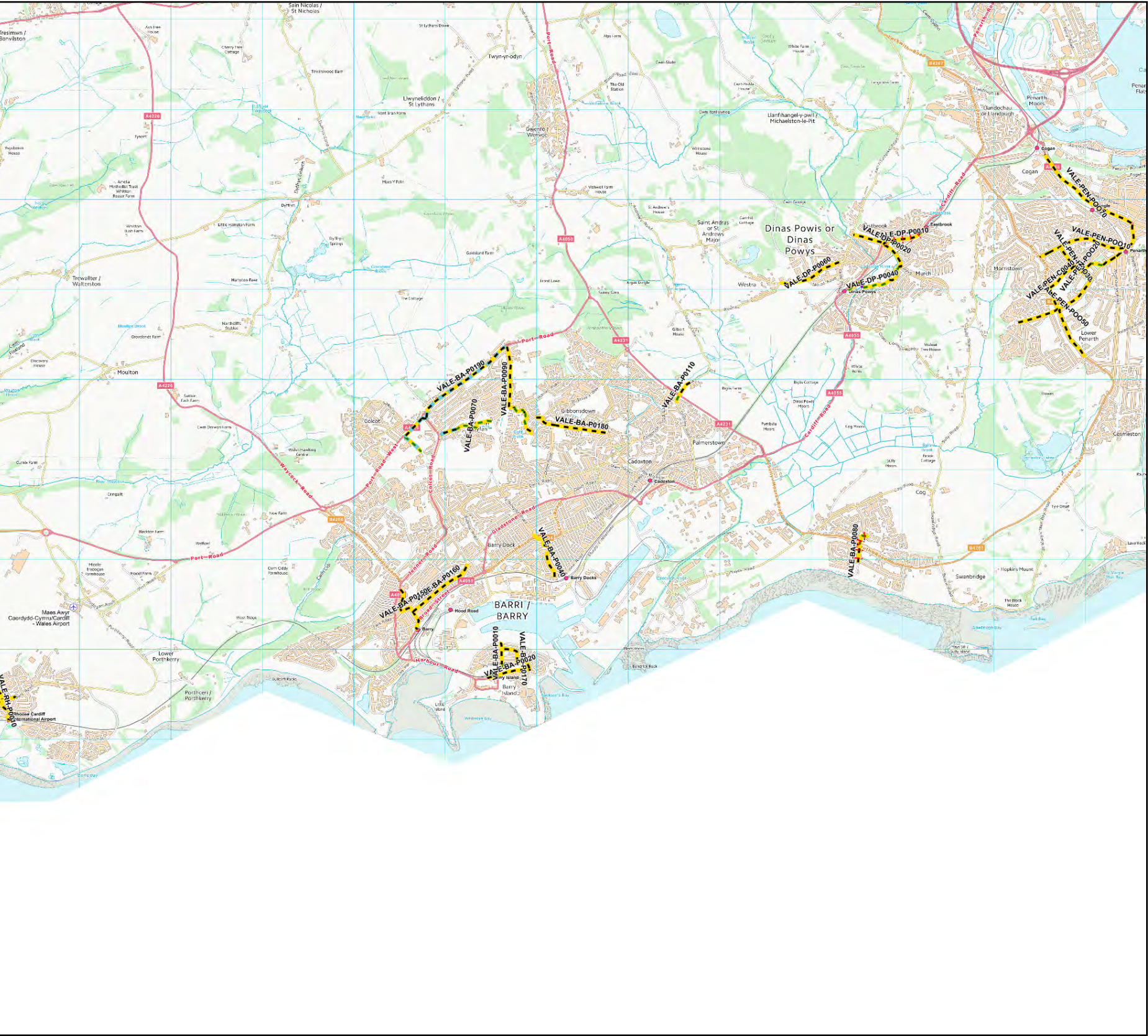

Legend / Eglurhad

Active Travel Routes / Llwybrau Teithio Llesol

- Undefined path design / Dyluniad llwybr heb ei ddiffinio
- Footpath (away from road) / Llwybr troed (i ffordd o'r ffordd)
- Footway (alongside road) / Troedffordd (ochr yn ochr â ffordd)
- Cycle track (away from road) / Trac beicio (i ffordd o'r ffordd)
- Cycle track (alongside road) / Trac beicio (ochr yn ochr â ffordd)
- Shared use foot/cycle path (away from road) / Llwybr cerdded/beicio a rennir (i ffordd o'r ffordd)
- Shared use foot/cycle path (alongside road) / Llwybr cerdded/beicio a rennir (ochr yn ochr â ffordd)
- Segregated foot/cycle path (away from road) / Llwybr cerdded/beicio wedi'i wahanu (i ffordd o'r ffordd)
- Segregated foot/cycle path (alongside road) / Llwybr cerdded/beicio wedi'i wahanu (ochr yn ochr â ffordd)
- Cycle route (on road, not segregated) / Lôn feicio (ar y ffordd, heb ei gwahanu)
- Cycle lane (on road, segregated) / Lôn feicio (ar y ffordd, wedi'i gwahanu)
- Pedestrian zone / Ardal cerdded
- Pedestrian and cycle zone / Ardal cerdded a beicio
- Road without footway / Ffordd heb droedffordd
- Statement / Datganiad

- Line end points / Pwyntiau diwedd llinell
- Integrated Network / Rhwydwaith Integredig



© Crown Copyright and database right 2014. Ordnance Survey 100021874. Welsh Government. © Hawlfraint a hawliau cronfa ddata'r Goron 2014. Rhif Trwydded yr Arolwg Ordnans 100021874. Whilst the Welsh Government have made every effort to ensure that the information on this website is accurate and up-to-date, the Welsh Government takes no responsibility for any incorrect information. The data is compiled from Public Rights of Way, Ordnance Survey ITN, Ordnance Survey ITN Urban Path and aerial photography derived data supplemented by field survey. The online map is provided for guidance only and is not a legal record. Er bod Llywodraeth Cymru wedi gwneud pob ymdrech i sicrhau bod y wybodaeth ar y wefan hon yn gywir ac yn gyfredol, mae Llywodraeth Cymru yn cymryd unrhyw gyfrifoldeb am unrhyw wybodaeth anghywir. Lluniwyd y data o hawliau tramwy cyhoeddus, RhTI yr AO, Llwybrau Trefol RhTI yr AO a data sy'n deillio o ffotograffau o'r awyr wedi'i ategu gan arolwg maes. Yn y map ar-lein yn darparu canllaw yn unig ac nid yw cofnod cyfreithiol.



Barry Cycle

Produced by the Active Travel web site. Gynhyrchwyd gan y wefan Teithio Llesol.

Vale of Glamorgan Council
Civic Offices
Holton Road
Barry, CF63 4RU



Legend / Eglurhad

- Active Travel Routes / Llwybrau Teithio Llesol
- Undefined path design / Dyluniad llwybr heb ei ddiffinio
 - Footpath (away from road) / Llwybr troed (i ffwrdd o'r ffordd)
 - Footway (alongside road) / Troedffordd (ochr yn ochr â ffordd)
 - Cycle track (away from road) / Trac beicio (i ffwrdd o'r ffordd)
 - Cycle track (alongside road) / Trac beicio (ochr yn ochr â ffordd)
 - Shared use foot/cycle path (away from road) / Llwybr cerdded/beicio a rennir (i ffwrdd o'r ffordd)
 - Shared use foot/cycle path (alongside road) / Llwybr cerdded/beicio a rennir (ochr yn ochr â ffordd)
 - Segregated foot/cycle path (away from road) / Llwybr cerdded/beicio wedi'i wahanu (i ffwrdd o'r ffordd)
 - Segregated foot/cycle path (alongside road) / Llwybr cerdded/beicio wedi'i wahanu (ochr yn ochr â ffordd)
 - Cycle route (on road, not segregated) / Lôn feicio (ar y ffordd, heb ei gwahanu)
 - Cycle lane (on road, segregated) / Lôn feicio (ar y ffordd, wedi'i gwahanu)
 - Pedestrian zone / Ardal cerdded
 - Pedestrian and cycle zone / Ardal cerdded a beicio
 - Road without footway / Ffordd heb droedffordd
 - Statement / Datganiad
- Line end points / Pwyntiau diwedd llinell
- Integrated Network / Rhwydwaith Integredig



© Crown Copyright and database right 2014. Ordnance Survey 100021874. Welsh Government. © Hawlfraint a hawliau cronfa ddata'r Goron 2014. Rhif Trwydded yr Arolwg Ordnans 100021874. Whilst the Welsh Government have made every effort to ensure that the information on this website is accurate and up-to-date, the Welsh Government takes no responsibility for any incorrect information. The data is compiled from Public Rights of Way, Ordnance Survey ITN, Ordnance Survey ITN Urban Path and aerial photography derived data supplemented by field survey. The online map is provided for guidance only and is not a legal record. Er bod Llywodraeth Cymru wedi gwneud pob ymdrech i sicrhau bod y wybodaeth ar y wefan hon yn gywir ac yn gyfredol, mae Llywodraeth Cymru yn cymryd unrhyw gyfrifoldeb am unrhyw wybodaeth anghywir. Lluniwyd y data o hawliau tramwy cyhoeddus, RhTI yr AO, Llwybrau Trefol RhTI yr AO a data sy'n deillio o ffotograffau o'r awyr wedi'i ategu gan arolwg maes. Yn y map ar-lein yn darparu canllaw yn unig ac nid yw cofnod cyfreithiol.



Appendix F – Adopted Highway within Site Vicinity



Appendix G – Waycock Cross Improvements

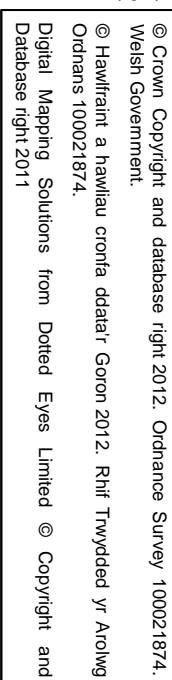

- ## NOTES

Rev	Date	Description	By	Ck	App
FOR ISSUE					
PARSONS BRINCKERHOFF					
5100 Central Road Cedar Rapids, IA 52402 CFI 1-800-440-2444			Tel: 44-003-2082-7000 Fax: 44-003-2082-7001		
Client: VALE OF GLAMORGAN					
Sub-project: FIVE MILE LANE IMPROVEMENTS					
Title: WAYCOCK CROSS IMPROVEMENTS					
Drawn: IM			Checked: CN		
Design: LEP			Approved: JC		
Date: 23/03/2015	Scale:	1:500	A1	Sheet:	1 OF 1
Project Number:		Drawing Number:		Revision:	
3512646D-HHC		Figure 9		-	
© Copyright Parsons Brinckerhoff					

Appendix H – Sycamore Cross Proposed Junction Improvements

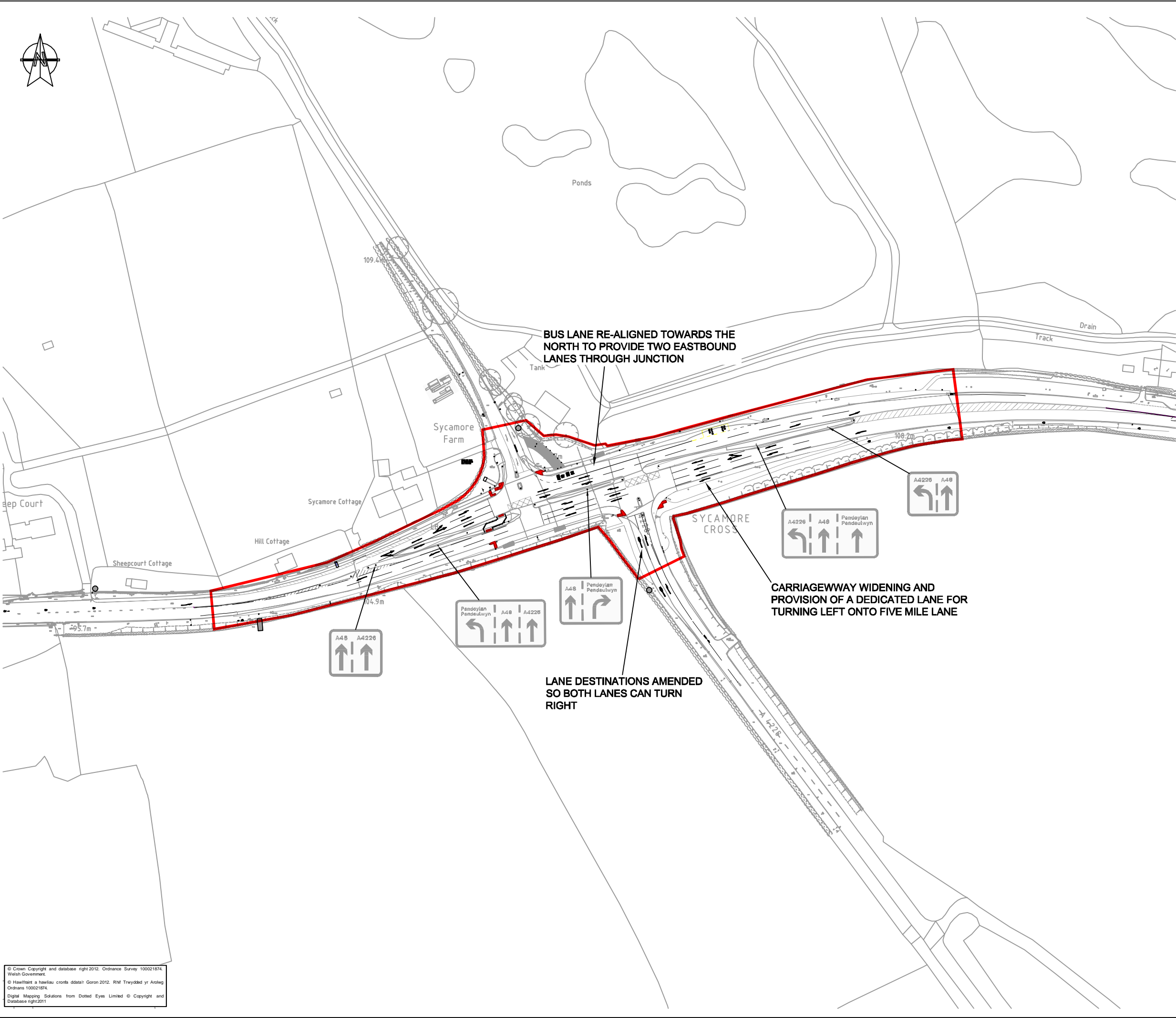

© Crown Copyright and database right 2012. Ordnance Survey 100021874.
Welsh Government.
© Hawffrant a hawllau cronta ddata y Goron 2012. Rhif Trwydded yr Arolwg
Ordnans 100021874.
Digital Mapping Solutions from Dotted Eyes Limited © Copyright and
Database right 2011

KEY

RED LINE BOUNDARY

Rev	Date	Description	By	Chk	App
-----	------	-------------	----	-----	-----

**PARSONS
BRINCKERHOFF**

Kings Orchard
1 Queen Street
Bristol BS2 0HQ

Tel: 44-(0)1179-306200

Client:

VALE of GLAMORGAN
BRD MORGANNWG

Site/Project:

FIVE MILE LANE
IMPROVEMENTS

Title:

SYCAMORE CROSS
JUNCTION WORKS

Drawn: CEW		Checked:	
Designed: JM		Approved:	
Date: 27/11/2015	Scale: 1:2000	A3	Sheet:
Project Number:	Drawing Number:	Revision:	
3512646D	FIGURE 7	-	
© Copyright Parsons Brinckerhoff			

Appendix I – PIA Data Analysis Search Areas

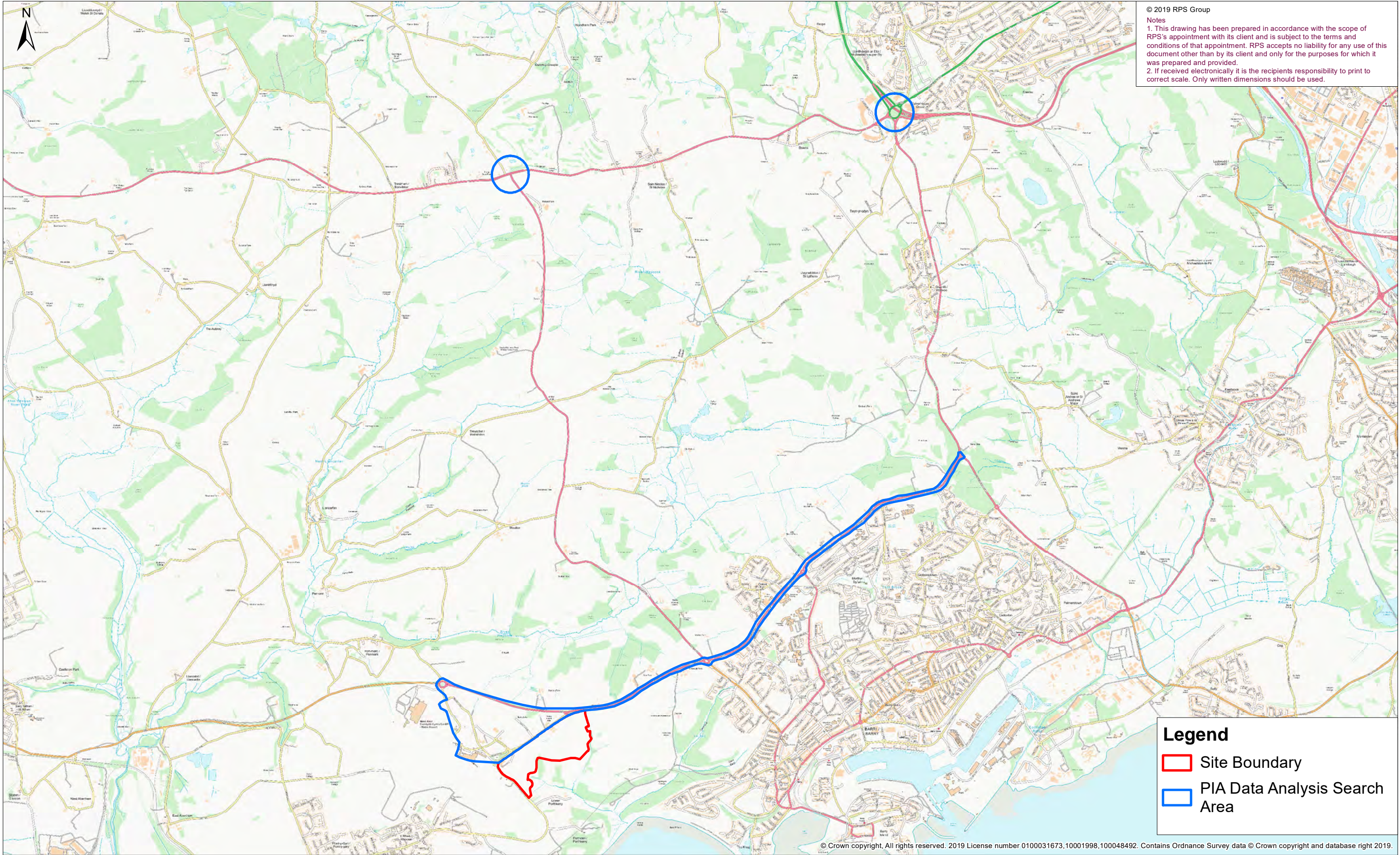

Appendix J – Preliminary Northern Access Concept

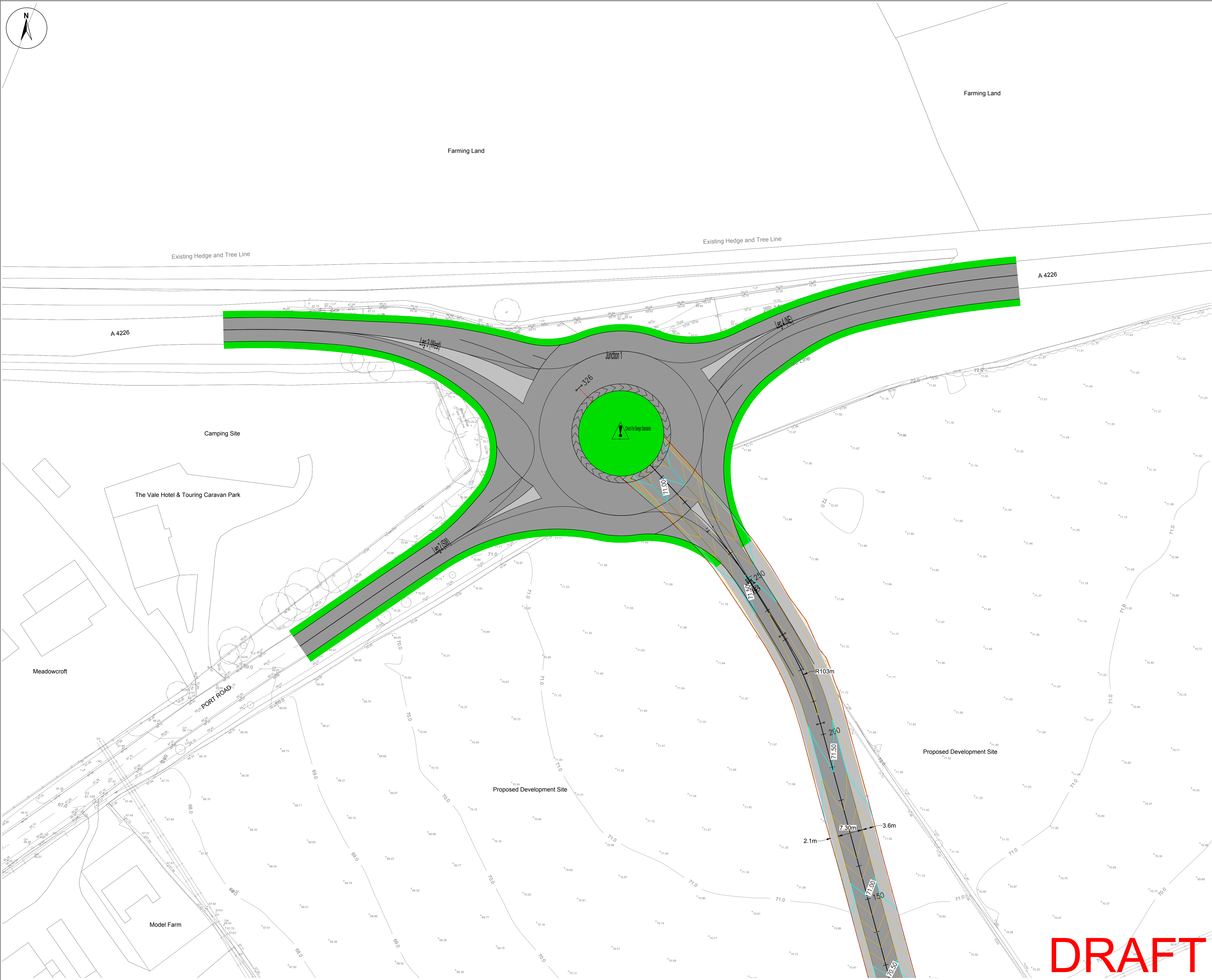
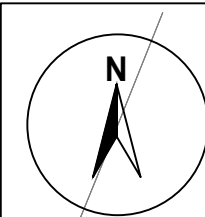

- © 2019 RPS Group
- NOTES
1. This drawing has been prepared in accordance with the scope of RPS's appointment with its client and is subject to the terms and conditions of that appointment. RPS accepts no liability for any use of this document other than by its client and only for the purposes for which it was prepared and provided.
 2. If received electronically it is the recipients responsibility to print to correct scale. Only written dimensions should be used.
 3. This drawing is to be read in conjunction with all relevant scheme drawings.
 4. Drawing based on topographical survey undertaken by RPS drawing number JKK9669-03-06.

KEY

Proposed Carriageway

Proposed Footway

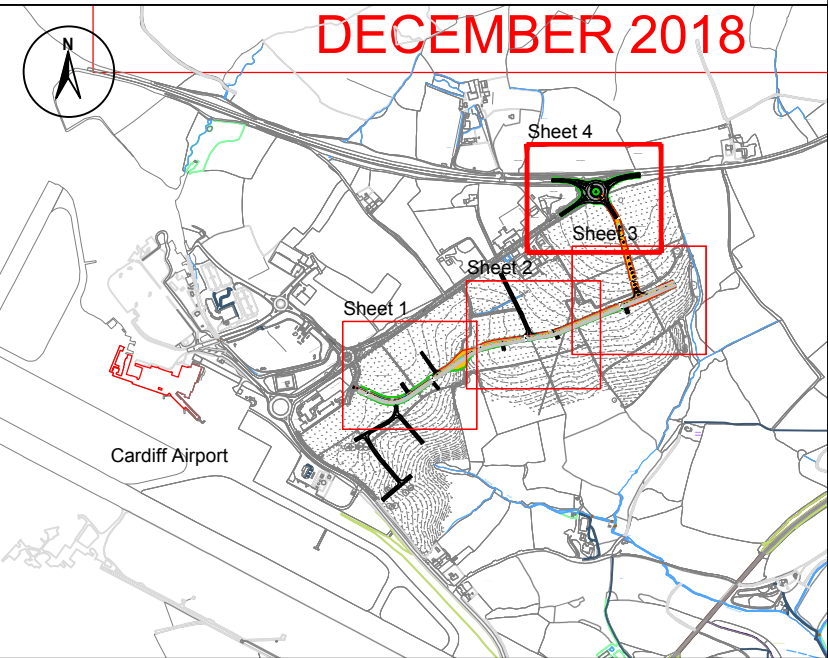

PRELIMINARY
NOT FOR
CONSTRUCTION

Rev	Description	By	CB	Date
-----	-------------	----	----	------



20 Milton Park, Abingdon, Oxfordshire, OX14 4SH
T: +44(0)1235 432 190 E: transport@rpsgroup.com

Client Legal & General (Strategic Land) Ltd

Project Model Farm, Rhoose

Title Preliminary Northern Site Access Concept

Status	Drawn By	PM/Checked by
INFORMATION	DH	MB

Project Number	Scale @ A1	Date Created
JNY9624	1:500	29/03/2019

RPS Drawing/Figure Number	Rev
JNY9624 - Appendix J	-

rpsgroup.com

DRAFT

Appendix K – Preliminary Southern Access Concept