

NOTES

- ALL DIMENSIONS SHOWN ARE IN METRES UNLESS OTHERWISE SPECIFIED
- ALL WORKS ARE TO BE CARRIED OUT IN ACCORDANCE WITH THE CONTRACT SPECIFICATION AND THE MANUAL OF CONTRACT DOCUMENTS FOR HIGHWAY WORKS (MCHW).
- DRAWING SHOULD BE READ IN CONJUNCTION WITH THE ACCOMODATION WORKS SERIES.
- ALL WORKING HOURS AND TRAFFIC MANAGEMENT MEASURES ARE TO BE AGREED WITH THE LOCAL HIGHWAY AUTHORITY AND DEPLOYED IN ACCORDANCE WITH CHAPTER 8 OF THE TRAFFIC SIGNS MANUAL.
- LOCATION OF SITE COMPOUND TO BE AGREED WITH THE LOCAL HIGHWAY AUTHORITY PRIOR TO WORKS COMMENCING. ALL MOVEMENT OF PLANT SHOULD BE IN ACCORDANCE WITH RECOGNISED GOOD INDUSTRY PRACTICE. BANKSMEN SHOULD BE PROVIDED WHEN REQUIRED.
- THE GENERAL PUBLIC SHOULD BE SEPARATED FROM THE WORKS WITH ADEQUATE LATERAL CLEARANCE AND APPROPRIATE SAFETY ZONES PROVIDED IN ACCORDANCE WITH CHAPTER 8 OF THE TRAFFIC SIGNS MANUAL.
- ACCESS TO PRIVATE PROPERTIES MUST BE MAINTAINED AT ALL TIMES UNLESS OTHERWISE AGREED WITH THE AFFECTED PARTY AND THE LOCAL HIGHWAY AUTHORITY.
- MEASURES SHOULD BE DEPLOYED TO ENSURE NOISE, VIBRATION AND DUST IS MINIMISED.
- ALL BURIED SERVICES ARE TO BE POSITIVELY LOCATED ON SITE PRIOR TO EXCAVATION. CAT SCANS SHALL BE COMPLETED PRIOR TO EXCAVATION WITH SERVICE LOCATIONS MARKED UP ON SITE. OPERATIVES SHALL EMPLOY HAND DIGGING METHODS WHEN WORKING IN CLOSE PROXIMITY TO BURIED SERVICES. STATUTORY UNDERTAKER'S PLANT SHALL BE PROTECTED AS NECESSARY. ADDITIONAL TRIAL PITS SHALL BE EXCAVATED AS REQUIRED.

KEY

- PLANNING APPLICATION BOUNDARY
- T4 ——— TIMBER POST AND 4 RAIL (REFER TO MCHW, VOLUME 3, SERIES H DRAWING H3)
- PD ——— SECURITY FENCING TYPE TO BE CONFIRMED ON RECEPTION OF ACCOMMODATION WORKS
- B+O4 ——— TIMBER POST AND 4 RAIL WITH BADGER AND OTTER MESH (REFER TO MCHW, VOLUME 3, SERIES H DRAWING H48 TYPE 8)
- T4 ——— TIMBER POST AND WIRE (REFER TO MCHW, VOLUME 3, SERIES H DRAWING H1 TYPE 2)
- EB1 ——— 3m HIGH STONE CLAD WALL (REFER TO DRAWING 60509148-SHT-30-0000-CT-0308 FOR DETAILS)
- EB2 ——— 2.5 m REFLECTIVE ENVIRONMENTAL BARRIER (REFER TO DRAWING *60509148-SHT-30-0001* FOR DETAILS)
- EB3 ——— 2.5 m ABSORPTIVE ENVIRONMENTAL BARRIER (REFER TO DRAWING *60509148-SHT-30-0001* FOR DETAILS)
- CHANGE OF FENCE TYPE
- STEEL SINGLE FIELD GATE, 3.6 m WIDE (REFER TO MCHW, VOLUME 3, SERIES H DRAWING H17)



PROJECT
ST. ATHAN NORTHERN ACCESS ROAD

CLIENT
 WELSH GOVERNMENT



Llywodraeth Cymru
Welsh Government

CONSULTANT
 AECOM
 1 CALLAGHAN SQUARE
 CARDIFF
 CF10 5BT
 TEL: (029) 20674600
 FAX: (029) 20674699

SAFETY, HEALTH AND ENVIRONMENTAL INFORMATION
 In addition to the hazards/risks normally associated with the types of work detailed on this drawing, note the following specific residual risks (Reference shall also be made to the design hazard log).
 Construction
 WORKING ON AND ADJACENT TO LIVE CARRIAGEWAY
 LIVESTOCK IN ADJACENT LAND
 DEEP CUTTING IN THIS AREA, STABILITY OF GROUND COULD BE AFFECTED

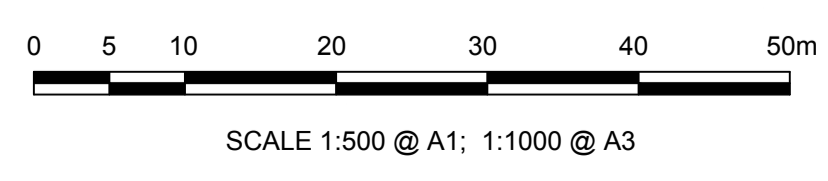
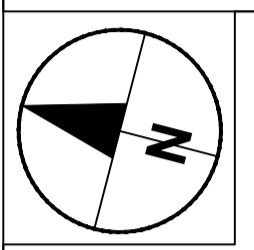
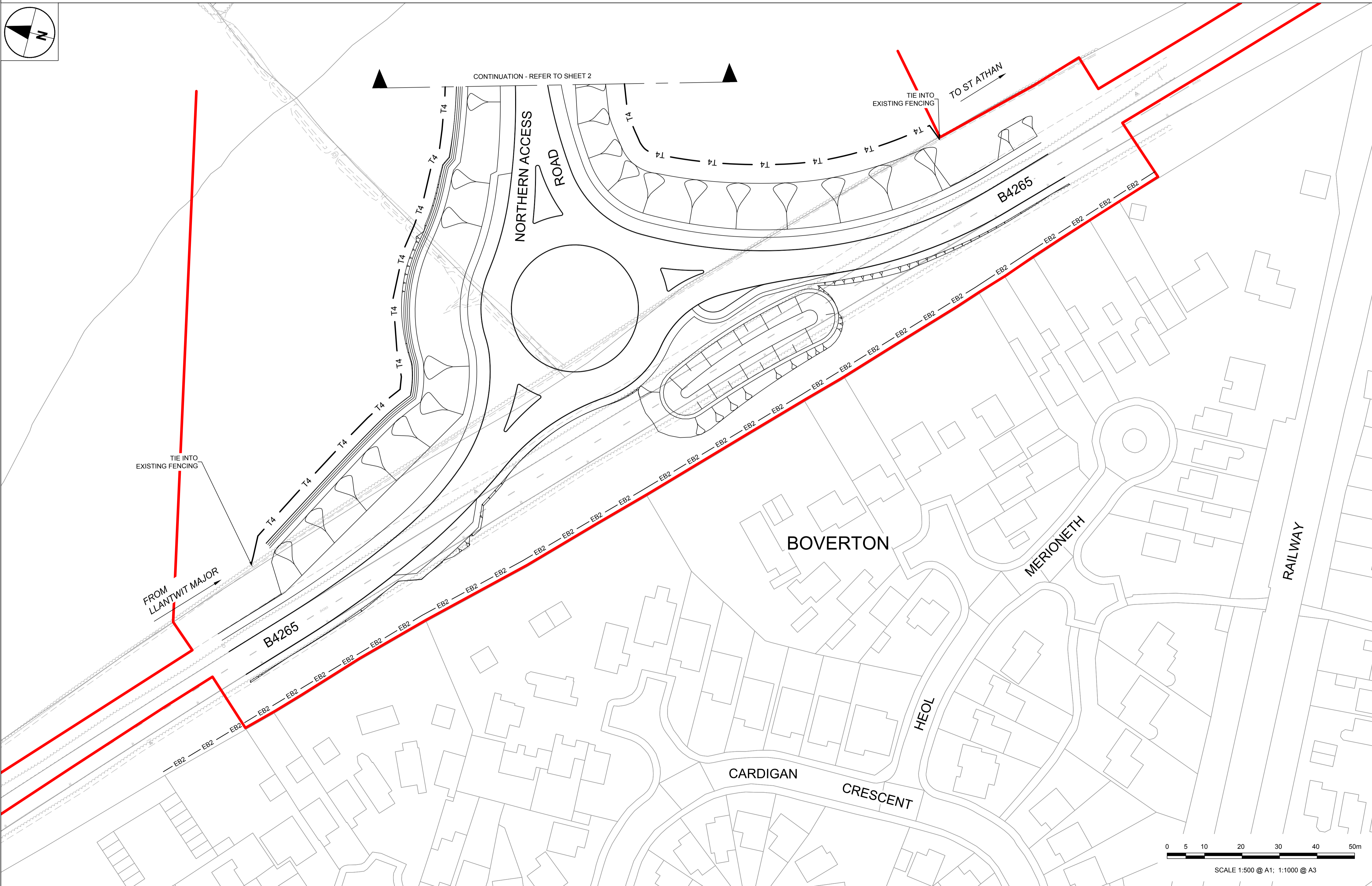

STATUS

ISSUE FOR TENDER

ISSUE/REVISION

IR	DATE	DESCRIPTION
C	14-07-17	ISSUE FOR TENDER
B	25-05-17	FENCE EXTENTS UPDATED
A	27-03-17	PLANNING SUBMISSION ISSUE

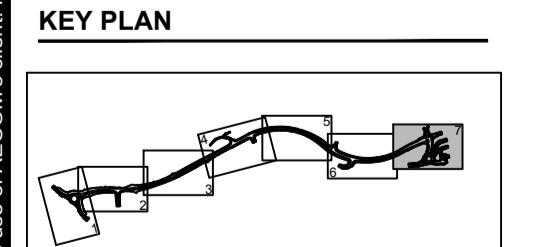

PROJECT NUMBER
 60509148

SHEET TITLE
 ST.ATHAN FENCING SHEET 1 OF 7

SHEET NUMBER
 60509148-SHT-30-0000-CT-0301

File name: P:\PROJECTS\HIGHWAYS - ST.ATHAN\2017 EXECUTION\03 DOCUMENTS\108 CAD\01 WORKING\DRAWINGS\0300 - FENCING\60509148-SHT-30-0000-CT-0301_0307.DWG Last saved by: SHORTEE Last Plot: 2017-07-17
 Project Management: AB Designer: AB Checked: TM Approved: RM
 ISO A1 84mm x 84mm

This drawing has been prepared for the use of AECOM's client. It may not be used, modified, reproduced or relied upon by third parties, except as agreed by AECOM or as required by law. AECOM accepts no responsibility, and denies any liability whatsoever, to any party that uses or relies on this drawing without AECOM's express written consent. Do not scale this document. All measurements must be obtained from the stated dimensions.