

- General**
- Specified Site
  - Specified Buffer(s)
  - Bearing Reference Point
  - Map ID
  - Several of Type at Location
  - Pylon
  - Overhead Transmission Line
- Agency and Hydrological**
- Contaminated Land Register Entry or Notice (Location)
  - Contaminated Land Register Entry or Notice
  - Discharge Consent
  - Enforcement or Prohibition Notice
  - Integrated Pollution Control
  - Integrated Pollution Prevention Control
  - Local Authority Integrated Pollution Prevention and Control
  - Local Authority Pollution Prevention and Control Enforcement
  - Pollution Incident to Controlled Waters
  - Prosecution Relating to Authorised Processes
  - Prosecution Relating to Controlled Waters
  - Registered Radioactive Substance
  - River Network or Water Feature
  - River Quality Sampling Point
  - Substantiated Pollution Incident Register
  - Water Abstraction
  - Water Industry Act Referral
- Waste**
- BGS Recorded Landfill Site (Location)
  - BGS Recorded Landfill Site
  - EA Historic Landfill (Buffered Point)
  - EA Historic Landfill (Polygon)
  - Integrated Pollution Control Registered Waste Site
  - Licensed Waste Management Facility (Landfill Boundary)
  - Licensed Waste Management Facility (Location)
  - Local Authority Recorded Landfill Site (Location)
  - Local Authority Recorded Landfill Site
  - Potentially Infilled Land (Non-water)
  - Potentially Infilled Land (Non-water)
  - Potentially Infilled Land (Water)
  - Potentially Infilled Land (Water)
  - Potentially Infilled Land (Water)
  - Registered Landfill Site
  - Registered Landfill Site (Location)
  - Registered Landfill Site (Point Buffered to 100m)
  - Registered Landfill Site (Point Buffered to 250m)
  - Registered Waste Transfer Site (Location)
  - Registered Waste Transfer Site
  - Registered Waste Treatment or Disposal Site (Location)
  - Registered Waste Treatment or Disposal Site
- Hazardous Substances**
- COMAH Site
  - Explosive Site
  - NIHHS Site
  - Planning Hazardous Substance Consent
  - Planning Hazardous Substance Enforcement
- Geological**
- BGS Recorded Mineral Site

### Site Sensitivity Map - Segment B5

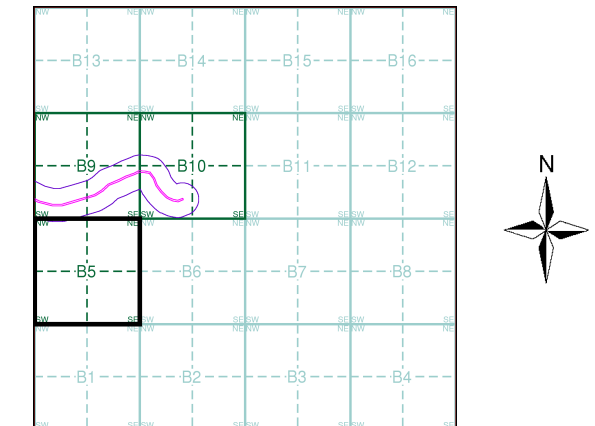

### Order Details

Order Number: 91812710\_1\_1  
 Customer Ref: 60509148  
 National Grid Reference: 300530, 169230  
 Slice: B  
 Site Area (Ha): 3.32  
 Plot Buffer (m): 100

### Site Details

St Athan Route, Cowbridge, South Glamorgan, CF71 7EQ

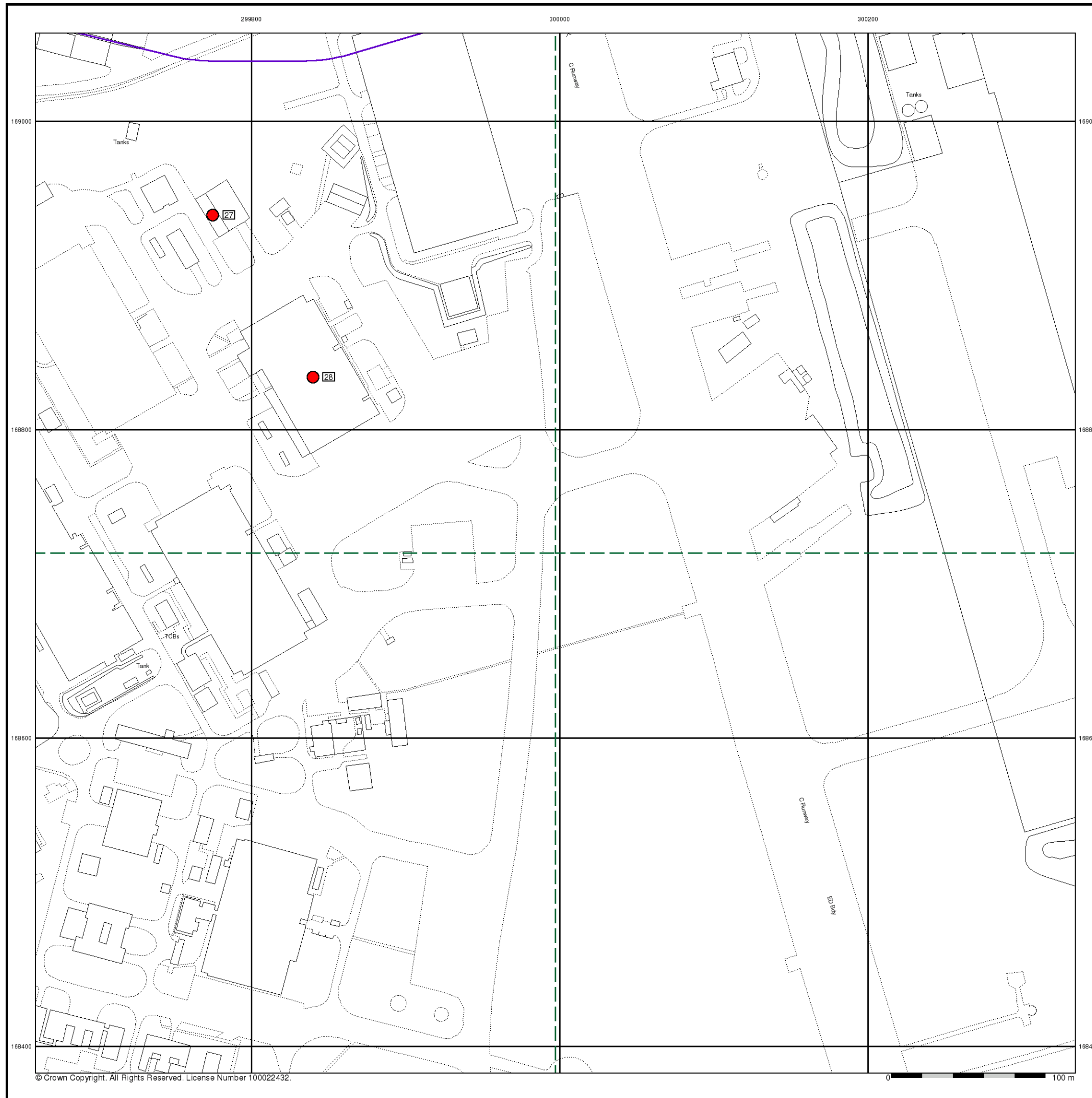

- General**
- Specified Site
  - Specified Buffer(s)
  - Bearing Reference Point
  - Map ID
  - Several of Type at Location
  - Pylon
  - Overhead Transmission Line
- Agency and Hydrological**
- Contaminated Land Register Entry or Notice (Location)
  - Contaminated Land Register Entry or Notice
  - Discharge Consent
  - Enforcement or Prohibition Notice
  - Integrated Pollution Control
  - Integrated Pollution Prevention Control
  - Local Authority Integrated Pollution Prevention and Control
  - Local Authority Pollution Prevention and Control Enforcement
  - Local Authority Recorded Landfill Site
  - Pollution Incident to Controlled Waters
  - Prosecution Relating to Authorised Processes
  - Prosecution Relating to Controlled Waters
  - Registered Radioactive Substance
  - River Network or Water Feature
  - River Quality Sampling Point
  - Substantiated Pollution Incident Register
  - Water Abstraction
  - Water Industry Act Referral
- Waste**
- BGS Recorded Landfill Site (Location)
  - BGS Recorded Landfill Site
  - EA Historic Landfill (Buffered Point)
  - EA Historic Landfill (Polygon)
  - Integrated Pollution Control Registered Waste Site
  - Licensed Waste Management Facility (Landfill Boundary)
  - Licensed Waste Management Facility (Location)
  - Local Authority Recorded Landfill Site (Location)
  - Local Authority Recorded Landfill Site
  - Potentially Infilled Land (Non-water)
  - Potentially Infilled Land (Non-water)
  - Potentially Infilled Land (Water)
  - Potentially Infilled Land (Water)
  - Potentially Infilled Land (Water)
  - Registered Landfill Site
  - Registered Landfill Site (Location)
  - Registered Landfill Site (Point Buffered to 100m)
  - Registered Landfill Site (Point Buffered to 250m)
  - Registered Waste Transfer Site (Location)
  - Registered Waste Transfer Site
  - Registered Waste Treatment or Disposal Site (Location)
  - Registered Waste Treatment or Disposal Site
- Hazardous Substances**
- COMAH Site
  - Explosive Site
  - NIHHS Site
  - Planning Hazardous Substance Consent
  - Planning Hazardous Substance Enforcement
- Geological**
- BGS Recorded Mineral Site

### Site Sensitivity Map - Segment B9

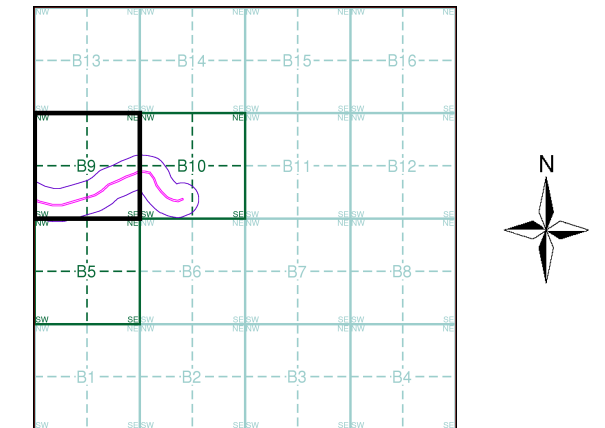

### Order Details

Order Number: 91812710\_1\_1  
 Customer Ref: 60509148  
 National Grid Reference: 300530, 169230  
 Slice: B  
 Site Area (Ha): 3.32  
 Plot Buffer (m): 100

### Site Details

St Athan Route, Cowbridge, South Glamorgan, CF71 7EQ

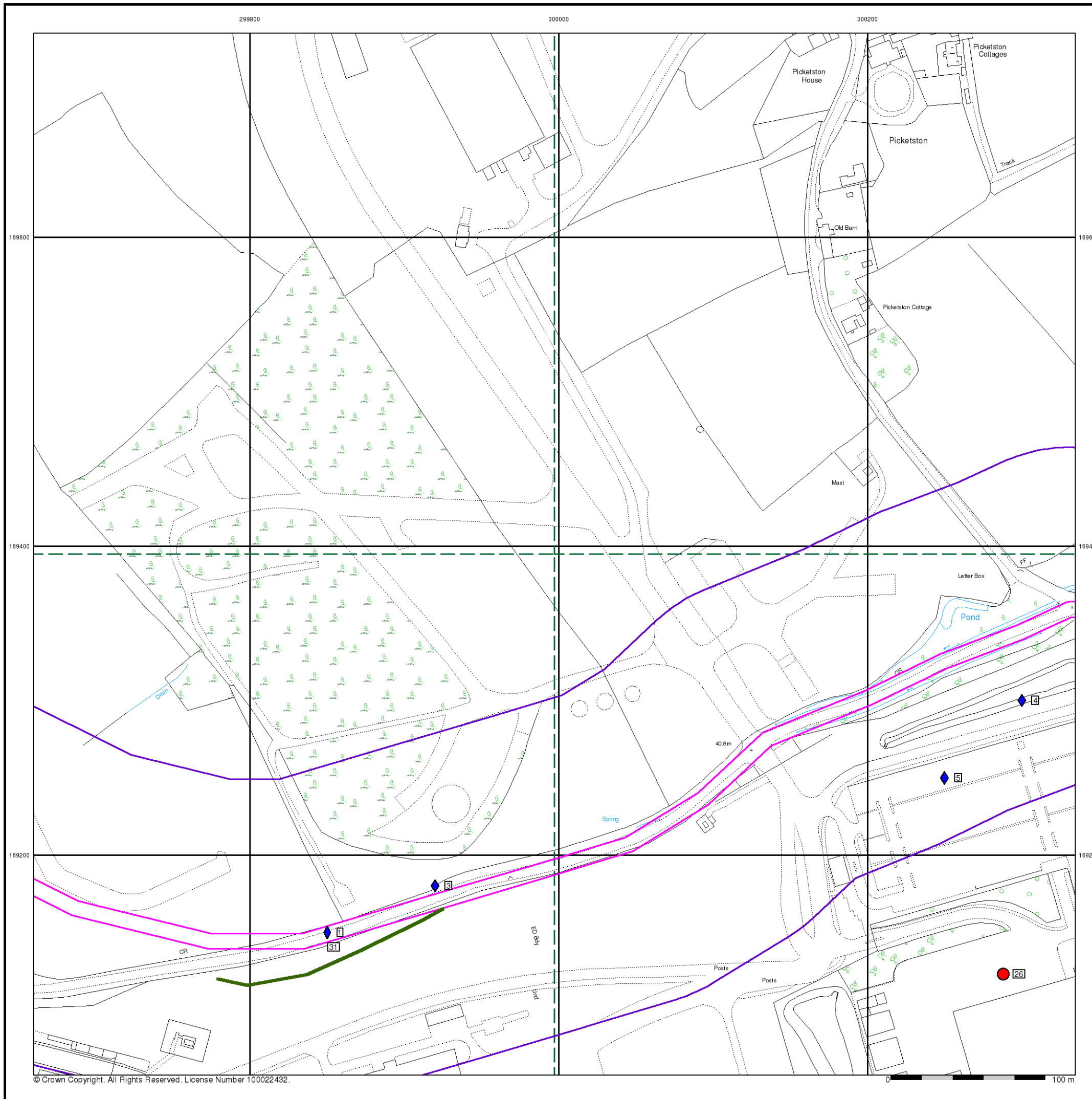

- General**
- Specified Site
  - Specified Buffer(s)
  - Bearing Reference Point
  - Map ID
  - Several of Type at Location
  - Pylon
  - Overhead Transmission Line
- Agency and Hydrological**
- Contaminated Land Register Entry or Notice (Location)
  - Contaminated Land Register Entry or Notice
  - Discharge Consent
  - Enforcement or Prohibition Notice
  - Integrated Pollution Control
  - Integrated Pollution Prevention Control
  - Local Authority Integrated Pollution Prevention and Control
  - Local Authority Pollution Prevention and Control Enforcement
  - Local Authority Recorded Landfill Site (Location)
  - Pollution Incident to Controlled Waters
  - Prosecution Relating to Authorised Processes
  - Prosecution Relating to Controlled Waters
  - Registered Radioactive Substance
  - River Network or Water Feature
  - River Quality Sampling Point
  - Substantiated Pollution Incident Register
  - Water Abstraction
  - Water Industry Act Referral
- Waste**
- BGS Recorded Landfill Site (Location)
  - BGS Recorded Landfill Site
  - EA Historic Landfill (Buffered Point)
  - EA Historic Landfill (Polygon)
  - Integrated Pollution Control Registered Waste Site
  - Licensed Waste Management Facility (Landfill Boundary)
  - Licensed Waste Management Facility (Location)
  - Local Authority Recorded Landfill Site (Location)
  - Local Authority Recorded Landfill Site
  - Potentially Infilled Land (Non-water)
  - Potentially Infilled Land (Non-water)
  - Potentially Infilled Land (Water)
  - Potentially Infilled Land (Water)
  - Potentially Infilled Land (Water)
  - Registered Landfill Site
  - Registered Landfill Site (Location)
  - Registered Landfill Site (Point Buffered to 100m)
  - Registered Landfill Site (Point Buffered to 250m)
  - Registered Waste Transfer Site (Location)
  - Registered Waste Transfer Site
  - Registered Waste Treatment or Disposal Site (Location)
  - Registered Waste Treatment or Disposal Site
- Hazardous Substances**
- COMAH Site
  - Explosive Site
  - NIHHS Site
  - Planning Hazardous Substance Consent
  - Planning Hazardous Substance Enforcement
- Geological**
- BGS Recorded Mineral Site

### Site Sensitivity Map - Segment B10

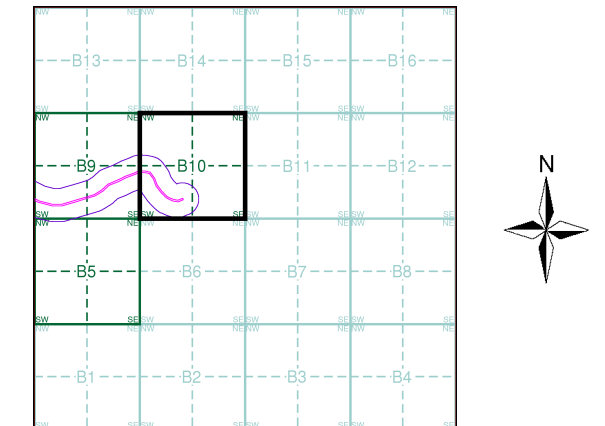

### Order Details

Order Number: 91812710\_1\_1  
 Customer Ref: 60509148  
 National Grid Reference: 300530, 169230  
 Slice: B  
 Site Area (Ha): 3.32  
 Plot Buffer (m): 100

### Site Details

St Athan Route, Cowbridge, South Glamorgan, CF71 7EQ

