



SAFETY, HEALTH AND ENVIRONMENTAL INFORMATION

In addition to the hazards/risks normally associated with the types of work detailed on this drawing, note the following specific residual risks (Reference shall also be made to the design Hazard log).

Consideration

For Hazards Refer to Document: Safety in Design - Designers Residual Hazard Register

NOTES

- ALL DIMENSIONS SHOWN ARE IN METRES UNLESS OTHERWISE SPECIFIED
- ALL WORKS ARE TO BE CARRIED OUT IN ACCORDANCE WITH THE CONTRACT SPECIFICATION AND THE MANUAL OF CONTRACT DOCUMENTS FOR HIGHWAY WORKS.
- ALL WORKING HOURS AND TRAFFIC MANAGEMENT MEASURES ARE TO BE AGREED WITH THE LOCAL HIGHWAY AUTHORITY AND DEPLOYED IN ACCORDANCE WITH CHAPTER 8 OF THE TRAFFIC SIGNS MANUAL.
- LOCATION OF SITE COMPOUND TO BE AGREED WITH THE LOCAL HIGHWAY AUTHORITY PRIOR TO WORKS COMMENCING. ALL MOVEMENT OF PLANT SHOULD BE IN ACCORDANCE WITH RECOGNISED GOOD INDUSTRY PRACTICE. BANKSMEN SHOULD BE PROVIDED WHEN REQUIRED.
- THE GENERAL PUBLIC SHOULD BE SEPARATED FROM THE WORKS WITH ADEQUATE LATERAL CLEARANCE AND APPROPRIATE SAFETY ZONES PROVIDED IN ACCORDANCE WITH CHAPTER 8 OF THE TRAFFIC SIGNS MANUAL.
- ACCESS TO PRIVATE PROPERTIES MUST BE MAINTAINED AT ALL TIMES UNLESS OTHERWISE AGREED WITH THE AFFECTED PARTY AND THE LOCAL HIGHWAY AUTHORITY.
- MEASURES SHOULD BE DEPLOYED TO ENSURE NOISE, VIBRATION AND DUST IS MINIMISED.
- ALL DIAGRAM NUMBERS REFER TO THE TRAFFIC SIGNS REGULATIONS AND GENERAL DIRECTIONS 2016.
- THE CONTRACTOR SHALL BE RESPONSIBLE FOR ENSURING THAT ALL EXISTING ROAD MARKINGS ARE SURVEYED AND DOCUMENTED PRIOR TO ANY SURFACING WORKS SO AS TO ENSURE ANY EXISTING ROAD MARKINGS THAT ARE TO REMAIN CAN BE REINSTATED ON COMPLETION OF THE WORKS.

KEY

- TSRGD DIAGRAM No. 1001 (300mm THICK)
- TSRGD DIAGRAM No. 1003 (600mm LINE, 300mm GAP, 200mm THICK)
- TSRGD DIAGRAM No. 1003.1 (1000mm LINE, 1000mm GAP, 200mm THICK)
- TSRGD DIAGRAM No. 1004 (4000mm LINE, 2000mm GAP, 100mm THICK)
- TSRGD DIAGRAM No. 1008 (2000mm LINE, 4000mm GAP, 100mm THICK)
- TSRGD DIAGRAM No. 1009 (600mm LINE, 300mm GAP, 100mm THICK)
- TSRGD DIAGRAM No. 1010 (1000mm LINE, 1000mm GAP, 100mm THICK)
- PLANNING APPLICATION BOUNDARY
- TSRGD DIAGRAM No. 1038 (4000mm LENGTH)
- TSRGD DIAGRAM No. 1039 (8000mm LENGTH)
- TSRGD DIAGRAM No. 1023 (3750mm LENGTH)
- TSRGD DIAGRAM No. 1014 (4500mm LENGTH)

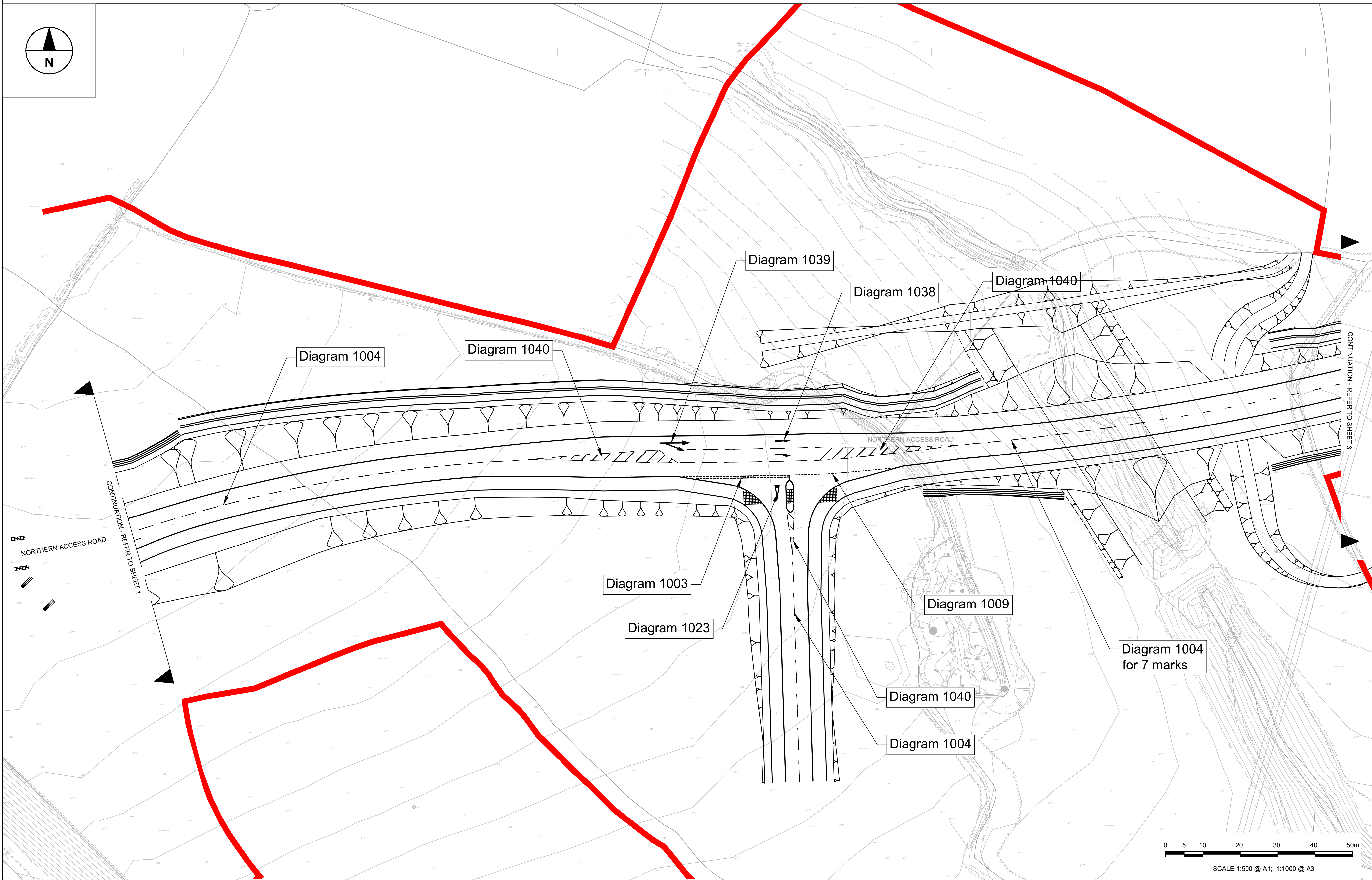
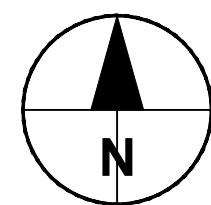

CONTINUATION - REFER TO SHEET 3

CONTINUATION - REFER TO SHEET 1

Diagram 1004 for 7 marks

STATUS

PLANNING SUBMISSION ISSUE

ISSUE/REVISION

IR	DATE	DESCRIPTION
A	26-05-2017	PLANNING SUBMISSION ISSUE

KEY PLAN

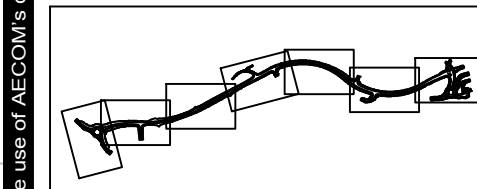

PROJECT NUMBER

60509148

SHEET TITLE

ST. ATHAN
ROAD MARKINGS
SHEET 2 OF 7

SHEET NUMBER

60509148-SHT-30-0000-CT-1222



SCALE 1:500 @ A1; 1:1000 @ A3