



SAFETY, HEALTH AND ENVIRONMENTAL INFORMATION

In addition to the hazards/risks normally associated with the types of work detailed on this drawing, note the following specific residual risks (Reference shall also be made to the design hazard log).

Construction
KNOWN BADGER PRESENCE IN AREA
WORKING ADJACENT TO WATERCOURSE
WORKING AT HEIGHT OVER FARMER ACCESS UNDERPASS AND LARGE DRAINAGE CULVERT
OVERHEAD ELECTRICITY CABLES OVER CARRIAGEWAY
LIVESTOCK IN ADJACENT LAND
DEEP CUTTING IN THIS AREA
STABILITY OF GROUND COULD BE AFFECTED

STATUS

PLANNING SUBMISSION ISSUE

ISSUE/REVISION

IR	DATE	DESCRIPTION
A	27-03-17	PLANNING SUBMISSION ISSUE

KEY PLAN

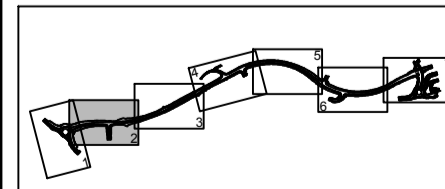

PROJECT NUMBER

60509148

SHEET TITLE

ST.ATHAN
PAVEMENT PLANS
SHEET 2 OF 7

SHEET NUMBER

60509148-SHT-30-0000-CT-0702

NOTES

1. ALL WORKS ARE TO BE CARRIED OUT IN ACCORDANCE WITH THE CONTRACT SPECIFICATION AND THE MANUAL OF CONTRACT DOCUMENTS FOR HIGHWAY WORKS.
2. ALL WORKING HOURS AND TRAFFIC MANAGEMENT MEASURES ARE TO BE AGREED WITH THE LOCAL HIGHWAY AUTHORITY AND DEPLOYED IN ACCORDANCE WITH CHAPTER 8 OF THE TRAFFIC SIGNS MANUAL.
3. LOCATION OF SITE COMPOUND TO BE AGREED WITH THE LOCAL HIGHWAY AUTHORITY PRIOR TO WORKS COMMENCING. ALL MOVEMENT OF PLANT SHOULD BE IN ACCORDANCE WITH RECOGNISED GOOD INDUSTRY PRACTICE. BANKSMEN SHOULD BE PROVIDED WHEN REQUIRED.
4. THE GENERAL PUBLIC SHOULD BE SEPARATED FROM THE WORKS WITH ADEQUATE LATERAL CLEARANCE AND APPROPRIATE SAFETY ZONES PROVIDED IN ACCORDANCE WITH CHAPTER 8 OF THE TRAFFIC SIGNS MANUAL.
5. ACCESS TO PRIVATE PROPERTIES MUST BE MAINTAINED AT ALL TIMES UNLESS OTHERWISE AGREED WITH THE AFFECTED PARTY AND THE LOCAL HIGHWAY AUTHORITY.
6. MEASURES SHOULD BE DEPLOYED TO ENSURE NOISE, VIBRATION AND DUST IS MINIMISED.
7. ALL BURIED SERVICES ARE TO BE POSITIVELY LOCATED ON SITE PRIOR TO EXCAVATION. CAT SCANS SHALL BE COMPLETED PRIOR TO EXCAVATION WITH SERVICE LOCATIONS MARKED UP ON SITE. OPERATIVES SHALL

EMPLOY HAND DIGGING METHODS WHEN WORKING IN CLOSE PROXIMITY TO BURIED SERVICES. STATUTORY UNDERTAKER'S PLANT SHALL BE PROTECTED AS NECESSARY. ADDITIONAL TRIAL PITS SHALL BE EXCAVATED AS REQUIRED.

KEY

- PROPOSED PAVEMENT TYPE 1
SURFACE COURSE
 - 35 mm THIN SURFACE COURSE SYSTEM
BINDER COURSE
 - 60 mm THICK, AC20 DENSE BIN 40/60
BASE COURSE
 - 200 mm THICK, AC32 DESNSE BASE 40/60
SUB BASE
 - 250 mm THICK, TYPE 2.1
 PSV = 55 AND MAX. AAV = 16
- PROPOSED FOOTWAY/CYCLEWAY PAVEMENT
SURFACE COURSE
 - 20 mm THICK, AC6 DESNSE SURF 100/150
BINDER COURSE
 - 50 mm THICK, AC20 DENSE BIN 160/220
SUB BASE
 - 150 mm THICK, TYPE 2.1
- PLANNING APPLICATION BOUNDARY
- PROPOSED PAVEMENT TYPE 2
SURFACE COURSE
 - 35 mm THIN SURFACE COURSE SYSTEM
BINDER COURSE
 - 60 mm THICK, AC20 DENSE BIN 40/60
BASE COURSE
 - 200 mm THICK, AC32 DESNSE BASE 40/60
SUB BASE
 - 250 mm THICK, TYPE 2.1
 PSV = 60 AND MAX. AAV = 16
- PROPOSED TRAFFIC ISLAND
SURFACE COURSE
 - 25 mm THICK, AC6 DENSE SURF 100/150
BINDER COURSE
 - 90 mm THICK, AC20 DENSE BIN100/150
SUB BASE
 - 250 mm THICK, TYPE 2.1

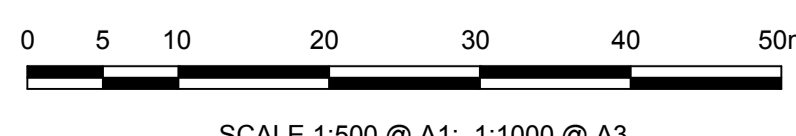
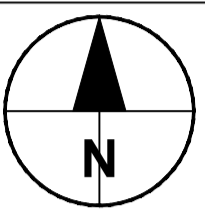
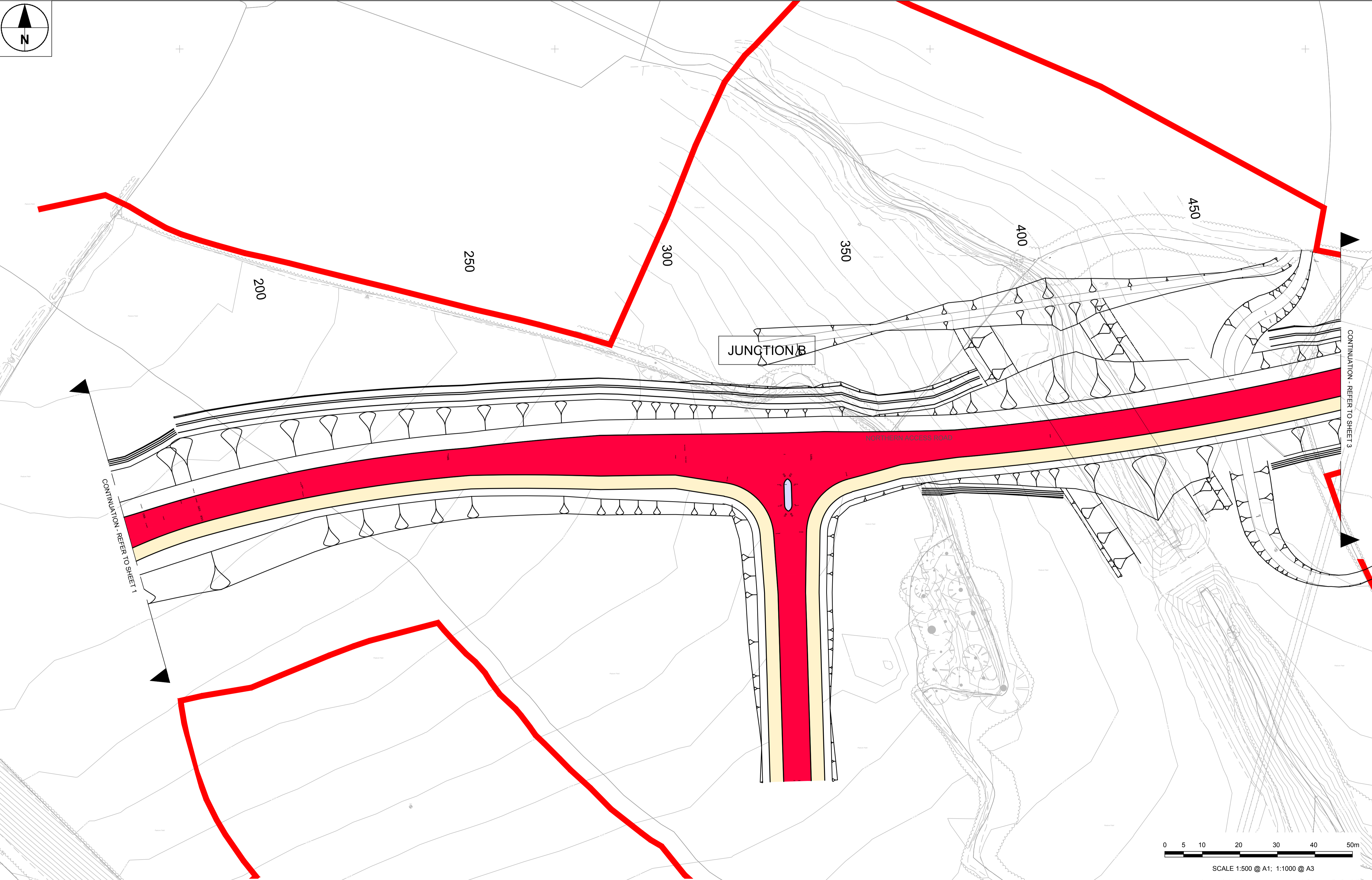

SCALE 1:500 @ A1; 1:1000 @ A3

ISO A1 594mm x 841mm
 Approved: RM
 Checked: RM
 Designer: M4
 Project Management: M4
 Last saved by: SHORTEE
 Last printed: 2017-05-25
 File name: P:\UK\DF-1\PROJECTS\HIGHWAYS - ST.ATHAN\B3 EXECUTION\B3 DOCUMENTS\605 CAD\01 WORKING DRAWINGS\0702 - ROAD PAVEMENTS GENERAL\60509148-SHT-30-0000-CT-0702.DWG
 Printed on: 100% Recycled Content Paper

This drawing has been prepared for the use of AECOM's client. It may not be used, modified, reproduced or relied upon by third parties, except as agreed by AECOM or as required by law. AECOM accepts no responsibility, and denies any liability, whatsoever to any party that uses or relies on this drawing without AECOM's express written consent. Do not scale this document. All measurements must be obtained from the stated dimensions.