



SAFETY, HEALTH AND ENVIRONMENTAL INFORMATION

In addition to the hazards/risks normally associated with the types of work detailed on this drawing, note the following specific residual risks (Reference shall also be made to the design hazard log).

Construction
WORKING ON AND ADJACENT TO LIVE CARRIAGEWAY
HIGH PERCENTAGE OF CARAVAN TRAILER TRAFFIC IN THIS AREA
OVERHEAD ELECTRICITY CABLES OVER CARRIAGEWAY

STATUS

PLANNING SUBMISSION ISSUE

ISSUE/REVISION

IR	DATE	DESCRIPTION
B	26-05-2017	SITE CLEARANCE EXTENTS UPDATED
A	27-03-2017	PLANNING SUBMISSION ISSUE

KEY PLAN

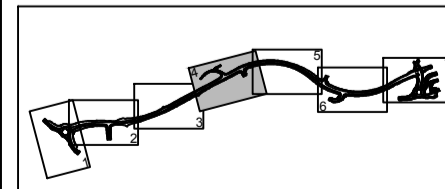

PROJECT NUMBER

60509148

SHEET TITLE

ST.ATHAN
SITE CLEARANCE
SHEET 4 OF 8

SHEET NUMBER

60509148-SHT-30-0000-CT-0204

NOTES

- ALL DIMENSIONS SHOWN ARE IN METRES UNLESS OTHERWISE SPECIFIED
- ALL WORKS ARE TO BE CARRIED OUT IN ACCORDANCE WITH THE CONTRACT SPECIFICATION AND THE MANUAL OF CONTRACT DOCUMENTS FOR HIGHWAY WORKS.
- ALL WORKING HOURS AND TRAFFIC MANAGEMENT MEASURES ARE TO BE AGREED WITH THE LOCAL HIGHWAY AUTHORITY AND DEPLOYED IN ACCORDANCE WITH CHAPTER 8 OF THE TRAFFIC SIGNS MANUAL.
- LOCATION OF SITE COMPOUND TO BE AGREED WITH THE LOCAL HIGHWAY AUTHORITY PRIOR TO WORKS COMMENCING. ALL MOVEMENT OF PLANT SHOULD BE IN ACCORDANCE WITH RECOGNISED GOOD INDUSTRY PRACTICE. BANKSMEN SHOULD BE PROVIDED WHEN REQUIRED.
- THE GENERAL PUBLIC SHOULD BE SEPARATED FROM THE WORKS WITH ADEQUATE LATERAL CLEARANCE AND APPROPRIATE SAFETY ZONES PROVIDED IN ACCORDANCE WITH CHAPTER 8 OF THE TRAFFIC SIGNS MANUAL.
- ACCESS TO PRIVATE PROPERTIES MUST BE MAINTAINED AT ALL TIMES UNLESS OTHERWISE AGREED WITH THE AFFECTED PARTY AND THE LOCAL HIGHWAY AUTHORITY.
- MEASURES SHOULD BE DEPLOYED TO ENSURE NOISE, VIBRATION AND DUST IS MINIMISED.
- OVERHEAD ELECTRICITY LINES ARE PRESENT, IF WORKING NEAR ELECTRICITY LINES FOLLOW ADVICE FROM WESTERN POWER DISTRIBUTION.
- ABOVE GROUND VEGETATION WILL BE REMOVED IN ACCORDANCE WITH THE HAZEL DORMOUSE EPSL METHOD STATEMENT AND REPTILE HABITAT MANIPULATION METHODS.

KEY

- TREE TO BE REMOVED
- STUMP TO BE REMOVED
- GATE TO BE REMOVED
- FENCE TO BE REMOVED
- MANHOLE TO BE REMOVED
- POST TO BE REMOVED
- FEEDER PILLAR TO BE REMOVED
- ROAD SIGN, CHECK SCHEDULE IF TO BE SENT TO TIP OR STORE
- GULLY TO BE REMOVED SEE SCHEDULE IF TO BE SENT TO STORE OR TIP
- GENERAL SITE CLEARANCE
- EXISTING PAVEMENT TO BE BROKEN OUT FOR NEW PAVEMENT CONSTRUCTION
- EXISTING PAVEMENT TO BE BROKEN OUT AND BACKFILLED WITH TOPSOIL
- EXISTING CONCRETE TO BE BROKEN OUT FOR NEW PAVEMENT CONSTRUCTION
- EXISTING CONCRETE TO BE BROKEN OUT AND BACKFILLED WITH TOPSOIL
- STRUCTURE TO BE DEMOLISHED, STRUCTURAL ENGINEER IS TO BE CONSULTED AS TO HOW IT IS TO BE DEMOLISHED
- PLANNING BOUNDARY
- KERB TO BE REMOVED
- INSPECTION CHAMBER TO BE REMOVED

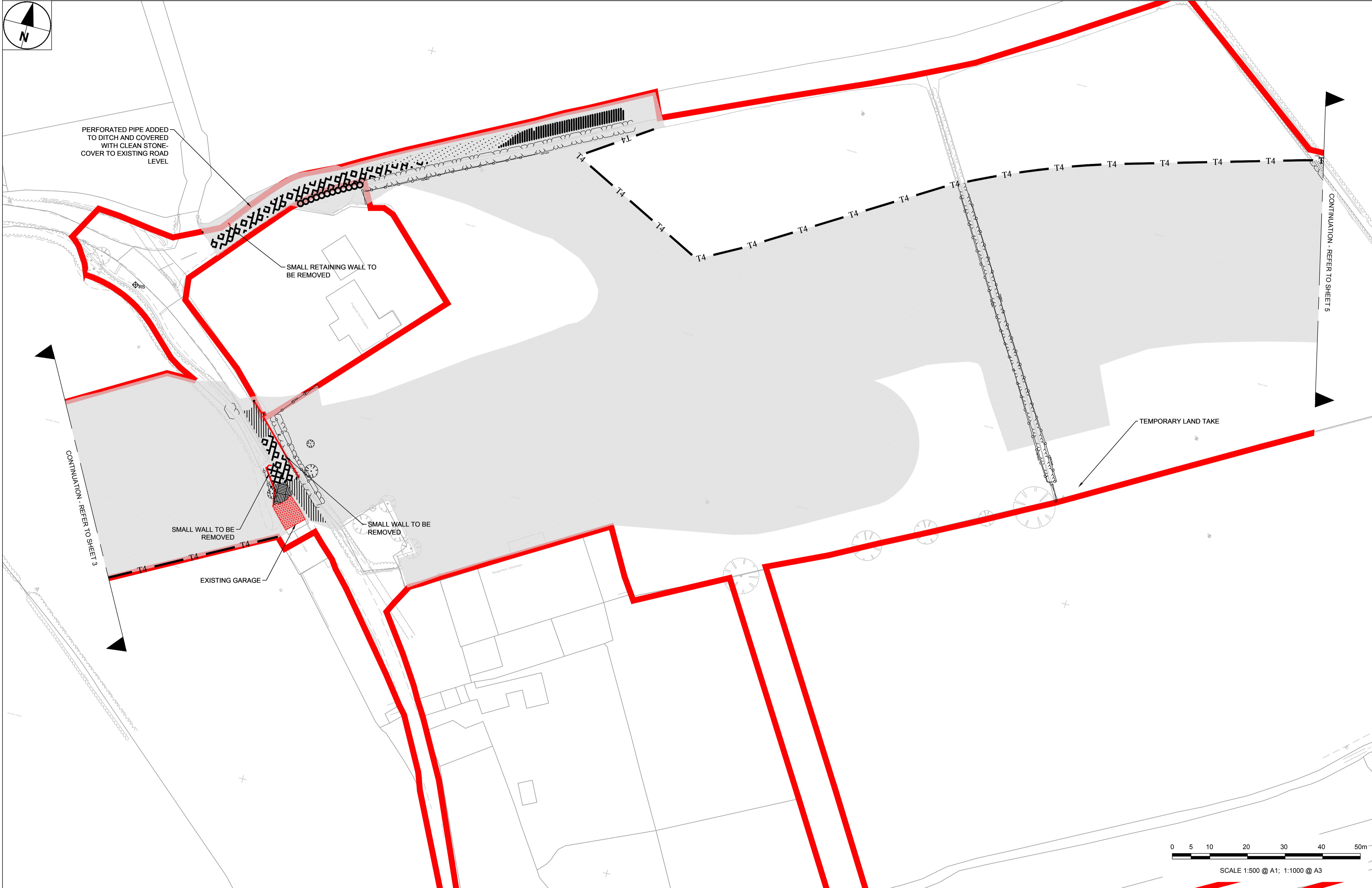
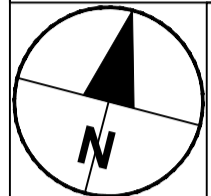

PERFORATED PIPE ADDED TO DITCH AND COVERED WITH CLEAN STONE-COVER TO EXISTING ROAD LEVEL

SMALL RETAINING WALL TO BE REMOVED

SMALL WALL TO BE REMOVED

SMALL WALL TO BE REMOVED

EXISTING GARAGE

TEMPORARY LAND TAKE

CONTINUATION - REFER TO SHEET 3

CONTINUATION - REFER TO SHEET 5



ISO A1 841mm x 603mm
Approved: RM
Checked: TAM
Designer: AS
Project Management Initials:
Last Printed: 2017-05-25
Last saved by: JACCOLDIGHT
Last saved by: JACCOLDIGHT
File name: P:\UKCDF\1\PROJECTS\HIGHWAYS - ST.ATHAN\03 EXECUTION\03 DOCUMENTS\06 CAD\01 WORKING DRAWINGS\0200 - SITE CLEARANCE\60509148-SHT-30-0000-CT-0204.dwg

This drawing has been prepared for the use of AECOM's client. It may not be used, modified, reproduced or relied upon by third parties, except as agreed by AECOM or as required by law. AECOM accepts no responsibility, and denies any liability whatsoever, to any party that uses or relies on this drawing without AECOM's express written consent. Do not scale this document. All measurements must be obtained from the stated dimensions.