

BSI A1 594mm x 841mm  
Checked: RM  
Approved: RM  
Designer: MH  
Project Management Initials:

**KEY**  
— PROPOSED LAND ACQUISITION BOUNDARY  
X PROPOSED GATES

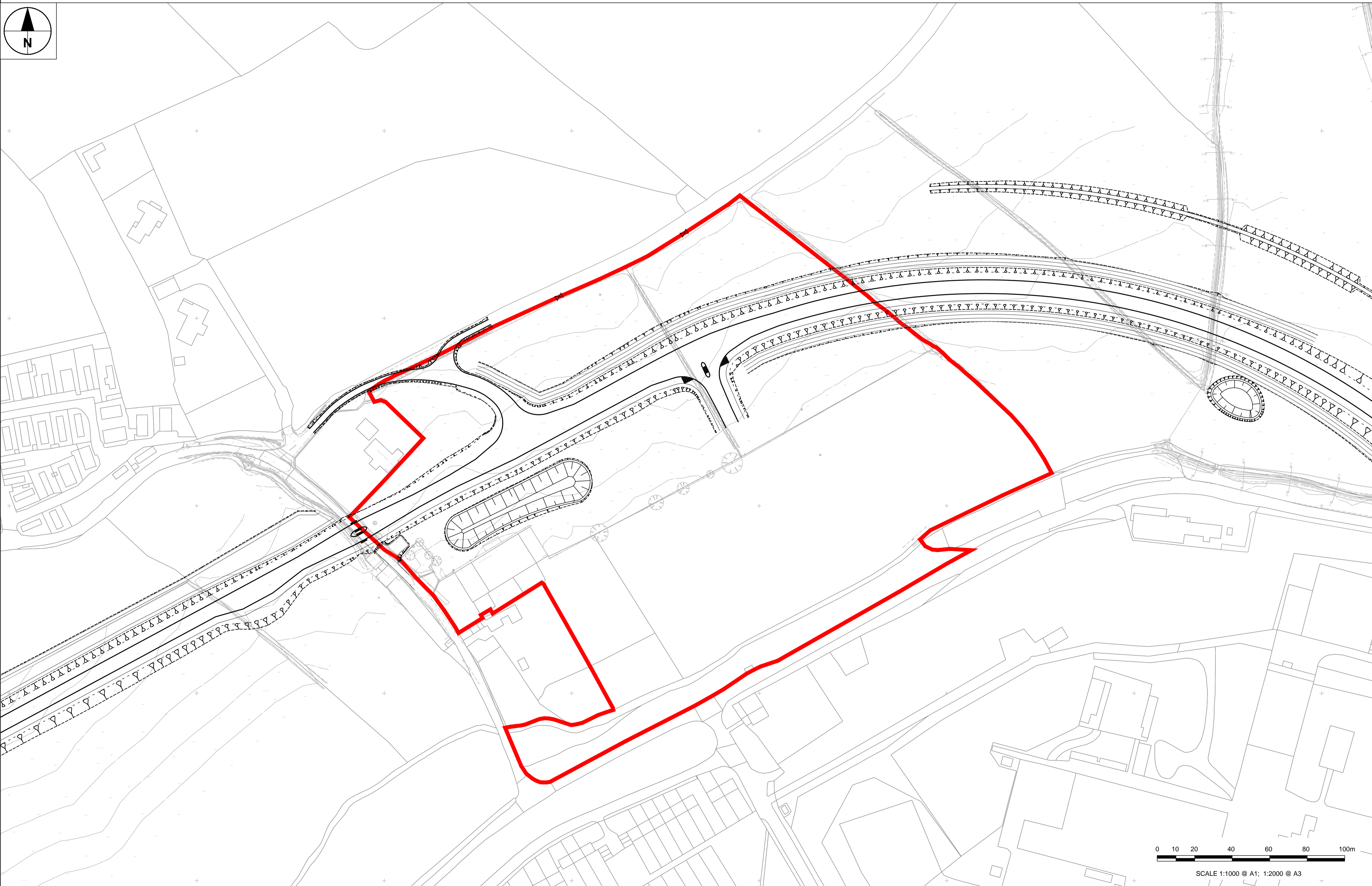
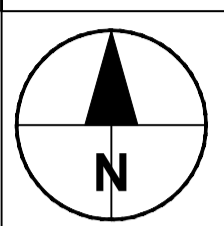

**PROJECT**  
ST. ATHAN  
NORTHERN  
ACCESS  
ROAD

**CLIENT**  
WELSH GOVERNMENT



Llywodraeth Cymru  
Welsh Government

**CONSULTANT**  
AECOM  
1 CALLAGHAN SQUARE  
CARDIFF  
CF10 5BT  
TEL: (029) 20674600  
FAX: (029) 20674699

**SAFETY, HEALTH AND ENVIRONMENTAL INFORMATION**

In addition to the hazards normally associated with the types of work detailed on this drawing, note the following specific residual risks (Reference shall also be made to the design hazard register)

Construction  
For Hazards Refer to Document: Safety in Design - Designers Residual Hazard Register

|  |
|--|
|  |
|  |
|  |
|  |

File name: F:\PROJECTS\HIGHWAYS - ST ATHAN\3 EXECUTION\3 DOCUMENTS\308 CAD\01 WORKING\DRAWINGS\0505 - BOUNDARY & LAND ACQUISITION\60505148-SHT-30-0000-CT-0054.DWG  
Last saved by: ONELL3  
Last plotted: 2017-03-24

**STATUS**  
PLANNING SUBMISSION ISSUE

| ISSUE/REVISION |  |  |
|----------------|--|--|
|                |  |  |
|                |  |  |
|                |  |  |

| IR | DATE       | DESCRIPTION               |
|----|------------|---------------------------|
| A  | 27-03-2017 | PLANNING SUBMISSION ISSUE |

**KEY PLAN**

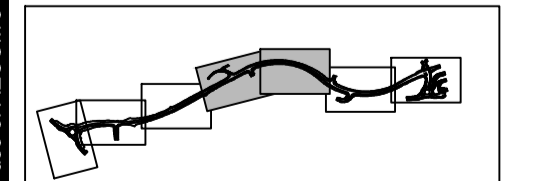

**PROJECT NUMBER**  
60509148

**SHEET TITLE**  
ST.ATHAN  
ACCOMODATION WORKS  
PLOT 12 - FROGLANDS FARM

**SHEET NUMBER**  
60509148-SHT-30-0000-CT-0054

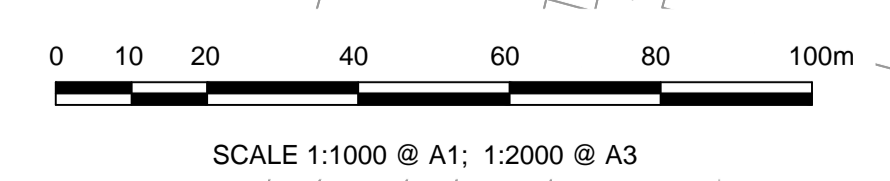

SCALE 1:1000 @ A1; 1:2000 @ A3