



PROJECT
ST. ATHAN
NORTHERN
ACCESS
ROAD

CLIENT
WELSH GOVERNMENT



Llywodraeth Cymru
Welsh Government

CONSULTANT
AECOM
1 CALLAGHAN SQUARE
CARDIFF
CF10 5BT
TEL: (029) 20674600
FAX: (029) 20674699

SAFETY, HEALTH AND ENVIRONMENTAL INFORMATION

In addition to the hazards normally associated with the types of work detailed on this drawing, note the following specific residual risks (Reference shall also be made to the design hazard log)

Construction
For Hazards Refer to Document Safety in Design - Designers Residual Hazard Register

KEY
PROPOSED LAND ACQUISITION BOUNDARY
PROPOSED GATES

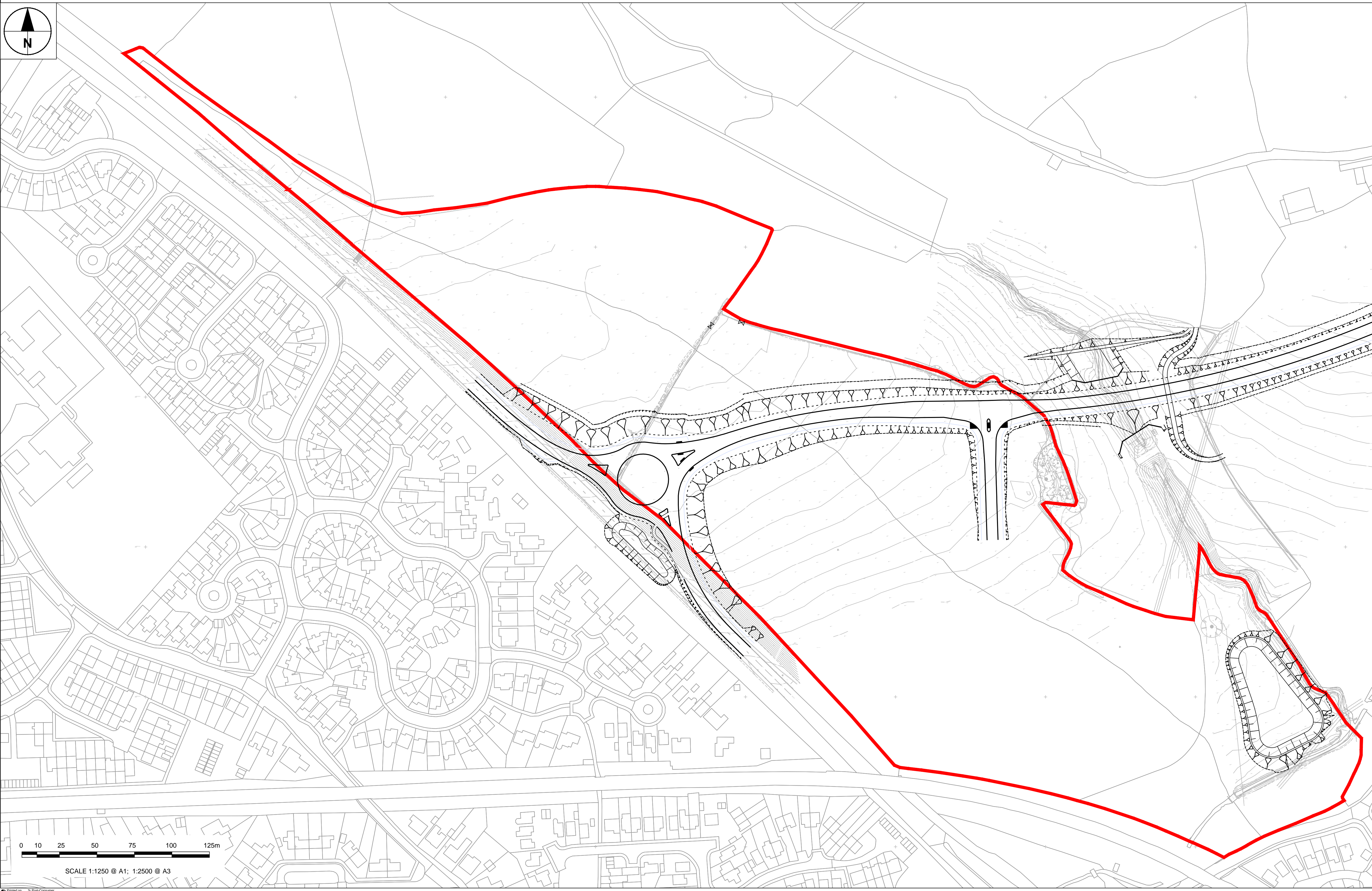
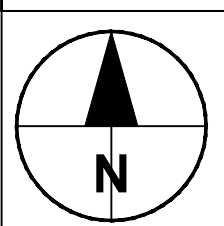

SCALE 1:1250 @ A1; 1:2500 @ A3

STATUS
PLANNING SUBMISSION ISSUE

ISSUE/REVISION

NO	DATE	DESCRIPTION
A	27-03-2017	PLANNING SUBMISSION ISSUE

KEY PLAN

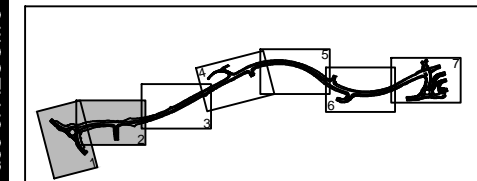

PROJECT NUMBER
60509148

SHEET TITLE
ST.ATHAN
ACCOMODATION WORKS
PLOT 17 - BOVERTON COURT FARM

SHEET NUMBER
60509148-SHT-30-0000-CT-0051

ISO A1 594mm x 841mm
Project Management Initials: Designer: MH Checked: RM Approved: RM
Filename: F:\PROJECTS\HIGHWAYS - ST ATHAN\3 EXECUTION\3 DOCUMENTS\308 CAD\01 WORKING\DRAWINGS\0501 - BOUNDARY & LAND ACQUISITION\60509148-SHT-30-0000-CT-0051.DWG Last saved by: BEBRIDGEB Last Printed: 2017-03-24
This drawing has been prepared for the use of AECOM's client. It may not be used, modified, reproduced or relied upon by third parties, except as agreed by AECOM or as required by law. AECOM accepts no responsibility, and denies any liability, whatsoever, to any party that uses or relies on this drawing without AECOM's express written consent. Do not scale this document. All measurements must be obtained from the stated dimensions.
Printed on: Recycled Content Paper