

ISO A1 594mm x 841mm  
 Approved: MJ  
 Checked: RB  
 Designer: RB  
 Project Management: RB  
 File name: P:\UKCDF\1\PROJECTS\HIGHWAYS - ST ATHAN\3 EXECUTION\3 DOCUMENTS\CAD\01 WORKING DRAWINGS\3000 - LANDSCAPE AND ECOLOGY\60509148-SHT-30-0000-CT-3001\_3007\_LAND\_ECCL.DWG - Last saved by: SHORTEE - Last printed: 2017-05-25

- ALL WORKS ARE TO BE CARRIED OUT IN ACCORDANCE WITH THE CONTRACT SPECIFICATION AND THE MANUAL OF CONTRACT DOCUMENTS FOR HIGHWAY WORKS.
- REFER TO SITE CLEARANCE DRAWINGS 60509148-SHT-30-0000-CT-0201 TO 0208 FOR DETAILS OF VEGETATION TO BE RETAINED OR REMOVED AND TRANS-LOCATED HEDGES.
- REFER TO ARBORICULTURAL REPORT DOCUMENT 60509148-LDRP-00002 FOR DETAILS OF ALL RETAINED TREES AND TREE PROTECTION REQUIREMENTS.
- WHERE RETAINED TREES ARE LOCATED CLOSE TO A PROPOSED CUT SLOPE THEIR STABILITY AND LONG TERM VIABILITY SHOULD BE ASSESSED BY A SUITABLY QUALIFIED ARBORICULTURIST.
- REFER TO FENCING DRAWINGS 60509148-SHT-30-0000-CT-0301 TO 0308 FOR DETAILS OF HIGHWAY FENCING, WALLS AND ACOUSTIC BARRIERS.
- REFER TO EARTHWORKS DRAWINGS 60509148-SHT-30-0000-CT-0621 TO 0627.
- REFER TO ECOLOGICAL ASSESSMENT AND MITIGATION FOR DETAILS OF 'DEAD HEDGE'.

- ALL PROPOSED PLANTING AREAS ARE TO BE CULTIVATED AS PER SPECIFICATION 3004 AND APPENDIX 30/4.
- WHERE EXISTING TREE CANOPY EXTEND OVER AREAS OF PROPOSED GRASS, SOIL PREPARATION WILL BE UNDERTAKEN WITH REGARD TO THE PRESENCE OF TREE ROOTS.
- FINAL LANDSCAPE MITIGATION DESIGN WILL BE SUBJECT TO AMENDMENTS TO RESPOND TO FINAL SITE CLEARANCE.
- FOR SHRUB AND INTERMITTENT TREE PLANTING AREAS THE LARGER STOCK, I.E., THOSE IDENTIFIED AS TREES WITHIN THE SCHEDULES WILL ACCOUNT FOR 20% OF THE TOTAL NUMBER OF PLANTS WITHIN EACH INDIVIDUAL PLANTING AREAS.
- WHERE AREAS OF PROPOSED SOFT LANDSCAPE TREATMENT COINCIDE WITH AREAS OF ABANDONED CARRIAGEWAY, WHERE POSSIBLE TOP SOIL AND SUB SOIL PROFILES ARE TO BE REINSTATED TO MATCH THE SURROUNDING SOIL HORIZONS, WITH THE FOLLOWING MINIMUM TOP SOIL DEPTHS
  - SEEDED AREAS - 100 mm
  - PLANTED AREAS (EXCLUDING TREES) - 300 mm
  - PLANTED AREAS (INCLUDING TREES) - 300 mm

- KEY**
- LE 1.1 AMENITY GRASS AREAS
  - LE 1.3 SPECIES RICH GRASSLAND
  - LE 1.6 OPEN GRASSLAND
  - LE 2.4 LINEAR TREES AND SHRUBS
  - LE 2.4.1 LINEAR TREE AND SHRUB MIX 2
  - LE 2.5 SHRUBS WITH INTERMITTENT TREES
  - LE 2.6 SHRUBS
  - LE 4.2 NATIVE HEDGEROW
  - LE 4.2.1 TRANSLOCATED NATIVE HEDGEROW
  - LE 4.2.2 NATIVE HEDGEROW - AMENITY MIXTURE
  - LE 4.4 NATIVE HEDGEROW WITH TREES

- LE 5.1 INDIVIDUAL TREES
- PLANNING APPLICATION BOUNDARY
- EXISTING TREES & SHRUBS
- PROPOSED HIGHWAY BOUNDARY FENCE LINE - SEE NOTE 5
- PROPOSED HIGHWAY BOUNDARY WALL - SEE NOTE 5
- PROPOSED ACOUSTIC BARRIER - SEE NOTE 5
- PROPOSED 'DEAD HEDGEROW' ECOLOGICAL FEATURE

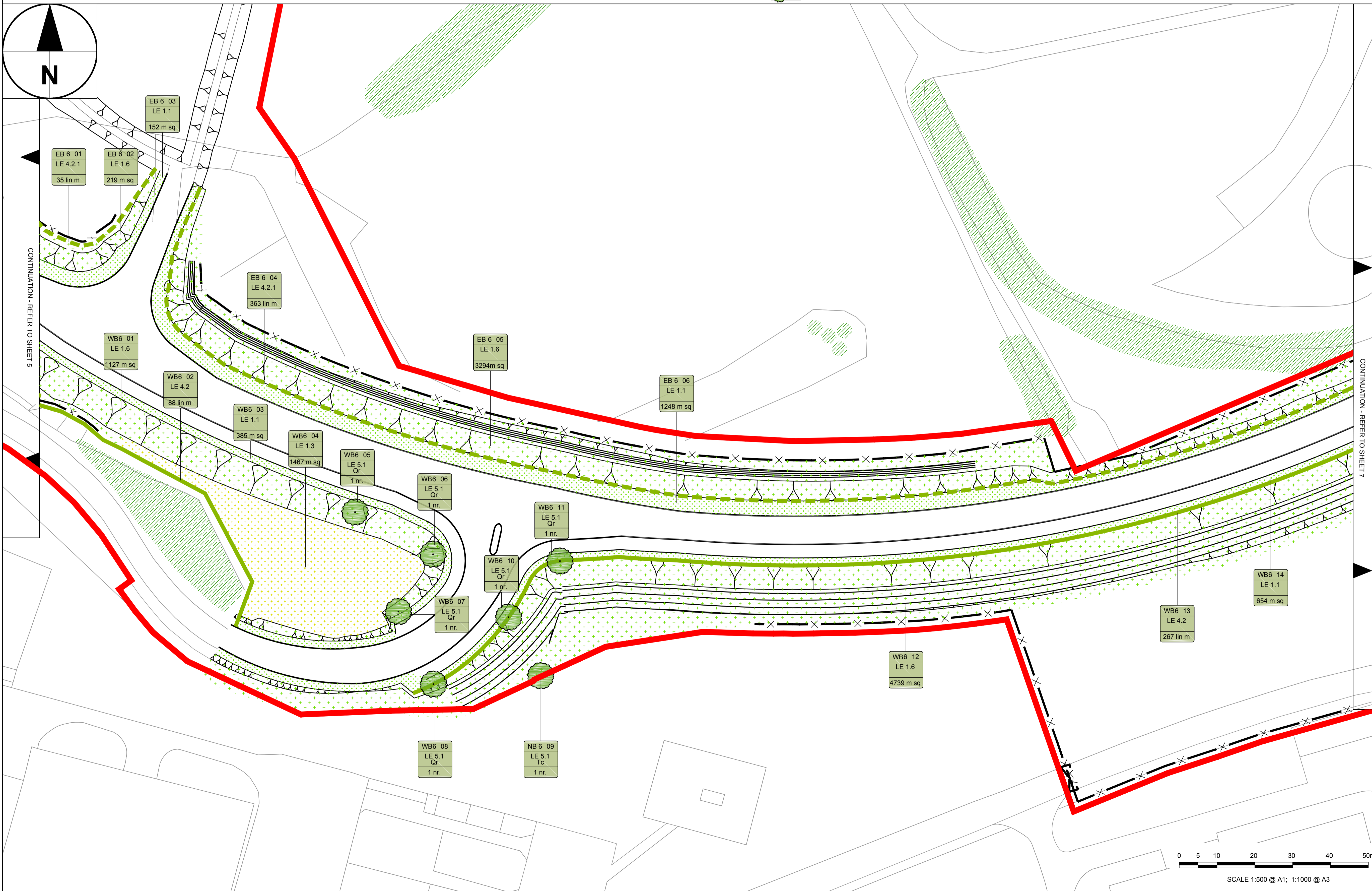

**AECOM**

PROJECT  
**ST. ATHAN  
 NORTHERN  
 ACCESS  
 ROAD**

CLIENT  
 WELSH GOVERNMENT

CONSULTANT  
 AECOM  
 1 CALLAGHAN SQUARE  
 CARDIFF  
 CF10 5BT  
 TEL: (029) 20674600  
 FAX: (029) 20674699

**SAFETY, HEALTH AND ENVIRONMENTAL INFORMATION**

In addition to the hazards risks normally associated with the types of work detailed on this drawing, note the following specific residual risks (Reference shall also be made to the design hazard log)

Construction  
 For Hazards Refer to Document: Safety in Design - Designers Residual Hazard Register

**STATUS**

PLANNING SUBMISSION ISSUE

**ISSUE/REVISION**

IR	DATE	DESCRIPTION
A	15-03-2017	PLANNING SUBMISSION ISSUE

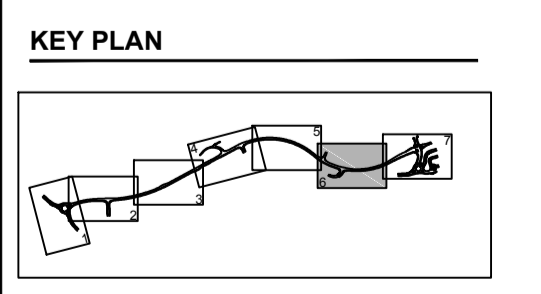

**PROJECT NUMBER**  
 60509148

**SHEET TITLE**  
 ST ATHAN  
 LANDSCAPE PROPOSALS  
 SHEET 6 OF 8

**SHEET NUMBER**  
 60509148-SHT-30-0000-CT-3006

