

ISO A1 594mm x 841mm  
 Approved: RM  
 Checked: RM  
 Designer: M4  
 Project Management Initials:  
 Last Printed: 2017-03-24  
 Last Saved by: SHORTEE  
 Last Printed: 2017-03-24  
 Last Saved by: SHORTEE  
 File Name: F:\PROJECTS\HIGHWAYS - ST ATHAN\EXECUTING DOCUMENTS\CAD\01 WORKING DRAWINGS\150 - VISIBILITY SPLAYS\60509148-SHT-30-0000-CT-0151-151.DWG

**NOTES**

1. ALL DIMENSIONS SHOWN ARE IN METRES UNLESS OTHERWISE SPECIFIED
2. ONLY THE MOST ONEROUS VEHICLES IS SHOWN IN THE SWEEP PATH ANALYSIS
3. SWEEP PATHS AROUND THE ROUNDABOUT CIRCULATORY HAVE BEEN OMITTED FOR CLARITY.
4. TRACKING AT JUNCTIONS HAS BEEN UNDERTAKEN AT 5 Km/h
5. VISIBILITY SPLAYS HAVE BEEN PRODUCED BASED ON THE REQUIREMENTS OF THE DMRB TD 42/95, TD 50/04 AND TD 16/07.

**KEY**

- PLANNING BOUNDARY
- VISIBILITY ENVELOPE
- PROPOSED KERB LINE
- ▲ ROAD SIGN
- PROPOSED BLISTER TACTILES 400mm x 400mm
- VEHICLE OUTLINE
- VEHICLE OVERHANG

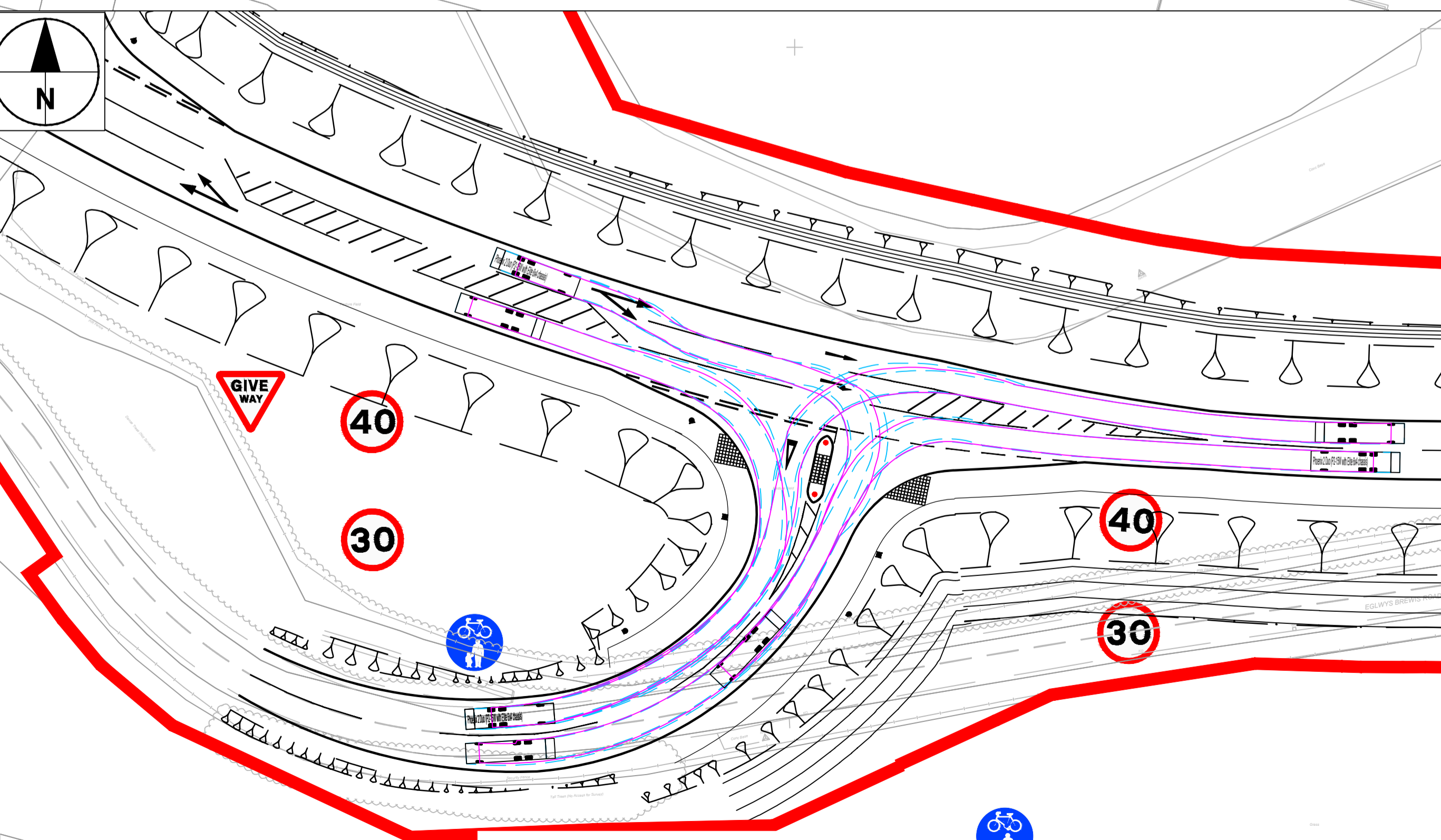
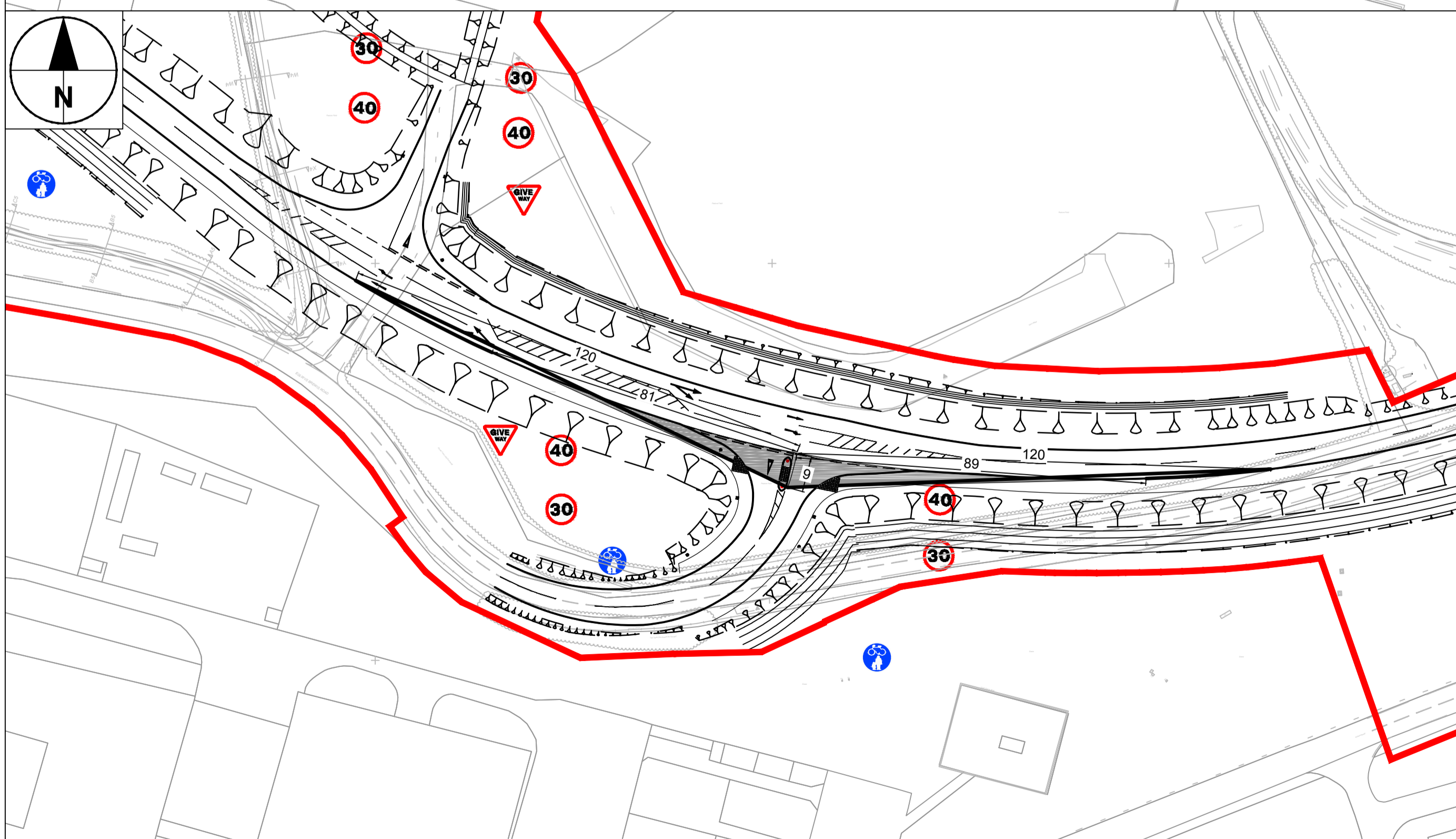
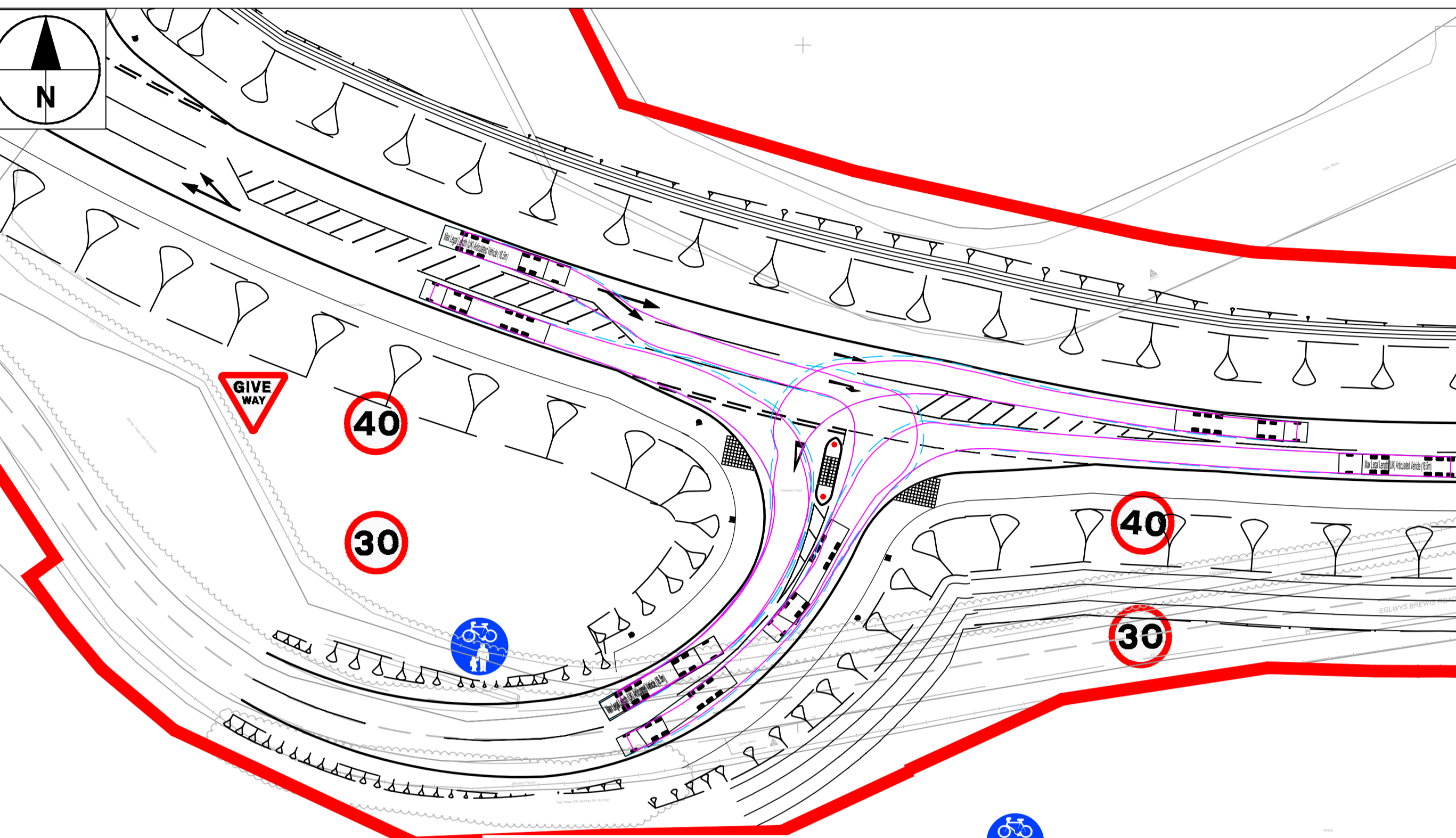
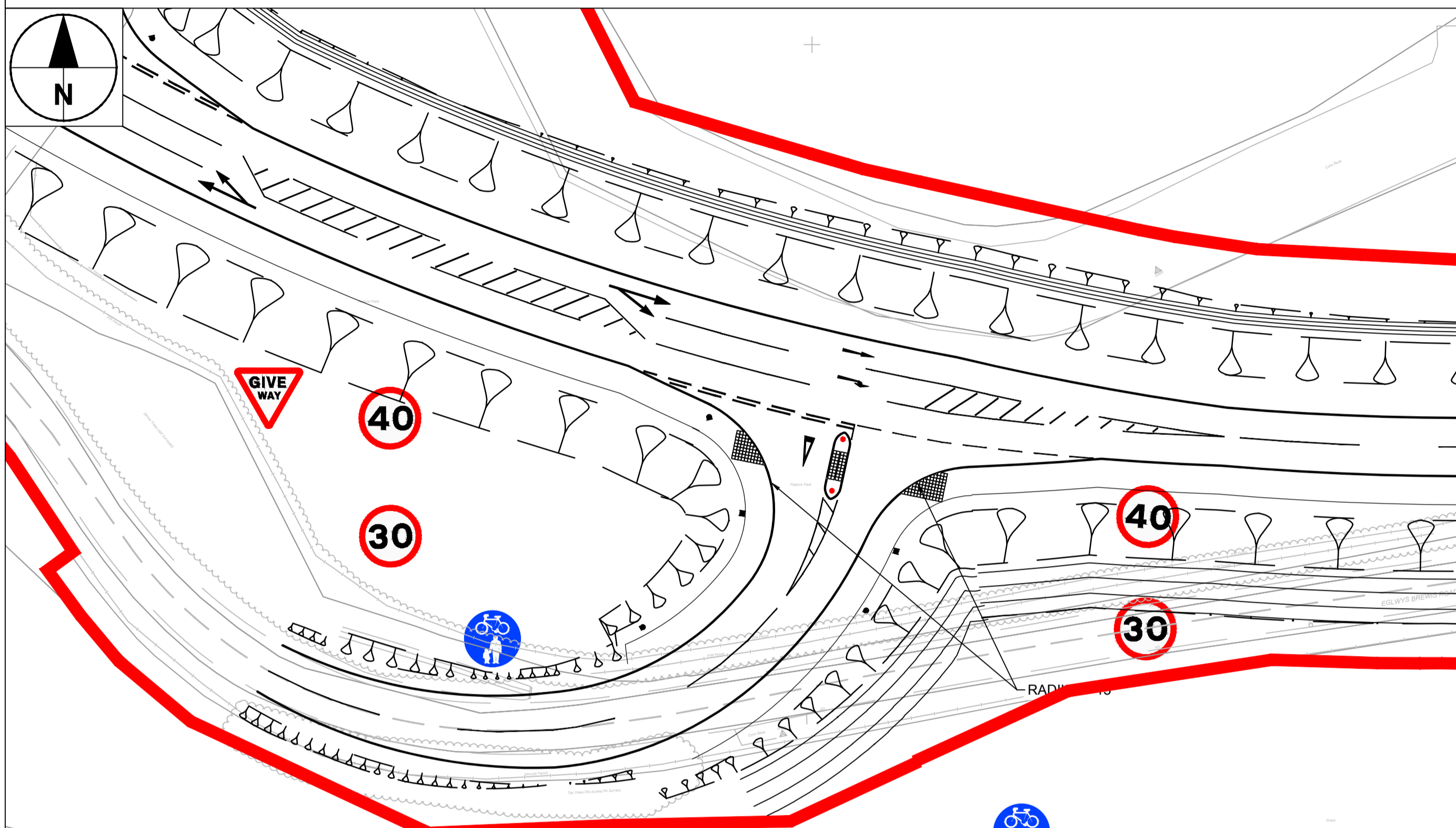
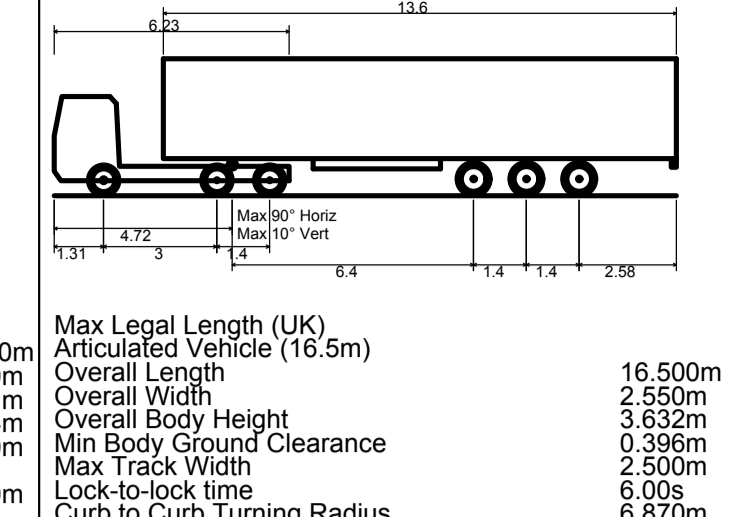
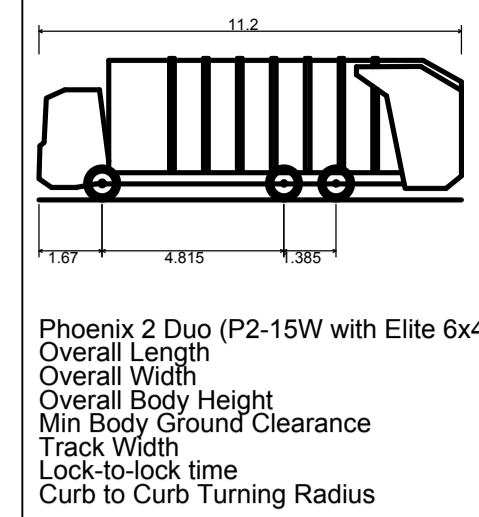

**AECOM**

PROJECT  
**ST. ATHAN NORTHERN ACCESS ROAD**

CLIENT  
 WELSH GOVERNMENT

Llywodraeth Cymru  
 Welsh Government

CONSULTANT  
 AECOM  
 1 CALLAGHAN SQUARE  
 CARDIFF  
 CF10 5BT  
 TEL: (029) 20674600  
 FAX: (029) 20674699

**SAFETY, HEALTH AND ENVIRONMENTAL INFORMATION**

In addition to the hazards/risks normally associated with the types of work detailed on this drawing, note the following specific residual risks (Reference shall also be made to the design hazard log).

Construction
UNDERGROUND UTILITIES IN THIS AREA (INC. GAS)
WORKING ADJACENT TO WATERCOURSE
WORKING ON AND ADJACENT TO LIVE CARRIAGEWAY
MOD ACTIVITIES IN ADJACENT LAND

**STATUS**

PLANNING SUBMISSION ISSUE
ISSUE/REVISION

**KEY PLAN**

**PROJECT NUMBER**  
 60509148

**SHEET TITLE**  
 ST. ATHAN SWEPT PATH ANALYSIS & VISIBILITY SPLAYS JUNCTION E

**SHEET NUMBER**  
 60509148-SHT-30-0000-CT-0156

