

PROPOSED



A.J. Design Associates.
Specialists in Architectural Design, Surveying and Building Engineering.

THE STUDIO, St Giles House, Brook Farm, Llanmaes, Vale of Glamorgan,
CF61 2XR. - E mail: jones.jenkins@virgin.net, Tel: 01446 678422, Mob: 078 553311 28

This drg. & the works are the copyright of AJ Design Associates and may not be amended or re-produced without written permission. No liability will be accepted for amendments made by a third pt

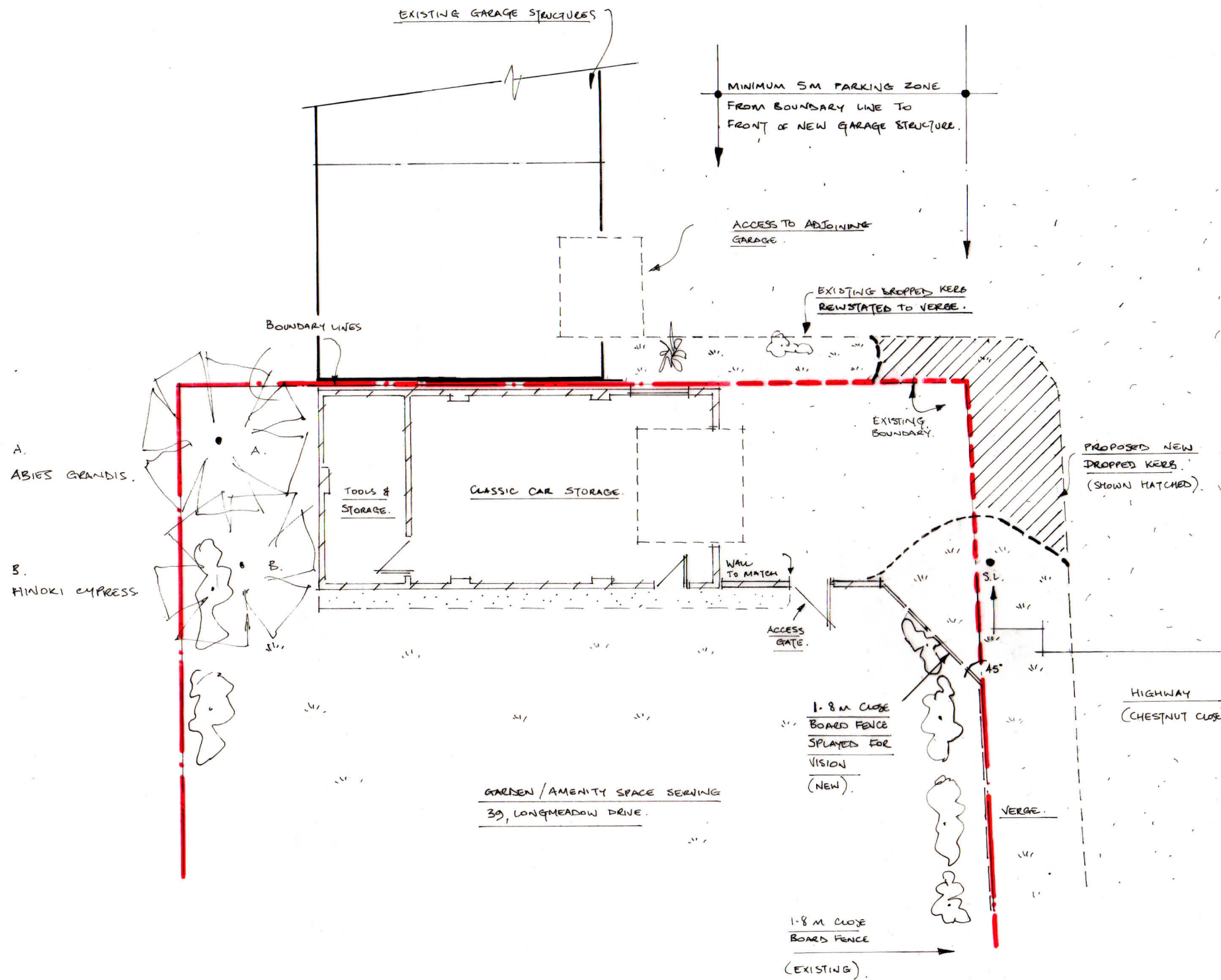

SITE LAYOUT

PLAN

SCALE 1:100

S.L. = EXISTING STREET LAMP.

N.B. AS AGREED WITH HIGHWAYS ENGINEER MR PETER COUGHAN ON THE 5th JULY 2017, IT IS PROPOSED TO LEAVE THE EXISTING STREET LAMP IN ITS CURRENT POSITION AS SHOWN, WITH DROPPED KERB AREA (SHOWN HATCHED) 1 METRE DISTANCE FROM S.L.

REVISION B - 2nd AUGUST 2017.

REVISION A - 17th JULY 2017.

Scale 1:100 @ A3 - DRG. 03.