



Tree Survey

At

Land at St. Nicholas

*Inspected by:-
Julian Wilkes BSc.For, MSc.Land Man, MIC.For, MArborA
Treescene Ltd
The Walled Garden
Old Coedarhydyglyn
St Nicholas
Cardiff
CF5 6SG
Tel No. 029 20599300*

9th February, 2015

Registered Office: Treescene Limited
The Walled Garden, Old Coedarhydyglyn, St Nicholas, Cardiff CF5 6SG
Tel. 029 205 99300 Fax. 029 205 92929 Email. trees@treescene.co.uk

I have been instructed by Grant Strong of Redrow Homes to carry out a survey on trees at Land at St. Nicholas.

Scope of Report

This Tree Survey has been undertaken within the recommendations of British Standards 5837:2012 and current good arboricultural practice.

The survey entailed a visual inspection from ground level of all trees.

Each tree has been numbered and, where instructed, for future identification on site, have been tagged using small durable metal or plastic tags.

Due to variations of existing ground levels through the site, height dimensions are estimated and are given in metres. Accurate heights, measured with the aid of optical instruments can be provided where instructed.

Trunk/stem diameters are measured at 1.5 metres above ground level, or immediately above the root flare for multi-stemmed trees.

Estimate branch spread is taken in metres from the centre of the trunk, at the four cardinal points of a compass, to achieve an accurate representation of crown shape.

An assessment of a tree's age classification is made in terms of its maturity within the site's landscape.

An assessment of a tree's physiological condition is to be made as good, fair, poor, dead.

Data on the structural condition of the tree should be entered, e.g., collapsing, leaning and the presence of any decay or physical defect should be noted.

Preliminary management recommendations include further investigation of suspected defects that require more detailed assessment and potential for wildlife habitat.

An assessment of a tree's future life expectancy is made as <10, 10-20, 20-40 or >40 etc.

Table 1 – Cascade chart for tree quality assessment

Category and definition	Criteria (including subcategories where appropriate)			BRITISH STANDARD BS 5837:2012
<p>Category U Those in such a condition that they cannot realistically be retained as living trees in the context of the current land use for longer than 10 years</p>	<ul style="list-style-type: none"> • Trees that have a serious, irremediable, structural defect, such that their early loss is expected due to collapse, including those that will become unviable after removal of other U category trees (i.e. where, for whatever reason, the loss of companion shelter cannot be mitigated by pruning) • Trees that are dead or are showing signs of significant, immediate, and irreversible overall decline • Trees infected with pathogens of significance to the health and/or safety of other trees nearby, or very low quality trees suppressing adjacent trees of better quality <p>NOTE Category U trees can have existing or potential conservation value which it might be desirable to preserve; see 4.5.7.</p>			
	1 Mainly arboricultural values	2 Mainly landscape values	3 Mainly cultural values, including conservation	
<p>Category A Those of high quality with an estimated remaining life expectancy of at least 40 years</p>	Trees that are particularly good examples of their species, especially if rare or unusual, or essential components of groups, or of formal or semi-formal arboricultural features (e.g. the dominant and/or principal trees within an avenue)	Trees, groups or woodlands of particular visual importance as arboricultural and/or landscape features	Trees, groups or woodlands of significant conservation; historical, commemorative or other value (e.g. veteran trees or wood-pasture)	
<p>Category B Those of moderate quality with an estimated remaining life expectancy of at least 20 years</p>	Trees that might be included in category A, but are downgraded because of impaired condition (e.g. presence of significant though remediable defects, including unsympathetic past management and storm damage), such that they are unlikely to be suitable for retention for beyond 40 years; or trees lacking the special quality necessary to merit the category A designation	Trees present in numbers, usually growing as groups or woodlands, such that they attract a higher collective rating than they might as individuals; or trees occurring as collectives but situated so as to make little visual contribution to the wider locality	Trees with material conservation or other cultural benefits	
<p>Category C Those of low quality with an estimated remaining life expectancy of at least 10 years, or young trees with a stem diameter below 150mm</p>	Unremarkable trees of very limited merit or such impaired condition that they do not qualify in higher categories	Trees present in groups or woodlands, but without this conferring on them significantly greater collective landscape value, and/or trees offering low or only temporary/transient landscape benefits	Trees with no material conservation or other cultural value	

G1 **Group of Hawthorn (*Crataegus monogyna*)**
Height 1.5m
Single/Multi stemmed Multi stemmed
Stem Diameter 0.1m
Branch Spread N – 1m
E – 1m
S – 1m
W – 1m
Height of Crown 0m
Age Young
Physiological Condition Fair to poor
Structural Condition Slightly gappy hedgerow established on boundary of site
Prel. Man. Recommendations Trim annual growth from top and sides
Est. Remaining Contribution 20-40
Category C

G2 **Group of Hawthorn (*Crataegus monogyna*)**
Height 2m
Single/Multi stemmed Multi stemmed
Stem Diameter 0.1m
Branch Spread N – 1m
E – 1m
S – 1m
W – 1m
Height of Crown 0m
Age Young
Physiological Condition Fair to poor
Structural Condition Slightly gappy hedgerow
Prel. Man. Recommendations Trim annual growth from top and sides
Est. Remaining Contribution 20-40
Category C2

T3 **Sycamore (*Acer pseudoplatanus*)**
Height 21m
Single/Multi stemmed Single stem
Stem Diameter >1.5m
Branch Spread N – 6m
E – 10m
S – 9m
W – 8m
Height of Crown 2m
Age Mature
Physiological Condition Fair to poor
Structural Condition Notable tree of variable form. Extensive basal decay which may lead to total tree failure if crown is not remediated.
Prel. Man. Recommendations Undertake 30% overall crown reduction. Monitor for stability.
Est. Remaining Contribution 20-40
Category C2

G4

Group of Hawthorn (*Crataegus monogyna*), Holly (*Ilex aquifolium*) and Elder (*Sambucus nigra*)

Height

3m

Single/Multi stemmed

Multi stemmed

Stem Diameter

0.3m

Branch Spread

N – 2m

E – 2m

S – 2m

W – 2m

Height of Crown

1m

Age

Middle aged

Physiological Condition

Fair to poor

Structural Condition

Slightly gappy hedgerow

Prel. Man. Recommendations

Trim annual growth from top and sides

Est. Remaining Contribution

20-40

Category

C2

G5

Group of Hawthorn (*Crataegus monogyna*), Elder (*Sambucus nigra*) and Holly (*Ilex aquifolium*)

Height

3m

Single/Multi stemmed

Single and multi stemmed

Stem Diameter

0.3m

Branch Spread

N – 1m

E – 1m

S – 1m

W – 1m

Height of Crown

0m

Age

Middle aged

Physiological Condition

Fair to poor

Structural Condition

Gappy hedgerow on boundary of site

Prel. Man. Recommendations

Trim annual growth from top and sides

Est. Remaining Contribution

20-40

Category

C2

T6

Eucalyptus (*Eucalyptus gunnii*)

Height

10m

Single/Multi stemmed

Single stem

Stem Diameter

0.65m

Branch Spread

N – 5m

E – 5m

S – 5m

W – 5m

Height of Crown

4m

Age

Mature

Physiological Condition

Poor

Structural Condition

Off-site tree thus preventing full inspection. Main stem divides at 2m leading to multi stemmed mid crown. Evidence of basal decay and die-back in upper crown.

Prel. Man. Recommendations

Remove

Est. Remaining Contribution

<10

Category

U

G7 **Group of Hawthorn (*Crataegus monogyna*), Holly (*Ilex aquifolium*) and Elder (*Sambucus nigra*)**

Height	3m
Single/Multi stemmed	Multi stemmed
Stem Diameter	0.3m
Branch Spread	N – 2m E – 2m S – 2m W – 2m
Height of Crown	1m
Age	Middle aged
Physiological Condition	Fair to poor
Structural Condition	Slightly gappy hedgerow
Prel. Man. Recommendations	Trim annual growth from top and sides
Est. Remaining Contribution	20-40
Category	C2

T8 **Oak (*Quercus robur*)**

Height	13m
Single/Multi stemmed	Single stem
Stem Diameter	0.65m
Branch Spread	N – 7m E – 7m S – 10m W – 9m
Height of Crown	2m
Age	Mature
Physiological Condition	Fair
Structural Condition	Tree of reasonable form with slight lean to south. Some poor quality pruning in lower crown. Some minor deadwood within crown.
Prel. Man. Recommendations	Prune to remove stubs in lower crown and major deadwood. Shorten any potentially end-weighted lateral branches by up to 2m to reduce risk of structural failure. Monitor for health.
Est. Remaining Contribution	>40
Category	B2

T9	Oak (Quercus robur)
Height	5m
Single/Multi stemmed	Single stem
Stem Diameter	0.38m
Branch Spread	N – 4m E – 4m S – 3m W – 0m
Height of Crown	2m
Age	Middle aged
Physiological Condition	Fair to poor
Structural Condition	Tree of poor form heavily suppressed by adjacent specimen. Evidence of minor animal damage at base of main stem on southern side.
Prel. Man. Recommendations	Crown raise to 2.5m. Prune to remove major deadwood. Monitor for health.
Est. Remaining Contribution Category	10-20 C
T10	Oak (Quercus robur)
Height	4m
Single/Multi stemmed	Single stem
Stem Diameter	0.6m
Branch Spread	N – 0m E – 0m S – 0m W – 12m
Height of Crown	0m
Age	Mature
Physiological Condition	Poor
Structural Condition	Partially collapsed specimen which has fallen into adjacent field to the north
Prel. Man. Recommendations	Dismantle
Est. Remaining Contribution Category	<10 U

T11	Oak (<i>Quercus robur</i>)
Height	18m
Single/Multi stemmed	Single stem
Stem Diameter	1.1m (estimate)
Branch Spread	N – 6m E – 10m S – 11m W – 10m
Height of Crown	3m
Age	Mature
Physiological Condition	Good to fair
Structural Condition	Notable specimen of good form with well-balanced crown. Some deadwood within crown. Off-site tree thus preventing full inspection and accurate measurement.
Prel. Man. Recommendations	Prune to remove major deadwood. Crown raise to 4m removing secondary branches only. Shorten any potentially end-weighted branches extending over site by 2-3m to reduce risk of branch failure. Monitor for health.
Est. Remaining Contribution	>40
Category	B2
T12	Holly (<i>Ilex aquifolium</i>)
Height	7m
Single/Multi stemmed	Multi stemmed
Stem Diameter	0.35m
Branch Spread	N – 1m E – 3m S – 1m W – 2m
Height of Crown	0m
Age	Middle aged
Physiological Condition	Fair
Structural Condition	Multi stemmed specimen of reasonable form
Prel. Man. Recommendations	Sever ivy at base
Est. Remaining Contribution	>40
Category	B

T13	Ash (<i>Fraxinus excelsior</i>)
Height	11m
Single/Multi stemmed	Single stem
Stem Diameter	0.27m
Branch Spread	N – 3m E – 3m S – 3m W – 3m
Height of Crown	3m
Age	Middle aged
Physiological Condition	Fair
Structural Condition	Tree of reasonable form. Main stem divides at 2m leading to twin stemmed mid crown.
Prel. Man. Recommendations	No action required at this time
Est. Remaining Contribution	20-40
Category	B2

T14	Hazel (<i>Corylus avellana</i>)
Height	5m
Single/Multi stemmed	Multi stemmed
Stem Diameter	0.45m
Branch Spread	N – 2m E – 2m S – 2m W – 3m
Height of Crown	2m
Age	Middle aged
Physiological Condition	Fair to poor
Structural Condition	Multi stemmed coppice stool of variable form
Prel. Man. Recommendations	No action required at this time
Est. Remaining Contribution	20-40
Category	C

G15	Group of Hazel (<i>Corylus avellana</i>), Holly (<i>Ilex aquifolium</i>), Hawthorn (<i>Crataegus monogyna</i>) and Blackthorn (<i>Prunus spinosa</i>)
Height	Up to 6m
Single/Multi stemmed	Single and multi stemmed
Stem Diameter	Up to 0.4m
Branch Spread	N – 2m E – 2m S – 2m W – 2m
Height of Crown	1m
Age	Middle aged
Physiological Condition	Fair to poor
Structural Condition	Gappy hedgerow established on boundary of site. Some deadwood within crowns.
Prel. Man. Recommendations	Prune to remove major deadwood
Est. Remaining Contribution	20-40
Category	C

T16	Ash (<i>Fraxinus excelsior</i>)
Height	14m
Single/Multi stemmed	Multi stemmed
Stem Diameter	0.6m
Branch Spread	N – 8m E – 7m S – 7m W – 8m
Height of Crown	4m
Age	Mature
Physiological Condition	Fair to poor
Structural Condition	Tree of variable form. Old hedgerow stub that has produced two up-right stems. Extensive deadwood throughout crown.
Prel. Man. Recommendations	Prune to remove major deadwood. Monitor for safety.
Est. Remaining Contribution	20-40
Category	C2
G17	Group of Holly (<i>Ilex aquifolium</i>), Hazel (<i>Corylus avellana</i>), Hawthorn (<i>Crataegus monogyna</i>) and Blackthorn (<i>Prunus spinosa</i>)
Height	Up to 6m
Single/Multi stemmed	Single and multi stemmed
Stem Diameter	0.35m
Branch Spread	N – 2m E – 2m S – 1m W – 2m
Height of Crown	0m
Age	Mature
Physiological Condition	Fair to poor
Structural Condition	Gappy hedgerow established on boundary of site
Prel. Man. Recommendations	Trim annual growth from top and sides
Est. Remaining Contribution	20-40
Category	C2
G18	Group of Hawthorn (<i>Crataegus monogyna</i>)
Height	8m
Single/Multi stemmed	Multi stemmed
Stem Diameter	0.4m
Branch Spread	N – 2m E – 2m S – 3m W – 3m
Height of Crown	1m
Age	Mature
Physiological Condition	Fair to poor
Structural Condition	Trees generally of poor form. Some stems leaning extensively to west into site.
Prel. Man. Recommendations	Remove excessively leaning stems. Crown raise remaining trees to 3.5m. Monitor for health.
Est. Remaining Contribution	10-20
Category	C2

G19

Group of Hawthorn (*Crataegus monogyna*), Holly (*Ilex aquifolium*) and Blackthorn (*Prunus spinosa*)

Height

Up to 8m

Single/Multi stemmed

Multi stemmed

Stem Diameter

0.45m

Branch Spread

N – 2m

E – 3m

S – 2m

W – 3m

Height of Crown

1m

Age

Mature

Physiological Condition

Fair to poor

Structural Condition

Trees generally of variable form. Some Hawthorns have extensive deadwood throughout crowns.

Prel. Man. Recommendations

Prune to remove major deadwood. Crown raise to 3.5m over site.

Est. Remaining Contribution

10-20

Category

C2

T20

Plum (*Prunus* spp)

Height

6m

Single/Multi stemmed

Single stem

Stem Diameter

0.28m

Branch Spread

N – 5m

E – 2m

S – 0m

W – 1m

Height of Crown

3m

Age

Mature

Physiological Condition

Poor

Structural Condition

Tree of poor form with extensive basal decay. This specimen is at risk of failure.

Prel. Man. Recommendations

Remove

Est. Remaining Contribution

<10

Category

U

T21

Crab-apple (*Malus* spp)

Height

9m

Single/Multi stemmed

Multi stemmed

Stem Diameter

0.9m

Branch Spread

N – 6m

E – 5m

S – 6m

W – 4m

Height of Crown

3m

Age

Mature

Physiological Condition

Poor

Structural Condition

Tree of poor form with extensive basal decay. This specimen is at risk of failure.

Prel. Man. Recommendations

Remove

Est. Remaining Contribution

<10

Category

U

T22	Plum (Prunus spp)
Height	6m
Single/Multi stemmed	Multi stemmed
Stem Diameter	0.35m
Branch Spread	N – 2m E – 2m S – 2m W – 2m
Height of Crown	2m
Age	Middle aged
Physiological Condition	Fair to poor
Structural Condition	Tree of variable form
Prel. Man. Recommendations	Monitor for stability
Est. Remaining Contribution	10-20
Category	C
T23	Ash (Fraxinus excelsior)
Height	13m
Single/Multi stemmed	Multi stemmed
Stem Diameter	0.65m
Branch Spread	N – 4m E – 2m S – 7m W – 4m
Height of Crown	4m
Age	Mature
Physiological Condition	Poor
Structural Condition	Twin stemmed specimen of poor form with extensive basal decay. This specimen is at risk of failure.
Prel. Man. Recommendations	Remove
Est. Remaining Contribution	<10
Category	U
G24	Group of Blackthorn (Prunus spinosa), Hawthorn (Crataegus monogyna) and Elder (Sambucus nigra)
Height	3m
Single/Multi stemmed	Multi stemmed
Stem Diameter	0.25m
Branch Spread	N – 1m E – 1m S – 1m W – 1m
Height of Crown	0m
Age	Middle aged
Physiological Condition	Fair to poor
Structural Condition	Scrubby specimens forming gappy hedgerow
Prel. Man. Recommendations	No action required at this time
Est. Remaining Contribution	10-20
Category	C

T25	Hawthorn (<i>Crataegus monogyna</i>)
Height	5m
Single/Multi stemmed	Multi stemmed
Stem Diameter	0.5m
Branch Spread	N – 2m E – 2m S – 2m W – 2m
Height of Crown	2m
Age	Mature
Physiological Condition	Fair to poor
Structural Condition	Tree of variable form with crown heavily colonised by ivy thus preventing full inspection
Prel. Man. Recommendations	Sever ivy at base. Prune to remove major deadwood.
Est. Remaining Contribution	10-20
Category	C

T26	Hawthorn (<i>Crataegus monogyna</i>)
Height	7m
Single/Multi stemmed	Multi stemmed
Stem Diameter	0.5m
Branch Spread	N – 3m E – 3m S – 3m W – 4m
Height of Crown	3m
Age	Mature
Physiological Condition	Fair
Structural Condition	Hedgerow tree of reasonable form
Prel. Man. Recommendations	Prune to remove major deadwood
Est. Remaining Contribution	>40
Category	B2

T27	Holly (<i>Ilex aquifolium</i>)
Height	6m
Single/Multi stemmed	Multi stemmed
Stem Diameter	0.4m
Branch Spread	N – 2m E – 3m S – 1m W – 2m
Height of Crown	0m
Age	Middle aged
Physiological Condition	Fair to poor
Structural Condition	Multi stemmed specimen of variable form with most of the crown heavily suppressed by dense ivy
Prel. Man. Recommendations	Remove main stems and allow epicormic shoots at base to develop into bushy hedgerow
Est. Remaining Contribution	10-20
Category	C

T28	Hazel (<i>Corylus avellana</i>)
Height	4m
Single/Multi stemmed	Multi stemmed
Stem Diameter	0.4m
Branch Spread	N – 1m E – 1m S – 1m W – 1m
Height of Crown	1m
Age	Mature
Physiological Condition	Fair to poor
Structural Condition	Multi stemmed coppice stool of variable form
Prel. Man. Recommendations	No action required at this time
Est. Remaining Contribution	20-40
Category	C2

T29	Holly (<i>Ilex aquifolium</i>)
Height	5m
Single/Multi stemmed	Multi stemmed
Stem Diameter	0.35m
Branch Spread	N – 1m E – 1m S – 1m W – 1m
Height of Crown	1m
Age	Middle aged
Physiological Condition	Poor
Structural Condition	Tree of poor form with extensive die-back throughout crown
Prel. Man. Recommendations	Remove
Est. Remaining Contribution	<10
Category	U

T30	Holly (<i>Ilex aquifolium</i>)
Height	5m
Single/Multi stemmed	Multi stemmed
Stem Diameter	0.35m
Branch Spread	N – 1m E – 3m S – 3m W – 1m
Height of Crown	0m
Age	Middle aged
Physiological Condition	Fair to poor
Structural Condition	Tree of variable form. Upper crown has died back.
Prel. Man. Recommendations	Reduce main stems to 2m in height to allow epicormic shoots at base to develop into bushy hedgerow
Est. Remaining Contribution	10-20
Category	C2

T31	Hawthorn (<i>Crataegus monogyna</i>)
Height	5m
Single/Multi stemmed	Multi stemmed
Stem Diameter	0.35m
Branch Spread	N – 2m E – 3m S – 3m W – 2m
Height of Crown	2m
Age	Mature
Physiological Condition	Fair to poor
Structural Condition	Multi stemmed specimen of variable form. Some stems are dead or dying.
Prel. Man. Recommendations	Remove dead or dying stems. Remove major deadwood. Sever ivy at base. Monitor for health.
Est. Remaining Contribution Category	10-20 C2

G32	Group of Holly (<i>Ilex aquifolium</i>)
Height	6m
Single/Multi stemmed	Multi stemmed
Stem Diameter	0.35m
Branch Spread	N – 2m E – 1m S – 2m W – 2m
Height of Crown	0m
Age	Middle aged
Physiological Condition	Fair to poor
Structural Condition	Scrubby specimens of variable form
Prel. Man. Recommendations	No action required at this time
Est. Remaining Contribution Category	20-40 C2

G33	Group of Holly (<i>Ilex aquifolium</i>) and Hazel (<i>Corylus avellana</i>)
Height	Up to 10m
Single/Multi stemmed	Single and multi stemmed
Stem Diameter	Up to 0.35m
Branch Spread	N – 2m E – 1m S – 2m W – 1m
Height of Crown	0m
Age	Middle aged
Physiological Condition	Fair
Structural Condition	Multi stemmed specimens of reasonable form
Prel. Man. Recommendations	No action required at this time
Est. Remaining Contribution Category	20-40 B2

T34	Hazel (<i>Corylus avellana</i>)
Height	5m
Single/Multi stemmed	Multi stemmed
Stem Diameter	0.4m
Branch Spread	N – 2m E – 3m S – 2m W – 2m
Height of Crown	2m
Age	Middle aged
Physiological Condition	Fair to poor
Structural Condition	Multi stemmed coppice stool of variable form
Prel. Man. Recommendations	No action required at this time
Est. Remaining Contribution	20-40
Category	C

T35	Hawthorn (<i>Crataegus monogyna</i>)
Height	6m
Single/Multi stemmed	Multi stemmed
Stem Diameter	0.4m
Branch Spread	N – 3m E – 4m S – 2m W – 1m
Height of Crown	1m
Age	Mature
Physiological Condition	Fair to poor
Structural Condition	Tree of variable form with crown more heavily developed on eastern side
Prel. Man. Recommendations	No action required at this time
Est. Remaining Contribution	20-40
Category	C2

T36	Ash (<i>Fraxinus excelsior</i>)
Height	10m
Single/Multi stemmed	Single stem
Stem Diameter	0.43m
Branch Spread	N – 6m E – 0m S – 0m W – 4m
Height of Crown	3m
Age	Middle aged
Physiological Condition	Poor
Structural Condition	Tree of poor form with extensive basal decay. This specimen is unsafe for retention.
Prel. Man. Recommendations	Remove
Est. Remaining Contribution	<10
Category	U

T37

Height

Single/Multi stemmed

Stem Diameter

Branch Spread

Height of Crown

Age

Physiological Condition

Structural Condition

Prel. Man. Recommendations

Est. Remaining Contribution

Category

T38

Height

Single/Multi stemmed

Stem Diameter

Branch Spread

Height of Crown

Age

Physiological Condition

Structural Condition

Prel. Man. Recommendations

Est. Remaining Contribution

Category

Sycamore (*Acer pseudoplatanus*)

18m

Multi stemmed

0.75m

N – 8m

E – 7m

S – 5m

W – 6m

3m

Mature

Poor

Twin stemmed specimen of reasonable form. Extensive basal decay resulting from severe animal damage. Evidence of decay on main stems at approximately 3m. This specimen is unsafe for retention.

Remove

<10

U

Ash (*Fraxinus excelsior*)

17m

Multi stemmed

0.75m

N – 0m

E – 8m

S – 8m

W – 7m

3m

Mature

Poor

Twin stemmed specimen of variable form with extensive basal decay associated with historical animal damage. This specimen is unsafe for retention.

Remove

<10

U

T39	Apple (<i>Malus spp</i>)
Height	8m
Single/Multi stemmed	Single stem
Stem Diameter	0.36m
Branch Spread	N – 0m E – 5m S – 3m W – 4m
Height of Crown	3m
Age	Mature
Physiological Condition	Fair to poor
Structural Condition	Tree of variable form slightly suppressed by adjacent specimen. Main stem and mid crown heavily colonised by ivy this preventing full inspection.
Prel. Man. Recommendations	Undertake 20% overall crown reduction. Sever ivy at base. Monitor for safety.
Est. Remaining Contribution Category	10-20 C

T40	Hawthorn (<i>Crataegus monogyna</i>)
Height	5m
Single/Multi stemmed	Multi stemmed
Stem Diameter	0.35m
Branch Spread	N – 1m E – 3m S – 1m W – 1m
Height of Crown	1m
Age	Mature
Physiological Condition	Fair to poor
Structural Condition	Hedgerow tree of variable form
Prel. Man. Recommendations	No action required at this time
Est. Remaining Contribution Category	10-20 C

T41	Hawthorn (<i>Crataegus monogyna</i>)
Height	5m
Single/Multi stemmed	Multi stemmed
Stem Diameter	0.35m
Branch Spread	N – 1m E – 2m S – 2m W – 2m
Height of Crown	2m
Age	Mature
Physiological Condition	Fair to poor
Structural Condition	Tree of variable form. Some deadwood within crown.
Prel. Man. Recommendations	Prune to remove major deadwood
Est. Remaining Contribution Category	10-20 C

T42 Hawthorn**Height****Single/Multi stemmed****Stem Diameter****Branch Spread****Height of Crown****Age****Physiological Condition****Structural Condition****Prel. Man. Recommendations****Est. Remaining Contribution****Category****(Crataegus monogyna)**

6m

Multi stemmed

0.35m

N – 2m

E – 2m

S – 1m

W – 3m

3m

Mature

Fair to poor

Twin stemmed specimen of variable form. Some deadwood in lower crown. Main stems heavily colonised by ivy this preventing full inspection.

Crown raise to 3.5m. Prune to remove major deadwood. Sever ivy at base.

10-20

C

T43**Height****Single/Multi stemmed****Stem Diameter****Branch Spread****Height of Crown****Age****Physiological Condition****Structural Condition****Prel. Man. Recommendations****Est. Remaining Contribution****Category****Hawthorn (Crataegus monogyna)**

4m

Multi stemmed

0.35m

N – 1m

E – 2m

S – 1m

W – 2m

3m

Mature

Fair to poor

Twin stemmed specimen of variable form. Some poor quality pruning adjacent to overhead cable. Main stems and mid crown heavily colonised by ivy thus preventing full inspection.

Sever ivy at base. Prune to remove major deadwood.

10-20

C

T44	Ash (<i>Fraxinus excelsior</i>)
Height	16m
Single/Multi stemmed	Multi stemmed
Stem Diameter	0.8m
Branch Spread	N – 9m E – 7m S – 6m W – 5m
Height of Crown	2m
Age	Mature
Physiological Condition	Poor
Structural Condition	Tree of variable form with extensive basal decay. This specimen is unsafe for retention.
Prel. Man. Recommendations	Remove
Est. Remaining Contribution	<10
Category	U

T45	Ash (<i>Fraxinus excelsior</i>)
Height	16m
Single/Multi stemmed	Single stem
Stem Diameter	0.55m
Branch Spread	N – 3m E – 4m S – 6m W – 5m
Height of Crown	3m
Age	Mature
Physiological Condition	Fair to poor
Structural Condition	Tree of variable form with crown more heavily developed on southern side due to suppression by adjacent specimen. Evidence of animal damage at base of main stem. Main stem colonised by ivy thus preventing full inspection. Evidence of poor quality pruning in lower crown.
Prel. Man. Recommendations	Undertake 25% overall crown reduction. Prune to remove storm damaged branches and deadwood. Monitor for safety.
Est. Remaining Contribution	10-20
Category	C

G46	Group of Leyland Cypress (<i>Cupressocyparis leylandii</i>)
Height	2m
Single/Multi stemmed	Single stem
Stem Diameter	0.15m
Branch Spread	N – 1m E – 1m S – 1m W – 1m
Height of Crown	0m
Age	Young
Physiological Condition	Fair to poor
Structural Condition	Conifer hedge on boundary of garden
Prel. Man. Recommendations	Trim annual growth from top and sides
Est. Remaining Contribution	10-20
Category	C

G47	Group of Privet (<i>Ligustrum</i>) and Hazel (<i>Corylus avellana</i>)
Height	4m
Single/Multi stemmed	Multi stemmed
Stem Diameter	0.3m
Branch Spread	N – 1m E – 3m S – 1m W – 1m
Height of Crown	1m
Age	Middle aged
Physiological Condition	Fair to poor
Structural Condition	Gappy hedgerow sited on boundary of garden. Some stems partially collapsed and leaning to east.
Prel. Man. Recommendations	Prune to remove excessively leaning stems
Est. Remaining Contribution	10-20
Category	C

T48	Cedar of Lebanon (<i>Cedrus libani</i>)
Height	17m
Single/Multi stemmed	Single stem
Stem Diameter	0.7m (estimate)
Branch Spread	N – 6m E – 7m S – 7m W – 6m
Height of Crown	3m
Age	Mature
Physiological Condition	Fair
Structural Condition	Tree of good form with well-balanced crown. Some storm damage in lower crown.
Prel. Man. Recommendations	Prune to remove storm damaged branches. Monitor for safety.
Est. Remaining Contribution	>40
Category	B2

G49	Group of Privet (<i>Ligustrum</i>) and Hawthorn (<i>Crataegus monogyna</i>)
Height	1m
Single/Multi stemmed	Multi stemmed
Stem Diameter	0.15m
Branch Spread	N – 1m E – 1m S – 1m W – 1m
Height of Crown	0m
Age	Middle aged
Physiological Condition	Fair to poor
Structural Condition	Gappy hedgerow on boundary of garden
Prel. Man. Recommendations	Trim annual growth from top and sides
Est. Remaining Contribution	10-20
Category	C
G50	Group of Elder (<i>Sambucus nigra</i>) and Hawthorn (<i>Crataegus monogyna</i>)
Height	2m
Single/Multi stemmed	Multi stemmed
Stem Diameter	0.1m
Branch Spread	N – 1m E – 1m S – 1m W – 1m
Height of Crown	0m
Age	Middle aged
Physiological Condition	Fair to poor
Structural Condition	Gappy hedgerow on raised bank
Prel. Man. Recommendations	Trim annual growth from top and sides
Est. Remaining Contribution	10-20
Category	C
T51	Norway Maple (<i>Acer platanoides</i>)
Height	5m
Single/Multi stemmed	Single stem
Stem Diameter	0.25m
Branch Spread	N – 3m E – 3m S – 3m W – 3m
Height of Crown	2m
Age	Young
Physiological Condition	Fair
Structural Condition	Young specimen of reasonable form
Prel. Man. Recommendations	No action required at this time
Est. Remaining Contribution	>40
Category	B

T52

DEAD

T53

Cherry (*Prunus app*)

Height

5m

Single/Multi stemmed

Single stem

Stem Diameter

0.51m

Branch Spread

N - 4m

E - 4m

S - 5m

W - 3m

Height of Crown

2m

Age

Mature

Physiological Condition

Fair to poor

Structural Condition

Tree of variable form. Some storm damage in lower crown may have led to commencement of basal decay.

Prel. Man. Recommendations

Crown raise to 2.5m. Monitor for health.

Est. Remaining Contribution

10-20

Category

C

G54

Group of 2 Himalayan Birch (*Betula jacquemontii*)

Height

5m

Single/Multi stemmed

Single stem

Stem Diameter

0.15m

Branch Spread

N - 2m

E - 2m

S - 2m

W - 2m

Height of Crown

2m

Age

Young

Physiological Condition

Fair

Structural Condition

Young specimens of reasonable form

Prel. Man. Recommendations

Crown raise to 2.5m

Est. Remaining Contribution

20-40

Category

B

T55	Sycamore (Acer pseudoplatanus)
Height	17m
Single/Multi stemmed	Single stem
Stem Diameter	0.92m
Branch Spread	N – 6m E – 7m S – 7m W – 7m
Height of Crown	4m
Age	Mature
Physiological Condition	Fair
Structural Condition	Tree of reasonable form. Main stem divides at 2m leading to twin stemmed mid crown. Evidence of slight bulging at base due to restrictions of stem growth adjacent to tarmac pavement. Rooting of this specimen is likely to be restricted in all directions due to associated hard surfaces and change in levels. Some mild decay at lower fork associated with old pruning wound.
Prel. Man. Recommendations	No action required at this time
Est. Remaining Contribution	20-40
Category	B2

Recommendations for Tree Protection during Development

Due to the high risk to established trees we would recommend the installation of protective fencing prior to commencement of **any** works on site in accordance with BS 5837:2012 "Trees in relation to Construction". Trees should be protected using scaffold frame supporting weld mesh panel fencing sited on the edge of the Root Protection Area as defined in BS5837:2012. These fenced areas should not be used for the storage of any plant machinery or materials and personnel should be excluded at all times; these fences should remain in situ until after final landscaping has been carried out, removed by hand with great care to prevent compaction or root damage to established trees. The services of a suitably qualified arborist should be sought **prior** to the commencement of each stage.

Figure 2 Default specification for protective barrier

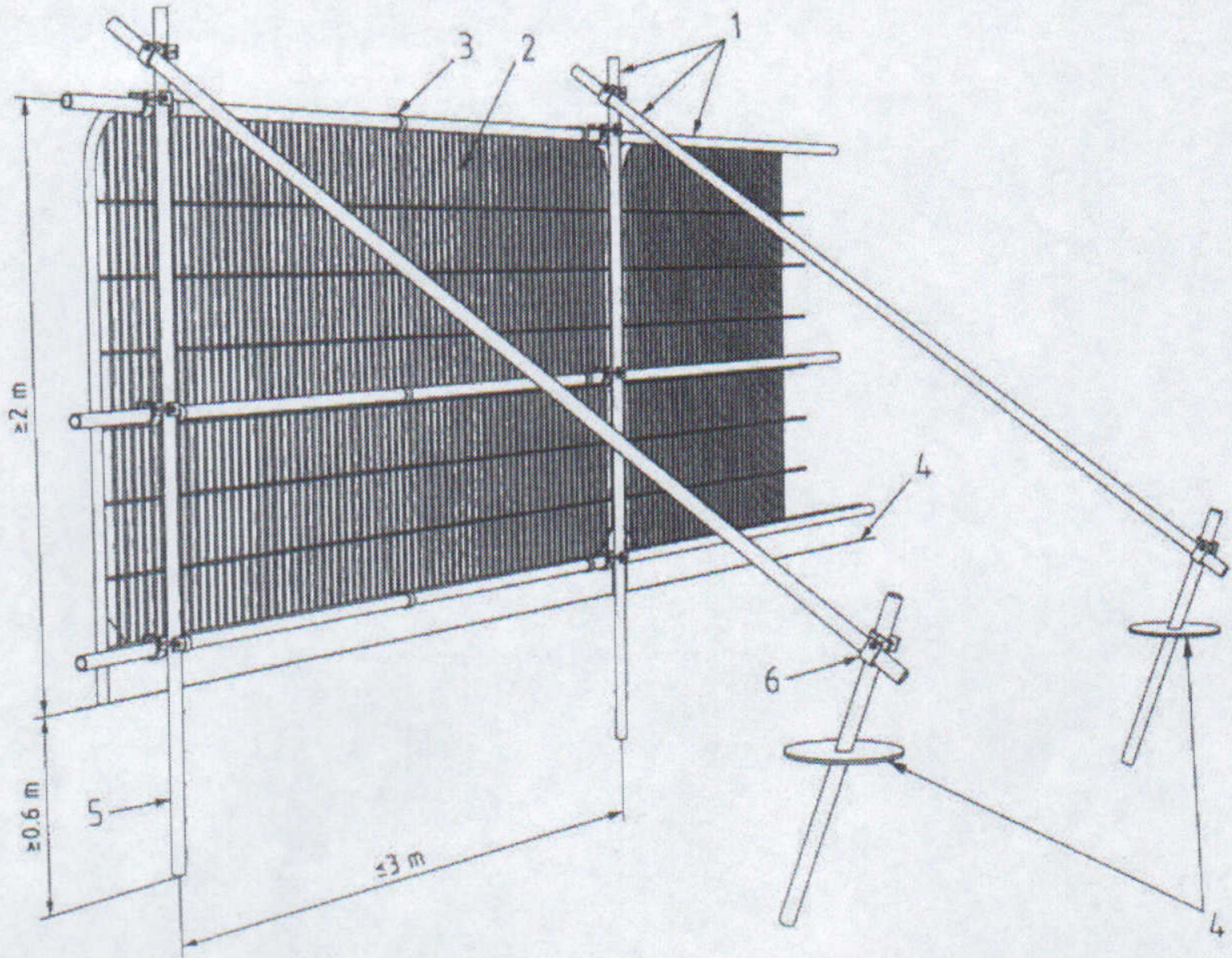

Key

- 1 Standard scaffold poles
- 2 Heavy gauge 2 m tall galvanized tube and welded mesh infill panels
- 3 Panels secured to uprights and cross-members with wire ties
- 4 Ground level
- 5 Uprights driven into the ground until secure (minimum depth 0.6 m)
- 6 Standard scaffold clamps

St. Nicholas

Tree Constraints Plan



Tree Constraints Plan

Root Protection Area
Tree Category
Tree Number
Canopy Spread

Category A Trees
Category B Trees
Category C Trees
Category U Trees

St. Nicholas

Tree Constraints Plan

Tree Constraints Plan

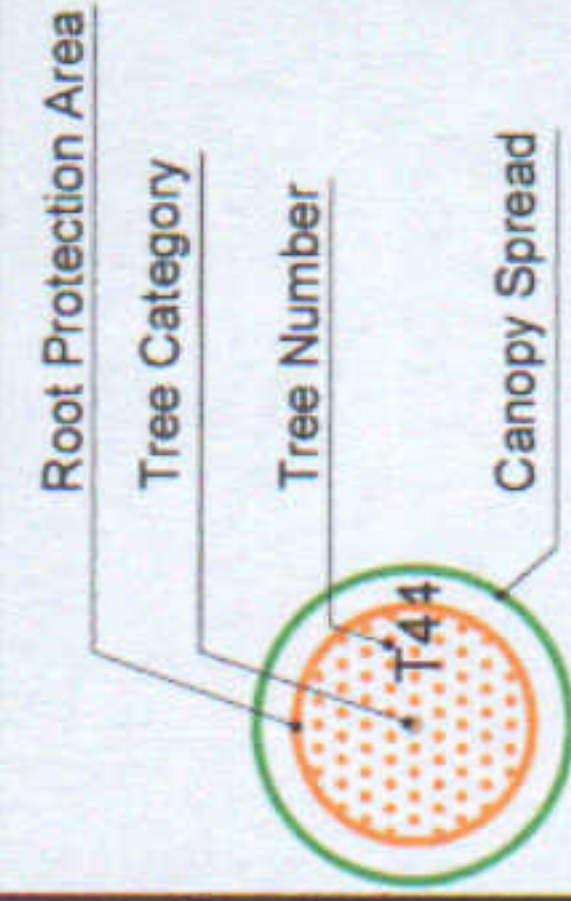

- Category A Trees
- Category B Trees
- Category C Trees
- Category U Trees

Scale 1: 600 @ A3
02/2015

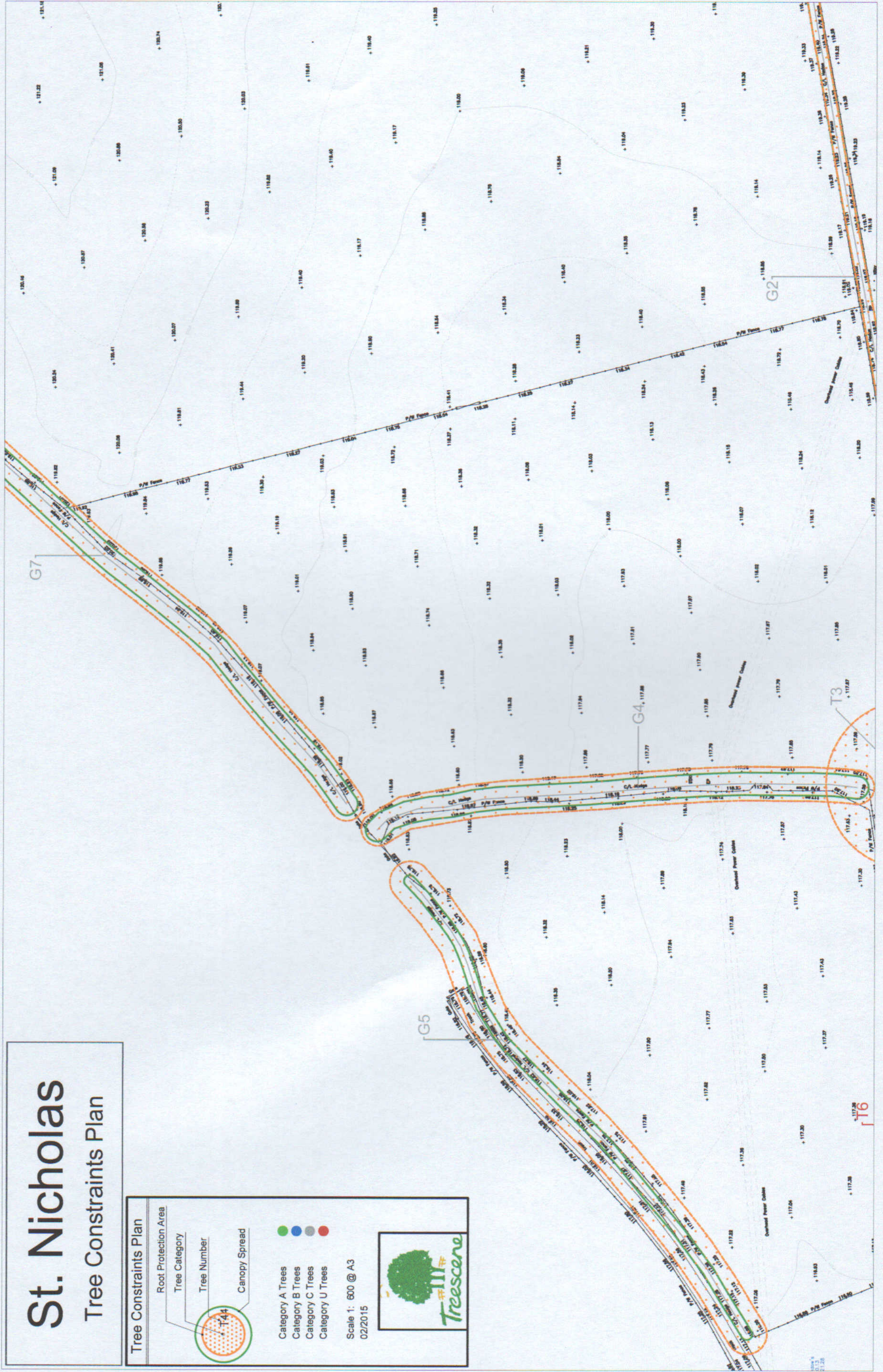

St. Nicholas

Tree Constraints Plan

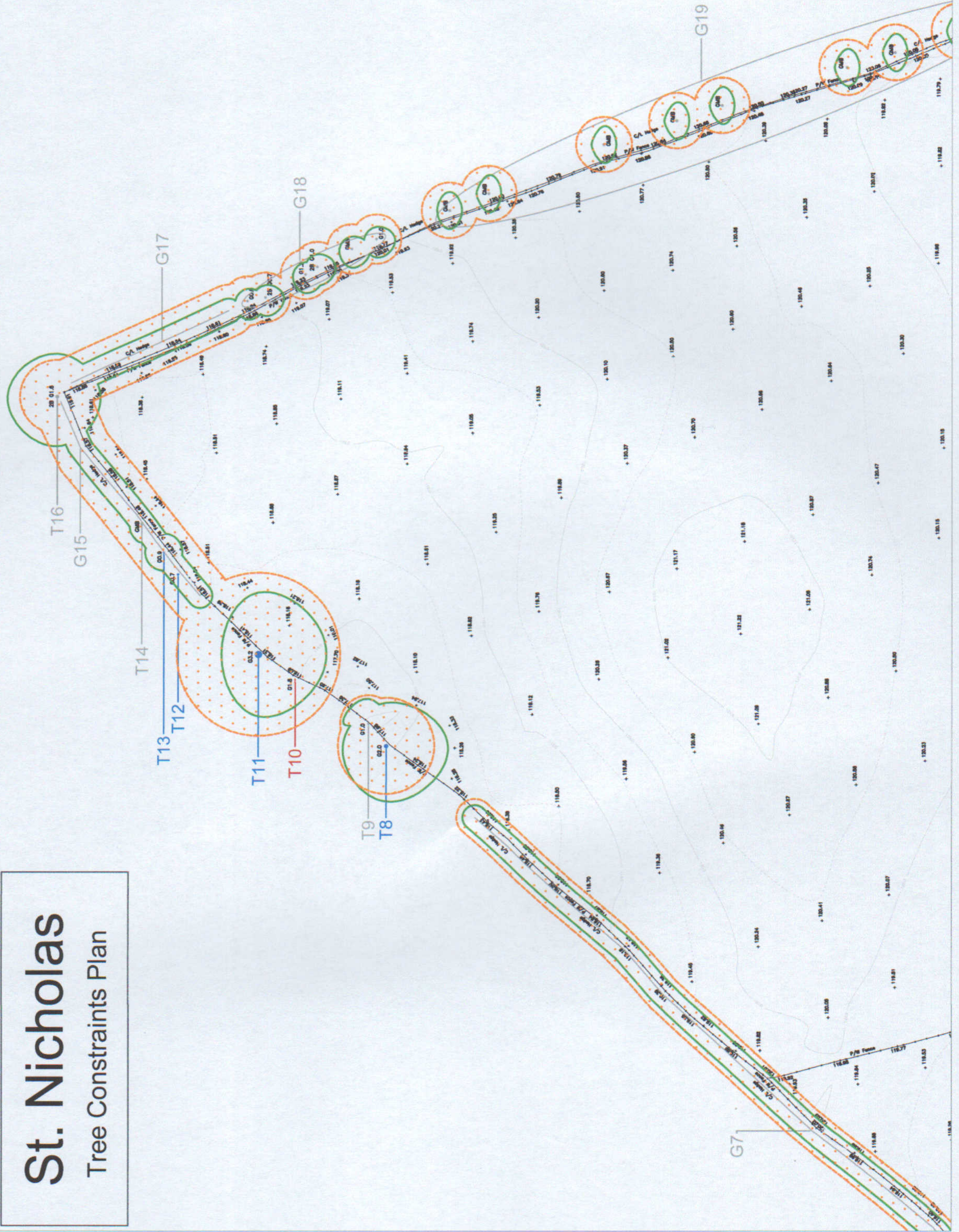

Tree Constraints Plan

- Root Protection Area
- Tree Category
- Tree Number
- Canopy Spread

● Category A Trees
● Category B Trees
● Category C Trees
● Category U Trees

Scale 1: 600 @ A3
02/2015



St. Nicholas Tree Constraints Plan

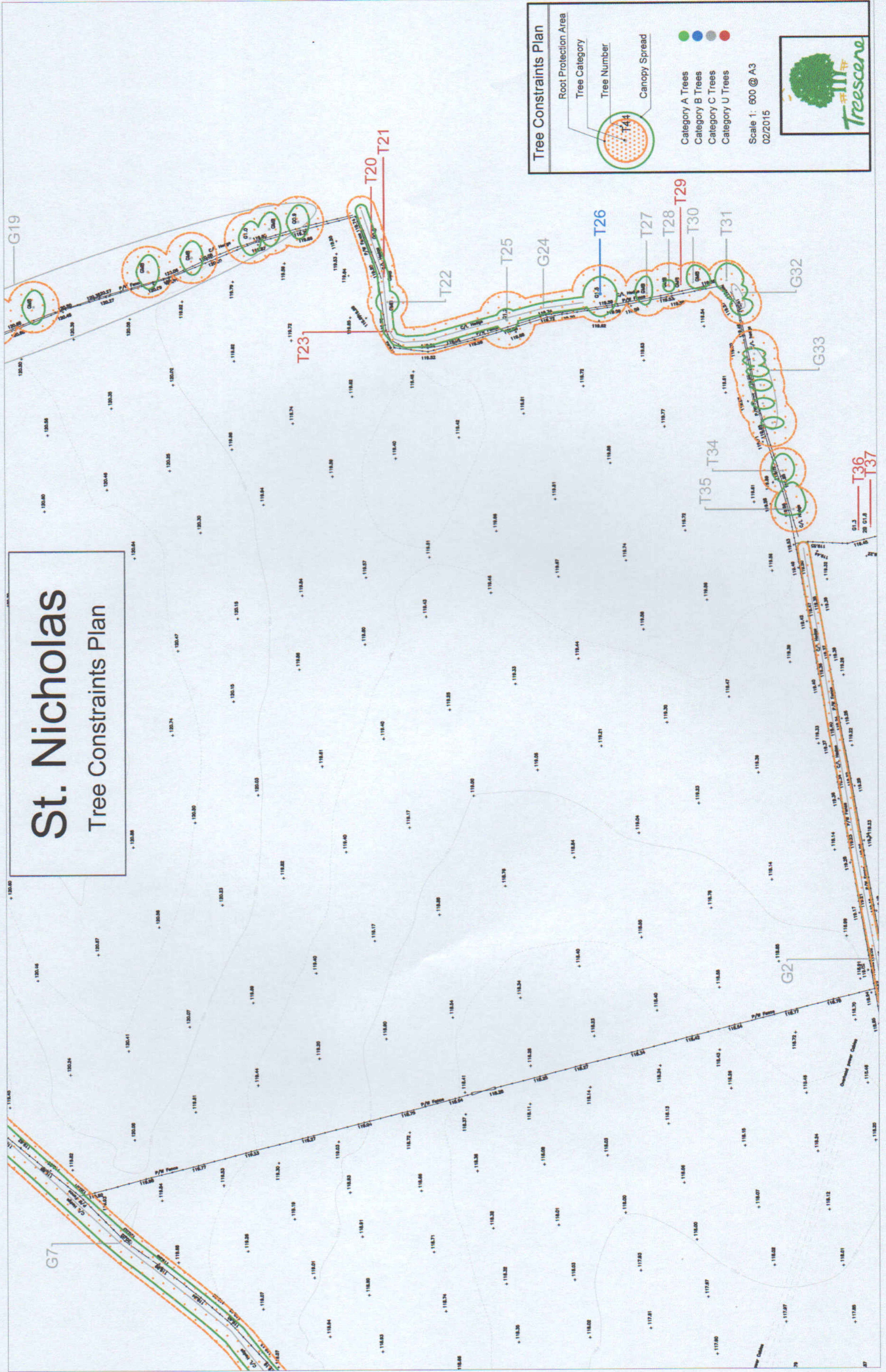

Tree Constraints Plan

Root Protection Area
Tree Category
Tree Number
Canopy Spread

Category A Trees
Category B Trees
Category C Trees
Category U Trees

Scale 1: 600 @ A3
02/2015

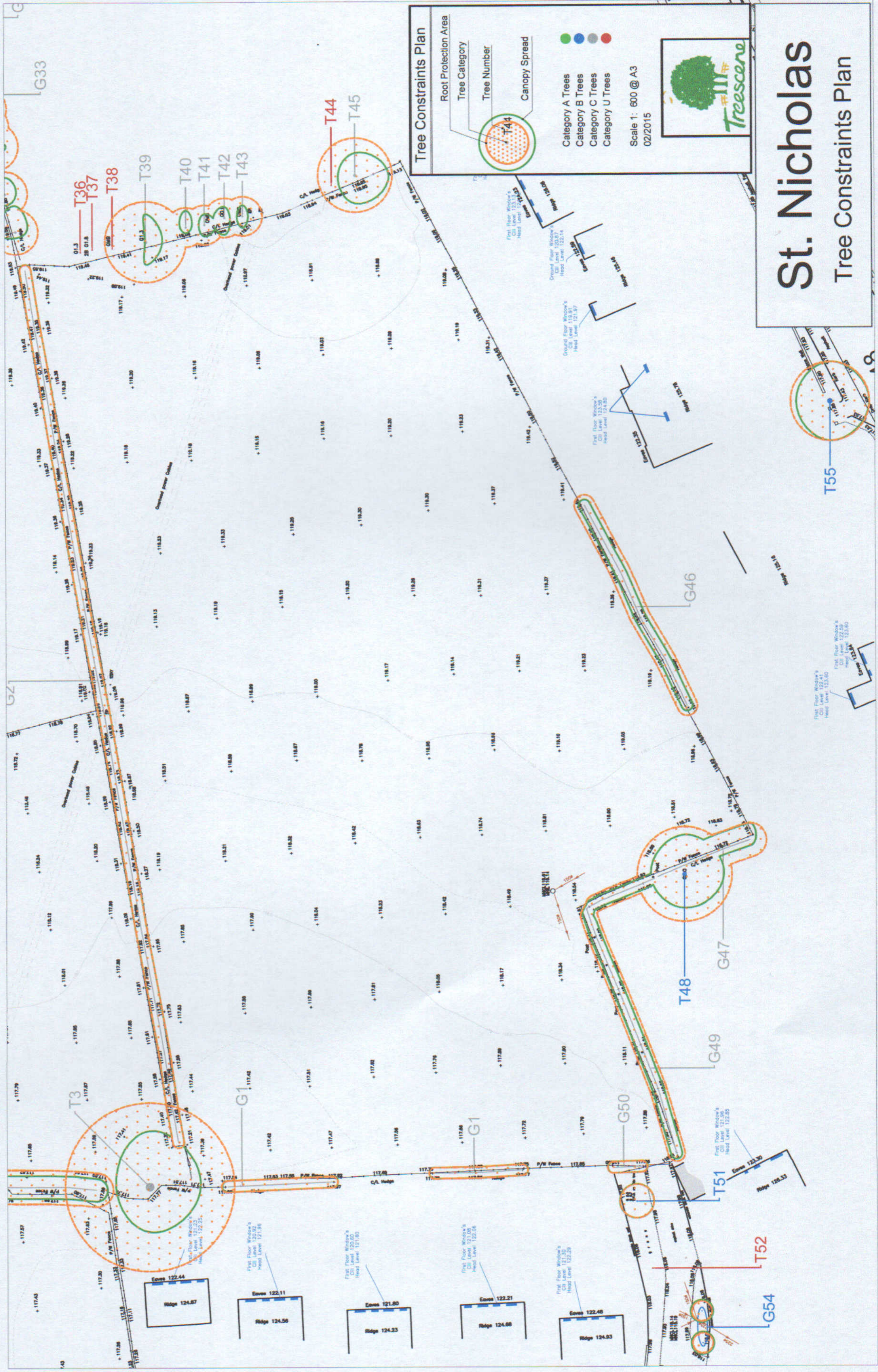

St. Nicholas

Tree Constraints Plan



Scale 1: 600 @ A3
02/2015

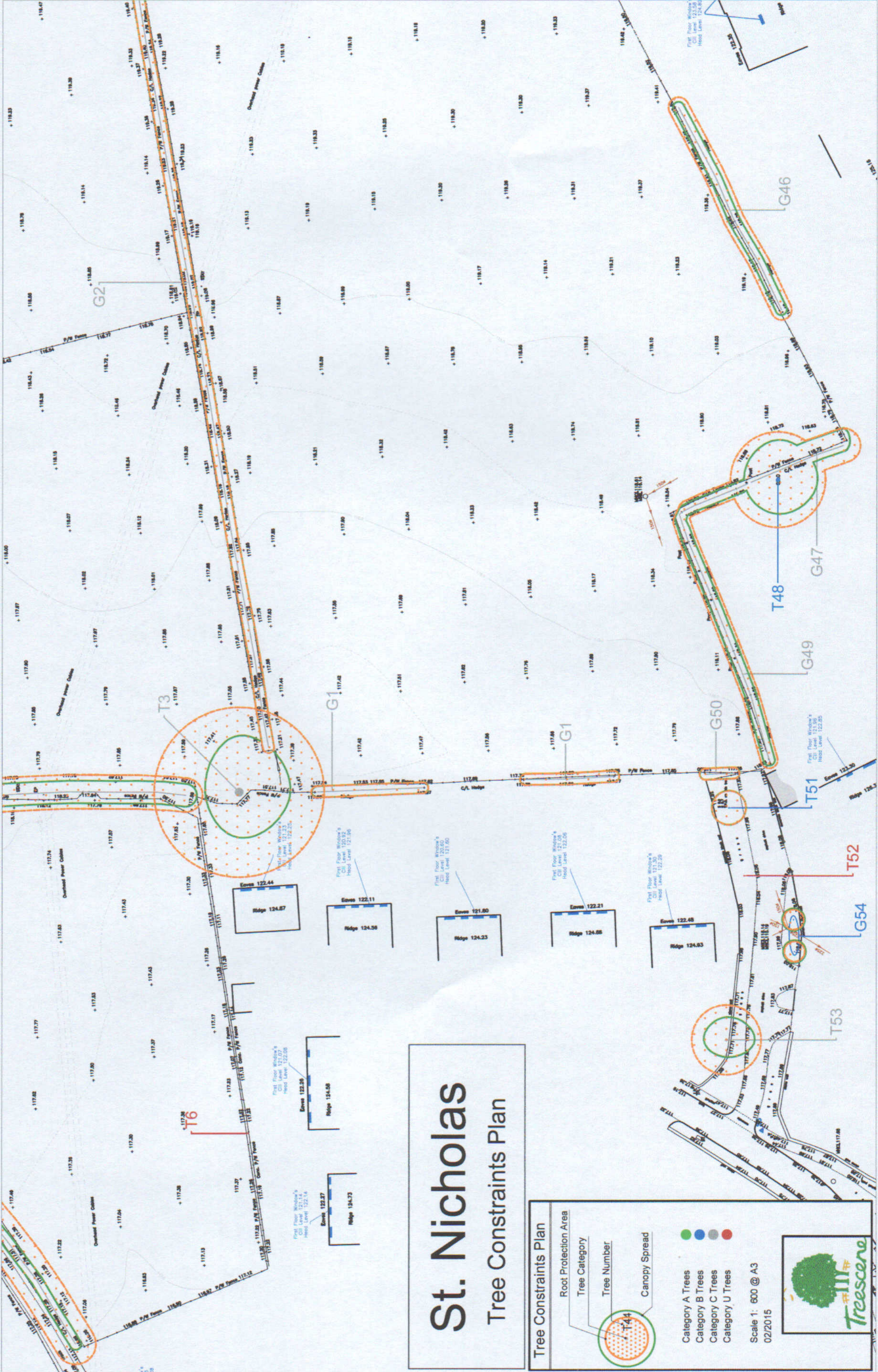

St. Nicholas

Tree Constraints Plan

Tree Constraints Plan

- Root Protection Area
- Tree Category
- Tree Number
- Canopy Spread

● Category A Trees
● Category B Trees
● Category C Trees
● Category U Trees

Scale 1: 600 @ A3
02/2015