

FARMERS ARM LANE

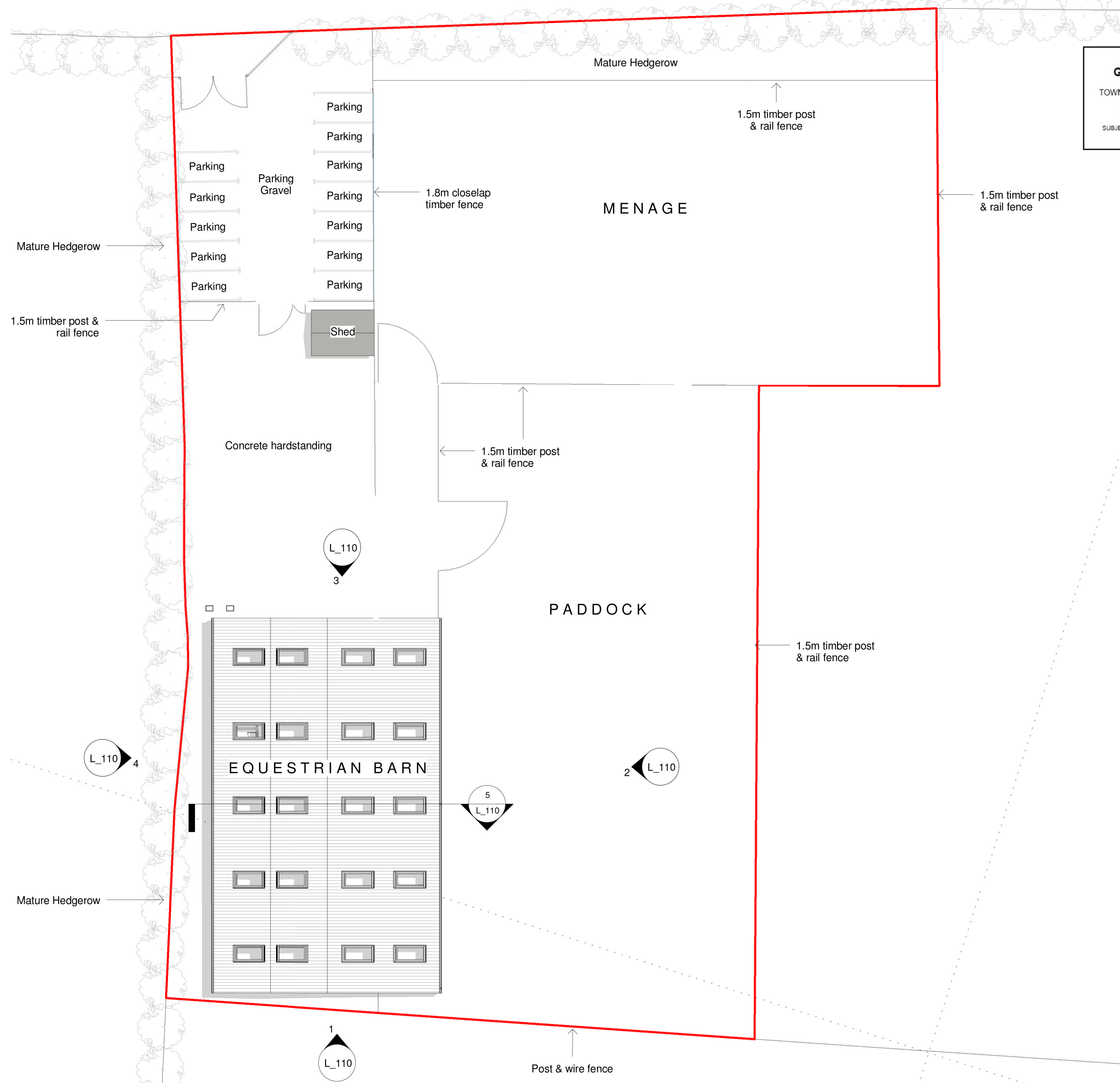

THE VALE OF
GLAMORGAN COUNCIL
TOWN AND COUNTRY PLANNING ACT 1990
APPROVED
SUBJECT TO COMPLIANCE WITH CONDITIONS (IF ANY)



Location Plan
1:1250

Site Plan as Existing
1:250

SITE AREA: 4200m2

Preliminary

date	rev	name	chk	note



Architectural Design - Feasibility - Planning - Building Control - Construction Details - Sustainable Design
Systems House 89 Heol Don Cardiff CF14 2AT
T 02920316857 M 07785582007 info@designlinepartnership.com

PROJECT
Proposed extension to equestrian barn

St Brides major Riding and Trekking Centre,
Farmers Arms Lane, CF32 0SD

DRAWING TITLE
Site Plan as Existing

SCALE	DATE	DRAWN BY	CHECKED BY
As indicated	26/09/13	Pete Legg	RH
DRAWING NUMBER	REVISION		
P392	L_001		

26/09/2013 19:36:10