

THE VALE OF  
GLAMORGAN COUNCIL  
TOWN AND COUNTRY PLANNING ACT 1990  
**APPROVED**  
SUBJECT TO COMPLIANCE WITH CONDITIONS (IF ANY)

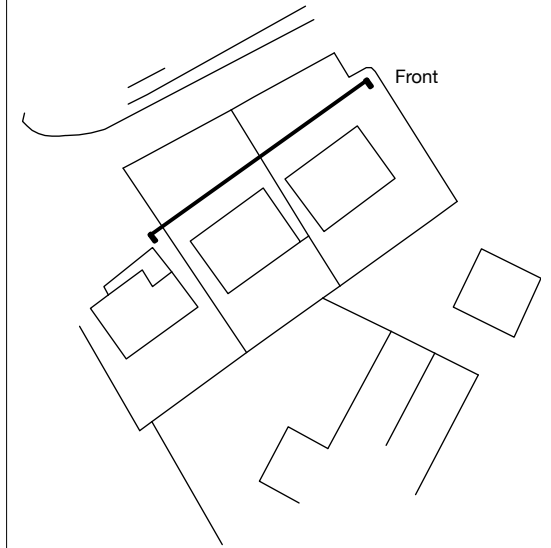

1 The Spinney



rev • description	issue date
Planning Issue	13.02.2015



**Scheme Design**

**BLEE HALLIGAN**

project	1 Spinney, Aberthin, Vale of Glamorgan, CF71 7HW
client	Sarah & Tony Patten
drawing number	E006
scale	1:100 @ A3
drawn	Greg Blee

**Existing Front Elevation**

Do not scale from this drawing. All dimensions are to be checked on site prior to commencing works on site. Any discrepancy found between information given on this drawing and that given elsewhere or recorded on site shall be notified immediately to the project architect in writing.