

15 00068 FUL

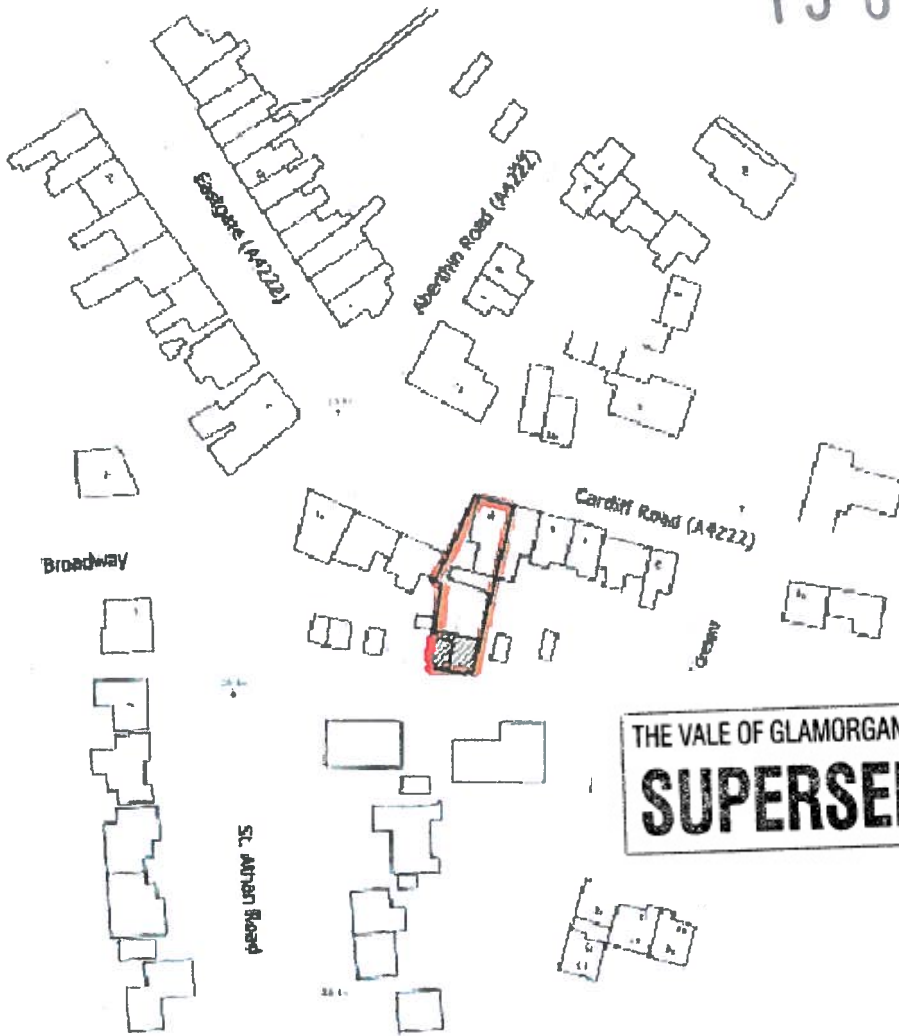

THE VALE OF GLAMORGAN COUNCIL
SUPERSEDED

RECEIVED

21 JAN 2015

ENVIRONMENTAL
AND ECONOMIC
REGENERATION

Site location plan
1:1250

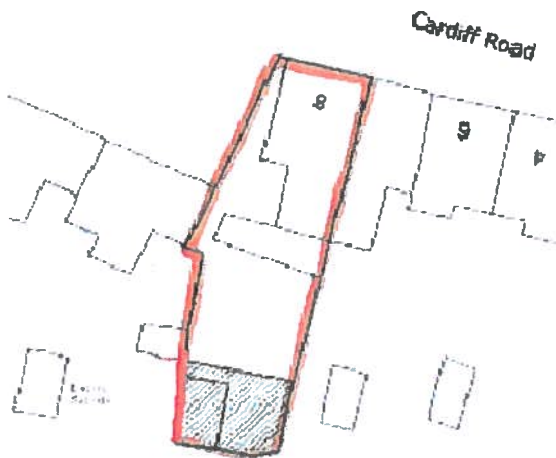

Site location plan
1:500

ADDRESS: 8 CARDIFF ROAD
COWBRIDGE

DRAWING TITLE: 05 - SITE LOCATION PLAN

SITE BOUNDARY



PROPOSED GARAGE LOCATION

