

Revisions

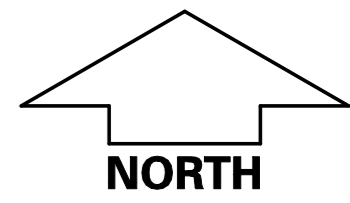

THE VALE OF
GLAMORGAN COUNCIL
TOWN AND COUNTRY PLANNING ACT 1990
APPROVED
SUBJECT TO COMPLIANCE WITH CONDITIONS (IF ANY)

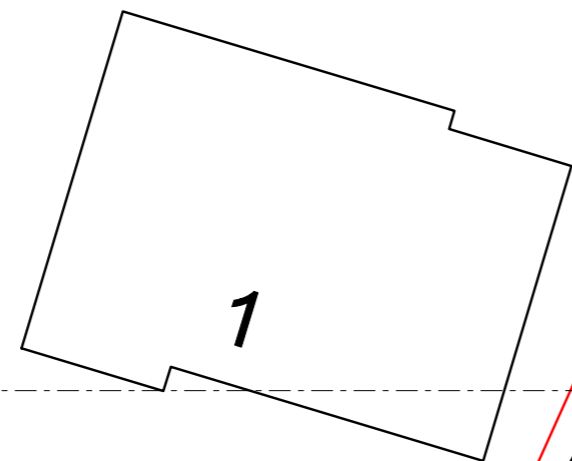

ROOKERY WOOD

ROOKERY CLOSE

168400

315200



HAZARD AWARENESS

UTILITIES HAZARD AWARENESS INFORMATION:

REFER TO THE WESTERN POWER, DWR CYMRU / WELSH WATER & WALES & WEST UTILITIES FOR EXISTING SERVICES LAYOUTS.

NOTE:
PRIOR TO WORK COMMENCING, RECOMMENDATION FOR A COMPREHENSIVE CCTV DRAINAGE SCAN TO BE UNDERTAKEN OF THE SITE & ITS SURROUNDINGS. LOCATION OF BUILDINGS SUBJECT TO CCTV SCAN FINDINGS.

SITE PLAN PRODUCED USING DETAILED SURVEY PREPARED BY OTHERS).
PLANS ARE SUBJECT TO IMPOSED PLANNING CONDITIONS & THOROUGH DRAINAGE INVESTIGATIONS. POSITION OF ALL EXISTING IN USE & REDUNDANT DRAINAGE RUNS TO BE CONFIRMED FOLLOWING FURTHER INVESTIGATION.

POSITION OF ANY EXISTING UNDERGROUND ELECTRICAL CABLES TO BE CONFIRMED FOLLOWING FURTHER INVESTIGATION.

OWNERSHIP OF ALL BOUNDARIES TO BE CONFIRMED BY CLIENT.

REFER TO ENGINEER'S PROPOSALS FOR DETAILS OF UPGADING WORKS TO EXISTING HIGHWAY, PROPOSED HIGHWAYS WITHIN NEW DEVELOPMENT AND FOR PROPOSED SITE LEVELS AND DRAINAGE DETAILS

pentan
architects
22 Cathedral Road
Cardiff CF11 9LJ
t: 029 2030 9010
info@pentan.co.uk

Project 2 ROOKERY CLOSE	Client MR I MACKINNON
Drawing Title EXISTING SITE PLAN	

Date NOV '14
Scale 1:200 @ A3
Drawing No. PL002
Rev.

NOTES. Do not scale. All dimensions are in millimetres unless stated otherwise