

THE VALE OF
GLAMORGAN COUNCIL
TOWN AND COUNTRY PLANNING ACT 1990
APPROVED
SUBJECT TO COMPLIANCE WITH CONDITIONS (IF ANY)

NEW EXTERNAL FRONT WALL
TO BE BUILT OFF EXISTING
RETAINING WALL. FOUNDATIONS
TO BE EXCAVATED TO CHECK
SUITABILITY BY BCO OR AJ

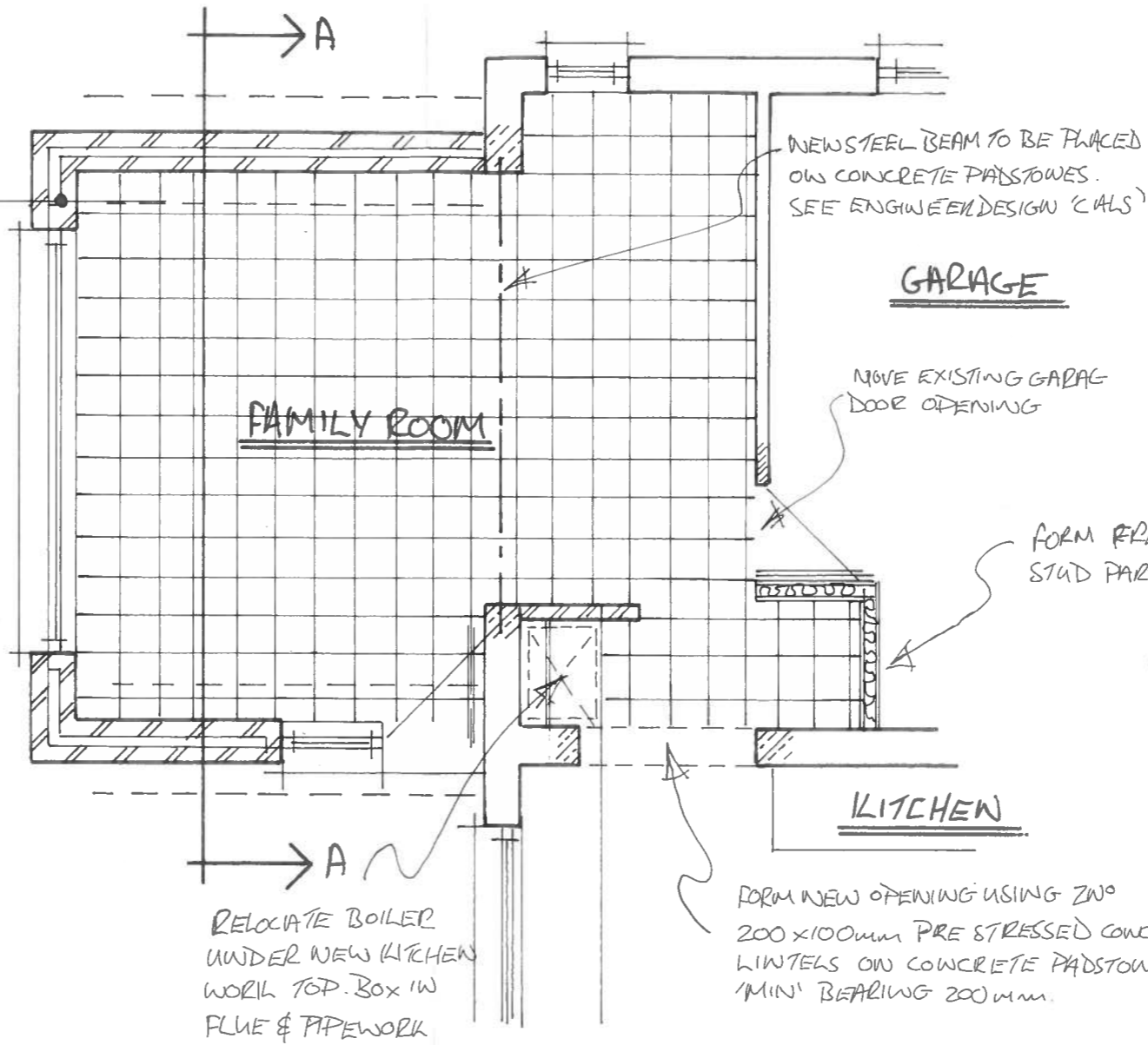

1401449 FUL



PROPOSED GROUND FLOOR

1:50.

PROPOSED GROUND FLOOR

