

VALE OF GLAMORGAN COUNCIL
AMENDED PLANS
 RECEIVED Date.....

2014/01445/FUL Received 20 January 2015

THE VALE OF GLAMORGAN COUNCIL
 TOWN AND COUNTRY PLANNING ACT 1990
APPROVED
 SUBJECT TO COMPLIANCE WITH CONDITIONS (IF ANY)

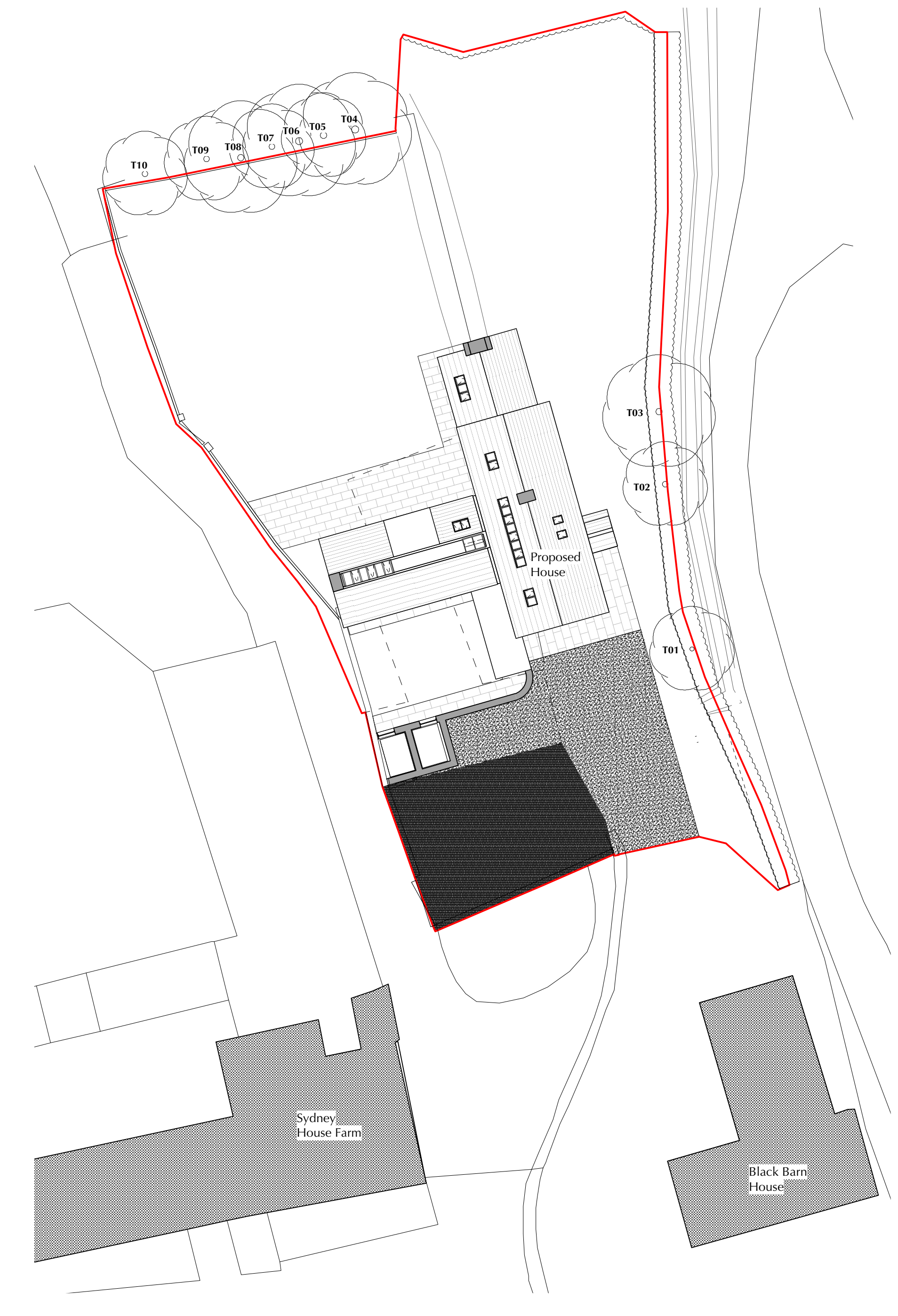
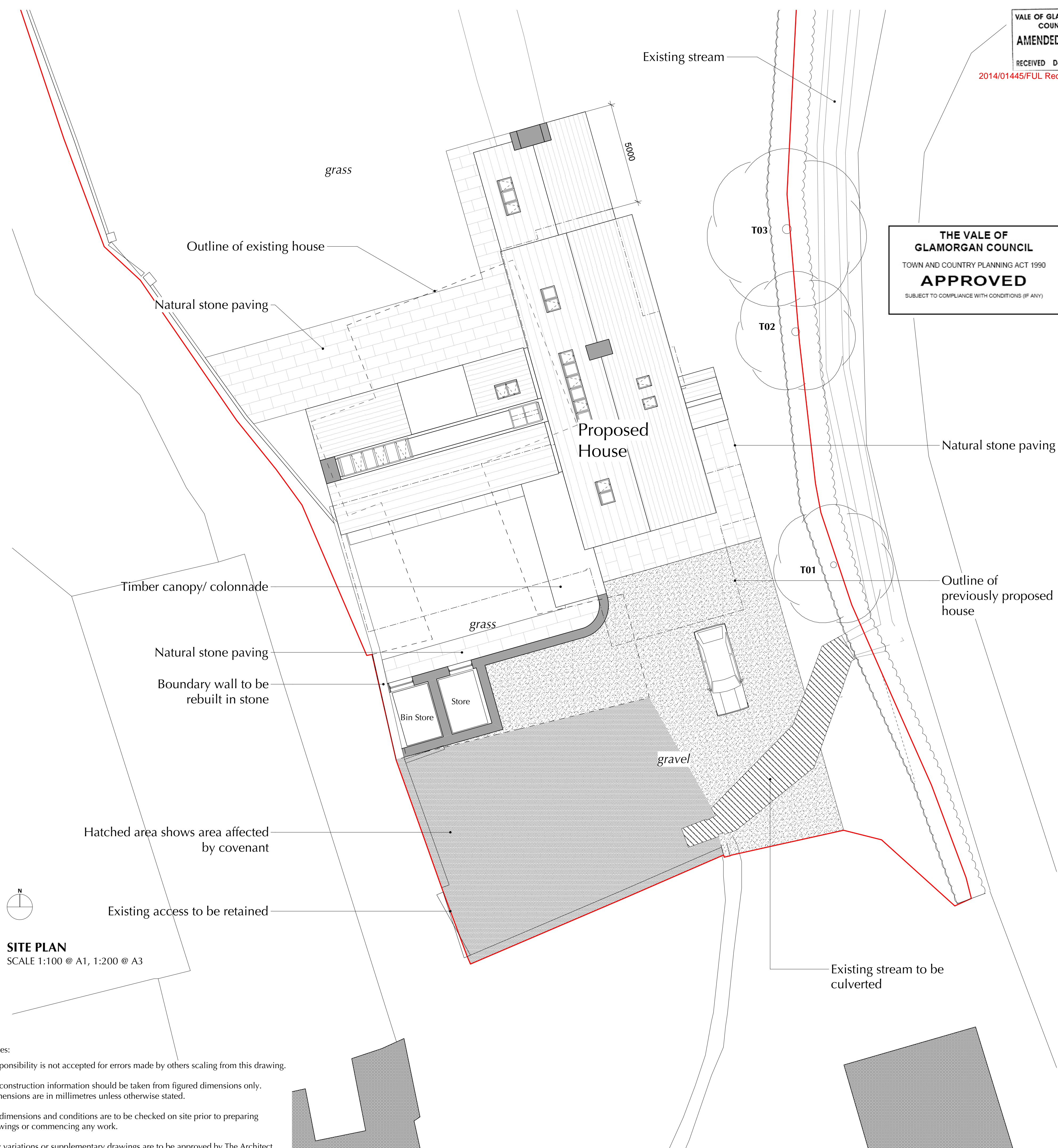

SITE PLAN
 SCALE 1:100 @ A1, 1:200 @ A3

LOCATION PLAN
 SCALE 1:250 @ A1, 1:500 @ A3

Notes:
 Responsibility is not accepted for errors made by others scaling from this drawing.
 All construction information should be taken from figured dimensions only. Dimensions are in millimetres unless otherwise stated.
 All dimensions and conditions are to be checked on site prior to preparing drawings or commencing any work.
 Any variations or supplementary drawings are to be approved by The Architect.

NO.	DATE	REVISION
A	15/1/15	Proposed property moved 5m North. Garage omitted. Landscaping amended to suit.

CLIENT
Mr & Mrs Mackle

PROJECT
Stourbridge House, Llyswnoey

DRAWING TITLE
Proposed Site & Location Plan

DRAWN/CHECKED
 CS/MP

SCALE
 1:100 @ A1

DATE
 Nov' 2014

DRAWING NO.
3413

REV.
P_200 A

DAVIES SUTTON ARCHITECTS
 Penrhed Studios • Penrhed Street
 Grange Town • Cardiff • CF11 7JU
 Tel: 029 2066 4455 • Fax: 029 2066 4411
 Email: office@davies-sutton.co.uk
 Web: www.davies-sutton.co.uk

DO NOT SCALE FOR CONSTRUCTION PURPOSES • ALL DIMENSIONS TO BE CHECKED ON SITE • NOTIFY ARCHITECT OF ALL DISCREPANCIES • THIS DRAWING IS COPYRIGHT