

14/01355/VVL

THE VALE OF  
GLAMORGAN COUNCIL  
TOWN AND COUNTRY PLANNING ACT 1990  
**APPROVED**  
SUBJECT TO COMPLIANCE WITH CONDITIONS (IF ANY)

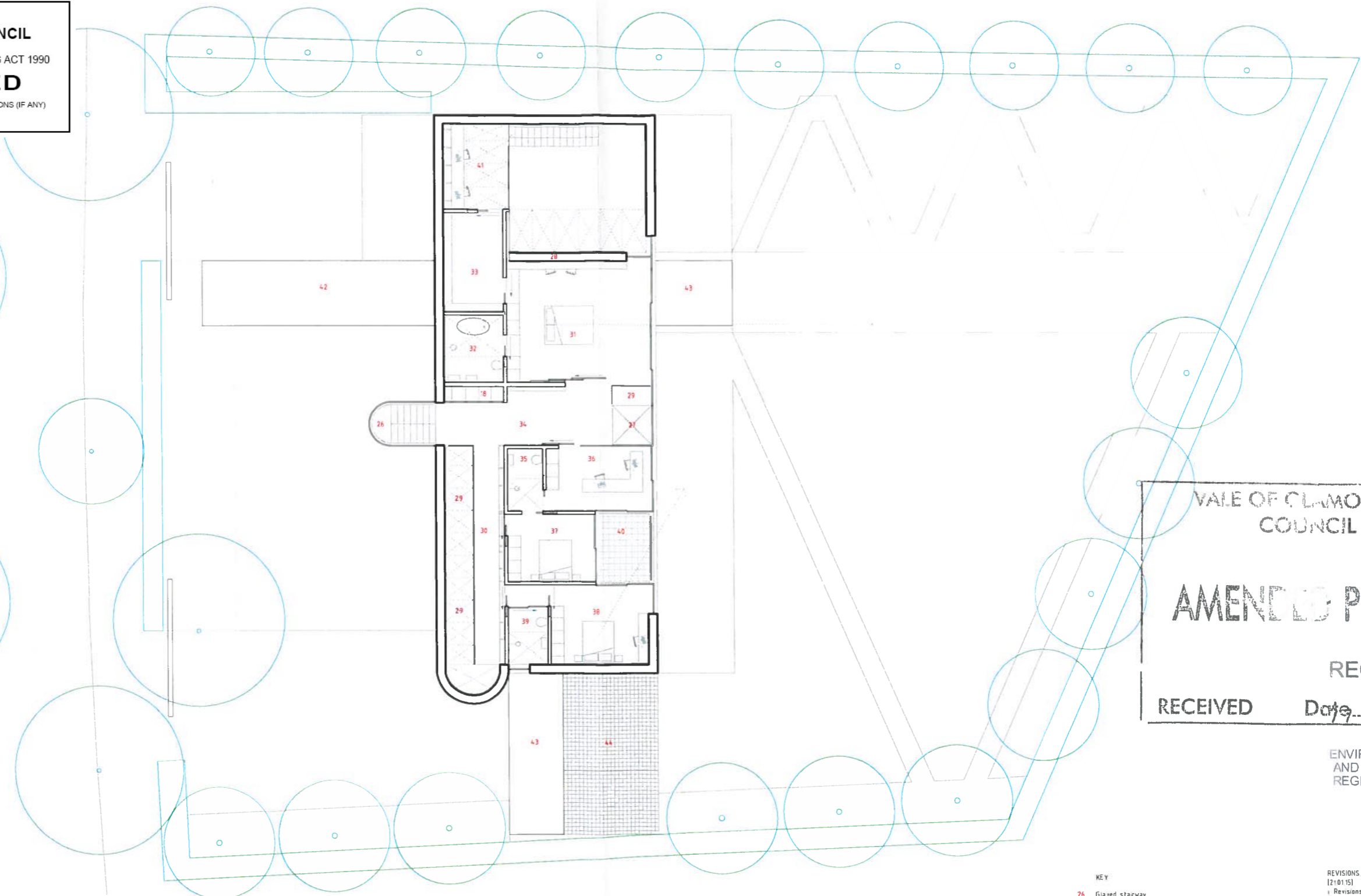

VALE OF GLAMORGAN  
COUNCIL  
**AMENDED PLANS**  
RECEIVED  
RECEIVED Date JAN 2015

ENVIRONMENTAL  
AND ECONOMIC  
REGENERATION

- KEY
- 26 Glazed stairway
  - 27 Glazed lift
  - 28 Service riser
  - 29 Void to floor below
  - 30 1st floor gallery walkway
  - 31 Masterbedroom
  - 32 Masterbedroom ensuite
  - 33 Walk-in wardrobe
  - 34 1st floor library
  - 35 Bathroom
  - 36 Study
  - 37 Bedroom 02
  - 38 Bedroom 03
  - 39 Bedroom 03 ensuite
  - 40 External terrace
  - 41 1st Gallery for the music room
  - 42 Anodised aluminium over the entrance
  - 43 Anodised aluminium canopy
  - 44 Perforated anodised aluminium canopy

REVISIONS  
(21/01/15)  
+ Revisions in line with local authority  
planning requirements

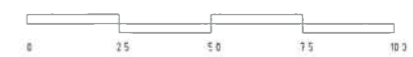

PROJECT  
NEW DWELLING AT 12 PARK ROAD

SCHEME  
FIRST FLOOR PLAN

DATE  
200 @ A3  
JAN 15 08 1421/S05A

LOYN & CO ARCHITECTS