

Payne, Adrienne J

14/01238/FUL

From: Jonathan Williams <jonathan@rfparchitects.com>
Sent: 11 September 2015 14:19
To: Prichard, Yvonne J
Cc: Planning & Transportation (Customer Care)
Subject: Brynheulog, Welsh St Donats, Cowbridge, Vale of Glamorgan, CF71 7SS - Planning Approval Ref. 2014/01238/FUL
Attachments: 2276_dp111a.pdf; Existing Wall 1.jpg; Existing Wall 3.jpg; Existing Wall 4.jpg; Existing Wall 5.jpg

Dear Yvonne

I write to provide with the information required by the following planning conditions in connection with the above approval:

Condition 7

- The applicant has hand-delivered the following material samples to your offices:
 - Natural slate
 - Natural limestone
 - Reconstructed stone sills / heads
 - Windows

Condition 8

- The applicant proposes to replace the entirety of the stone boundary wall that runs alongside the highway as it is dilapidated and beyond repair. This is detailed on the attached Proposed Site Plan drawing, 2276/DP111A, which was submitted as part of the recent Non-Material Application (ref. 2014/01238/FULA).
- I attach 4 photographs showing the condition of the existing wall and a photograph depicting the wall to be constructed

I trust you are well and look forward to receiving your confirmation that the foregoing and attached information is sufficient to discharge Conditions 7 and 8.

Kind regards

Jonathan

Jonathan N Williams
Robertson Francis Partnership
Chartered Architects
13 Cathedral Road
CARDIFF
CF11 9HA

t: 029 2039 9000
m: 07710 362286

RECEIVED

14 SEP 2015

ENVIRONMENTAL
AND ECONOMIC
REGENERATION

D.E.E.R
RECEIVED
ACTION BY: 4P/Jmc
NO: 1
ACK:

WARNING:

Please ensure that you have adequate virus protection in place before you open or detach any documents attached to this e-mail. The information contained in this e-mail message and any attachments are (a) the property of Robertson Francis Partnership, (b) confidential, and (c) may also be legally privileged. They are intended only for the addressee. If you are not the addressee you must not disclose, copy or distribute these or take any action in reliance on them. If you have received this e-mail in error, please notify us immediately by telephone on 029 2039 9000 and redirect the e-mail and any attachments to us.

 Please consider the environment before printing this e-mail

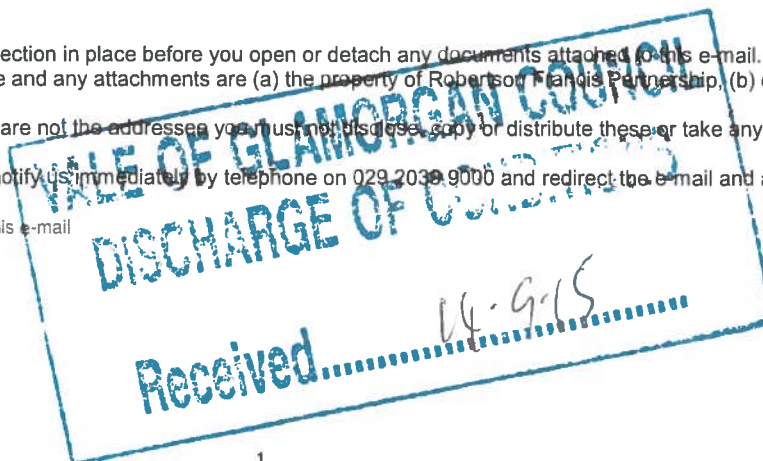



GP

HEOL MYNYDD

LB

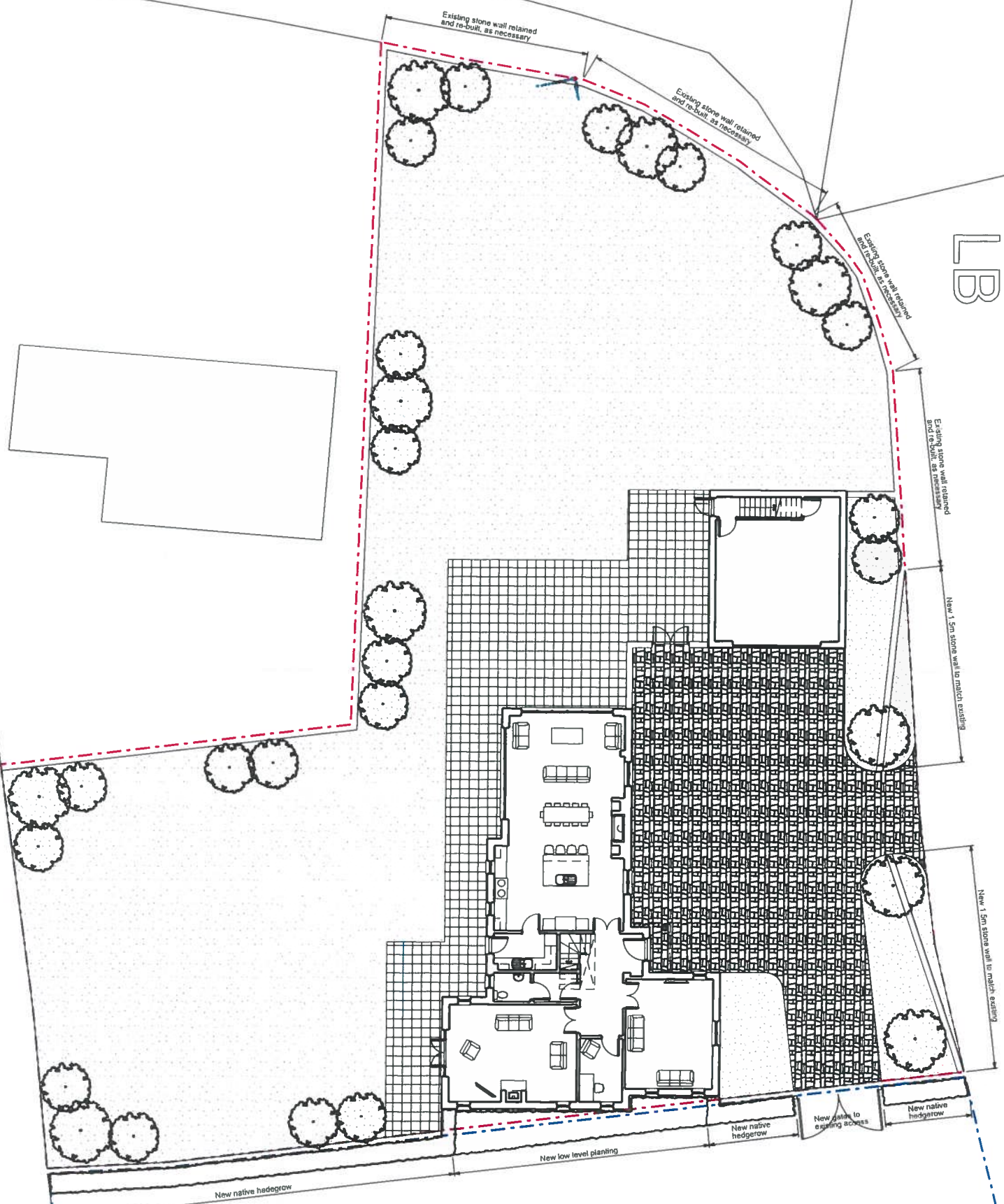

N
O
T
E
S

RECEIVED

14 SEP 2015

ENVIRONMENTAL
AND ECONOMIC
REGENERATION

VALE OF GLAMORGAN COUNCIL
DISCHARGE OF CONDITIONS
Received 14.9.15

REVISION	DESCRIPTION	BY	DATE
A	Site plan and boundary treatment amended to suit repositioned house	RDP	04.08.15
ROBERTSON FRANCIS P A R T N E R S H I P Chartered Architects Tel : (029) 2039 9000 5-7 Museum Place Fax : (029) 2038 7351 Cardiff CF10 3BD E-mail : info@francisfrancis.com			
RFP			
MR L ENGLAND			

BRYHEULOG
WELSH ST DONATS
VALE OF GLAM., CF71 7SS

PROPOSED SITE PLAN
INCORPORATING TOPOGRAPHICAL
AND AS-BUILT SURVEY

STATUS	DATE	DESIGNED	CHECKED	SCALE
PLANNING	18.05.15	RDP	JNW	1:250
CDR NO	2276	DISCHARGE NO	DP 111	REV
				A

THIS DRAWING IS COPYRIGHT. ALL DIMENSIONS TO BE CHECKED ON SITE. ANY DISCREPANCIES TO BE REPORTED IMMEDIATELY TO THE ARCHITECTS. ALL DIMENSIONS TO BE CHECKED PRIOR TO ORDER OF MATERIALS OR FABRICATION OF WORK. THIS DRAWING SHOULD NOT BE SCALED.

RECEIVED

SEP 2015

ENVIRONMENTAL
ECONOMIC
REGISTRATION

14/01/2015

VALE OF GLAMORGAN COUNCIL
DISCHARGE CERTIFICATE
Received 14/01/2015

14/01/38 fu

VALE OF GLAMORGAN COUNCIL
DISCHARGE OF CC. 10/1/38

Received 14.9.15

14/01238/fm



VALE OF GLAMORGAN
DISCHARGE

RECEIVED

SEP 2003

Received

14/9/15

14/01/2014
VALE OF GLAMORGAN COUNCIL
DISCHARGE OF COLLECTIONS
Received 14/01/2014



14/01/2011



WALE OF GLAMORGAN COUNCIL
IN CHARGE OF CONSTRUCTION
14 SEP 2015
RECEIVED
ENVIRONMENTAL
AND ECONOMIC
REGENERATION