

**THE VALE OF
GLAMORGAN COUNCIL**
 TOWN AND COUNTRY PLANNING ACT 1990
APPROVED
 SUBJECT TO COMPLIANCE WITH CONDITIONS (IF ANY)

2014/01222/ful

RECEIVED

21 OCT 2014

ENVIRONMENTAL
AND ECONOMIC
REGENERATION

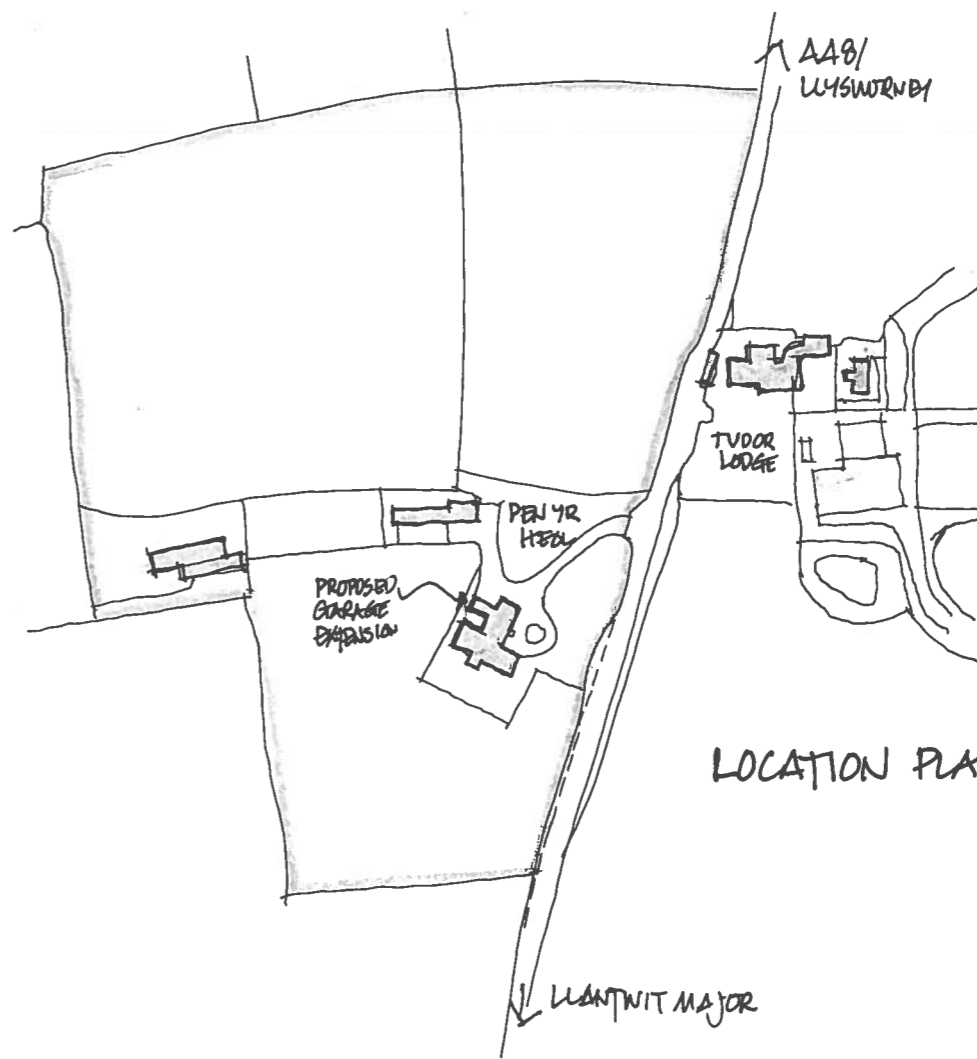

PROPOSED EXTENSION TO EXISTING GARAGE
 PEN YR HEOL, LLYSWORNEY
 MR & MRS M.J. TOUGH
 OCT 2014

EXISTING