

1401175 FUL

RECEIVED

07 OCT 2014

ENVIRONMENTAL
AND ECONOMIC
REGENERATION

THE VALE OF
GLAMORGAN COUNCIL
TOWN AND COUNTRY PLANNING ACT 1990
APPROVED
SUBJECT TO COMPLIANCE WITH CONDITIONS (IF ANY)

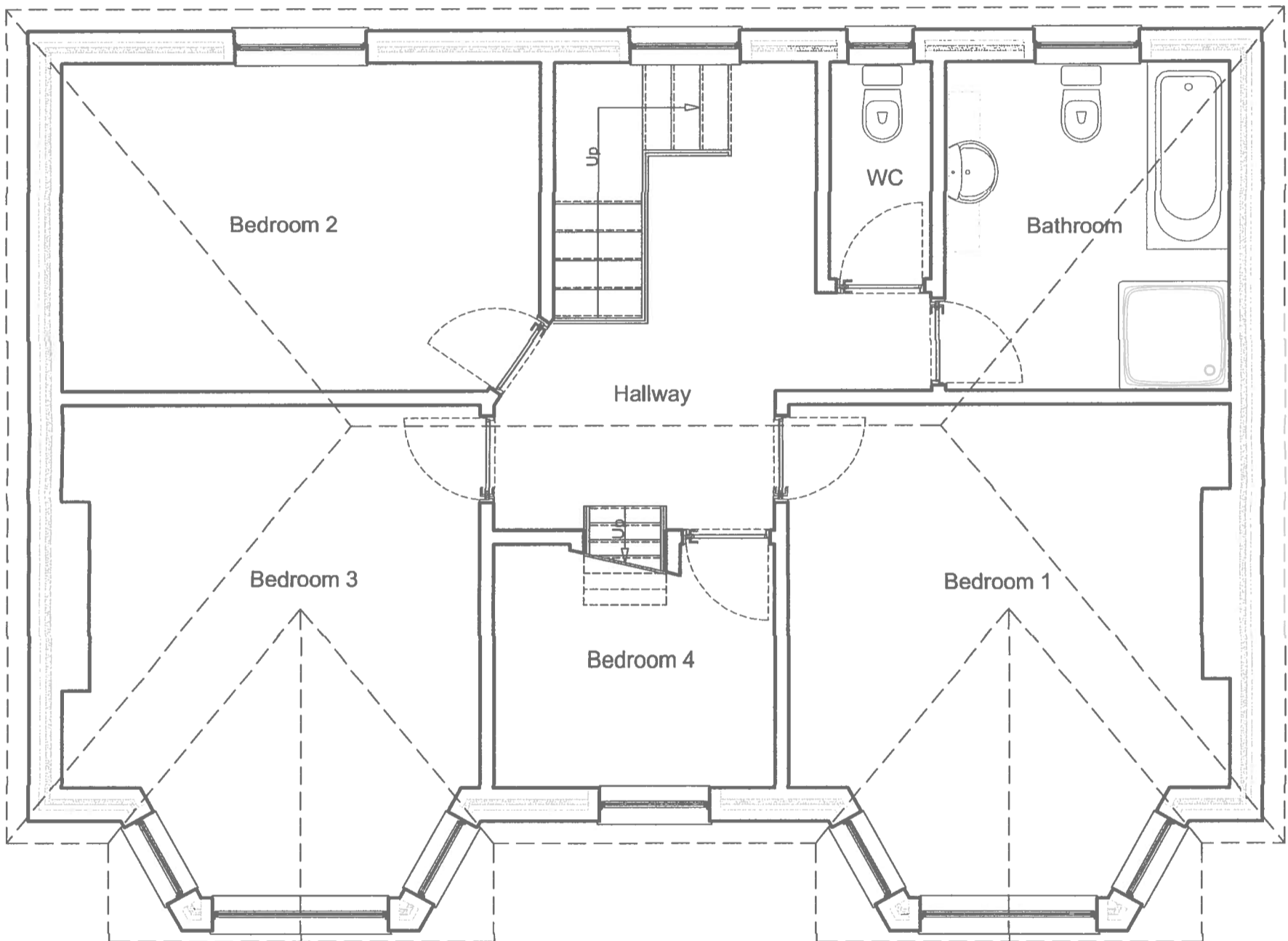

SHEET:
A-3
SCALE:
1:50
DATE:
18/09/2014

Plan-it-
Design
DRAWINGS PROVIDED BY:

PROJECT DESCRIPTION:
Two storey rear extension
Mr Alan Williams
Morfa
12 Romilly Avenue, Romilly Park, Barry, CF62 6RB

SHEET TITLE:
**Existing
First Floor Plan**

THE VALE OF
GLAMORGAN COUNCIL
 TOWN AND COUNTRY PLANNING ACT 1990
APPROVED
 SUBJECT TO COMPLIANCE WITH CONDITIONS (IF ANY)



Left side elevation

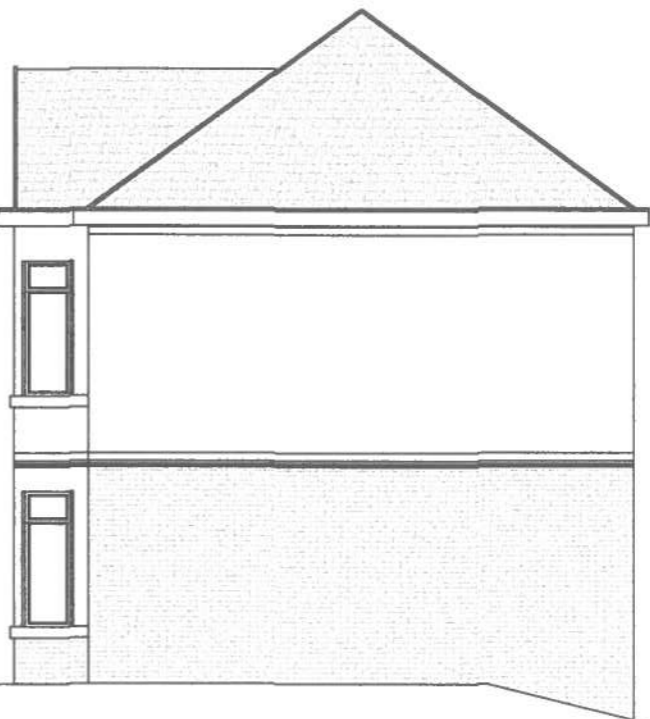

Right side elevation

RECEIVED
 07 OCT 2014
 ENVIRONMENTAL
 AND ECONOMIC
 REGENERATION

14 01 175 FUL



Front elevation

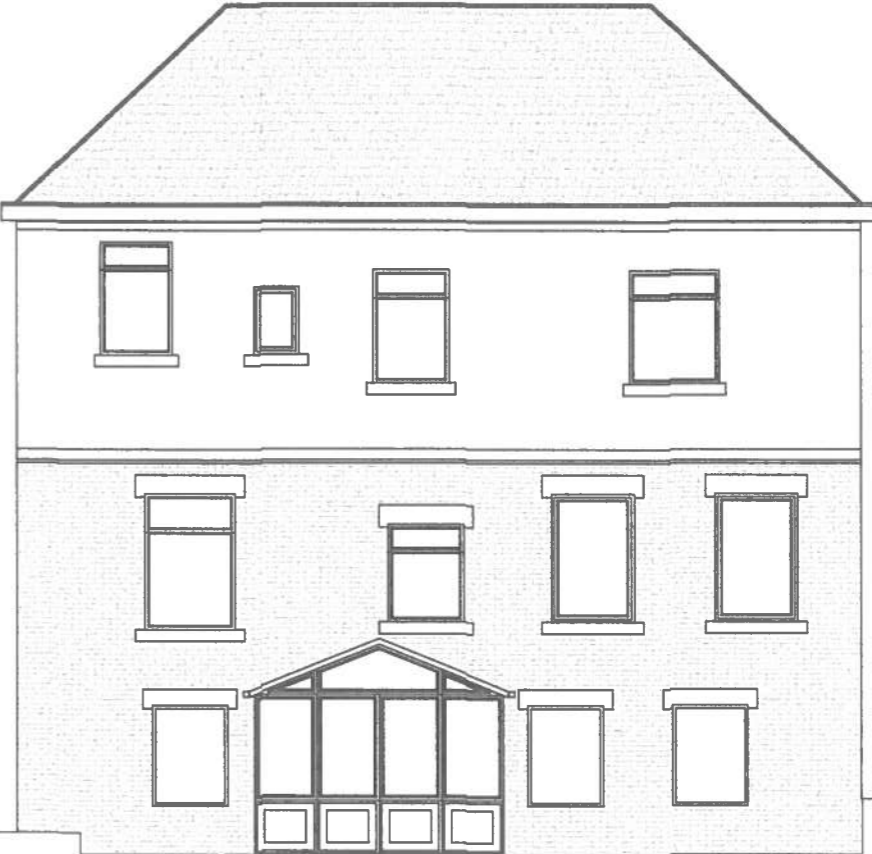

Rear elevation



SHEET: A-3
 SCALE: 1:100
 DATE: 27/08/2014



DRAWINGS PROVIDED BY:
PLAN IT DESIGN

PROJECT DESCRIPTION:
Two storey rear extension
 Mr Alan Williams
 Morfa 12 Romilly Avenue, Romilly Park, Barry, CF62 6RB

SHEET TITLE:
Existing Elevations