

**THE VALE OF
GLAMORGAN COUNCIL**
TOWN AND COUNTRY PLANNING ACT 1990

REFUSED

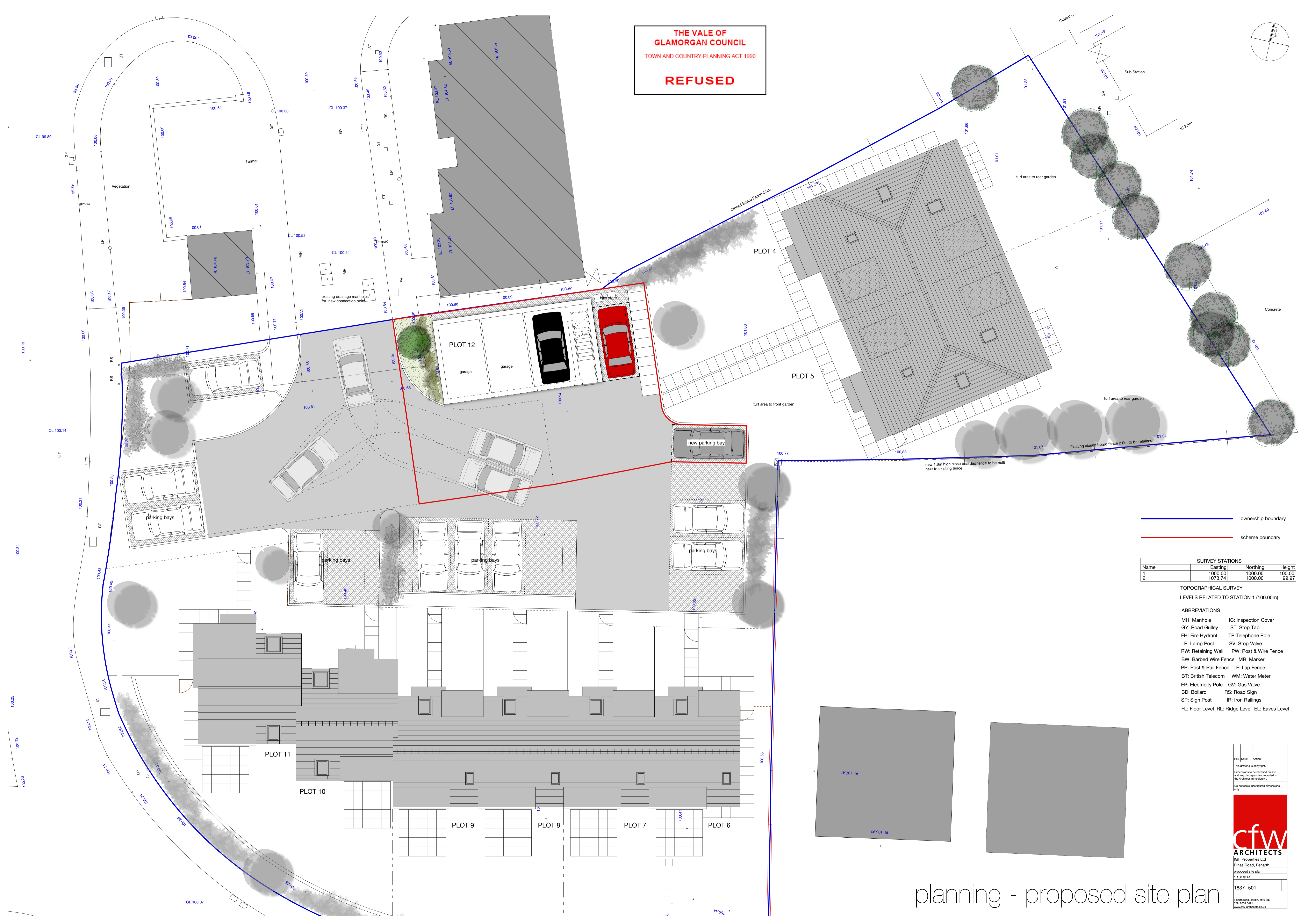

— ownership boundary
— scheme boundary

SURVEY STATIONS		
Name	Easting	Northing
1	1000.00	1000.00
2	1073.74	1000.00

TOPOGRAPHICAL SURVEY
LEVELS RELATED TO STATION 1 (100.00m)

- ABBREVIATIONS
- MH: Manhole
 - GY: Road Gully
 - FH: Fire Hydrant
 - LP: Lamp Post
 - RW: Retaining Wall
 - BW: Barbed Wire Fence
 - PR: Post & Rail Fence
 - BT: British Telecom
 - IC: Inspection Cover
 - ST: Stop Tap
 - TP: Telephone Pole
 - SV: Stop Valve
 - PW: Post & Wire Fence
 - MR: Marker
 - LF: Lap Fence
 - WM: Water Meter
 - GV: Gas Valve
 - RS: Road Sign
 - IR: Iron Railings
 - FL: Floor Level
 - RL: Ridge Level
 - EL: Eaves Level

Rev	Date	Action

This drawing is copyright.
Dimensions to be checked on site
and any discrepancies reported to
the Architect immediately.
Do not scale, use Squared dimensions
only.

cfw
ARCHITECTS

IGH Properties Ltd
Dinas Road, Penarth
proposed site plan
1:150 @ A1
1837- 501

if north used, credit: cfw 3du
© 2018 cfw
www.cfw-architects.co.uk

planning - proposed site plan