

ADDITIONAL DRAWINGS

14/12/14

THE VALE OF
GLAMORGAN COUNCIL
TOWN AND COUNTRY PLANNING ACT 1990
APPROVED
SUBJECT TO COMPLIANCE WITH CONDITIONS (IF ANY)

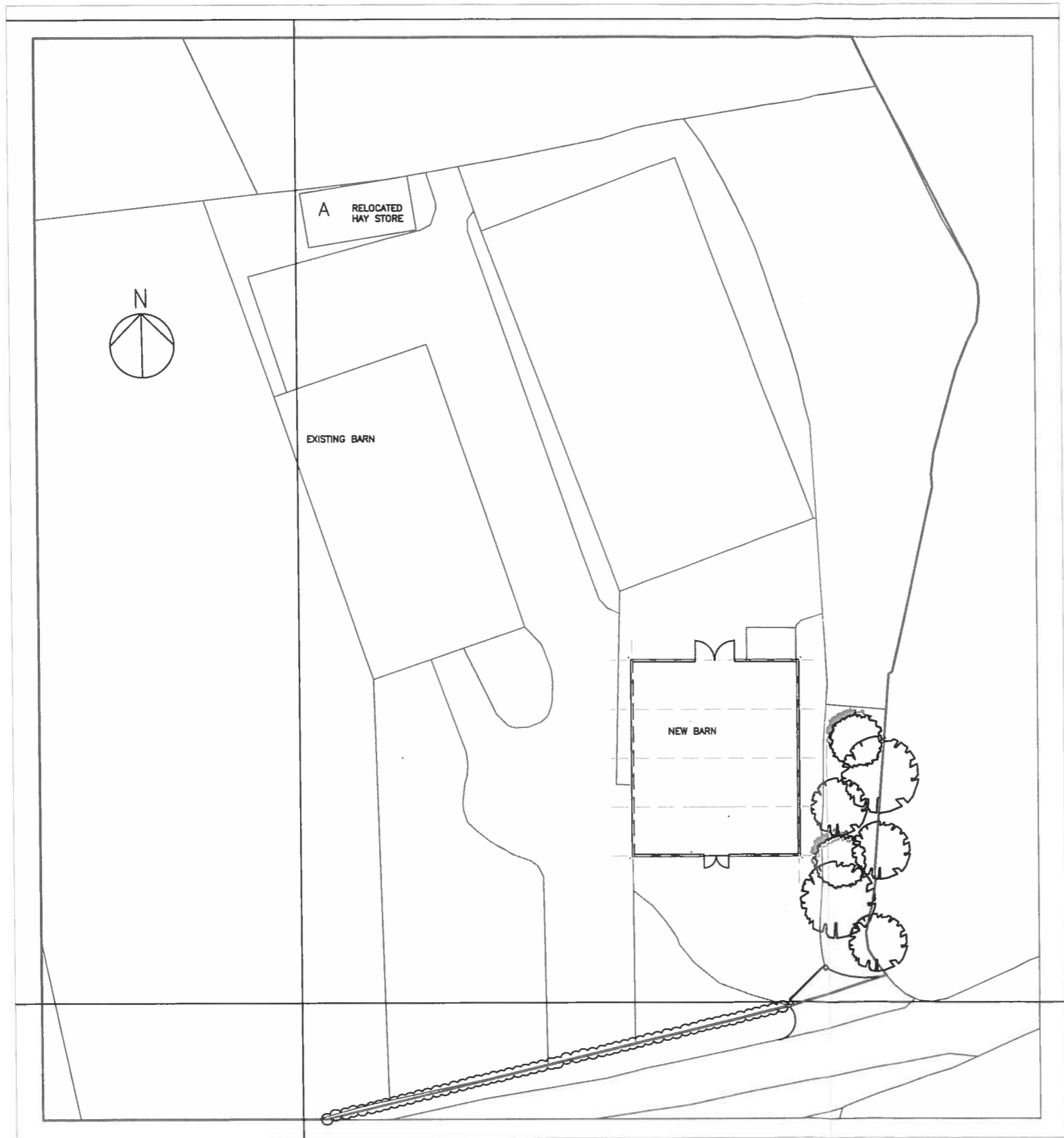

PROPOSED SITE PLAN 1:500

VALE OF GLAMORGAN
COUNCIL
AMENDED PLANS
2014/01014 /FUL
RECEIVED Date 14/12/14

Project Name and Address
NEW BARN
PEN Y BRYN BOTTOM FARM
LLANMAES
VALE OF GLAMORGAN
CF71 7LU

Client R J M HARRIS	Sheet (PA)1001A
Date JULY 2014	PROPOSED LAYOUT
Scale 1:100 @ A3	

Architect:
Nick Renwick Chartered Architect
6 Old Hall, Cowbridge
Vale of Glamorgan. CF71 7AH
Tel: 01446 775589

1401014 FUL